



SETUP, PARTS & MAINTENANCE MANUAL BZT 2000 SERIES

Models:

642220	BZT 2190 19HP KAW W/48 SIDE DISCHARGE
642221	BZT 2190 19HP KAW W/52 SIDE DISCHARGE
642222	BZT 2230 23HP KAW W/52 SIDE DISCHARGE
642223	BZT 2230 23HP KAW W/61 SIDE DISCHARGE
642233	BZT 2250 25HP KAW W/61 SIDE DISCHARGE
642227	BZT 2230LC 23HP KLR W/52 SIDE DISCHARGE
642228	BZT 2230LC 23HP KLR W/61 SIDE DISCHARGE



WARNING: If incorrectly used this machine can cause severe injury. Those who use and maintain this machine should be trained in its proper use, warned of its dangers and should read the entire manual before attempting to set up, operate, adjust or service the machine.

CALIFORNIA
Proposition 65 Warning

Diesel engine exhaust and some of its constituents are known to the State of California to cause cancer, birth defects and other reproductive harm.



WARNING

The engine exhaust from this product contains chemicals known to the State of California to cause cancer, birth defects or other reproductive harm.

Californie Proposition 65
Avertissement

Les échappements des moteurs diesel et certains de leurs composés sont reconnus par l'Etat de Californie pour être cancérigènes, provoquer des défauts congénitaux et d'autres dangers en matière de reproduction.



AVERTISSEMENT

L'émission du moteur de ce matériel contient des produits chimiques que l'Etat de Californie considère être cancérigènes, provoquer des défauts congénitaux et d'autres dangers en matière de reproduction.

California Advertencia
de la Proposicion 65

El estado de California hace saber que los gases de escape de los motores diesel y algunos de sus componentes producen cáncer, defectos de nacimiento y otros daños en el proceso de reproducción humana.



ADVERTENCIA

El estado de California hace saber que los gases de escape de este producto contienen productos químicos que producen cáncer, defectos de nacimiento y otros daños en el proceso de reproducción humana.

BZT 2000 Series

IMPORTANT MESSAGE

Thank you for purchasing this Bunton product. You have purchased a world class mowing product, one of the best designed and built anywhere.

This machine comes with an Operation and Safety Manual and a separate Setup, Parts and Maintenance Manual. The useful life and good service you receive from this machine depends to a large extent on how well you read and understand these manuals. Treat your machine properly, lubricate and adjust it as instructed, and it will give you many years of reliable service.

Your safe use of this Bunton product is one of our prime design objectives. Many safety features are built in, but we also rely on your good sense and care to achieve accident-free operation. For best protection, study the manuals thoroughly and watch the operation training video. Learn the proper operation of all controls. Observe all safety precautions. Follow all instructions and warnings completely. Do not remove or defeat any safety features. Make sure those who operate this machine are as well informed and careful in its use as you are.

See a Bunton dealer for any service or parts needed. Bunton service ensures that you continue to receive the best results possible from Bunton's products. You can trust Bunton replacement parts because they are manufactured with the same high precision and quality as the original parts.

Bunton designs and builds its equipment to serve many years in a safe and productive manner. For longest life, use this machine only as directed in the manuals, keep it in good repair and follow safety warnings and instructions. You'll always be glad you did.

Textron Golf, Turf & Specialty Products
One Bob Cat Lane
Johnson Creek, WI 53038-0469

TABLE OF CONTENTS	FIGURES	PAGE
SAFETY		2
ASSEMBLY AND SETUP		3-5
MAINTENANCE CHART		6
MAINTENANCE RECORD		7
MAINTENANCE		8-15
ADJUSTMENTS		16-19
BELT REPLACEMENT		20, 21
SPECIFICATIONS		22-24
PARTS SECTION		25
UPPER ENGINE DECK ASSY	FIGURE 1	26, 27
LOWER ENGINE DECK ASSY/CLUTCH	FIGURE 2	28, 29
CRADLE ASSEMBLY	FIGURE 3	30, 31
DECALS	FIGURE 4	32, 33
BUMPER	FIGURE 5	34, 35
BRAKES/REAR WHEEL	FIGURE 6	36, 37
HYDRAULICS	FIGURE 7	38, 39
HYDROGEAR PUMP	FIGURE 8	40, 41
DECALS-CUTTERDECKS	FIGURE 9	42, 43
KOHLER WIRE HARNESS-LIQ. COOLED	FIGURE 10	44, 45
KAWASAKI WIRE HARNESS	FIGURE 11	46, 47
FUEL TANKS/CONTROL PANEL	FIGURE 12	48, 49
OIL COOLER	FIGURE 13	50, 51
OIL COOLER-LIQUID COOLED	FIGURE 14	52, 53
SEAT ASSEMBLY & ROPS	FIGURE 15	54, 55
ELECTRIC DECK LIFT	FIGURE 16	56, 57
STEERING/INSTRUMENTS	FIGURE 17	58, 59
CRADLE & CASTER ASSEMBLY	FIGURE 18	60, 61
48" SIDE DISCHARGE	FIGURE 19	62, 63
52" & 61" SIDE DISCHARGE	FIGURE 20	64, 65
BELTS	FIGURE 21	66, 67

NOTICE !!!

Unauthorized modifications may present **extreme** safety hazards to operators and bystanders and could also result in product damage.

Textron Golf, Turf & Specialty Products strongly warns against, rejects and disclaims any modifications, add-on accessories or product alterations that are not designed, developed, tested and approved by Textron Golf, Turf & Specialty Products Engineering Department. Any Textron Golf, Turf & Specialty Products product that is altered, modified or changed in any manner not specifically authorized after original manufacture—including the addition of “after-market” accessories or component parts not specifically approved by Textron Golf, Turf & Specialty Products—will result in the Textron Golf, Turf & Specialty Products Warranty being voided.

Any and all liability for personal injury and/or property damage caused by any unauthorized modifications, add-on accessories or products not approved by Textron Golf, Turf & Specialty Products will be considered the responsibility of the individual(s) or company designing and/or making such changes. Textron Golf, Turf & Specialty Products will vigorously pursue full indemnification and costs from any party responsible for such unauthorized post-manufacture modifications and/or accessories should personal injury and/or property damage result.

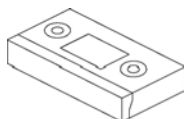

OPERATION TRAINING VIDEO:

Part Number	Description
2810586	BZT 2000 SERIES



This symbol means:
ATTENTION!
BECOME ALERT!

Your safety and the safety of others is involved.

Signal word definitions:

The signal words below are used to identify levels of hazard seriousness. These words appear in this manual and on the safety labels attached to Ransomes machines. For your safety and the safety of others, read and follow the information given with these signal words and/or the symbol shown above.

DANGER

DANGER indicates an imminently hazardous situation which, if not avoided, **WILL** result in death or serious injury.

WARNING

WARNING indicates a potentially hazardous situation which, if not avoided, **COULD** result in death or serious injury.

CAUTION

CAUTION indicates a potentially hazardous situation which, if not avoided, **MAY** result in minor or moderate injury. It may also be used to alert against unsafe practices or property damage.

CAUTION

CAUTION used without the safety alert symbol indicates a potentially hazardous situation which, if not avoided, **MAY** result in property damage



MODEL NUMBER: This number appears on sales literature, technical manuals and price lists.

SERIAL NUMBER: This number appears only on your mower. It contains the model number followed consecutively by the serial number. Use this number when ordering parts or seeking warranty information.

TOOLS REQUIRED FOR ASSEMBLY

- Wrecking bar
- Claw hammer
- Ratchets: 3/8"
- Sockets: 3/8", 1/2", 17 mm, 19 mm
- Wrenches: two 15/16" (or adjustable), 13 mm, 17 mm, 19 mm
- Level
- Straight edge
- Tire pressure gauge

NOTE: All references below to the "right" or "left" are with respect to an operator at the controls.

1. INSTALL SEAT

- Position seat over seat plate and route seat wire **W** through hole **H** in seat plate. Drop seat mounting studs through seat plate holes. Secure studs with four 5/16-18 whiz nuts and tighten securely.
- Leave enough seat wire between the seat and seat plate to allow full fore and aft travel of the seat. Secure seat wire on the bottom of the seat plate with clip **C** and a 1/4-20x3/8 thread forming screw.
- Connect the tractor harness to the seat wire.

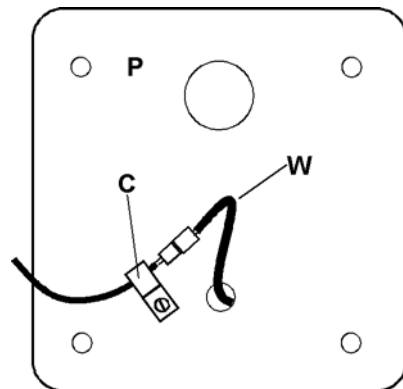
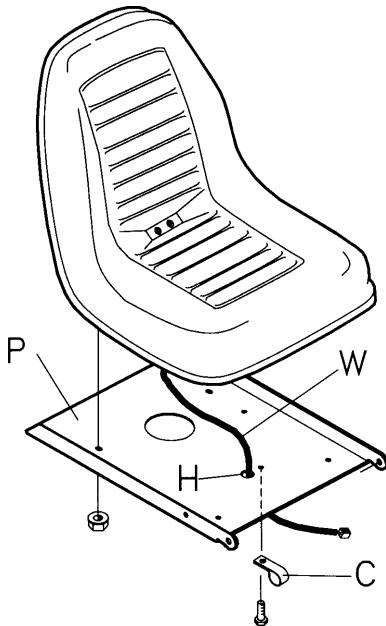
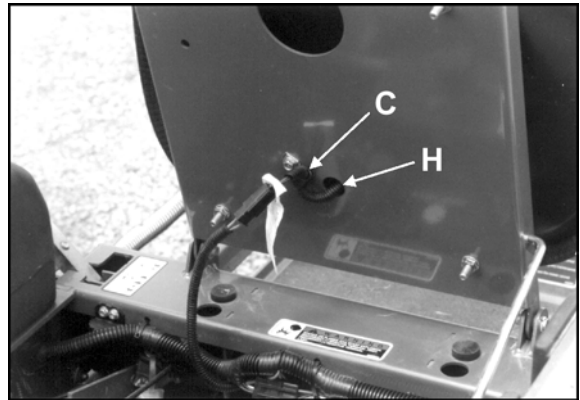

Bottom of seat plate **P** showing clip **C**

2. Set tire pressures to 14 lbs/in² (1.0 kg/cm²). Tires are overinflated for shipping.

3. LEVEL CUTTERDECK

To level decks, follow Steps a-d:

- a) Remove the height of cut pin **A** and raise the cutterdeck to the 3" height of cut position.
- b) Locate (2) 3" tall blocks just inside the front rollers and (2) 2-7/8" tall blocks just inside the rear rollers.
- c) Lower the deck until it is resting on the blocks and there is plenty of float for the actuator **B**.
- d) Loosen the jamnuts on the height of cut clips. Adjust the thread rolling screws **C** on the front and rear chains until the chains just become tight. Tighten the jamnuts against the clips.

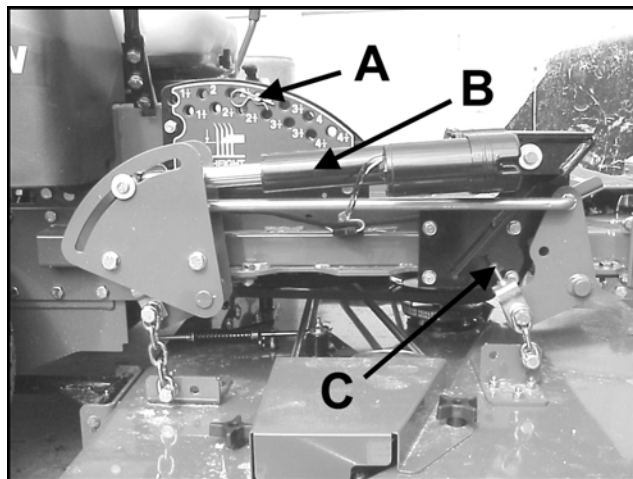

4. TRACTION LEVERS

- a) Remove bolt **A**.
- b) Rotate traction lever **B** into position and secure with bolt **A**. Repeat for the other lever.
- c) Tighten all fasteners.
- d) Sit on the machine. If the levers are too long, bracket **C** may be removed to make them shorter.

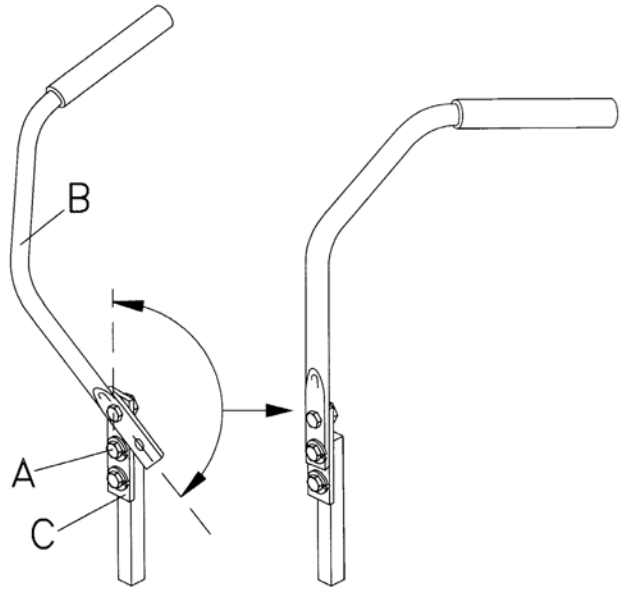

5. FINAL PREPARATIONS

- Check the engine and hydraulic oil levels. Top up with the correct oil if necessary. Use 10W30 motor oil for the engine. Use fresh, clean 15W40 or 20W50 motor oil or 15W50 synthetic motor oil for the hydraulic system.
- Remove the battery from the machine. Fill the battery to the bottom of the vent wells with acid and trickle charge for several hours. Replace the battery in the machine and make the connections, red to positive first, then black (ground) to negative.
- Read Operation and Safety Manual before starting.
- Run engine at full RPM for 5 minutes before engaging blades to allow the engine to be fully lubricated before load is applied.
- Check the hydrostat neutral adjustment. Neutral is set at the factory but may require readjustment if air trapped during the initial oil fill has worked out of the system. See adjustments section later in this manual.
- Do not use the machine without an approved grass collector, the grass discharge chute or mulching plates correctly fitted.

MAINTENANCE CHART

BZT 2000 Series

MAINTENANCE OPERATION	Maintenance is an ongoing job. These intervals are maximum times between maintenance operations. Perform more often under severe conditions.						
	FIRST 5 HOURS	DAILY	EVERY 25 HOURS	EVERY 50 HOURS	EVERY 100 HOURS	EVERY 200 HOURS	EVERY 500 HOURS
ENGINE							
Consult the engine manual for additional information and instructions							
Check/Top off Engine Coolant (Where Applicable)		X					
Check/Top up Oil Level		X					
Check for Leaks		X					
Clean Air Intake Screen		X					
Clean Air Cleaner Precleaner			X				
Clean Air Cleaner Element					X		
Clean Cooling Fins					X		
Change Oil and Filter	X	See engine manufacturer's manual					
Check/Replace Spark Plugs						X	
HYDRAULICS							
Check for Leaks		X					
Check/Top up Oil Level					X		
Change Oil and Filter	X						X
MACHINE							
Check Interlock Operation		X					
Check Tire Pressures		X					
Check/Top up Battery					X		
Lubricate All Points				X			

MAINTENANCE RECORD

This image shows a blank sheet of white paper with horizontal ruling lines. The lines are evenly spaced and extend across the width of the page. There are no margins, text, or other markings on the paper.

7

CHECK DAILY

Operator Presence Interlock System - Start Operation

For the engine to crank, the parking brake must be on, the PTO (blades) off and traction levers in the neutral lock position. Sit in the seat and check, one by one, if the engine will crank with the parking brake off, the blades on, and either traction lever out of neutral lock. Also, make sure engine coolant temperature gauge light flashes upon turning key to the **ON** position.

Operator Presence Interlock System - Run Operation

The operator must be in the seat for the engine to run with the parking brake off, the traction levers moved out of the neutral lock position, or the blades on. To check:

1. Start the engine and run at 1/2 throttle with the operator on the machine but raised off the seat.
2. One by one: move the parking brake to the "OFF" position, traction levers out of the neutral lock position (check each independently), and turn the blades on. Each check should kill the engine after 1/2 second. (A 1/2 second delay is built into the system to prevent engine cutout when traversing rough terrain.)

Repair machine before using if the Operator Presence Interlock System does not operate correctly in start or run. Contact your authorized Bunton dealer.

Hardware

Tighten any nuts and bolts found loose. Replace any broken or missing cotter pins. Repair any other problems before operating.

Tire pressure

Tires should be kept inflated at 14 lbs/in² (1.0 kg/cm²). Improper tire inflation can cause rapid tire wear and poor traction. Uneven inflation can cause uneven cutting.

Battery

Check the electrolyte level at each oil change as follows:

1. Stop engine and remove key.
2. Remove battery vent caps. The electrolyte level should reach the bottom of the vents.
3. Top up, if necessary, with distilled water.
4. Replace vent caps.

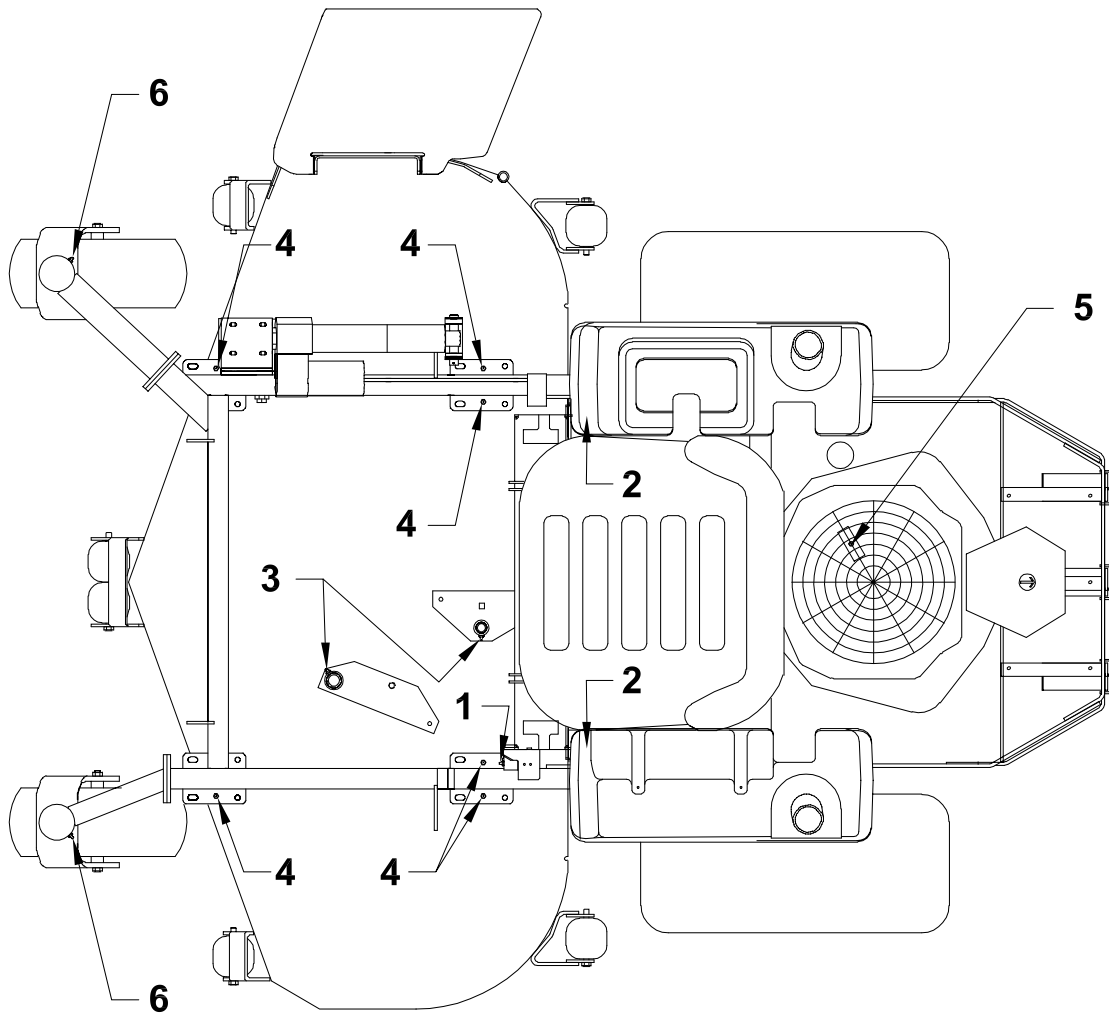

LUBRICATION

Every 50 hours of operation, lubricate the following points (1-5) with grease:

1. Brake lever pivot (1 point)
2. Push arms (2 points located at rear of cutterdeck under each fuel tank)
3. Deck idler pivot bearings (2 points)
4. Deck lift pivots (6 points)
5. Hydro belt tensioner (1 point under engine deck)
6. Caster wheel pivots (2 points)
(Lubricate every 500 hours or once a year)

NOTE ON BLADE SPINDLES - The blade spindles on these machines use a superior sealed bearing that does not require relubrication.

HYDRAULIC SYSTEM

After the first 5 hours of operation, fluid level in the hydraulic system should be checked every 100 hours or when a leak has occurred. If the fluid is low, check all components for leaks.

To check, remove reservoir cap **M**. The fluid level should be at the bottom of the filler tube. If low, top up (do not overfill). Use one of the oils listed below:

- SAE 15W40 motor oil
- SAE 20W50 motor oil
- 15W50 synthetic motor oil

AFTER FIRST FIVE (5) HOURS

1. Remove plug **N** to drain hydraulic reservoir. Dispose of used oil in accordance with local requirements.
2. Clean and replace the plug.
3. Change hydraulic oil filter **G**.
4. Fill the reservoir with fresh oil to the bottom of the reservoir filler tube, using an oil from the list above. Do not overfill.

PERIODIC OIL CHANGES

Change the hydraulic fluid and hydraulic filter after each 500 hours of operation using the same procedure given above.

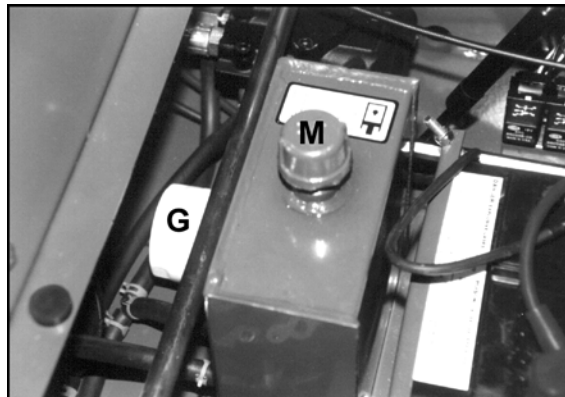

View from right side

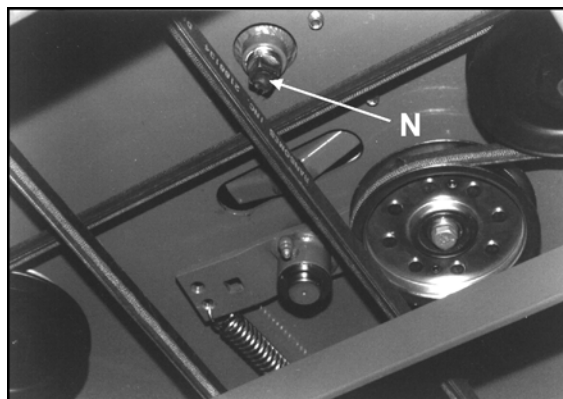

View from below machine

NOTES:

Before servicing the hydraulic system, stop the engine, disconnect spark plug wires and disengage the PTO.

- After any hydraulic line is opened, plug or cap it promptly to reduce the risk of contamination.
- Do not use teflon tape on hydraulic pipe fittings. Use a liquid sealant that will dissolve into the system.
- Make sure all hydraulic connections are tight and hydraulic hoses and lines are in good condition before applying pressure to system.

WARNING

The machine's hydraulic system operates under high pressure. When checking for leaks, do not use your hands to attempt to find a leak. Instead, use cardboard or paper. Escaping hydraulic fluid can be under sufficient pressure to penetrate skin and cause serious injury. If hydraulic fluid is injected into the skin, it must be promptly removed by a doctor familiar with this form of injury or gangrene may result.

ENGINE OIL

Do not perform engine maintenance without the engine off, spark plug wires disconnected and PTO disengaged.

AFTER FIRST FIVE (5) HOURS

While the engine is warm:

1. Remove drain cap **D** and drain the crankcase. Dispose of used oil in accordance with local requirements.
2. Clean and replace the cap.
3. Change oil filter.
4. Fill the crankcase with fresh oil to the full mark. Do not overfill. See engine manual for oil specifications.

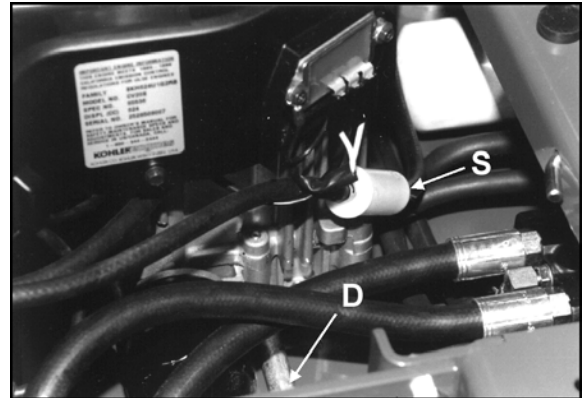

DAILY

1. Check oil level with the dipstick.
2. If oil is needed, add fresh oil of proper viscosity and grade. See engine manual for oil specifications. Do not overfill.
3. Replace dipstick before starting engine.

PERIODIC OIL CHANGES

1. See engine manual for oil and filter change intervals after the break-in period.
2. Follow instructions for first oil change, above.

FUEL FILTER

An inline fuel filter **S** is located at the right side of the engine. Inspect at every oil change to make sure it is clean and unobstructed. Replace if dirty.

SPARK PLUGS

Remove each plug and check condition.

- Good operating conditions are indicated if the plug has a light coating of grey or tan deposit.
- A white blistered coating indicates overheating. A black coating indicates an “over rich” fuel mixture. Both may be caused by a clogged air cleaner or improper carburetor adjustment.
- Do not sandblast, wire brush or otherwise attempt to repair a plug in poor condition. Best results are obtained with a new plug.
- Set plug gap as specified in engine manual.

DUAL ELEMENT AIR CLEANER

The air cleaner with this engine has a high density paper air cleaner cartridge surrounded by an oiled, foam precleaner element. Both should be inspected regularly and maintained.

Clean and re-oil precleaner element every 25 hours (more often under dusty conditions).

1. Disassemble air cleaner cover.
2. Remove precleaner by sliding it off the paper cartridge.
3. Wash precleaner in kerosene or liquid detergent and water.
4. Wrap precleaner in cloth and squeeze to remove cleaner.
5. Saturate precleaner in engine oil. Squeeze to remove excess oil.
6. Re-install precleaner over paper cartridge. Reassemble air cleaner components and screw assembly down tight.

Every 100 hours (more often under very dusty or dirty conditions), check the paper cartridge.

- Clean by tapping gently.
- Do not wash the cartridge or use compressed air which can cause damage.
- Replace when cartridge is dirty, bent or damaged.

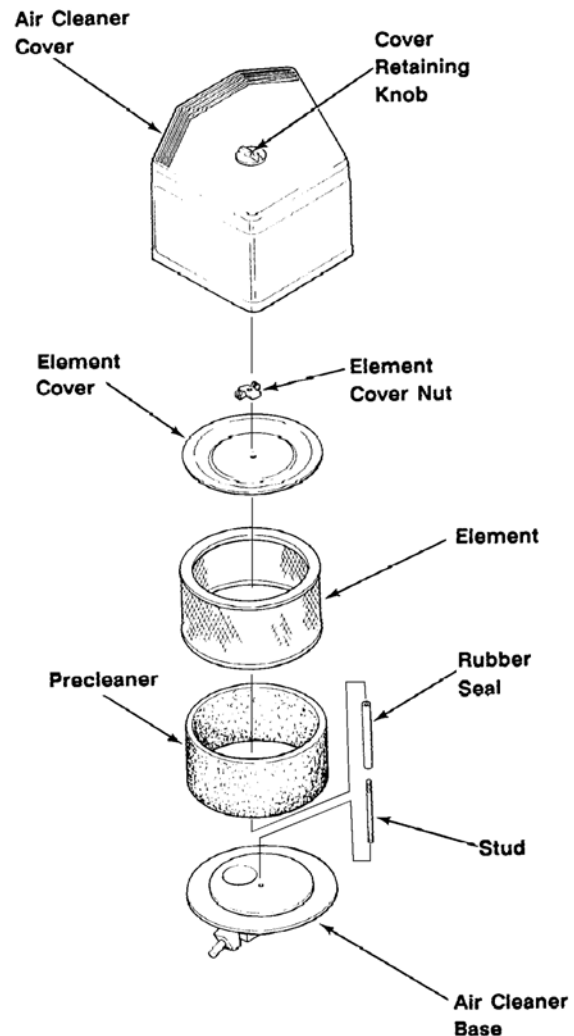

ENGINE COOLING

Continued operation with a clogged cooling system will cause severe overheating and can result in engine damage.

- **Daily:** Clean air intake screen **S**.
- **Every 100 hours:** Clean cooling fins beneath blower housing **H** with reference to information in the engine manufacturer's manual.

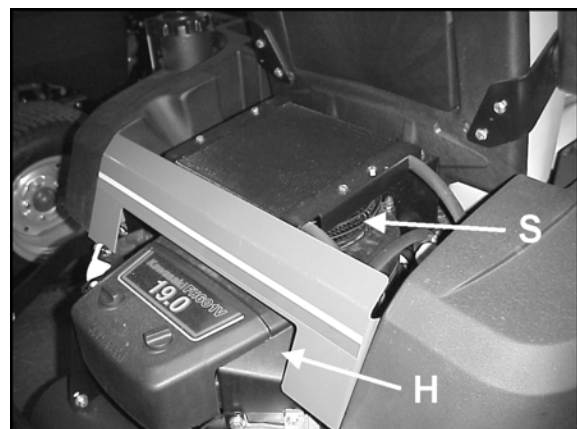

BLADE REMOVAL

Follow these instructions to prevent injury during blade removal:

1. Loosen with a box wrench or a socket and long breaker bar. To gain additional leverage, slip a long pipe or thick-walled tube over breaker bar or wrench.
2. Insert wood block **A** as shown, with grain perpendicular to blade, to prevent blade from turning when loosening.
3. Wear thickly padded gloves. Keep hands clear of blade path. Blades may rotate when bolt releases.

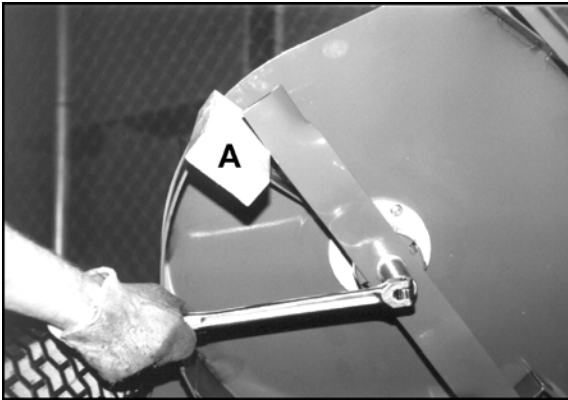

SHARPENING

Blades may be sharpened by filing or grinding.

- Inspect blades before sharpening.
- Replace bent or cracked blades.
- Replace blades when the lift portion has worn thin.
- Maintain cut angle at 30°.
- Do not overheat blades when sharpening.
- Always use Bunton blades. Use of another manufacturer's blades may be dangerous.

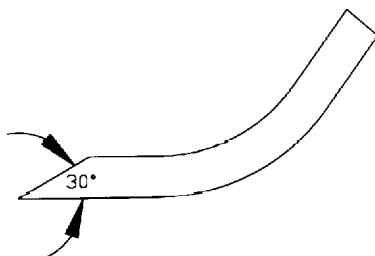

BLADE BALANCE

Blade balance must be maintained at 5/8 oz-in (19.4 g-cm) or less. Failure to keep blades balanced causes excess vibration, wear, and shortened life of most components of the machine.

To balance a blade:

1. Sharpen blade first.
2. Balance the blade at the center.
3. Attach a 1/8 oz (3.9 g) weight at a distance 5" (127 mm) from center on the light end. This should make the light end the heavy end:
 - If it does, the blade is balanced.
 - If does not, file or grind the heavy end until the addition of the weight makes the light end the heavy end.

BLADE INSTALLATION

1. Wear thickly padded gloves to prevent cuts from the sharp blade.
2. Insert the blade bolt, in order, through the conical washer (cup side toward the blade, as shown), the blade, and the blade spacer.
3. Install assembly on the blade spindle.
4. Torque the blade bolt to 70 ft-lbs.

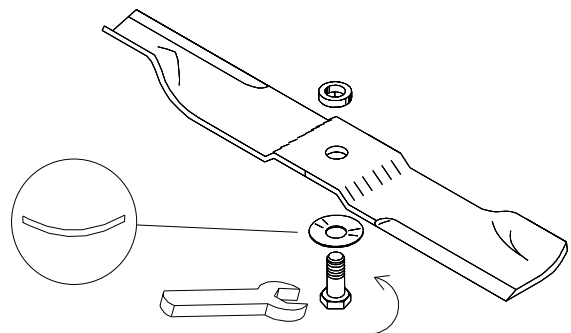

ENGINE COOLING-LIQUID COOLED

Continued operation with a clogged cooling system will cause severe overheating and can result in engine damage.

Remove air intake cover **S** by releasing the four latches **T**.

- **Daily:** Clean air intake cover **S**.
- **Daily:** Check coolant level at reservoir **I**.
- **Every 100 hours:** Clean cooling fins **H** and radiator **J** with reference to information in the engine manufacturer's manual.

WARNING

Do not open hot. Radiator is under pressure.
Remove cap slowly to avoid bodily injury.

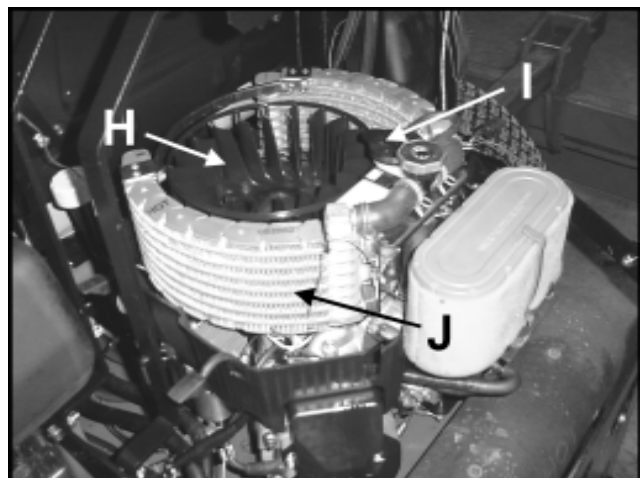
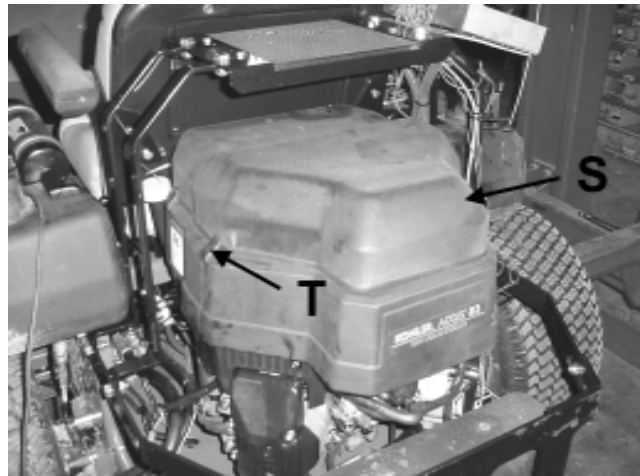

LIQUID COOLED DUAL ELEMENT AIR CLEANER

The air cleaner with this engine has a high density paper air cleaner cartridge surrounded by an oiled, foam precleaner element. Both should be inspected regularly and maintained.

Clean and re-oil precleaner element every 25 hours (more often under dusty conditions).

1. Remove air intake cover **S** by releasing the four latches **T**.
2. Disassemble air cleaner cover **A** by removing latch **B**.
3. Remove precleaner **C** by sliding it off the paper cartridge **D**.
4. Wash precleaner in kerosene or liquid detergent and water.
5. Wrap precleaner in cloth and squeeze to remove cleaner.
6. Saturate precleaner in engine oil. Squeeze to remove excess oil.
7. Re-install precleaner over paper cartridge. Reassemble air cleaner components and replace cover. Secure latch back in place.

Every 100 hours (more often under very dusty or dirty conditions), check the paper cartridge.

- Clean by tapping gently.
- Do not wash the cartridge or use compressed air which can cause damage.
- Replace when cartridge is dirty, bent or damaged.

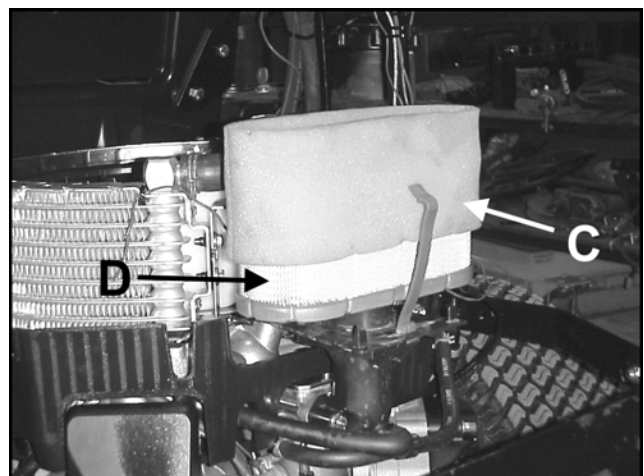
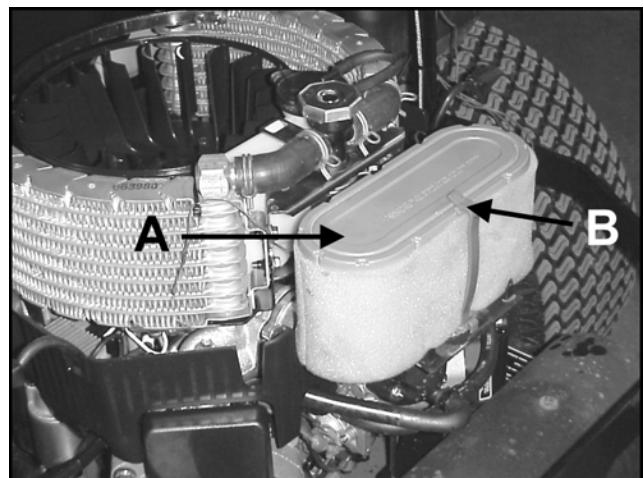
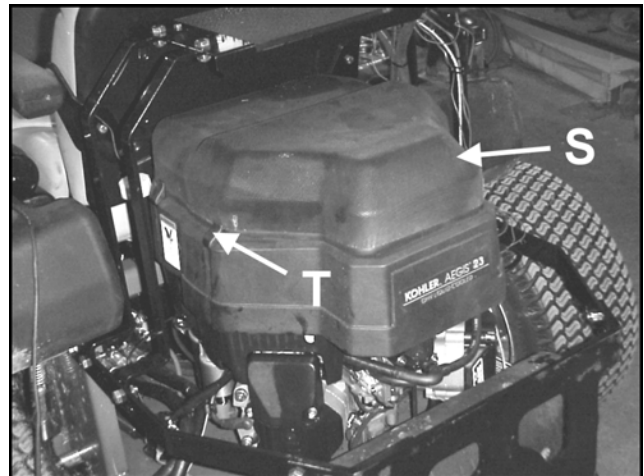

HEIGHT OF CUT

The height of cut is set by moving height of cut pin **N** to the hole designated for the height of cut desired.

To change the height of cut:

1. Raise the deck to the highest position.
2. Move pin **N** to the selected hole.
3. Lower the deck until the lift lever is stopped by the pin.

NOTES:

- Height of cut may vary due to the amount of tread on the tires, tire diameter or inflation pressure.
- For best results, adjust the rear deck rollers for the height of cut to be used (see below).



REAR DECK ROLLERS

The rear outside deck rollers are adjustable up and down to provide improved deck flotation and scalping protection at various heights of cut. They are not intended to ride continuously on the ground. Adjust no closer than 3/8" (10mm) to the ground.

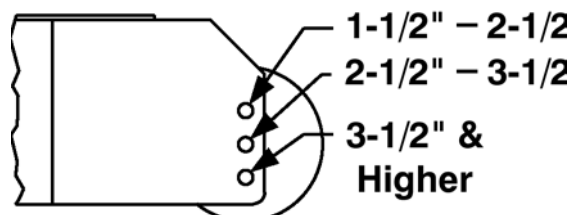

Height of cut ranges for roller adjustment

PUSH ARMS

The push arm rod ends must be adjusted evenly to:

- locate the deck perpendicular to the front-to-rear axis of the machine; and
- so the notch at the front of the engine deck clears the push arm bracket on the rear of the cutterdeck when the cutterdeck is raised to the transport position.

Adjust the rod end length to 1-7/16" (37 mm) to start. If any additional adjustment is required, adjust both rod ends so the same number of threads show.

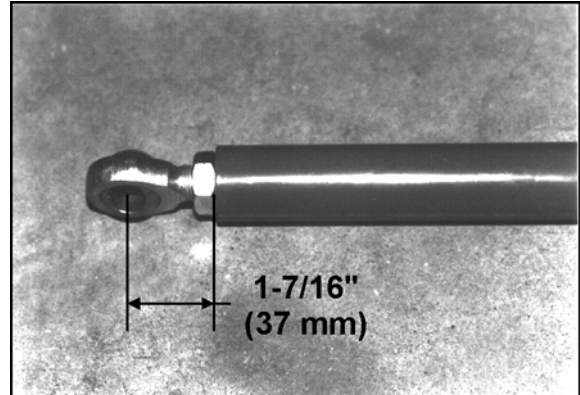

BELTS

All belts are tensioned by spring loaded idlers. No adjustment is required.

DECK LEVELING

NOTE: These instructions are in regards to both sides of the deck.

To level deck:

1. Park the machine on a smooth, level surface. Remove the height of cut pin **A** and raise the cutterdeck to the 3" height of cut position.
2. Locate (2) 3" tall blocks just inside the front rollers and (2) 2-7/8" tall blocks just inside the rear rollers.
3. Lower the deck until it is resting on the blocks and there is plenty of float for the actuator **B**.
4. Loosen the jamnuts on the height of cut clips. Adjust the thread rolling screws **C** on the front and rear chains until the chains just become tight. Tighten the jamnuts against the clips.

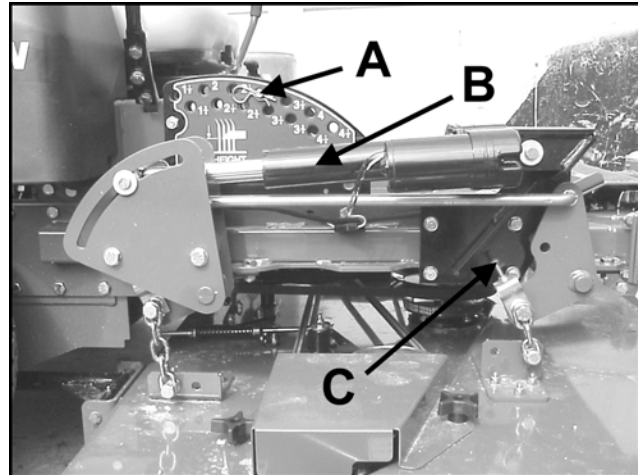

PARKING BRAKE

Start with parking brake **N** in the OFF position.

1. Adjust the parking brake rod to provide a distance of 14-3/16" between pin **K** and pin **L**.
2. Disconnect one end of rods **M** (at brakes on both sides of the machine).
3. Move the parking brake lever to the ON position.
4. Adjust rods **M** on each brake to be 3/4" short of connecting to the spring when all the slack is taken out of the brake linkage and brake lever **N**.
5. Move the parking brake to the OFF position and reconnect rods **M**.

This adjustment will cause the brake springs to stretch 3/4" when the brake is in the ON position to provide the correct parking brake force without overloading the brake.

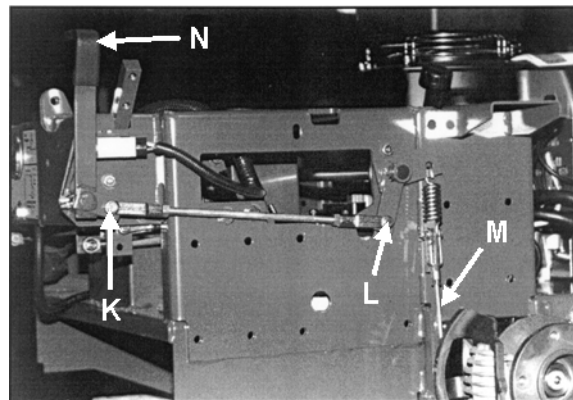

Parking brake assembly (fuel tank, tire and deck not shown for clarity - brake in ON position).

HYDROSTAT ADJUSTMENTS

A turnbuckle-style hydrostat neutral adjustment is provided.

Neutral:

1. Support the machine with the rear wheels off the ground. Use jackstands or equivalent support. Do not rely only on mechanical or hydraulic jacks.
2. Move the traction levers out into the neutral lock position and raise the seat.
3. Disconnect the seat switch and temporarily connect the two terminals with jumper wire **J** as shown.
4. Start the engine and run at low speed.
5. Loosen jam nuts **T** at both ends of the turnbuckle.
6. Rotate the turnbuckle until the corresponding wheel stops turning. Lock the turnbuckle jam nuts. Run the engine up to high idle to check the adjustment. Readjust if necessary.
7. Repeat steps 5 and 6 for the opposite side.
8. Remove the jumper wire and reconnect the seat switch.

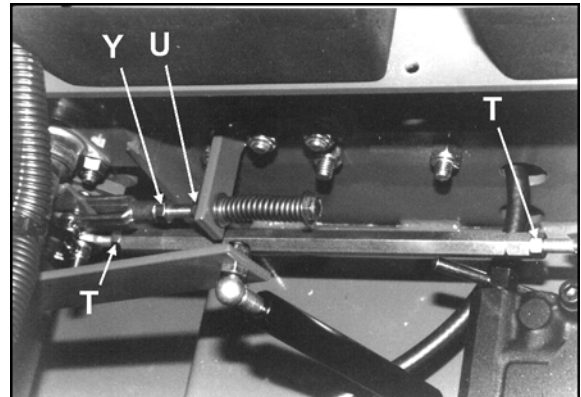
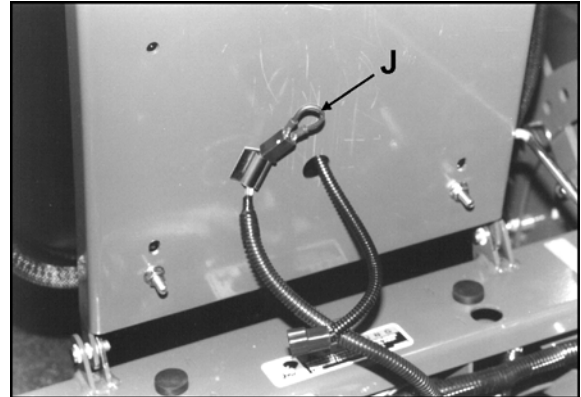

Right side adjustments
(wiring harness and seat rod removed for clarity)

Reverse Return:

1. Move traction levers out to the neutral lock position and raise the seat.
2. Locknut **U** should be run on the bolt as far as it will go.
3. Loosen jam nut **Y**. Adjust the clevis yoke by turning the head of the bolt until the clevis pin just makes contact with the rear of the slot in the lever it connects with. Tighten jam nut **Y**.
4. Repeat steps 2 and 3 for the opposite side.

NOTE: A slight creep in reverse is acceptable provided the wheel does not turn and the hydrostat pump does not whine when the parking brake is on.

Note: Always use Bunton replacement belts, not general purpose belts. Bunton belts are specially designed for use on commercial mowers and will normally last longer.

ENGINE-CUTTERDECK (PTO) BELT

1. Set the cutterdeck in the lowest height-of-cut position.
2. Attach a short extension to a 3/8" drive ratchet. Insert the ratchet extension into the square hole in the idler arm and use the ratchet to rotate the idler assembly enough to remove the belt. Remove the belt from the idlers and center cutterdeck pulley. Push belt back under engine deck.
3. Disconnect the electric clutch from the wire harness at plug **P**.
4. Remove the carriage bolts securing torque restraint **Q** to clutch **R**. Remove torque restraint.
5. Remove old belt from the machine.
6. Install a new belt by performing the these steps in reverse order.

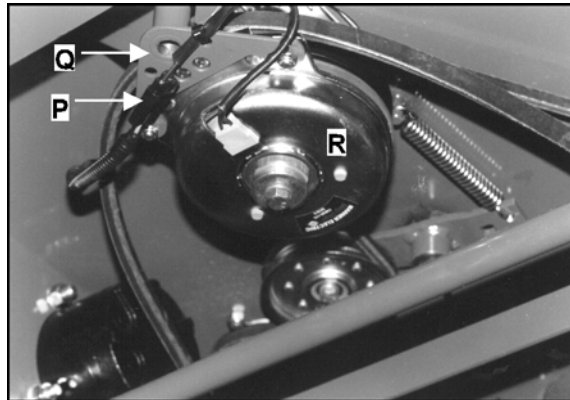
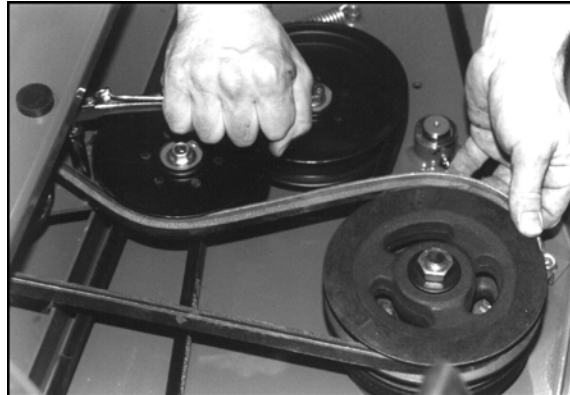

CUTTERDECK BELT

1. Set the cutterdeck in the lowest height-of-cut position.
2. Remove the engine-cutterdeck belt from the deck idlers and pulley (see engine-cutterdeck belt replacement). Push it aside but don't remove it from the machine.
3. Run the cutterdeck belt off the idler as shown. Remove it from the deck.
4. Install the new belt by performing these steps in reverse order. Take care to get the new belt on the correct side of the belt guides.
5. Re-install engine-cutterdeck belt (see engine-cutterdeck belt replacement).

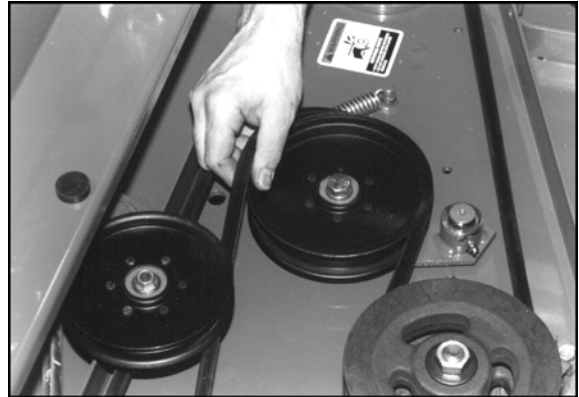

PUMP-DRIVE BELT

1. Remove engine-cutterdeck belt (see engine-cutterdeck belt replacement).
2. Attach an extension to a 3/8" drive ratchet. Insert the ratchet extension in the square hole of the pump drive idler arm. Use the ratchet handle to rotate it enough to remove the pump drive belt.
3. Install a new pump drive belt in the same manner as it was removed.
4. Re-install engine-cutterdeck belt (see engine-cutterdeck belt replacement).

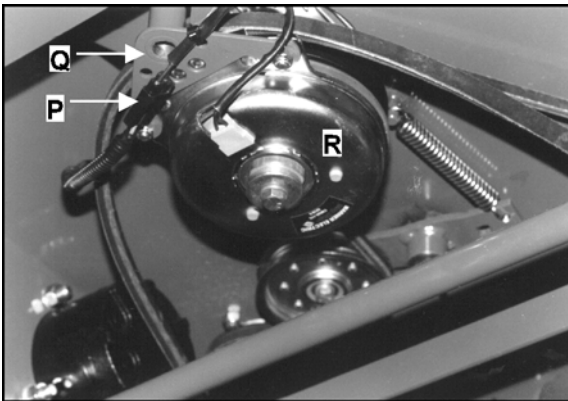

POWER UNITS

ENGINES :

Construction: Aluminum block with cast-in cast iron sleeves. Aluminum head.

Configuration: 4-stroke, vertical shaft, V-twin cylinder, overhead valve, air-cooled, or liquid cooled.

DRIVE SYSTEM:

Full hydrostatic pump and wheel motor combination for independently controlled drive wheels.

Pump: Hydrogear BDP-10L 10cc variable displacement piston pump.

Motors: Parker/Ross 15 cu.in. displacement MB series. Direct drive 1-1/4" (31.8mm) diameter output shaft.

Turn Radius: 0"

OPERATOR PRESENCE INTERLOCK SYSTEM:

Start: The PTO (blades) must be off, traction levers in neutral lock, and parking brake on for engine to crank.

Run: Operator must be in seat to take parking brake off, to move traction levers out of the neutral lock position, or to turn the PTO (blades) on or the engine will kill. The parking brake must be off for the traction levers to move out of the neutral lock position.

The operator may leave the seat with the engine running if the parking brake is on, the PTO (blades) is off, and the traction levers are in the neutral lock position. A time delay eliminates annoying engine cutout from operation over rough terrain.

CONTROLS:

Throttle; choke; power takeoff (PTO) clutch switch; traction levers; parking brake lever; lift lever.

FUEL SYSTEM:

One tank on each side of operator, each with a shutoff (1/4 turn). Total capacity 9-1/2 gallons (40 liters). Fuel selector/shutoff switch on front panel (1/4 turn). Replaceable fuel filter.

MAXIMUM GROUND SPEEDS:

Forward: 8 mph (12.9 km/h)

Reverse: 4 mph (6.4 km/h)

WHEELS & TIRES:

Drive wheels: 23x10.50-12 4-ply turf tread tires

Casters: 13x5.00-6 4-ply rib tread tires

Pressure: 14 p.s.i. (1 kg/cm²)

BRAKING:

Hayes disc type parking brakes. Spring applied for overload protection.

SEAT:

High back, foam padded suspension seat with standard armrests. Fore and aft adjusters, hinged for easy tilt-up access to pumps and battery. Prop rod to hold in up position. Internally mounted seat switch.

WEIGHT:

1025 lbs (465 kg)

BZT 2000 Series

SPECIFICATIONS

ENGINES				
MODEL NUMBERS	642220, 642221	642222, 642223	642233	642227, 642228
MANUFACTURER	Kawasaki	Kawasaki	Kawasaki	Kohler
MODEL	FH601V	FH680V	FH721V	LV675S
CYLINDERS	2	2	2	2
COOLING	Air	Air	Air	Liquid
BORE/STROKE	3.03 X 2.64" (77 X 67 mm)	2.96 X 2.99" (75.2 X 76 mm)	2.96 X 2.99" (75.2 X 76 mm)	3.15 X 2.64" (80 x 67mm)
DISPLACEMENT	38.1 cu.in. (624 cc)	41.2 cu.in. (675 cc)	41.2 cu.in. (675 cc)	41.1 cu. in. (674cc)
COMPRESSION	8.5:1	8.1:1	8.1:1	8.5:1
OUTPUT POWER	19 hp (14.2 kw) @ 3600 rpm	23 hp (17.2 kw) @ 3600 rpm	25 hp (18.4 kw) @ 3600 rpm	23hp (17.2kw) @ 3600 rpm
OUTPUT TORQUE	37.0 ft-lb (50.2 J) @ 2500 rpm	39.8 ft-lb (54.0 J) @ 2400 rpm	41.3 ft-lb (56.0 J) @ 2400 rpm	32.0 ft-lb (43 J) @ 2400 rpm
LUBRICATION	FULL PRESSURE	FULL PRESSURE	FULL PRESSURE	FULL PRESSURE
GOVERNOR	Mechanical	Mechanical	Mechanical	Mechanical
AIR CLEANER	Dual element	Dual element	Dual element	Dual Element
IGNITION SYSTEM	Electronic	Electronic	Electronic	Electronic
CHARGING SYSTEM	15 amp, regulated	13 amp, regulated	13 amp, regulated	15 amp, regulated
BATTERY	BCI group U1	BCI group u1	BCI group u1	BCI group u1
FUSES	Two, 20 amp blade	Two, 20 amp blade	Two, 20 amp blade	Two, 20 amp blade
FUEL CONSUMPTION @ MAX LOAD/ SPEED	1.7 gal./hr (6.5 l/hr)	2.1 gal./hr (8 l/hr)	2.0 gal./hr (7.6 l/hr)	1.6 gal./hr (6.1 l/hr)

FLUID CAPACITIES	QUANTITY	TYPE	FILTER
FUEL	9.5 gal. (40 l)	REGULAR, UNLEADED GASOLINE	REPLACEABLE
ENGINE OIL	2.1 qts (2 l) KOHLER 2.0 qts (1.9 l) KAWASAKI	SAE 10W30	SPIN-ON REPLACEABLE
HYDRAULIC OIL	2.6 qts (2.46 l)	SAE 15W40 MOTOR OIL SAE 20W50 MOTOR OIL 15W50 SYNTHETIC	10 MICRON SPIN-ON REPLACEABLE
COOLANT (Where Applicable)	1.48 qts (1.4 l)	50/50 MIX OF WATER AND ETHYLENE GLYCOL	N/A

CUTTERDECKS			
MODEL NUMBER	642220	642221, 642222 642227	642223, 642233 642228
TYPE	Side Discharge	Side Discharge	Side Discharge
CUTTING WIDTH	47.25" (120 cm)	52.5" (133 cm)	61" (155 cm)
WIDTH	N/A	N/A	N/A
WIDTH (CHUTE UP)	54" (137 cm)	56.25" (143 cm)	62" (157 cm)
WIDTH (CHUTE DOWN)	59" (150 cm)	64.5" (164 cm)	73" (185 cm)
CUTTING UNIT	One high lift blade (low lift optional)	One high lift blade (low lift optional)	One high lift blade (low lift optional)
NUMBER OF CUTTING UNITS	3	3	3
BLADE LENGTH	16.25" (41 cm)	18" (46 cm)	21" (53 cm)
BLADE THICKNESS	.205" (5.2 mm)	.205" (5.2 mm)	0.25" (6.35 mm)
TIP SPEED	16784 ft/min 5116 m/min	15694 ft/min 4784 m/min	18310 ft/min 5580 m/min
DAILY PRODUCTION (8 hr @ 6 mph)	Up to 22.9 acres (9.3 ha)	Up to 25.5 acres (10.3 ha)	Up to 29.5 acres (11.9 ha)

CONSTRUCTION:

Fabricated and welded or bolted 10-gauge, double-layer steel top with 7-gauge side skirts. Full floating design.

CUTTERDECK DRIVE SYSTEM:

Electric clutch/brake drives belt directly from engine to center spindle of cutterdeck. No twists in drive belt.

SPINDLES:

Top mounted and maintenance free, with 1" shaft in precision machined, aluminum housing

SPECIFIC TORQUES

BLADE BOLT TORQUE: 70 FT-LBS (95 Nm)

WHEEL HUB NUTS: 225 FT-LBS (237 Nm)

ENGINE CRANKSHAFT BOLT: 50 FT-LBS (68 Nm)

ANTI-SCALP ROLLERS:

48" Cutterdecks - 3 Rollers

52" Cutterdecks - 7 Rollers

61" Cutterdecks - 8 Rollers

CUTTING HEIGHT & PRODUCTION:

Height: Spring assisted lift lever allows easy setting of cut heights from 1-1/2" to 4-1/2" in 1/4" increments. "Set and forget" feature allows height of cut to be set and returned to without searching from operator position.

NOTE: 48" cutterdecks do not use spring assisted lift levers.

PARTS SECTION

UPPER ENGINE DECK ASSY

**BZT 2000
Series**

FIGURE 1

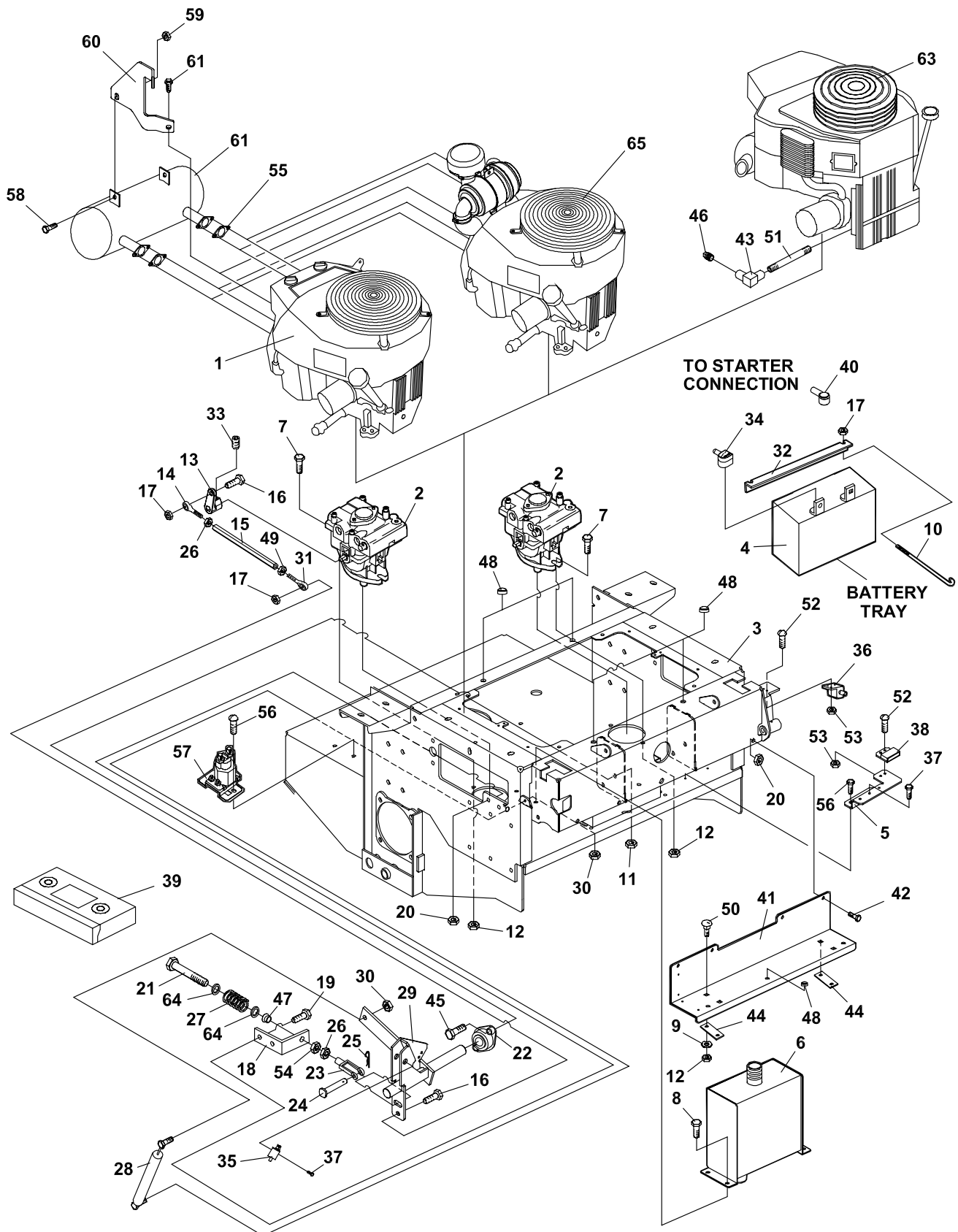

BZT 2000 Series

2722089-01

UPPER ENGINE DECK ASSY

FIGURE 1

ITEM	PART NO.	DESCRIPTION	QTY	ITEM	PART NO.	DESCRIPTION	QTY
1-1	2720607	ENGINE-KAWASAKI FHV	19 1	1-45	64123-15	BLT-HEX 3/8-16X3/4	8
	4114746	FILTER-AIR KAWASAKI	1	1-46	69051-01	PLUG-PIPE 3/8"	1
	4114747	FILTER-PRE KAWASAKI	1	1-47	38304-02	S BRG FLGD PLASTIC	2
	2722214	FILTER-OIL	1	1-48	810149	BUMPER-RUBBER	7
	38666	FILTER-FUEL	1	1-49	64025-33	NUT- 5/16-24 LH	2
1- 2	4121333	PUMP-HYDRO BDP-10A-440	2	1-50	64243-02	BLT-CRG M10-1.5X20	4
	(SEE FIGURE 8 FOR BREAKDOWN)			1-51	48024-17A	NIPPLE-PIPE 3/8 X 5	1
1-3	2720997	S ENGINE DECK W/LABS	1	1-52	64152-46	SCR-SLT HH #10-24	2
1-4	108055	BATTERY	1	1-53	64025-15	NUT-HEX #10-24 KEPS	4
1-5	2722293.7	BRACKET-RELAY	1	1-54	64229-08	LOCKNUT-NYLON 5/16-24	4
1-6	2186211	S HYD RESERVOIR W/LAB	1	1-55	11060-9016	GASKET-MUFFLER	2
1-7	64263-013	BLT-FLG HD M10-1.5 X 30	4	(OBTAIN THROUGH KAWASAKI DEALER)			
1-8	64197-016	BLT-TR 3/8-16X1 1/2	4	(ITEMS 56-66 FOR USE WITH KAWASAKI ENGINES ONLY)			
1-9	64251-004	WSHR-M10	4	1-56	64152-23	BLT-THDFRM 1/4-20 X 3/8	4
1-10	831861	BOLT-BENT BATT. HOOK	2	1-57	38665	SOLENOID	1
1-11	64141-4	NUT-WLF 3/8-16	8	1-58	64263-007	BLT-FLG HD M8-1.25 X 20	2
1-12	64237-03	LOCKNUT-NYLON M10-1.5	8	1-59	64266-02	NUT-FL LOCK M8-1.25	2
1-13	4118430	ARM-PUMP	2	1-60	4118507.7	BRKT-MUFFLER RH	1
1-14	38369-02	ROD END BALL JOINT	2	*	4118508.7	BRKT-MUFFLER LH	1
1-15	2188140	TURNBUCKLE	2				
1-16	64205-003	BLT-MET M8-1.25 X 30	4	1-61	64263-002	BLT-FLG HD M6-1.0 X 16	4
1-17	64229-02	LOCKNUT-NYLON 5/16-18	4	1-62	2188226	ASSY-MUFFLER	1
1-18	2182405.7	BRKT-REVERSE RETURN	2				
1-19	A1104057	BLT-M10-1.50 X 25	4	(USE ITEMS 43, 46, 51, 63 & 64 ON LIQUID COOLED MODELS ONLY)			
1-20	64246-03	WIZ NUT-MET M10-1.5	8	1-63	2721980	ENGINE-KOHLER 23HP	1
1-21	64123-205	BLT-HEX 5/16-24 X 4	2		2722712	FILTER-AIR KOHLER	1
1-22	2188145	BEARING-SELF ALIGNED	4		2722711	FILTER-PRE KOHLER	1
1-23	38020N	CLEVIS-YOKE PLATE	2		842502	ELEMENT-KLR OIL FILTER	1
1-24	64188-02	PIN-CLEVIS 5/16 X 1	2		38666	FILTER-FUEL	1
1-25	64168-2	HAIRPIN COTTER	2				
1-26	64025-03	NUT-HEX 5/16-24	2	1-64	64163-55	WASHER .328X.75X14 GA	4
1-27	2188139	SPRING-COMPRESSION	2	1-65	4118350	ENG-KAW FHV 23 HDAC	1
1-28	2721246	DAMPENER	2		4118340	ENG-KAW FHV 25 HDAC	1
1-29	4112105.7	WLDMT-MTN CTRL RH	1		4114746	S-AIR FILTER PRIMARY	1
*	4112104.7	WLDMT-MTN CTRL LH	1		4114747	S-AIR FILTER SAFETY	1
1-30	64237-05	LOCKNUT-NYLON M8-1.25	4		2722214	FILTER-OIL	1
1-31	38369-01	ROD END BALL JOINT	2		38666	FILTER-FUEL	1
1-32	2182427.7	HOLD DOWN, BATTERY	1				
1-33	64192-06	SETSCR SQHD 5/16-18X3/4	2				
1-34	112386	BOOT, BAT TERM POS	1				
1-35	108208	SWITCH, DBL POLE	2				
1-36	2188156	SWITCH NONO DBL POLE	1				
1-37	64197-015	BLT-TDFM #10-32X1/2 TRX	7				
1-38	2188154	MODULE-DELAY	1				
1-39	2810586	VIDEO	1				
1-40	2308095	COVER-TERMINAL	1				
1-41	2182404.7	PLATE, KICK	1				
1-42	64205-007	BLT-M10-1.5x20	4				
1-43	2690033-01	ELBOW-3/8 PIPE, 90 DEG	1				
1-44	2188146	STRIP, WEAR	2				

*NOT ILLUSTRATED

LOWER ENGINE DECK ASSY/CLUTCH

BZT 2000
Series

FIGURE 2

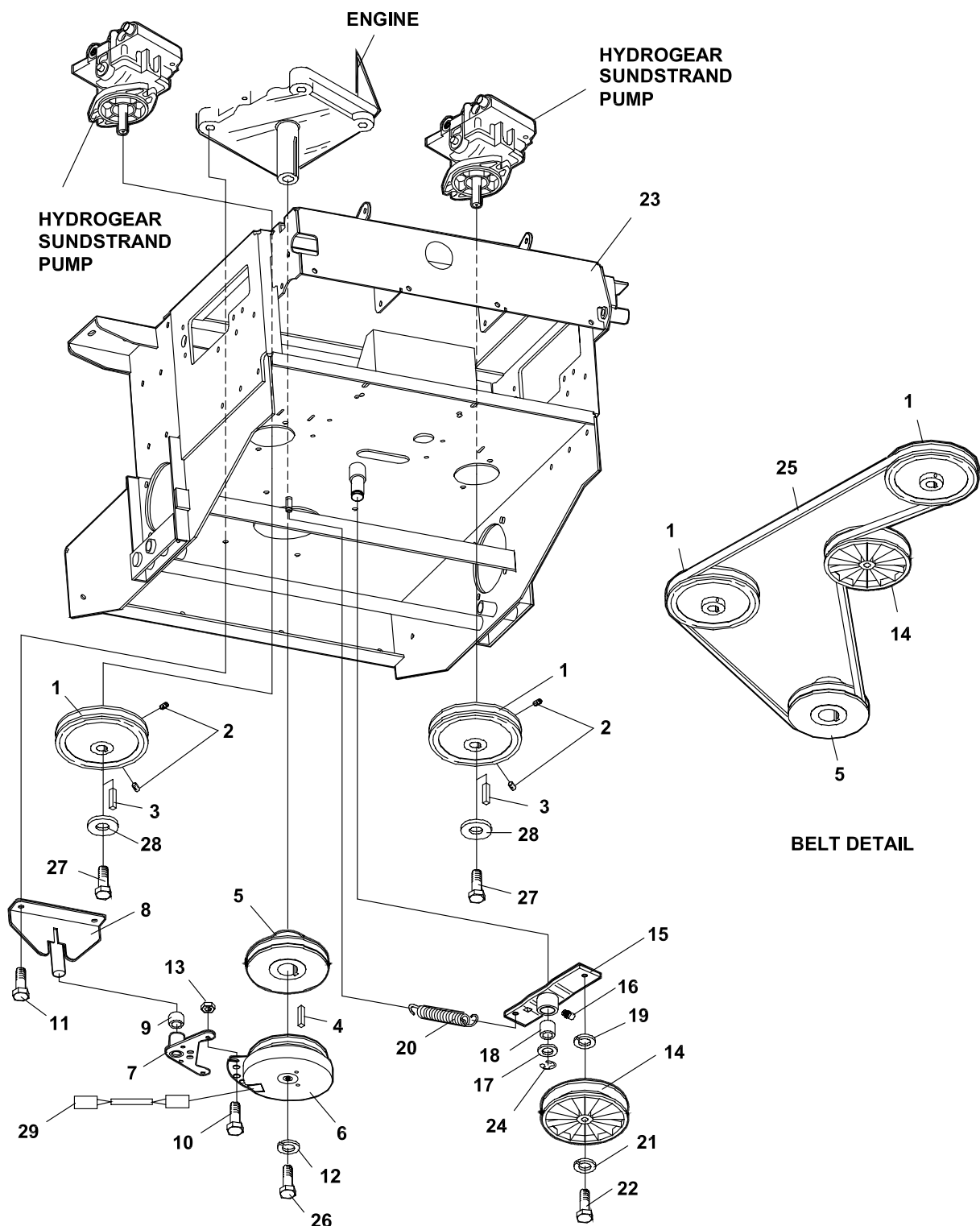

TORQUE TO 50 FT/LBS +/-10%

BZT 2000 Series

LOWER ENGINE DECK ASSY/CLUTCH

2722089-02

FIGURE 2

ITEM	PART NO.	DESCRIPTION	QTY	ITEM	PART NO.	DESCRIPTION	QTY
2-1	2722382	PULLEY-PUMP	2				
2-2	64044-1	SCREW-SET 1/4-20X1/4	4				
2-3	64238-03	KEY-MET 5mm SQX28mm	2				
2-4	64164-10	1/4X1/4X1 1/4 SQ END KEY	1				
2-5	4121339	PULLEY-4.25 ENGINE	1				
2-6	2721337	CLUTCH-ELECTRIC	1				
		(USE ON ALL MODELS EXCEPT 19HP)					
		(INCLUDES ITEMS 29 & 30)					
	2722016	CLUTCH-ELECTRIC 19HP	1				
		(USE ON 19HP MODELS ONLY)					
		(INCLUDES ITEMS 29 & 30)					
2-7	2721338.7	WLDMT-CLUTCH STOP	1				
		(USE ON ALL MODELS EXCEPT 19HP)					
	2721331.7	WLDMT-CLUTCH STOP	1				
		(USE ON 19HP MODELS ONLY)					
2-8	2186147.7	WLDMT-BRKT CLUTCH	1				
2-9	38304-03	BEARING-PLASTIC	1				
2-10	64205-001	BLT-MET M8-1.25X20	2				
2-11	64197-005	BLT-TR 3/8-16X1 1/4	4				
2-12	64006-06	LCKWSHR-HELICAL 7/16	1				
2-13	64265-04	NUT-FL NYL LOCK M8-1.25	2				
2-14	2308000	PULLEY-IDLER 4.00 E.O.D.	1				
2-15	2306082.7	WLDMT-IDLER ARM	1				
2-16	85010N	STRAIGHT ZERK FITTING	1				
2-17	64163-65	WASHER 18 GA	1				
2-18	65103A	BEARING-BUSHING	1				
2-19	33148-01	SPACER	1				
2-20	38219	SPRING-TENSION	1				
2-21	64006-03	LCKWSHR-HELICAL 3/8	1				
2-22	64123-21	BLT-HEX 3/8-24X1 1/4	1				
2-23	2720997	S ENGINE DECK WLABS	1				
2-24	64221-04	E-RING 0.875	1				
2-25	2188128	BELT-TRACTION DRIVE	1				
2-26	64123-155	BLT-HEX 7/16-20-3	1				
2-27	64205-013	BLT-MET M6-1X12	2				
2-28	64209-09	WASHER-CONICAL SPRING	2				
2-29	2720949	ASSY-CLUTCH WIRE	1				
2-30	* 4121560	KIT-BRAKE POLE RPLCMNT	1				

* NOT ILLUSTRATED

FIGURE 3

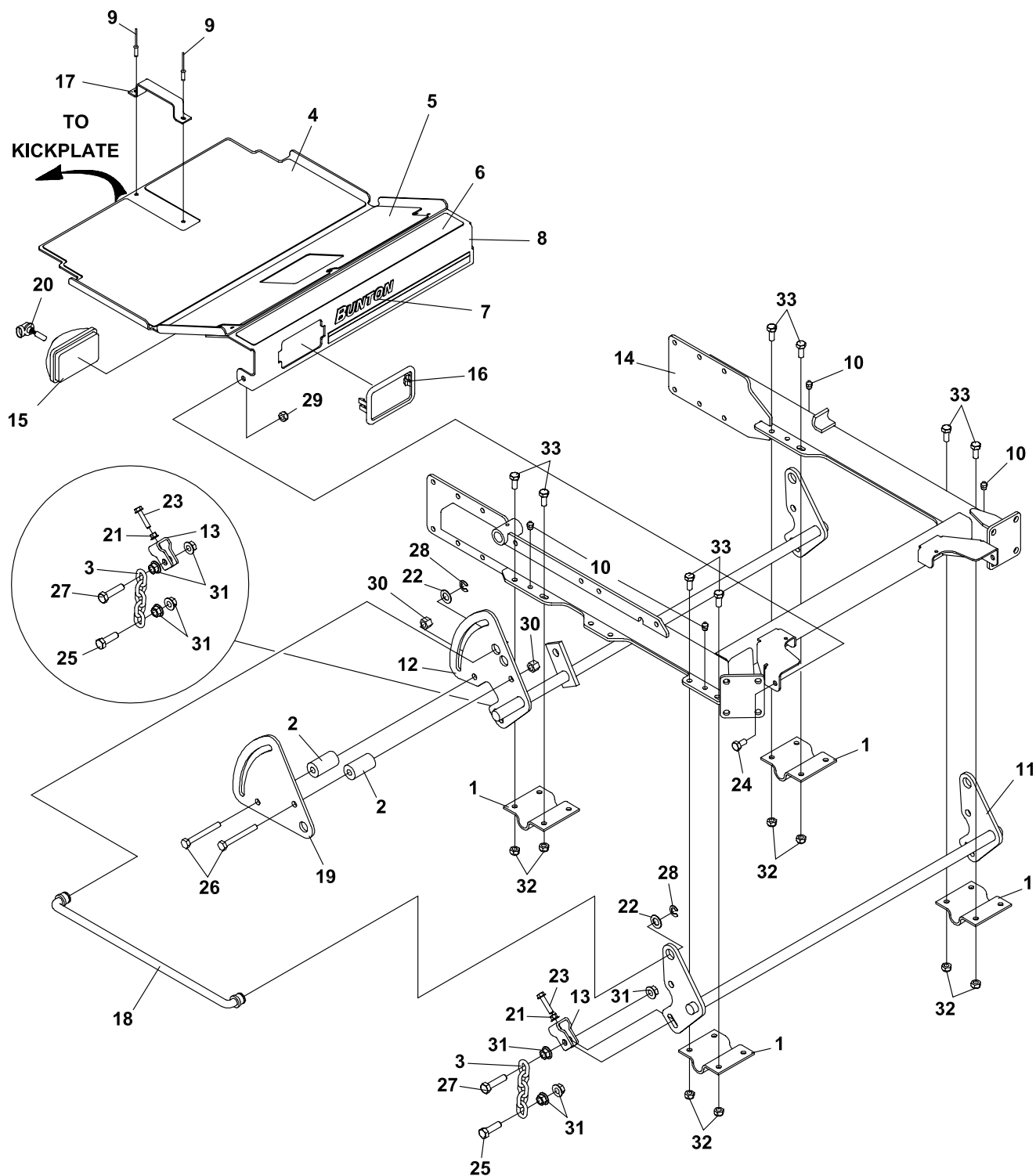

BZT 2000 Series

CRADLE ASSEMBLY

2722089-03

FIGURE 3

ITEM	PART NO.	DESCRIPTION	QTY	ITEM	PART NO.	DESCRIPTION	QTY
3-1	2182356.7	BRKT-SHAFT HANGER	4				
3-2	2183077	SPCR-DKLIFT ACTUATOR	2				
3-3	2188127	CHAIN-6.35 (.250) 5 LINKS	4				
3-4	2721859	MAT-FOOT PLATE LOWER	1				
3-5	2721860	MAT-FOOT PLATE MIDDLE	1				
3-6	2721861	MAT-FOOT PLATE UPPER	1				
3-7	2721992	LABEL-BUNTON STRIPE	1				
3-8	2721868	S-FOOT PLATE W/LABS	1				
	(INCLUDES ITEMS 4-6)						
3-9	64215-07	RIVET-POP IFI #84	2				
3-10	85051	ZERK-1/8 PIPE	6				
3-11	2722558.5	WLDMT-DECK LIFT, FRONT	1				
3-12	2722614.5	WLDMT-ELECTRIC LIFT	1				
3-13	2722630	CLIP-DECK HEIGHT ADJ	4				
3-14	2722723.5	WLDMT-CRADLE	1				
3-15	3010329	LAMP-FLOOD 12V	1				
3-16	3010330	KIT, SNAP MOUNT BEZEL	1				
3-17	32418-04	HANDLE W/SLOT	1				
3-18	4109960	ROD-DECK LIFT	2				
3-19	4112962.5	PLATE-DECK LIFT OUTER	1				
3-20	5003693	S-894 12V BULB	1				
3-21	64141-2	NUT-WLF 1/4-20	4				
3-22	64163-65	WSHR.890X1.375X18GA	8				
3-23	64197-020	BLT-TDFM 1/4-20X1-1/2	4				
3-24	64205-007	BLT MET M10-1.50X20	2				
3-25	64205-029	BLT-MET M12X1.75X40	4				
3-26	64263-022	BLT-FLG HD M12-1.75 X 90	2				
3-27	64205-060	BLT-MET M12-1.75X50	4				
3-28	64221-04	E-RING .875	4				
3-29	64237-03	LOCKNUT-NYLON M10-1.5	2				
3-30	64265-06	NUT-FL NYL LOCK M12-1.75	2				
3-31	64246-04	NUT-WHIZ M12-1.75	16				
3-32	64265-05	NUT-FL NYL LOCK M10-1.5	15				
3-33	64263-013	BLT-FLG HD M10-1.5 X 30	15				

FIGURE 4

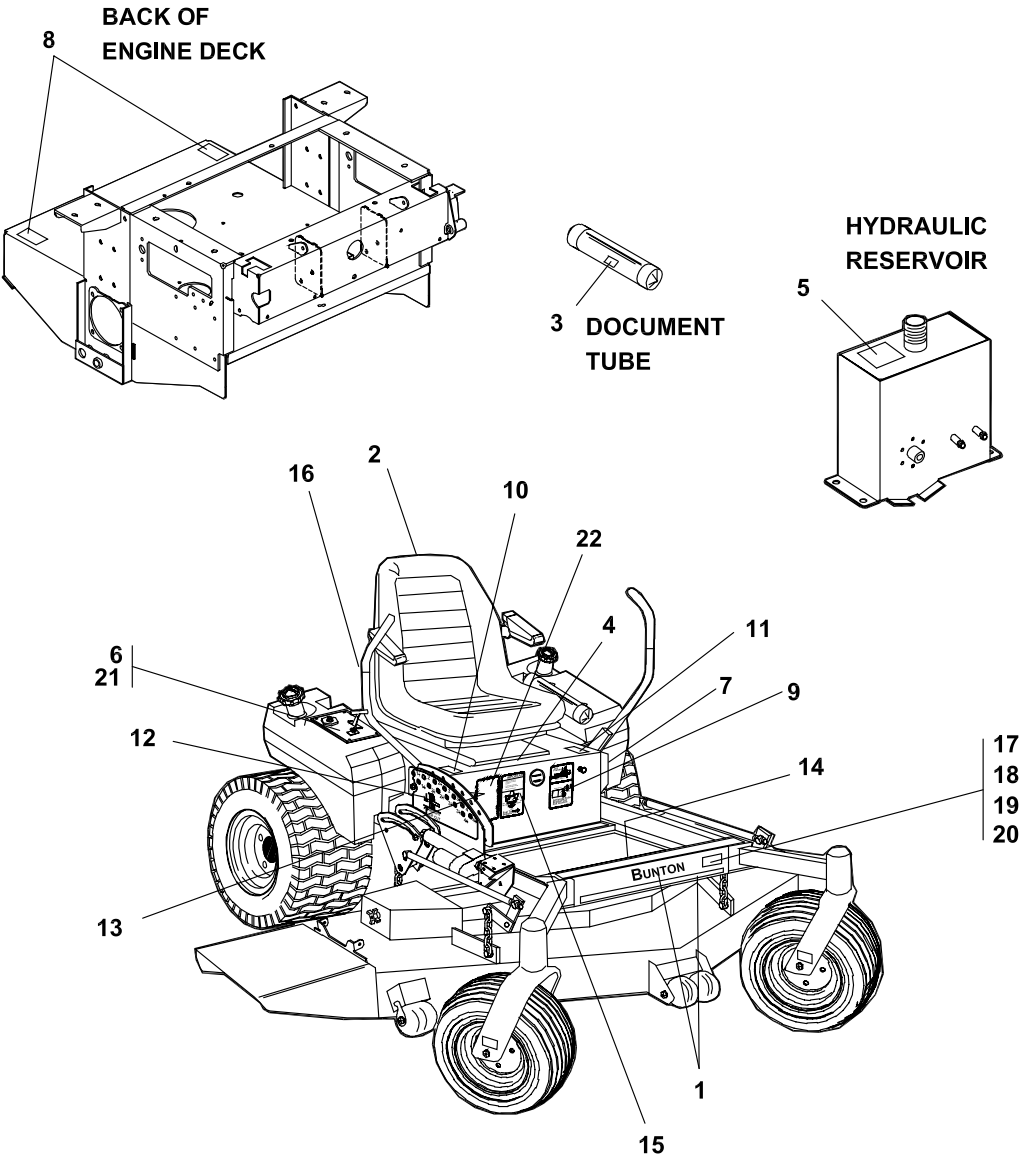

BZT 2000 Series

DECALS

2722089-04

FIGURE 4

ITEM	PART NO.	DESCRIPTION	QTY	ITEM	PART NO.	DESCRIPTION	QTY
4-1	2721992	LBL-BUNTON W/STRIPE	1				
4-2	2721886	LABEL-BUNTON TEXTRON	1				
4-3	2000735	LABEL-OPER MAN	1				
4-4	2000590	LABEL, WARN BATTERY	1				
4-5	2000691	LABEL - HYDR OIL FILL	1				
4-6	2721555	LABEL-CONTROL PANEL	1				
4-7	2000693	LABEL - PARK BRAKE	1				
4-8	2000698	LABEL(DBL) - FUEL/LEAKS	2				
4-9	4114158	LABEL-TIRES	1				
4-10	2000700	LABEL - RH TRACTION	1				
4-11	2000701	LABEL - LH TRACTION	1				
4-12	2000790	LABEL - HEIGHT OF CUT	1				
4-13	2000791	LABEL - INSIDE H.O.C.	1				
4-14	2000695	LABEL - WARN/USING	1				
4-15	2000706	LABEL-FUEL	1				
4-16	2721993	LABEL-BUNTON STRIPE	1				
4-17	2000795	LABEL-BZT 2250 DIECUT (USE ON 25 HP UNIT)	1				
4-18	2000796	LABEL-BZT 2230 DIECUT (USE ON 23 HP UNIT)	1				
4-19	2720858	LABEL-BZT 2190 DIECUT (USE ON 19 HP UNIT)	1				
		(ITEMS 20 & 21 USED ON LIQUID COOLED MODELS ONLY)					
4-20	2721987	LABEL-BZT2230LC DIE CUT	1				
4-21	2722124	LABEL-CNTRL PNL2230LC	1				
4-22	340830	DECAL-CAUTION SPANISH	1				

FIGURE 5

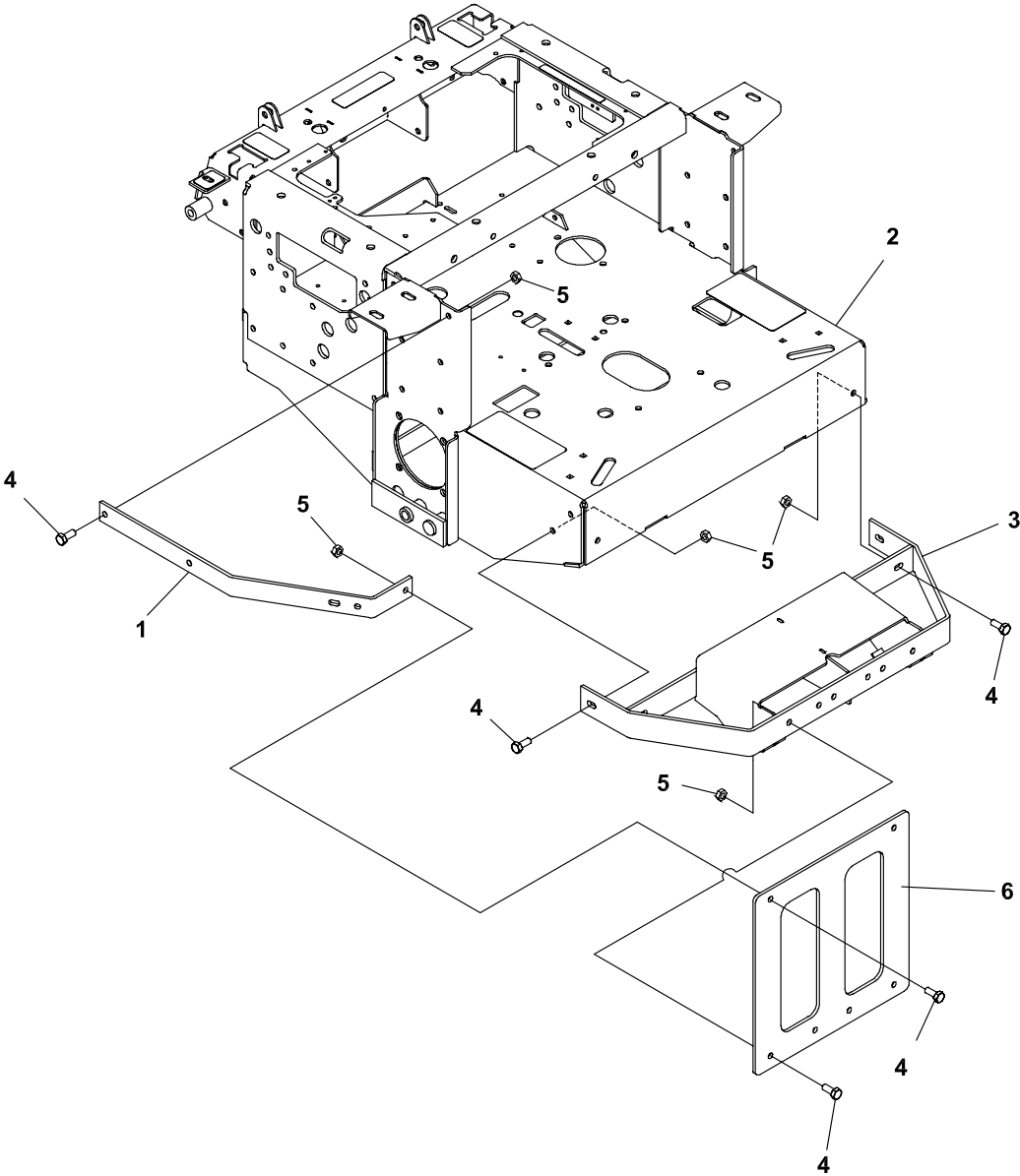

BZT 2000 Series

BUMPER

2722089-05

FIGURE 5

ITEM	PART NO.	DESCRIPTION	QTY	ITEM	PART NO.	DESCRIPTION	QTY
5-1	2722296.7	ARM-BUMPER	2				
5-2	2720997	S ENG DECK W/LABS	1				
5-3	2721324.7	WLDMT-BUMPER	1				
5-4	64263-013	BLT-FLG HD M10-1.5 X 30	10				
5-5	64265-05	NUT-FL NYL LOCK M10-1.5	10				
5-6	2721932.7	BRACE-VERTICAL	1				

FIGURE 6

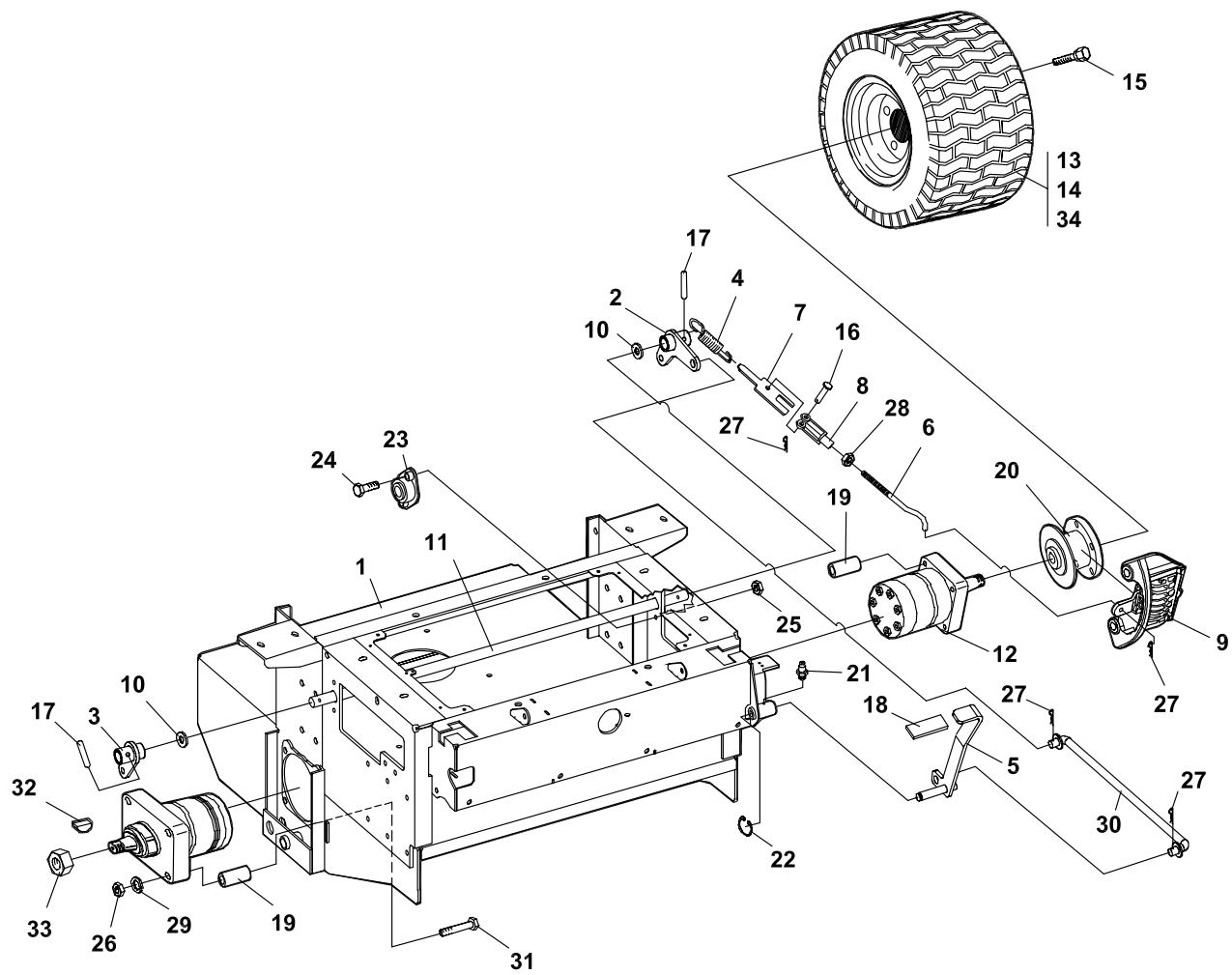

**TORQUE TO
225 FT/LBS**

BZT 2000 Series

BRAKES/REAR WHEEL

2722089-06

FIGURE 6

ITEM	PART NO.	DESCRIPTION	QTY	ITEM	PART NO.	DESCRIPTION	QTY
6-1	2720997	S ENGINE DECK WLABS	1	6-25	64141-4	NUT-WLF 3/8-16	4
6-2	4113527.7	WLDMT-BRAKE ARM LH	1	6-26	64207-07	NUT-HEX M12-1.75	8
6-3	4113529.7	WLDMT-BRAKE ARM RH	1	6-27	64168-2	HAIRPIN COTTER	6
6-4	128102	SPRING-EXTENSION	2	6-28	64025-03	NUT-HEX 5/16-24	2
6-5	4113518.7	WLDMT-BRAKE LEVER	1	6-29	64006-05	LCKWHSR-HELICAL 1/2	8
6-6	33213	ROD-SPD CTRL LH UPPER	2	6-30	4113530	ROD, BRAKE	1
6-7	2182387.7	GUIDE-SPRING	2	6-31	450767	CAPSCREW 12-1.75X110	8
6-8	38020N	CLEVIS-YOKE PLATE	2	6-32	64164-08	S-KEY / WHEEL MOTOR	2
6-9	2188147	ASSY BRAKE CW (LH)	1	6-33	64025-31	NUT1-20 UNSLOTTED TRW	2
	* 2188148	ASSY BRAKE CCW (RH)	1	6-34	2722001-01	RIM ASSY W/VALVE STEM	2
6-10	64163-06	WSHR-.768-.756 IDX14 GA	A/R		1985085-02	TIRE 24X12.00-12	2
6-11	2183056	SHAFT-BRAKE	1	(ITEM 34 USED ON 642223, 642233 & 642228)			
6-12	2188126-01	MOTOR-ASSY HYDRAULIC	2				
	(INCLUDES ITEM 35)						
6-13	2198156-01	RIM ASSY W/VALVE STEM	2				
	2198156-02	TIRE 23 X 10.5 X 12	2				
	(ITEM 13 USED ON 642222 & 642227)						
6-14	2720608-01	RIM ASSY W/VALVE STEM	2				
	2720608-02	TIRE-23 X 8.50-12	2				
	(ITEM 14 USED ON 642220 & 642221)						
6-15	64220-02	BOLT-WHEEL 7/16-20	10				
6-16	64188-02	PIN-CLEVIS 5/16X1	2				
6-17	64061-25	ROLL-PIN 1/4X1 1/4	2				
6-18	2188155	GRIP, 1/4X1X4 1/2	1				
6-19	2183063-01	SPACER, 32MM LONG	8				
6-20	2188149	HUB-WHL & DISC	2				
6-21	85010N	STRAIGHT ZERK FITTING	1				
6-22	64144-34	SNAP RING .50	1				
6-23	2188145	BRG-.75ID BRNZ SLF ALIGN	2				
6-24	64123-15	BLT-HEX 3/8-16X3/4	4				

SERVICE PARTS FOR 2188147 AND 2188148 BRAKE ASSEMBLIES				QTY/ASSY
2188147-01	BRACKET-MACHINED			1
2188147-02	PAD-CAM SIDE			1
2188147-03	PAD-SUPPORT			1
2188147-04	SPRING-LEVER RETAINER			1
2188147-05	HOUSING			1
2188147-06	CAM LH			1
2188147-07	PIVOT PIN			1
2188147-08	PAD-CARRIER SIDE			1
2188147-09	PAD-SUPPORT			1
2188148-01	*CAM RH			1
* NOT ILLUSTRATED				

BRAKE ASSEMBLY BREAKDOWN

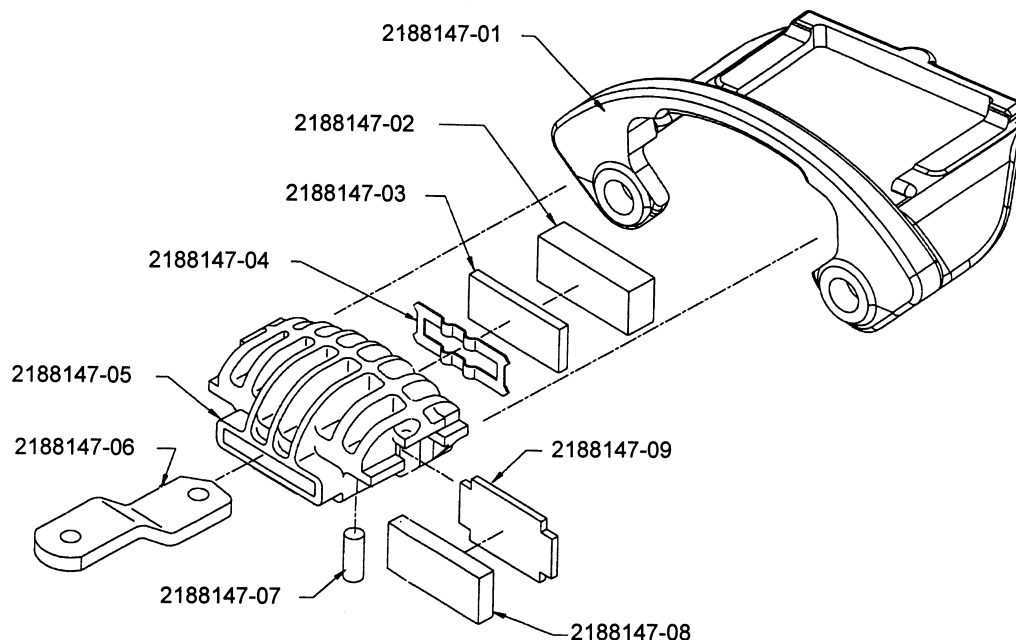
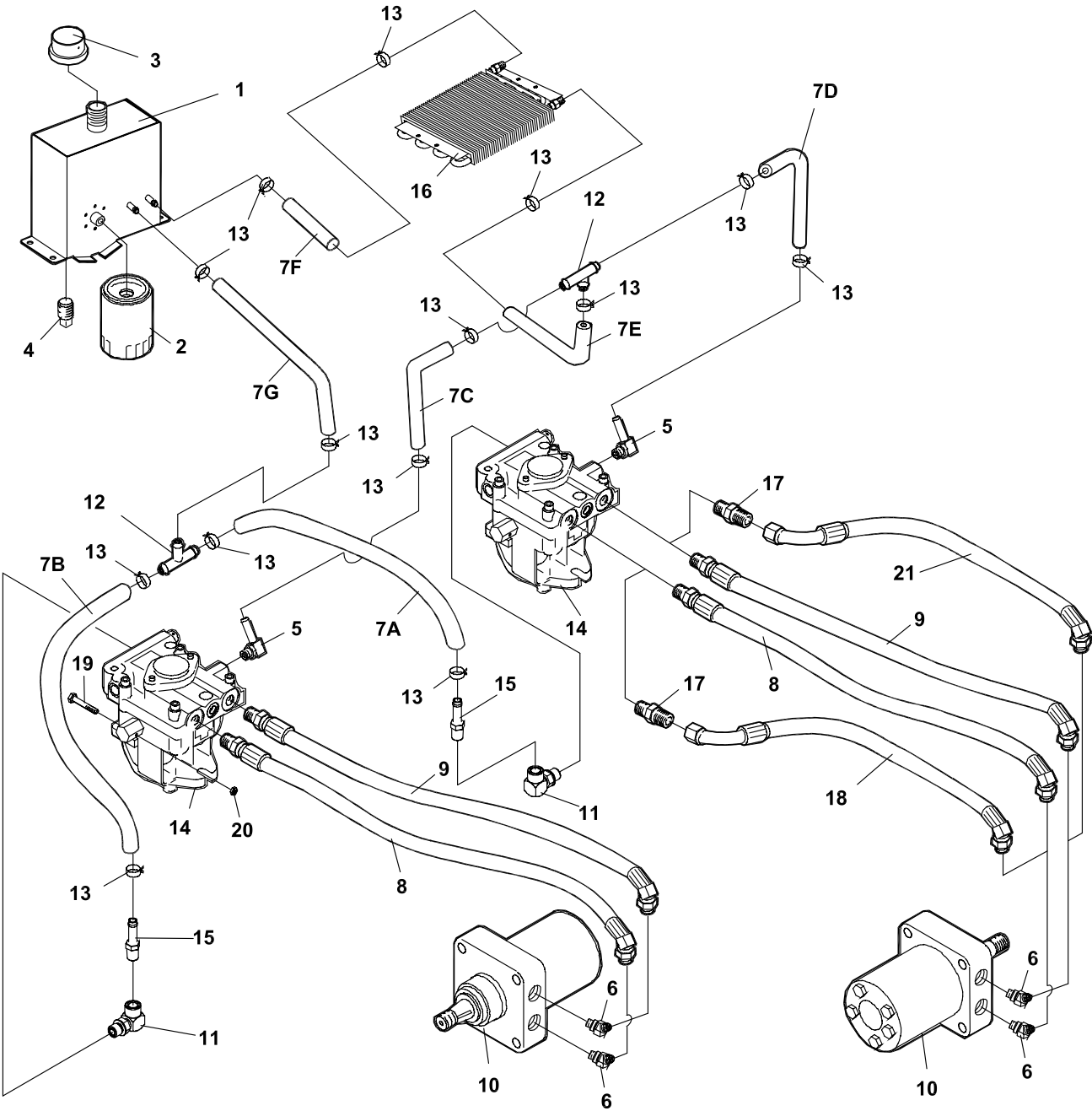

FIGURE 7



BZT 2000 Series

2722089-07

HYDRAULICS

FIGURE 7

ITEM	PART NO.	DESCRIPTION	QTY
7-1	2186211	S HYD RESERVOIR W/LAB	1
7-2	2720396	FILTER 25 MICRON	1
7-3	69216.7	CAP-RESERVOIR	1
7-4	108029	PLUG-MAGNETIC	1
7-5	158058-04	FTG-90 BRB 9/16-18X.38	2
7-6	108205-03	ELBOW-MALE 45 37-ORB	4
(69053-05 IS A SERVICEABLE LENGTH OF 55")			
7-7A	69053-05	3/8 HIGH TEMP HSE 18"	1
7-7B	69053-05	3/8 HIGH TEMP HSE 15"	1
7-7C	69053-05	3/8 HIGH TEMP HSE 19"	1
7-7D	69053-05	3/8 HIGH TEMP HSE 12"	1
7-7E	69053-05	3/8 HIGH TEMP HSE 22"	1
7-7F	69053-05	3/8 HIGH TEMP HSE 26"	1
7-7G	69053-05	3/8 HIGH TEMP HSE 5"	1
7-8	2188157-01	HOSE HYD ORB 37-22.38 (QTY OF 1 FOR ALL KAWASAKI ENGINES)	2
7-9	2188157-02	HOSE HYD ORB 37-25.00 (QTY OF 1 FOR 25 HP KAWASAKI ENGINE)	2
7-10	2188126-01	MOTOR-ASSY HYD	2
7-11	2690030-01	FTG 9/16-18 ORB X 3/8	2
7-12	58026-01	3 WAY CONNECTOR 3/8	2
7-13	88042-03	CLAMP-HOSE 5/8	14
7-14	4121333	PUMP-HYDRO BDP-10A-440	2
7-15	48386-04	FITTING-3/8 BARB 1/4	2
7-16	2188173	OIL COOLER	1
7-17	48089-03	FTG-STRGHT 8 ORB X 8 JIC 1 (ITEM 17 QTY 1 FOR KAW 14 & 23 HP) (ITEM 17 QTY 2 FOR KAW 25 HP)	1
7-18	2720320-01	HOSE-1/2 37/45 37 26.25 (ITEMS 17, 18 & 21 FOR KAWASAKI ENGINES ONLY)	1
7-19	64123-60	BOLT, 1/4-20X2 HEX	2
7-20	64229-01	LOCKNUT-NYL 1/4-20	2
7-21	2720320-02	HOSE-1/2 37/45 37 (ITEM 21 FOR KAW 25HP ENG ONLY)	1

SAE PORT 'O' RING		
PART NUMBER	THREAD SIZE	AS-568#
158061-10	9/16-18	-906
158061-11	3/4-16	-908
158061-12	7/8-14	-910
158061-13	1-1/16-12	-912
158061-14	1-5/16-12	-916
158061-16	1-5/8-12	-920
158061-03	1-7/8-12	-924

FIGURE 8

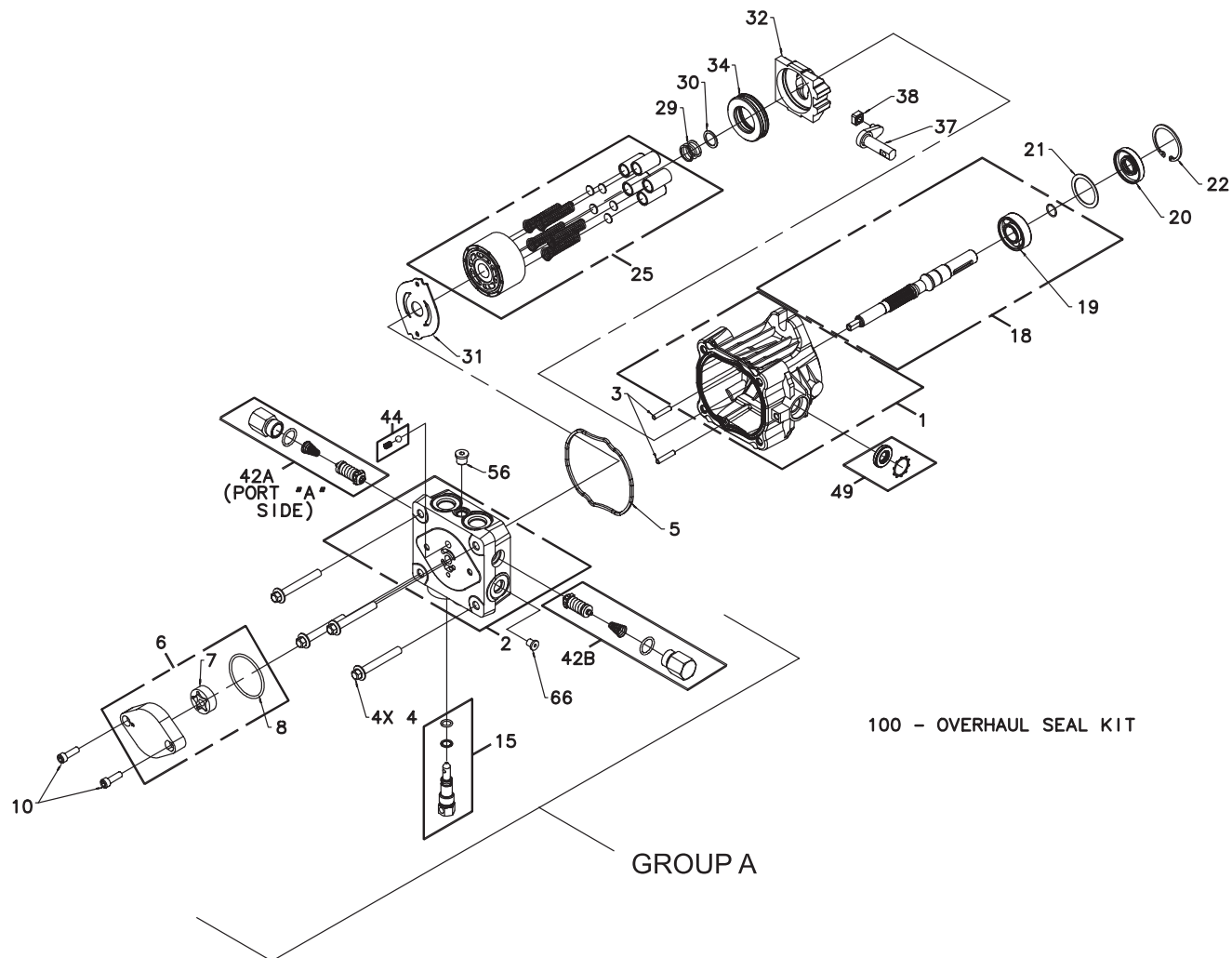

BZT 2000 Series

HYDROGEAR PUMP

2722087-08

FIGURE 8

ITEM	HYDROGEAR PART NO.	TEXTRON PART NO.	DESCRIPTION	QTY
8-1	70516	----	HOUSING KIT	1
8-2	70517	----	END CAP KIT	1
8-3	50641	----	STRAIGHT HEADLESS PIN	2
8-4	50969	2721615-01	FLANGE BOLT M8-1.25 X 60	4
8-5	51232	2721615-02	HOUSING O-RING	1
8-6	2513027	38345-06	CHARGE PUMP KIT	1
8-7	50273	38345-07	STD GEROTOR ASSEMBLY	1
8-8	9004101-1340	38345-08	O-RING	1
8-10	50095	38345-10	SOCKET SCREW M6-1.0 X 20	2
8-15	2513030	----	BYPASS VALVE KIT (BLANK)	1
8-18	70521	2721615-07	PUMP SHAFT KIT	1
8-19	50315	----	BALL BEARING 17 X 40 X 12	1
8-20	51161	----	LIP SEAL 17 x 40 x 12	1
8-21	50951	----	SPACER	1
8-22	50329	----	RETAINING RING	1
8-25	70331	38345-12	CYLINDER BLOCK KIT	1
8-29	2003014	----	BLOCK SPRING	1
8-30	2003017	----	BLOCK THRUST WASHER	1
8-31	51246	2721615-09	VALVE PLATE	1
8-32	2003087	188059-11	SWASH PLATE	1
8-34	50551	2721615-11	BALL THRUST BEARING	1
8-37	2003005	188059-15	ARM-TRUNNION	1
8-38	2000015	2721615-13	SLOT GUIDE	1
8-42A	70743	4121354	SHOCK VALVE KIT (.031")	1
8-42B	70741	4121355	SHOCK VALVE KIT (BLANK)	1
8-44	70403	2721615-16	CHARGE RELIEF VALVE KIT	1
8-49	2513043	2721615-17	TRUNNION SEAL/RETAINER KIT	1
8-56	9005110-4400	----	STRAIGHT THREAD PLUG	1
8-66	9005110-3100	----	5/16 SAE PLUG	1
8-100	70525	2721615-18	OVERHAUL SEAL KIT	1

FIGURE 9

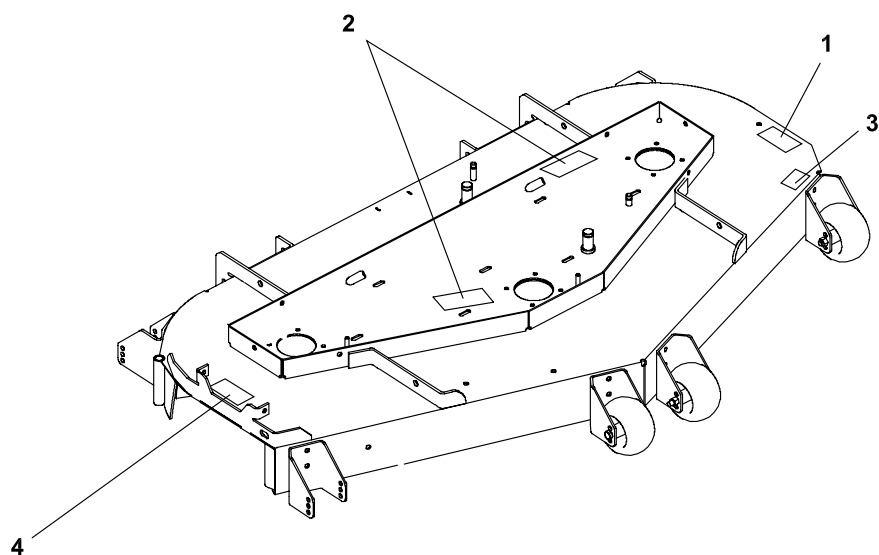

BZT 2000 Series

DECALS-CUTTERDECKS

2722087-21

FIGURE 9

ITEM	PART NO.	DESCRIPTION	QTY	ITEM	PART NO.	DESCRIPTION	QTY
9-1	2000572	LABEL-WARNING BLADES	1				
9-2	2000577	LABEL, WARNING	2				
9-3	2000696	LBL - BLADE INSTALL	1				
9-4	2000677	LABEL-DANGER/WARNING	1				

KOHLER WIRE HARNESS-LIQ. COOLED

BZT 2000 Series

FIGURE 10

2722089-10

ITEM	PART NO.	DESCRIPTION	QTY	ITEM	PART NO.	DESCRIPTION	QTY
10-1	2722147	HARNESS-WIRING	1				
10-2	148082-20	FUSE-20 AMP	2				
10-3	108061-13	CABLE-BATTERY	1				
10-4	158135-01	SWITCH-SEAT NO	1				
10-5	158136	WIRE-SEAT SWITCH	1				
10-6	48030N	HOUR METER ASSY	1				
10-7	2722227-02	CABLE-BATT W/CONDUIT (INCLUDES ITEMS 16 & 17)	1				
10-8	128010	KEY-SWITCH	1				
10-9	2722325	RELAY	5				
10-10	2188154	MODULE-DELAY	1				
10-11	2188153	SWITCH-CLUTCH	1				
10-12	2721337	CLUTCH-ELECTRIC (USE ON ALL MODELS EXCEPT 19HP) (INCLUDES 2720949 WIRE ASSY)	1				
	2722016	CLUTCH-ELECTRIC 19HP (USE ON 19HP MODELS ONLY) (INCLUDES 2720949 WIRE ASSY)	1				
10-13	2720949	ASSY-CLUTCH WIRE	1				
10-14	108208	SWITCH-DBL POLE	2				
10-15	2188156	SWITCH-NONO DBL POLE	1				
10-16	112386	BOOT-BAT TERM POS	1				
10-17	2308095	COVER-TERMINAL	1				
10-18	2188172	HARNESS-JUMPER	2				
10-19	2722635	GAUGE-TEMP 240 DEG	1				
10-20	2721903	HARNESS-CONTROL PNL	1				
10-21	2721814	SWITCH-DECK HEIGHT	1				
10-22	2721815	SWITCH-LIGHT	1				

BZT 2000 Series

KOHLER WIRE HARNESS-LIQ. COOLED

2722089-10

FIGURE 10

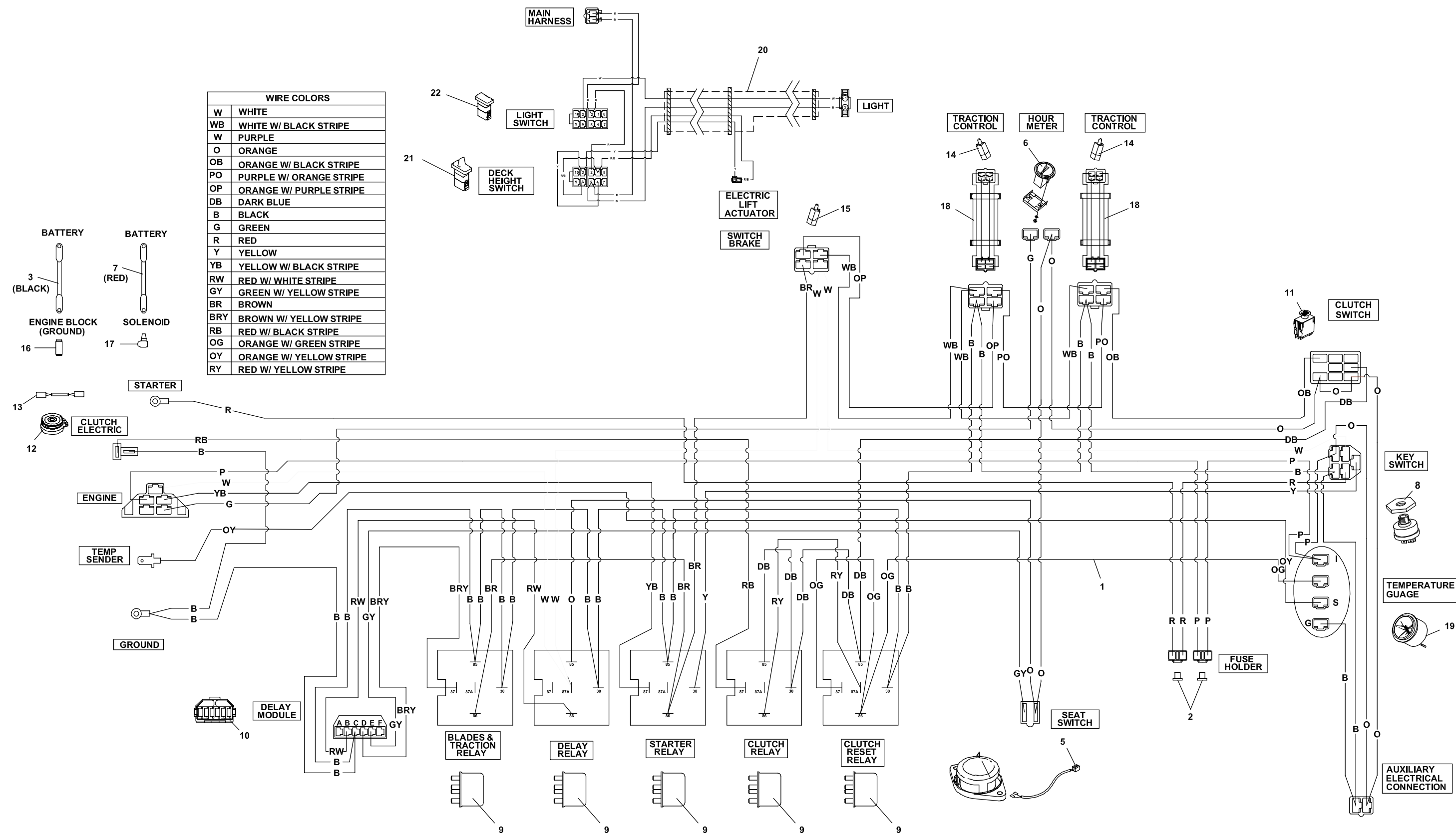
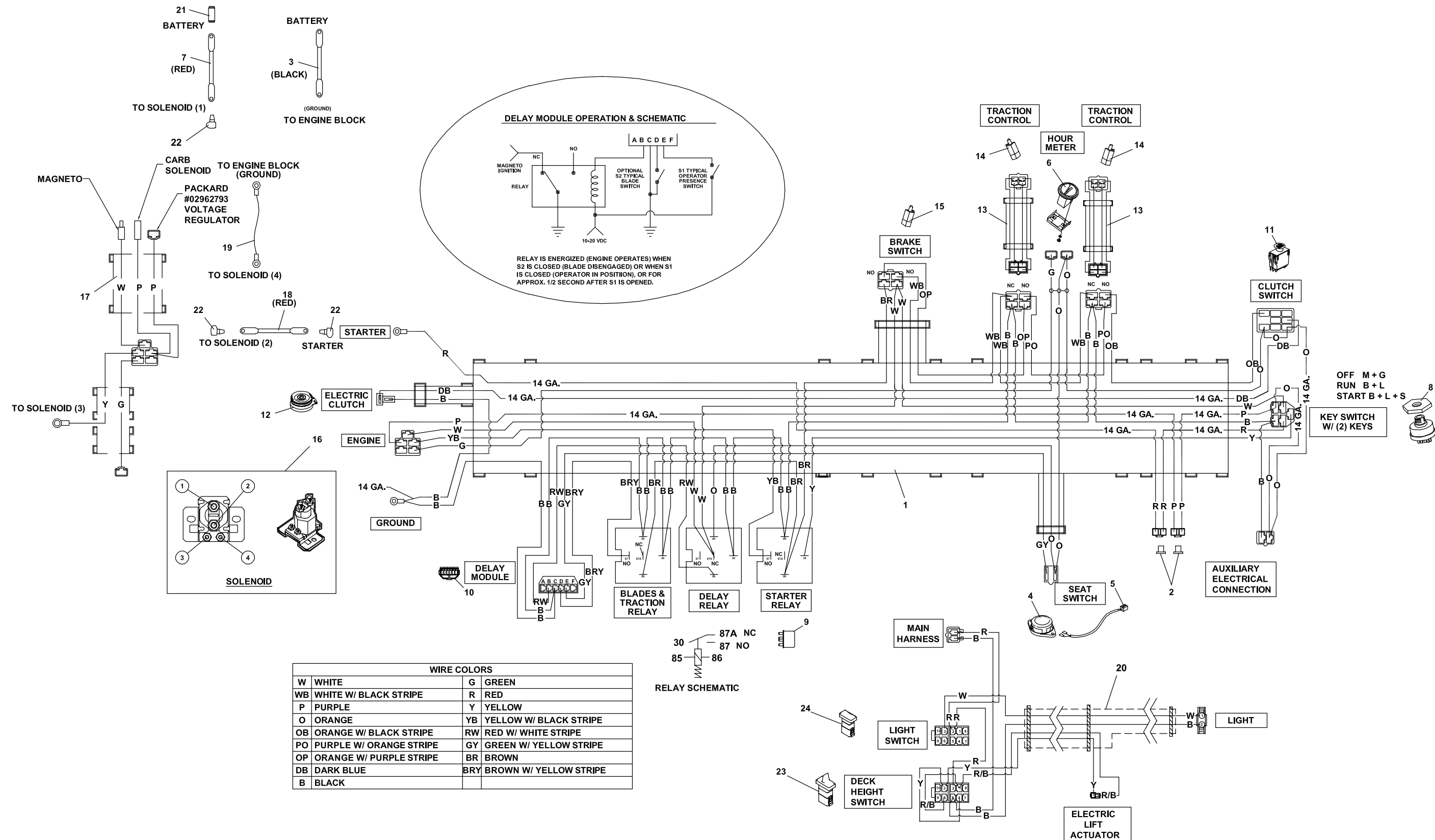

FIGURE 11

2722089-11

BZT 2000 Series



BZT 2000 Series

KAWASAKI WIRE HARNESS

2722089-11

FIGURE 11

ITEM	PART NO.	DESCRIPTION	QTY	ITEM	PART NO.	DESCRIPTION	QTY
11-1	2721375	HARNESS-WIRING	1				
11-2	148082-20	FUSE-20 AMP	2				
11-3	108061-13	CABLE-BATTERY	1				
11-4	158135-01	SWITCH-SEAT NO	1				
11-5	158136	WIRE-SEAT SWITCH	1				
11-6	48030N	HOUR METER ASSY	1				
11-7	2722227-02	CABLE-BATT W/CONDUIT (INCLUDES ITEMS 21 & 22)	1				
11-8	128010	KEY-SWITCH	1				
11-9	2722325	RELAY	3				
11-10	2188154	MODULE-DELAY	1				
11-11	2188153	SWITCH-CLUTCH	1				
11-12	2721337	CLUTCH-ELECTRIC (USE ON ALL MODELS EXCEPT 19HP) (INCLUDES 2720949 WIRE ASSY)	1				
	2722016	CLUTCH-ELECTRIC 19HP (USE ON 19HP MODELS ONLY) (INCLUDES 2720949 WIRE ASSY)	1				
11-13	2188172	HARNESS-JUMPER	2				
11-14	108208	SWITCH-DBL POLE	2				
11-15	2188156	SWITCH-NONO DBL POLE	1				
11-16	38665	SOLENOID	1				
11-17	2188224	HARNESS-JUMPER	1				
11-18	108061-04	CABLE-SOL/STARTER	1				
11-19	2188225	WIRE-GROUND	1				
11-20	2721903	HARNESS-CONTROL PNL	1				
11-21	112386	BOOT, BAT. TERM POS	1				
11-22	2308095	COVER-TERMINAL	3				
11-23	2721814	SWITCH-DECK HEIGHT	1				
11-24	2721815	SWITCH-LIGHT	1				

FIGURE 12

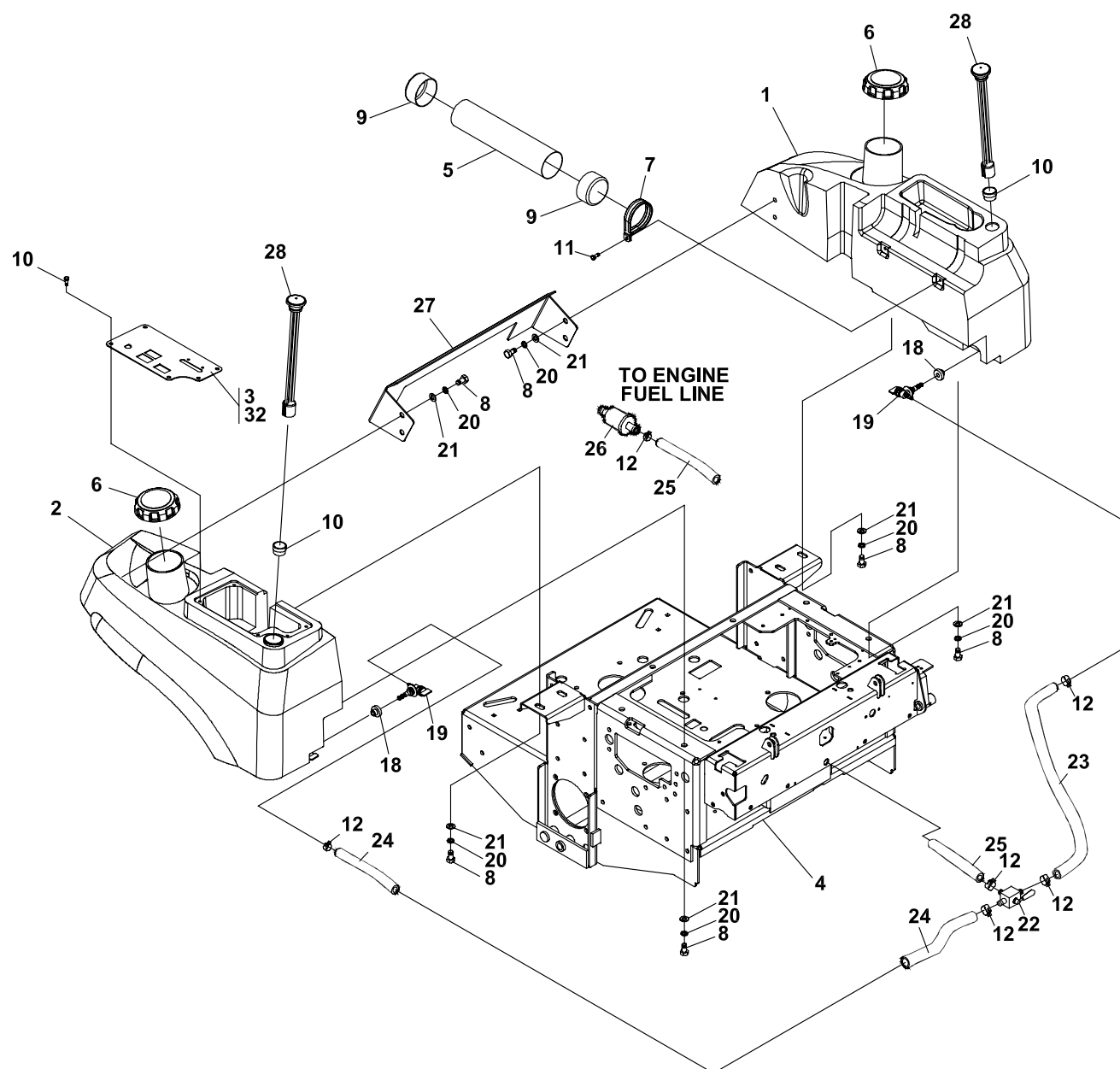

BZT 2000 Series

FUEL TANKS/CONTROL PANEL

2722089-12

FIGURE 12

ITEM	PART NO.	DESCRIPTION	QTY	ITEM	PART NO.	DESCRIPTION	QTY
12-1	2721510	TANK-FUEL LH (INCLUDES ITEMS 18 & 19)	1	12-16	64025-15	NUT-HEX #10-24 KEPS	2
12-2	2721509	TANK-FUEL RH (INCLUDES ITEMS 18 & 19)	1	12-17	64152-46	SCR.-SLT HH #10-24X1/2	2
12-3	2721808	S CONTROL PANEL W/LAB (USED ON ALL MODELS EXCEPT LIQUID COOLED)	1	12-18	48310	S BUSHING, FUEL TANK	2
				12-19	38540	S FUEL SHUTOFF VALVE	2
				12-20	800488	LOCKWASHER M10	12
				12-21	64251-004	WASHER-M10	12
				12-22	2188161	VALVE-TANK SELECTOR	1
				12-23	48016-13A	HOSE 1/4IDX1/2ODX2.00	1
12-4	2720997	S ENG DECK W/LABS	1	12-24	48016-21A	HOSE 1/4IDX1/2ODX1.84	1
12-5	2306144	S-DOC TUBE W/LABS	1	12-25	48016-22A	HOSE 1/4IDX1/2ODX1.67	1
12-6	2721520	CAP-FUEL TANK	2	12-26		FUEL FILTER	2
12-7	38542	CLAMP-DOC TUBE	2			(OBTAIN FROM KOHLER)	
12-8	64205-007	BLT-MET M10-1.5X20	12				
12-9	38061A	SPINDLE-SHIELD	2	12-27	2721915.5	BRKT-REAR BANNER	1
12-10	2218147	GROMMET-GAUGE	2	12-28	2721945	GAUGE-REMOTE FUEL	2
12-11	64263-001	BLT-FLG HD M6-1.0 X 12	7	12-29	2721814	SWITCH-DECK HEIGHT	1
12-12	88042N	HOSE CLAMP	6	12-30	2721815	SWITCH-LIGHT ON/OFF	1
12-13	128010	KEY-SWITCH	1			(ITEMS 33 & 34 USED ON LIQUID COOLED MODELS ONLY)	
12-14	118020-09	CONTROL, THROTTLE (FOR KOHLER ENGINE)	1	12-31	2722635	GAUGE-TEMP 240 DEG	1
	118020-14	CONTROL, THROTTLE (FOR KAWASAKI ENGINE)	1	12-32	2722295	S-CONTROL PANEL BZT LC	1
				12-33	2188178	SWITCH-RETAINER	1
12-15	2188153	SWITCH-CLUTCH	1	12-34	128010-01	S-KEY SWITCH NYLON NUT	1
				12-35	128010-03	S-COVERED KEY	1

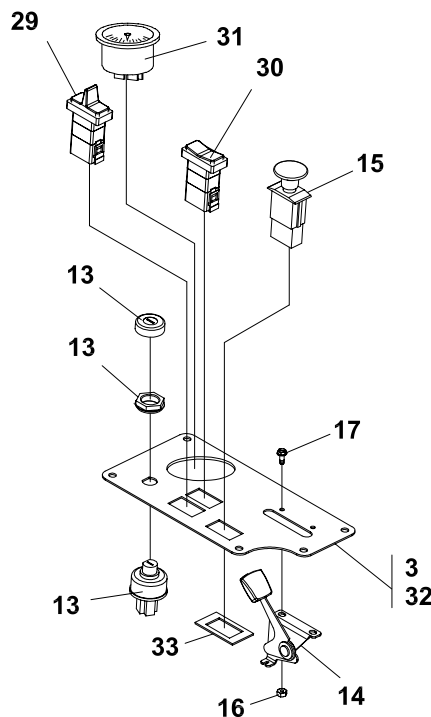
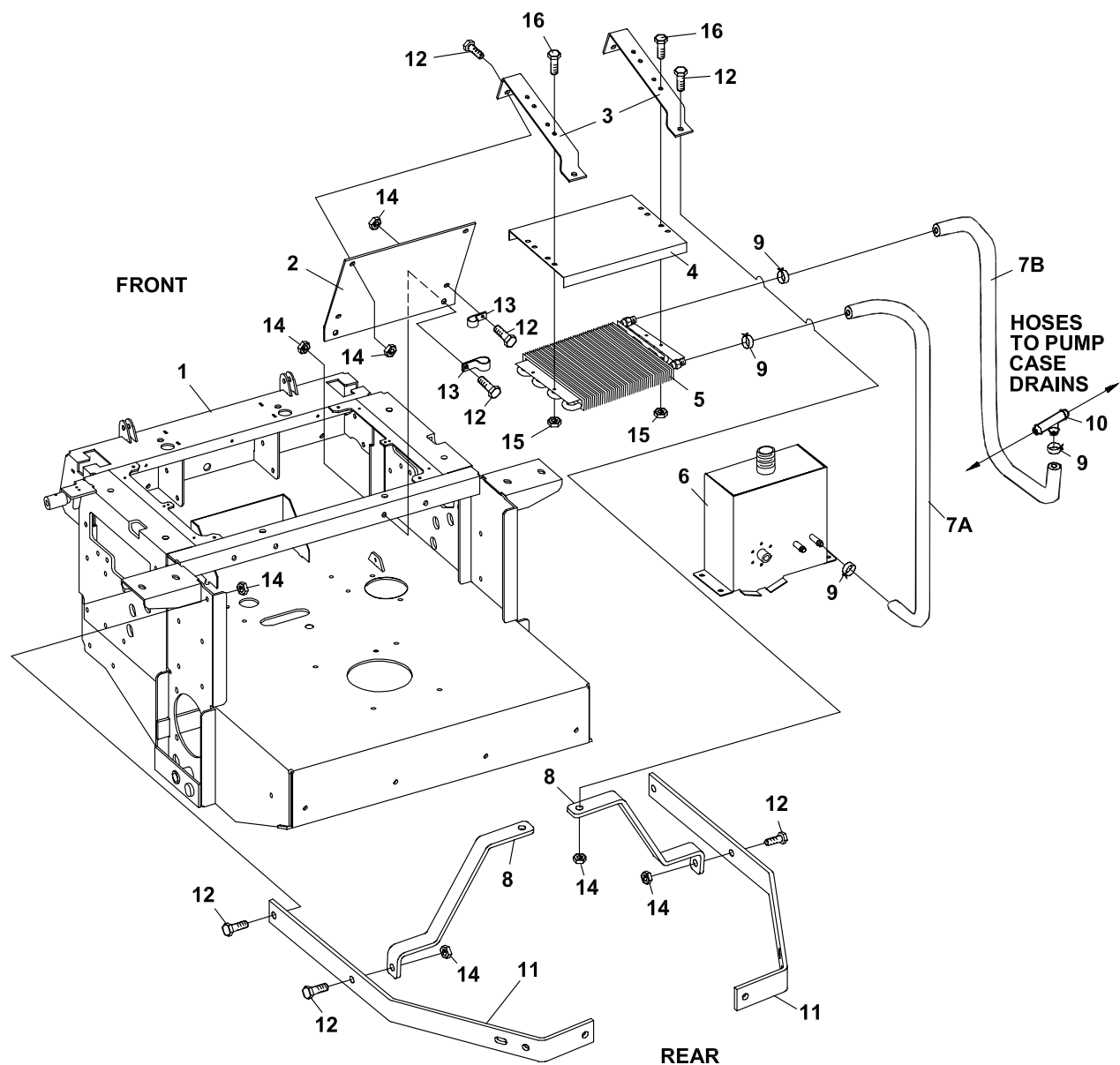

FIGURE 13



BZT 2000 Series

OIL COOLER

2722089-13

FIGURE 13

ITEM	PART NO.	DESCRIPTION	QTY	ITEM	PART NO.	DESCRIPTION	QTY
13-1	2720997	S ENGINE DECK W/LABS	1				
13-2	2722339.7	BRKT-FRONT COOLER	1				
13-3	2722338.7	BRKT-OIL COOLER	2				
13-4	2720891.7	SCREEN-OIL COOLER	1				
13-5	2188173	COOLER-OIL	1				
13-6	2186211	S HYD RSRVR W/LABS	1				
(69053-05 IS A SERVICEABLE LENGTH OF 55")							
13-7A	69053-05	3/8 HIGH TEMP HOSE 26"	1				
13-7B	69053-05	3/8 HIGH TEMP HOSE 22"	1				
13-8	2721928.7	BRKT-COOLER	2				
13-9	88042-04	CLAMP-HOSE 5/8	4				
13-10	58026-01	3 WAY CONNECTOR 3/8	1				
13-11	2722296.7	ARM-BUMPER	2				
13-12	64263-013	BLT-FLG HD M10-1.5 X 30	10				
13-13	48228-2A	CABLE-CLIP 3/4 W/INSTN	2				
13-14	64265-05	NUT-FL NYL LOCK M10-1.5	10				
13-15	64266-01	NUT-FL LOCK M6-1.0	4				
13-16	64263-002	BLT-FLG HD M6-1.0 X 16	4				

FIGURE 14

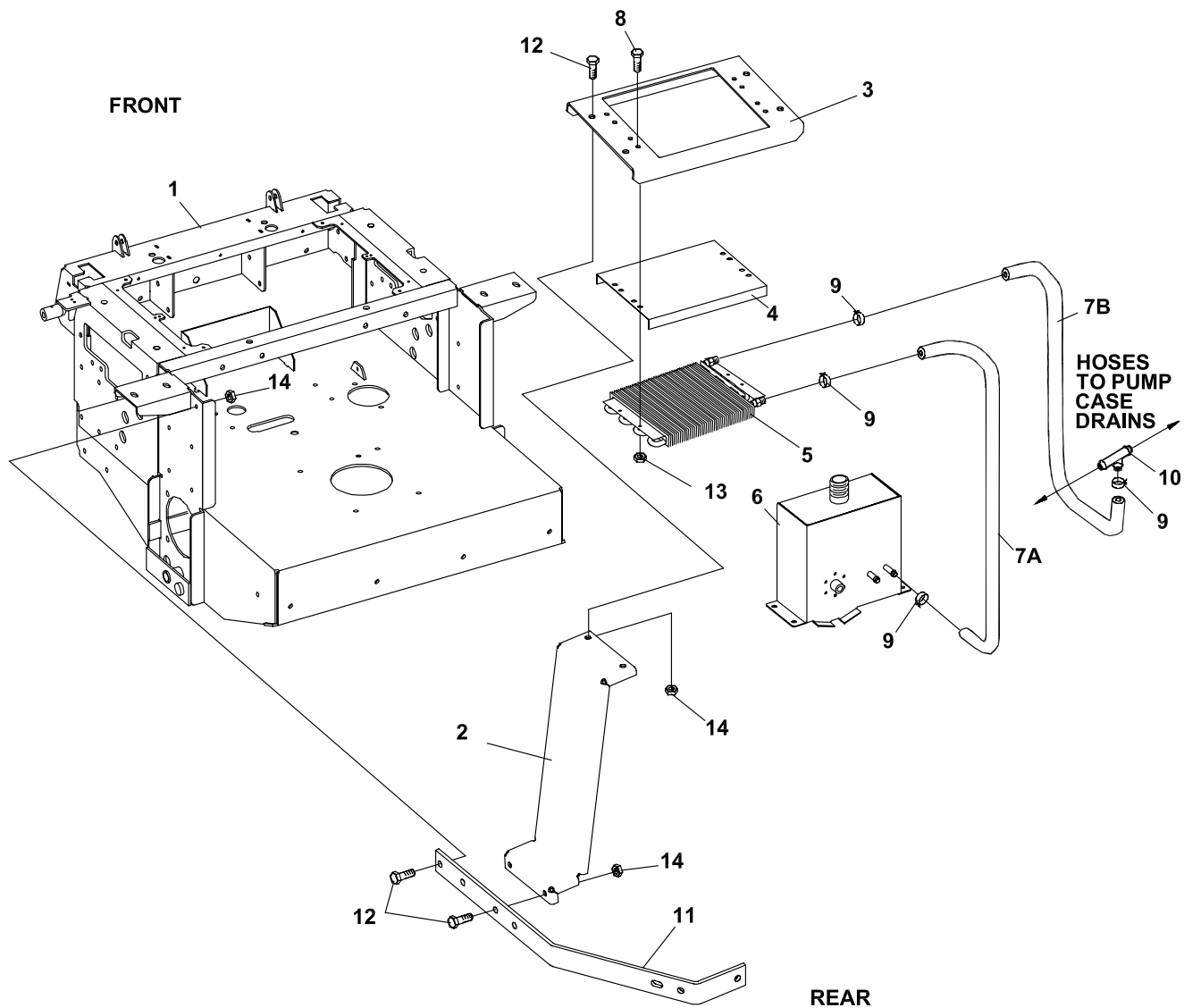

BZT 2000 Series

OIL COOLER-LIQUID COOLED

2722089-14

FIGURE 14

ITEM	PART NO.	DESCRIPTION	QTY	ITEM	PART NO.	DESCRIPTION	QTY
14-1	2720997	S ENGINE DECK W/LABS	1				
14-2	2722424.7	BRKT-UPPER OIL COOLER	1				
14-3	2722371.7	BRKT-OIL COOLER 223LC	2				
14-4	2720891.7	SCREEN-OIL COOLER	1				
14-5	2188173	COOLER-OIL	1				
14-6	2186211	S HYD RSRVR W/LABS	1				
(69053-05 IS A SERVICEABLE LENGTH OF 55")							
14-7A	69053-05	3/8 HIGH TEMP HOSE 30"	1				
14-7B	69053-05	3/8 HIGH TEMP HOSE 34"	1				
14-8	64263-002	BLT-FLG HD M6-1.0 X 16	4				
14-9	88042-04	CLAMP-HOSE 5/8	4				
14-10	58026-01	3 WAY CONNECTOR 3/8	1				
14-11	2722296.7	ARM-BUMPER	2				
14-12	64263-013	BLT-FLG HD M10-1.5 X 30	12				
14-13	64237-02	LOCKNUT-NYLON M6-1.00	4				
14-14	64265-05	NUT-FL NYL LOCK M10-1.5	12				

FIGURE 15

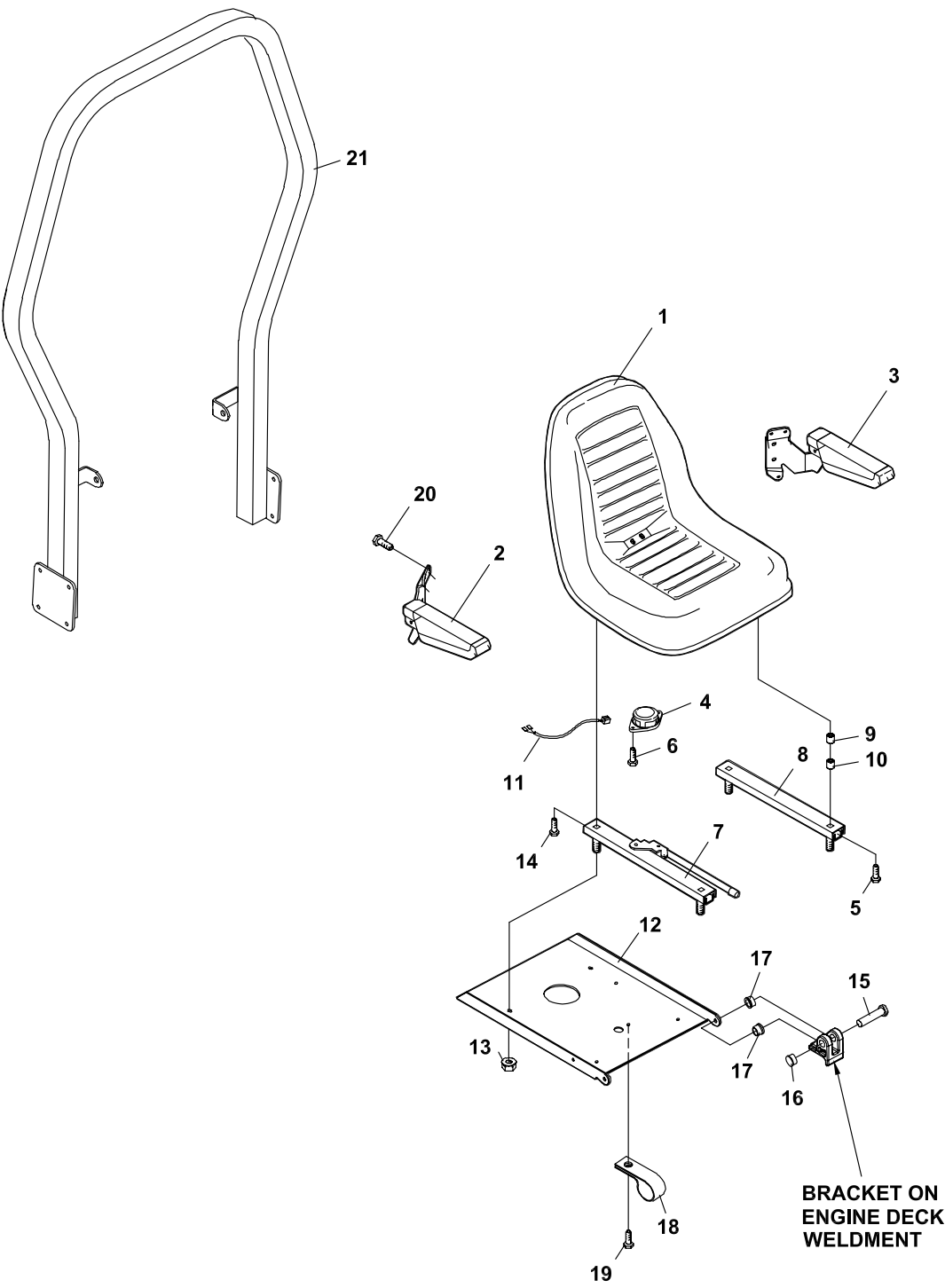

BZT 2000 Series

SEAT ASSEMBLY & ROPS

2187026

FIGURE 15

ITEM	PART NO.	DESCRIPTION	QTY	ITEM	PART NO.	DESCRIPTION	QTY
15-1	2720975	SEAT-SUSPENSION (INCLUDES ITEMS 2-10)	1				
	2720975-01	SEAT CUSHION	1				
	2720975-02	BACK CUSHION	1				
	2720975-05	CABLE ASSEMBLY (INTERNAL SEAT COMPONENT NOT ILLUSTRATED)	2				
	2720975-08	ASSY-SEAT BACK PANEL	1				
15-2	2721093	RH ARM REST	1				
15-3	2721094	LH ARM REST	1				
15-4	158135-01	SWITCH, SEAT NO	1				
15-5	64123-69	BLT-HEX 5/16-18X1-1/2	2				
15-6	64123-49	BLT-HEX 1/4-20X1/2	2				
15-7	2720975-04	SLIDE RAIL-ADJ	1				
15-8	2720975-03	SLIDE RAIL-SLAVE	1				
15-9	2720975-06	SPACER-NYLON 5/8"	2				
15-10	2720975-07	SPACER-NYLON 3/8"	4				
15-11	158136	WIRE-SEAT SWITCH	1				
15-12	2722427.7	PLATE-SEAT	1				
15-13	64141-6	NUT-WLF 5/16-18	4				
15-14	2198096	SCREW-CAP WSHR HD	4				
15-15	64188-39	PIN-CLEVIS3/8X1-3/8W/OHL	2				
15-16	64175-04	PUSHNUT 3/8 DIA	2				
15-17	38371-01	BRG-NYLINER 3/8	2				
15-18	48228A	CABLE CLIP-INSULATED	1				
15-19	64152-23	SCREW 1/4-20X3/8	1				
15-20	64139-16	BLT-WLF 5/16-18 X 3/4	6				
OPTIONAL ROPS:							
15-21	970162	ATT-ROPS (INCLUDES ITEM 22)					
15-22	* 2208260	S-SEAT BELT	1				

* NOT ILLUSTRATED

FIGURE 16

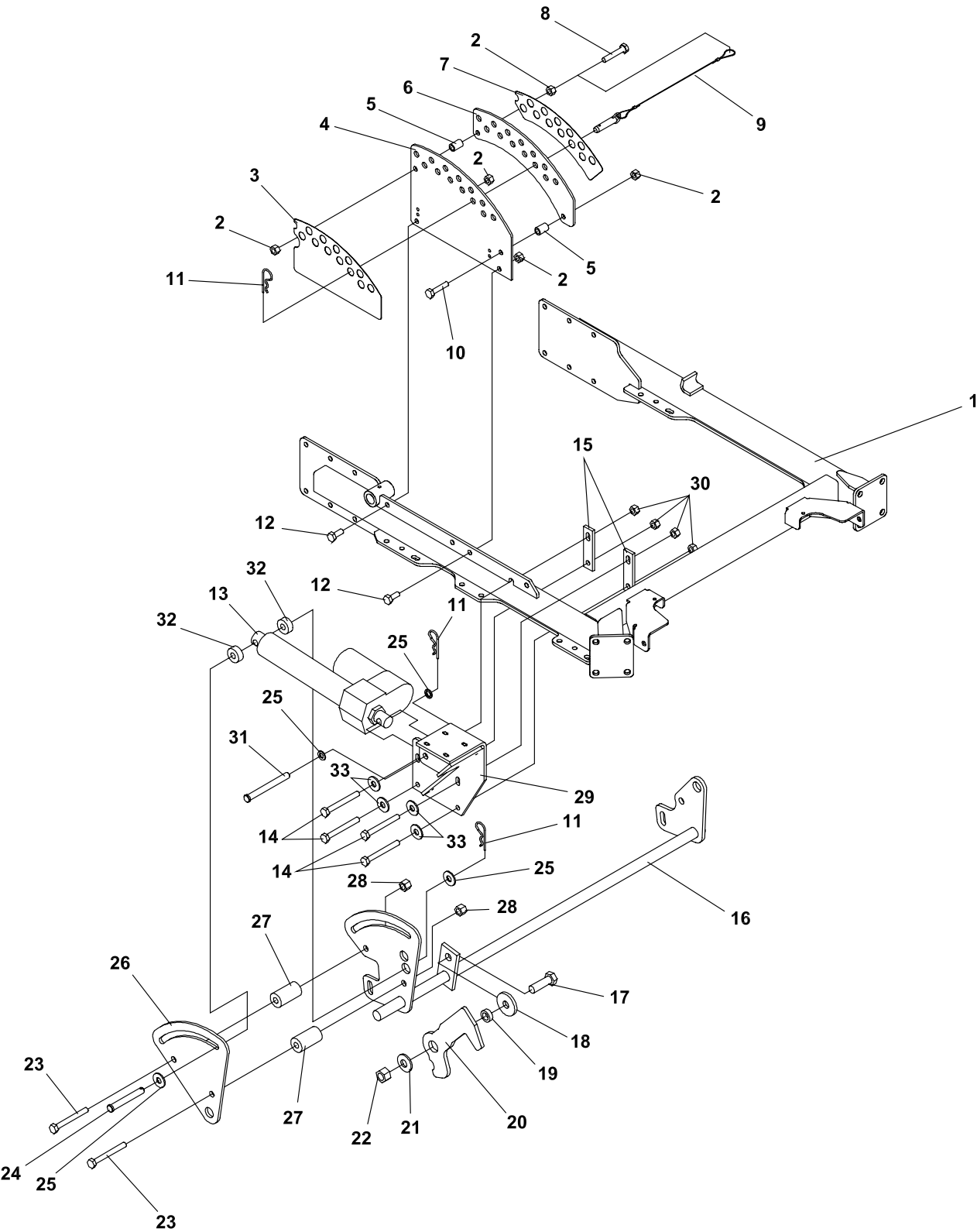

BZT 2000 Series

ELECTRIC DECK LIFT

2722089-16

FIGURE 16

ITEM	PART NO.	DESCRIPTION	QTY	ITEM	PART NO.	DESCRIPTION	QTY
16-1	2722723.5	WLDMT-CRADLE	1				
16-2	64237-03	LOCKNUT-NYLN M10-1.5	5				
16-3	2000791	LBL-OUTSIDE HOC	1				
16-4	2182523.7	PLATE-HEIGHT ADJ OUTER	1				
16-5	2183071-03	SPACER	2				
16-6	2182524.7	PLATE-HEIGHT ADJ INNER	1				
16-7	2000790	LABEL-INNER HOC	1				
16-8	64205-008	BLT-MET M10-1.50X55	1				
16-9	2188141	ASSY, PIN & LANYARD	1				
16-10	64205-034	BLT-MET M10-1.50X45	1				
16-11	64168-1	PIN-COTTER .120X2-3/8	3				
16-12	A1104057	BLT-MET M10-1.5X25	2				
16-13	2720642	ACTUATOR-LINEAR 12VDC	1				
16-14	64205-009	BLT-MET M10-1.5X65	4				
16-15	2721644.7	PLATE-BOLT	2				
16-16	2722614.5	WLDMT-ELECTRIC LIFT	1				
16-17	64205-055	BLT-MET M16-2.0 X 50	1				
16-18	64163-78	WASHER-.635 X 2.00	1				
16-19	2183084	SPACER-16.25X50.8X8.5LG	1				
16-20	2182522.7	LEVER-DECKLIFT	1				
16-21	64209-03	SPRING WASHER .67 ID	1				
16-22	64237-04	LOCKNUT-NYLON M16-2.0	1				
16-23	64263-022	BLT-FLG HD M12-1.75 X 90	2				
16-24	64188-40	PIN, CLEVIS 1/2 X 3-1/2	1				
16-25	64163-19	WASHER-33/64X1-1/4X12GA	4				
16-26	4112962.5	PLATE-DECKLIFT ELECT	1				
16-27	2183077	SPACER-DECKLIFT	2				
16-28	64265-06	NUT-FL NYL LOCK M12-1.75	2				
16-29	2721645.7	WLDMT-EL LIFT MTG BRKT	1				
16-30	64265-05	NUT-FL NYL LOCK M10-1.5	4				
16-31	64188-43	PIN-CLEVIS	1				
16-32	2188227	SPACER 1.25 X 0.50 X 0.52	2				
16-33	64251-004	WHSR-M10	4				

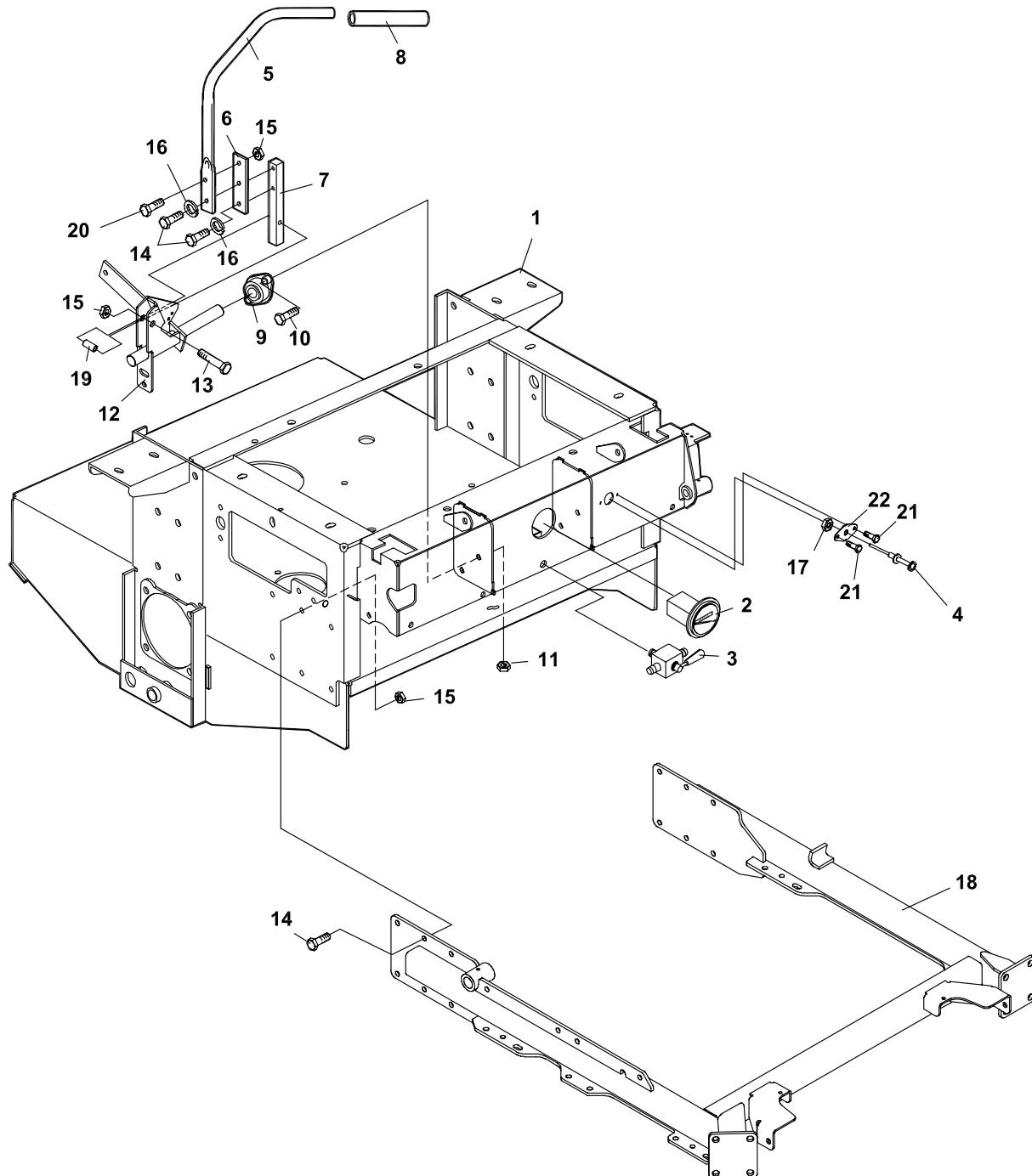

BZT 2000 Series

STEERING/INSTRUMENTS

2722089-17

FIGURE 17

ITEM	PART NO.	DESCRIPTION	QTY	ITEM	PART NO.	DESCRIPTION	QTY
17-1	2720997	S ENGINE DECK W/LABS	1				
17-2	48030N	HOUR METER ASSY	1				
17-3	2188161	VALVE-TANK SELECTOR	1				
17-4	108009-04	CONTROL-CHOKE 40.0 (USE WITH KOHLER ENGINES)	1				
	108009-03	CONTROL-CHOKE 51.0 (USE WITH KAWASAKI & LIQUID COOLED ENGINES ONLY)	1				
17-5	2182344.7	LEVER-CONTROL	2				
17-6	2182434.7	BRKT-TRACTION LEVER	2				
17-7	2183074	BRACKET-HANDLE	2				
17-8	2188144	GRIP-.75 IDX12	2				
17-9	2188145	BEARING-SELF ALIGNED	4				
17-10	64123-15	BLT-HEX 3/8-16X3/4	8				
17-11	64141-4	NUT-WLF 3/8-16	8				
17-12	4112105.7	WLDMT-MTN CNTRL RH	1				
	* 4112104.7	WLDMT-MTN CNTRL LH	1				
17-13	64205-011	BLT-MET M10-1.5X40	2				
17-14	A110406	BLT-MET M10-1.5X30	16				
17-15	64237-03	LOCKNUT-NYLON M10-1.5	16				
17-16	800488	LOCKWASHER-M10	4				
17-17	64025-04	NUT-HEX 3/8-24	1				
17-18	2722723.5	WLDMT-CRADLE	1				
17-19	2183073	SPACER	2				
17-20	A1104057	BOLT-M10-1.50X25	2				
17-21	64152-23	1/4-20X3/8 LG SP SCREW	2				
17-22	2222092	PLATE-CHOKE MOUNT	1				

* NOT ILLUSTRATED

CRADLE & CASTER ASSEMBLY

BZT 2000
Series

FIGURE 18

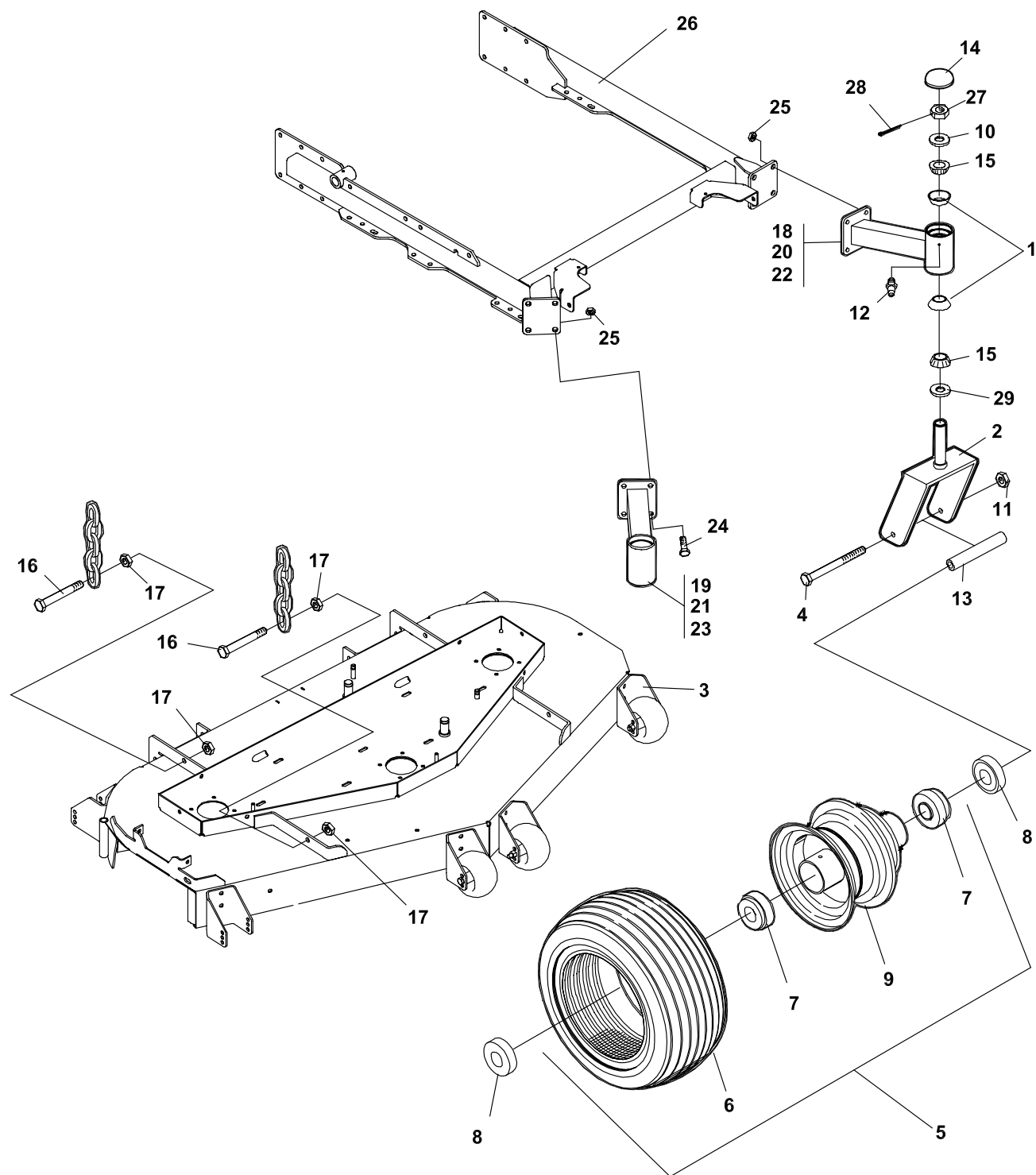

BZT 2000 Series

CRADLE & CASTER ASSEMBLY

2722089-18

FIGURE 18

ITEM	PART NO.	DESCRIPTION	QTY	ITEM	PART NO.	DESCRIPTION	QTY
18-1	48043-03C	S CUP, OUTER BEARING	4				
18-2	2721306.5	WLDMT-CASTER YOKE	2				
18-3		DECK W/LABS					
18-4	64123-215	BOLT-HEX 3/4-10X7 1/2	2				
18-5	2722228	WHEEL-13X5.00-6 ASSY (INCLUDES ITEMS 6, 7 & 9)	2				
18-6	2720475-01	TIRE-13X5.00-6 SMOOTH	1				
18-7	2722228-03	BEARING	2				
18-8	2722231	SPACER-END	4				
18-9	2722228-01	RIM-13" ASSY W/VLV STEM	1				
18-10	64163-26	WASHER, .766 ID X 1.625	2				
18-11	64229-07	LOCKNUT-NYLON 3/4-10	2				
18-12	85010N	ZERK, 1/4-28 STR SLF THD	9				
18-13	2722230-02	SPANNER-13" WHEEL	2				
18-14	2188135	DUST COVER	2				
18-15	48043-04C	S-CONE, OUTER BEARING	4				
18-16	64205-029	BLT-MET M12X1.75X40	8				
18-17	64246-04	NUT-WHIZ M12-1.75	16				
18-18	2722401.5	WLDMT-CASTR ARM 48 LH	1				
18-19	2722400.5	WLDMT-CASTR ARM 48 RH (USE FOR 48" DECKS ONLY)	1				
18-20	2722398.5	WLDMT-CASTR ARM 52 RH	1				
18-21	2722399.5	WLDMT-CASTR ARM 52 LH (USE FOR 52" DECKS ONLY)	1				
18-22	4113901.5	WLDMT-CASTR ARM 61 LH	1				
18-23	4113902.5	WLDMT-CASTR ARM 61 RH (USE FOR 61" SD DECKS ONLY)	1				
18-24	A1105061	BOLT-M12-1.75X30	8				
18-25	64237-06	LOCKNUT-NYLON M12-1.75	8				
18-26	2722723.5	WLDMT-CRADLE	1				
18-27	64025-20	NUT HEX 3/4-16 - SLOT U	2				
18-28	64140-5	COTTER PIN - 1/8 X 1-1/2	2				
18-29	48480	SEAL	2				

FIGURE 19

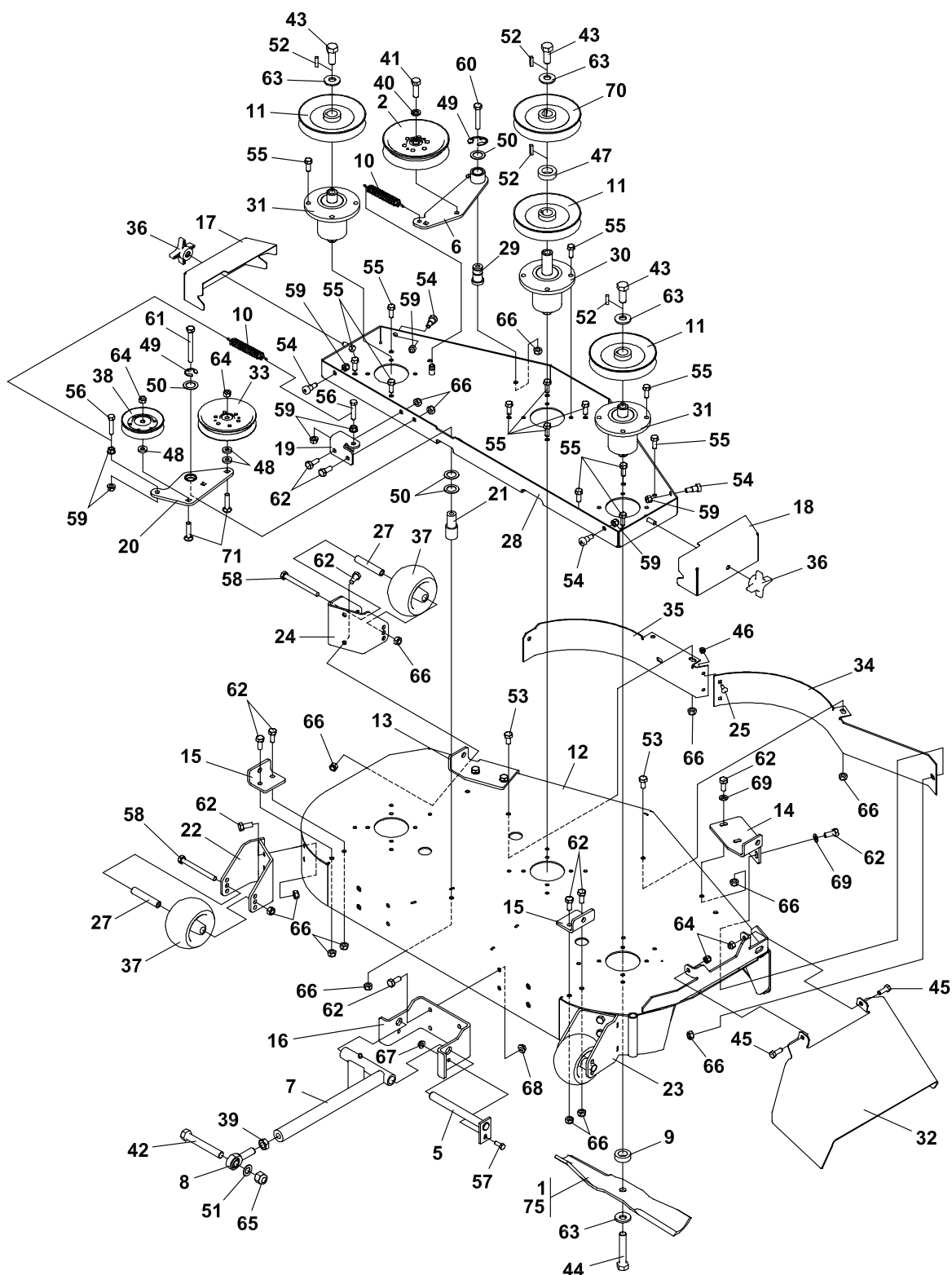

BZT 2000 Series

48" SIDE DISCHARGE

2720442

FIGURE 19

ITEM	PART NO.	DESCRIPTION	QTY	ITEM	PART NO.	DESCRIPTION	QTY
19-1	112111-01	BLADE 16.25 OFFST HLFT	3	19-53	64205-007	BLT-MET M10-1.5 X 20	6
19-2	128169	PULLEY, IDLER 5.50	1	19-54	64166-17	BLT-SHLDR 3/8-16 X 1.12	4
19-3	2183070-01	SHAFT-SPINDLE LONG	1	19-55	64197-003	BLT-THRDFM 3/8-16 X 1	23
19-4	2183070-02	SHAFT-SPINDLE	2	19-56	64123-87	BLT-HEX 3/8-16 X 1-3/4	2
19-5	2186125	WLDMT-LOCK, PUSHBAR	2	19-57	64205-001	BLT-MET M8-1.25 X 20	2
19-6	2186164.7	WLDMT-DECK IDLER	1	19-58	64205-004	BLT-MET M10-1.5 X 110	3
19-7	2186185.7	WLDMT-PUSHBAR	2	19-59	64141-4	NUT-WLF 3/8-16	8
19-8	2188142-01	ROD END 5/8	2	19-60	64205-009	BLT-METRIC M10-1.5X65	2
19-9	2188162	SPACER-BLADE	3	19-61	64205-012	BLT-MET M10-1.50 X 90	1
19-10	2188131	SPRING-EXTENSION	2	19-62	A1104057	BOLT-M10-1.50 X 25	28
19-11	2308140	PULLEY-ENGINE	4	19-63	64209-03	SPRING WASHER	6
19-12	2720896	S-DECK 48 SD W/LABS	1	19-64	64229-03	LOCKNUT-NYLON 3/8-16	4
19-13	2720631.7	BRKT-DECK HANGER LH	1	19-65	64229-06	LOCKNUT-NYLON 5/8-11	2
19-14	2720632.7	BRKT-DECK HANGER RH	1	19-66	64237-03	LOCKNUT-NYLON M10-1.5	25
19-15	2720633.7	BRKT-HANGER REAR	2	19-67	64237-05	NUT-WLF M8-1.25	2
19-16	2720634.7	BRKT-PUSHARM MTG	2	19-68	64246-03	NUT-WLF M10-1.5	4
19-17	2720637.5	COVER-BELT LH	1	19-69	64251-004	WASHER-M10	8
19-18	2720638.5	COVER-BELT RH	1	19-70	2228034	PULLEY-5.25 DEEP GRV	1
19-19	2720649.7	BRKT-SPRING ANCHOR	1	19-71	64018-5	BLT-CRG 3/8-16X1-3/4	2
19-20	2720655.7	WLDMT-IDLER ARM	1	19-72	38348-01	BEARING-SPINDLE	6
19-21	2720661	SHAFT-PIVOT	1	19-73	2221000	SPINDLE HOUSING	3
19-22	2720673.5	WLDMT-ROLLER BRKT LH	1	19-74	64144-38	SNAP-RING	3
19-23	2720676.5	WLDMT-ROLLER BRKT RH	1	19-75	2722543-01	BLADE-16.25 ELIMINATOR (OPTIONAL)	3
19-24	2720677.5	BRKT-ROLLER LH	1				
19-25	64018-2	BLT-CRG 1/4-20X3/4	2				
19-26	38315	NUT-SPINDLE	3	19-76	64221-04	E-RING.875	1
19-27	2720685	SPACER-ROLLER	3				
19-28	2721168	S-DECK STIFFNR W/LABS	1				
19-29	4116661	PIN-PIVOT	1				
19-30	2720758	ASSY-SPINDLE CENTER	1				
19-31	2720759	ASSY-SPINDLE	2				
19-32	32723.5	CHUTE-DISCHARGE	1				
19-33	38297	PULLEY-IDLER	1				
19-34	2720784.7	BAFFLE-FRONT RH	1				
19-35	4114063.7	BAFFLE-FRONT LH	1				
19-36	38524	KNOB-4 PRONG 3/8-16	2				
19-37	2721512	ROLLER-5X2.75 CENTERED	3				
19-38	48393	PULLEY-V-IDLER	1				
19-39	64001-1	NUT-HEX JAM, 5/8-18	2				
19-40	64006-05	LOCKWASHER-1/2	1				
19-41	64123-05	BLT-HEX 1/2-20 X 1-1/2	1				
19-42	64123-206	BLT-HEX 5/8-11 X 4-1/4	2				
19-43	64123-208	BLT-HEX 5/8-18 X 1-1/2	3				
19-44	64123-209	BLT-HEX 5/8-18 X 3-1/2	3				
19-45	64123-50	BLT-HEX 3/8-16 X 1	2				
19-46	64229-01	NUT-NYLON 1/-20	2				
19-47	64163-22	WASHER-1-1/32X1-3/4X1/2	1				
19-48	64163-46	WASHER-.383/.393X.88	3				
19-49	64221-04	E-RING.875	1				
19-50	64163-65	WASHER-.890X1.375X18GA	4				
19-51	64163-73	WASHER-.625X1.12X.062	2				
19-52	64164-12	KEY-SQUARE-1/4 X 1/4 X 1	4				

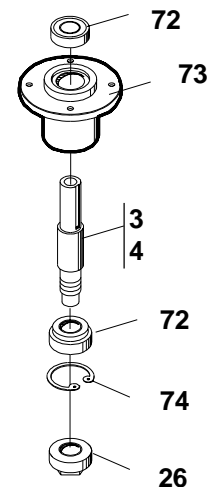

**2720758-ASSY TOP SPINDLE CENTER
(INCLUDES ITEMS 3, 26 & 72-74)**

**2720459-ASSY TOP MOUNT SPINDLE
(INCLUDES ITEMS 4, 26 & 72-74)**

FIGURE 20

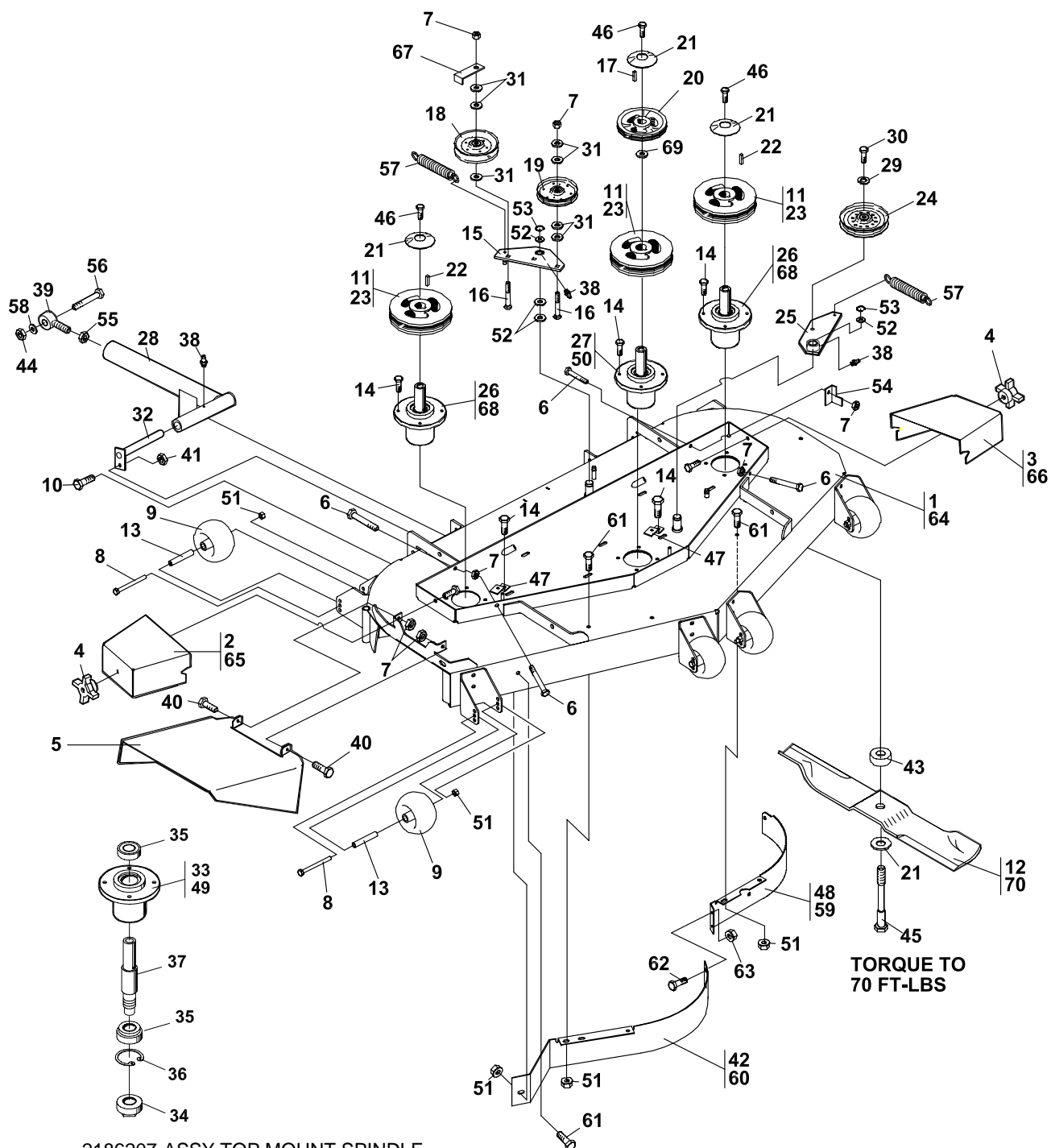

- 2186207-ASSY TOP MOUNT SPINDLE
- 2186205-ASSY TOP MOUNT SPINDLE
(INCLUDES ITEMS 33-37)
- 2720759-ASSY TOP MNT SPINDLE 52"
- 2720758-ASSY TOP MNT SPINDLE 52"
(INCLUDES ITEMS 34-37, 49)

BZT 2000 Series

2722089-20

52" & 61" SIDE DISCHARGE

FIGURE 20

ITEM	PART NO.	DESCRIPTION	QTY	ITEM	PART NO.	DESCRIPTION	QTY
20-1	4113651	S 52INCH DECK W/LABELS	1	20-35	38348-01	BEARING-SPINDLE	6
20-2	2182458.5	BELT COVER RH (USE ON 52" SD DECK ONLY)	1	20-36	64144-38	SNAP-RING	3
20-3	2182459.5	BELT COVER LH (USE ON 52" SD DECK ONLY)	1	20-37	2183070-01	SHAFT-SPINDLE LONG (USED IN ASSY 2186207)	1
20-4	38524	KNOB-4 PRONG 3/8-16	2		2183070-02	SHAFT-SPINDLE (USED IN ASSY 2186205)	2
20-5	2302092.5	CHUTE-MID 61 (USE ON 61" SD DECK ONLY)	1	20-38	85010N	STRAIGHT ZERK FTTG	6
	32723.5	CHUTE-DISCHARGE MIDSZ (USE ON 52" SD DECK ONLY)	1	20-39	2188142-01	ROD, END 5/8	2
20-6	64166-17	BLT-SHLDR 3/8-16X1.12	4	20-40	64123-50	BLT-HEX 3/8-16X1	2
20-7	64229-03	LOCKNUT NYLON 3/8-16	8	20-41	64237-05	LOCKNUT-NYLON M8-1.25	2
20-8	64205-004	BOLT-MET M10-1.5X110 (USE QTY 6 ON 52", QTY 7 ON 61")		20-42	4117664.7	BAFFLE-FRONT CENTER (USE ON 61" SD DECK ONLY)	1
20-9	2721512	ROLLER-5X2.75 CENTERED (USE QTY 6 ON 52", QTY 7 ON 61")		20-43	2188162	SPACER-BLADE	3
20-10	64205-001	BLT-MET M8-1.25X20	2	20-44	64229-06	LOCKNUT-NYLON 5/8-11	2
20-11	2308140	PULLEY ENGINE (USE ON 52" SD DECK ONLY)	3	20-45	64123-209	BLT-HEX 5/8-18X3.5	3
20-12	112111-03	BLADE 21.0 OFFST (USE ON 61" SD DECK ONLY)	3	20-46	64123-208	BLT-HEX 5/8-11X1 1/2	3
	112111-02	BLADE 18.0 OFFST (USE ON 52" SD DECK ONLY)	3	20-47	32767.7	SUPPORT-BELT (USE ON 61" SD DECK ONLY)	2
20-13	2720685	SPACER-ROLLER (USE QTY 6 ON 52", QTY 7 ON 61")		20-48	4117663.7	BAFFLE-FRONT LH (USE ON 61" SD DECK ONLY)	1
20-14	64197-003	BLT-TDFM 3/8-16X1 (USE QTY 14 ON 61", QTY 12 ON 52")		20-49	2221000	HOUSING-SPINDLE 52" (USE ON 52" SD DECK ONLY)	3
20-15	4121584.7	WLDMT-PTO IDLER	1	20-50	2720758	ASSY-TOP MNT SPINDLE 52" (INCLUDES ITEMS 34-37, 49) (USE ON 52" SD DECK ONLY)	1
20-16	64018-18	BOLT-CARRIAGE 3/8-16X2	2	20-51	64237-03	LOCKNUT-NYLON M10 (USE QTY 12 ON 52", QTY 13 ON 61")	12
20-17	64164-13	1/4X1/4X2 SQ END KEY	1	20-52	64163-65	WSHR .890X1.375X18 GA	4
20-18	48393	PULLEY, V IDLER	1	20-53	64221-04	E-CLIP .875	2
20-19	38297	IDLER, 5.0 OD FLNGD	1	20-54	2182437.7	GUIDE-BELT (USE ON 61" SD DECK ONLY)	1
20-20	128011	PULLEY, DECK DRIVE (USE ON 61" SD DECK ONLY)	1	20-55	64001-1	NUT-JAM 5/8-18	2
20-21	64209-03	SPRING WSHR .67 ID	6	20-56	64123-206	BLT-HEX 5/8-11X4.5	2
20-22	64164-12	1/4X1/4X1 SQ END KEY	2	20-57	2188131	SPRING-EXTENSION	2
20-23	31012A	ENGINE PULLEY (USE ON 61" SD DECK ONLY)	3	20-58	64163-73	WSHR-FLT .625IDX.062	A/R
20-24	128169	PULLEY, IDLER 5.50"	1	20-59	4114038.7	BAFFLE-FRONT LH (USE ON 52" SD DECK ONLY)	1
20-25	2186138.7	WLDMT-DECK IDLER (USE ON 61" SD DECK ONLY)	1	20-60	2182496.7	BAFFLE-FRONT RH (USE ON 52" SD DECK ONLY)	1
	2186164.7	WLDMT-DECK IDLER (USE ON 52" SD DECK ONLY)	1	20-61	64205-007	BLT MET M10-1.50X20	6
20-26	2720759	ASSY-TOP MNT SPNDLE 52" (INCLUDES ITEMS 34-37, 49) (USE ON 52" SD DECK ONLY)	2	20-62	64018-2	BLT-CRG 1/4-20X3/4	2
20-27	2186207	ASSY-TOP MNT SPNDL (INCLUDES ITEMS 33-37) (USE ON 61" SD DECK ONLY)	1	20-63	64229-01	LOCK NUT-NYL 1/4-20	2
20-28	2186185.7	WLDMT-PUSHBAR	2	20-64	4113514	S 61 CUTTERDECK W/LABS	1
20-29	64006-05	LCKWSHR HELICAL 1/2	1	20-65	2182352.5	BELT COVER RH (USE ON 61" SD DECK ONLY)	1
20-30	64123-05	BLT-HEX 1/2-20X1 1/2	1	20-66	2182351.5	BELT COVER LH (USE ON 61" SD DECK ONLY)	1
20-31	64163-46	WSHR .383/.393 X 7 GA	7	20-67	2302125.7	GUIDE-BELT	1
20-32	2186125	WLDMT-LOCK PSHBR	2	20-68	2186205	ASSY-TOP MNT SPNDL (INCLUDES ITEMS 33-37) (USE ON 61" SD DECK ONLY)	2
20-33	2191000.7	SPINDLE HOUSING (USE ON 61" SD DECK ONLY)	3	20-69	64163-64	WSHR 1.015X1.500X14GA	1
20-34	38315	NUT-SPINDLE	3	20-70	2722543-03	BLADE-21.00 ELIMINATOR (OPTIONAL ON 61" SD DECKS ONLY)	3
					2722543-02	BLADE-18.00 ELIMINATOR (OPTIONAL ON 52" SD DECKS ONLY)	3

FIGURE 21

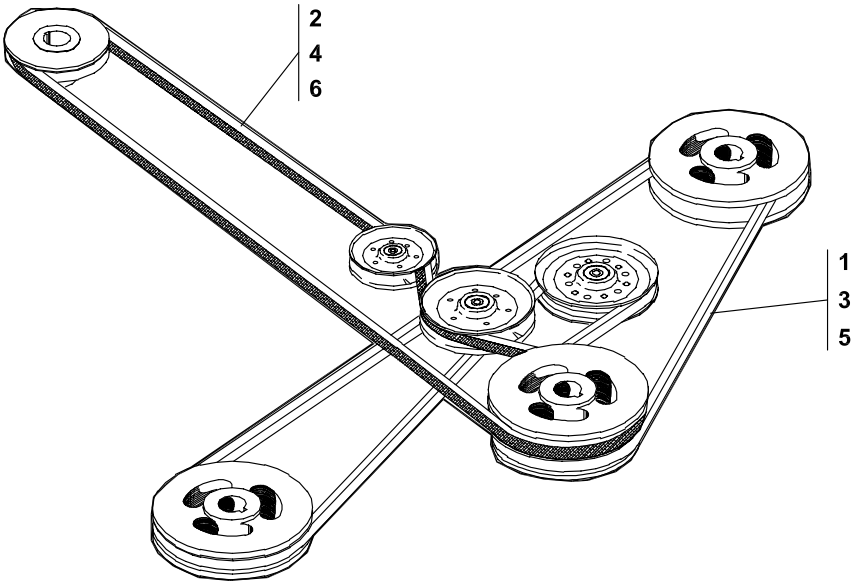

BZT 2000 Series

BELTS

2720451

FIGURE 21

ITEM	PART NO.	DESCRIPTION	QTY	ITEM	PART NO.	DESCRIPTION	QTY
21-1	2188176	BELT-CUTTERDECK 54	1				
21-2	2188175	BELT-PTO 54 (USE ON 52" SD DECK)	1				
21-3	128003	BELT-CUTTERDECK	1				
21-4	2188134	BELT-PTO (USE ON 61" SD DECK)	1				
21-5	128110	BELT-CUTTERDECK	1				
21-6	2720815	BELT-PTO (USE ON 48" SD DECK)	1				

World Class Quality, Performance And Support

Equipment from Textron Golf, Turf & Specialty Products is built to exacting standards ensured by ISO 9001 registration at all our manufacturing locations.

A worldwide dealer network and factory-trained technicians backed by Textron Parts Xpress provide reliable, high-quality product support.



BOB-CAT BUNTON CUSHMAN JACOBSEN RANSOMES RYAN

1451 Marvin Griffin Rd, Augusta, GA 30906
www.textron.com