



TECHNICAL MANUAL

Safety, Operation, Set-up, Parts

Model:
544856A TOTE TRAILER



WARNING: If incorrectly used this machine can cause severe injury. Those who use and maintain this machine should be trained in its proper use, warned of its dangers and should read the entire manual before attempting to set up, operate, adjust or service the machine.



521663 REV 06

CALIFORNIA
Proposition 65 Warning

Diesel engine exhaust and some of its constituents are known to the State of California to cause cancer, birth defects and other reproductive harm.



WARNING

The engine exhaust from this product contains chemicals known to the State of California to cause cancer, birth defects or other reproductive harm.

Californie Proposition 65
Avertissement

Les échappements des moteurs diesel et certains de leurs composés sont reconnus par l'Etat de Californie pour être cancérigènes, provoquer des défauts congénitaux et d'autres dangers en matière de reproduction.



AVERTISSEMENT

L'émission du moteur de ce matériel contient des produits chimiques que l'Etat de Californie considère être cancérigènes, provoquer des défauts congénitaux et d'autres dangers en matière de reproduction.

California Advertencia
de la Proposicion 65

El estado de California hace saber que los gases de escape de los motores diesel y algunos de sus componentes producen cáncer, defectos de nacimiento y otros daños en el proceso de reproducción humana.



ADVERTENCIA

El estado de California hace saber que los gases de escape de este producto contienen productos químicos que producen cáncer, defectos de nacimiento y otros daños en el proceso de reproducción humana.

TOTE TRAILER

IMPORTANT MESSAGE

Thank you for purchasing this Ryan product. You have purchased a world class product, one of the best designed and built anywhere.

This machine comes with a Technical Manual containing safety, operation, parts, maintenance and service information. The useful life and good service you receive from this machine depends to a large extent on how well you read and understand this manual. Treat your machine properly, lubricate and adjust it as instructed, and it will give you many years of reliable service.

Your safe use of this Ryan product is one of our prime design objectives. Many safety features are built in, but we also rely on your good sense and care to achieve accident-free operation. For best protection, study the manual thoroughly. Learn the proper operation of all controls. Observe all safety precautions. Follow all instructions and warnings completely. Do not remove or defeat any safety features. Make sure those who operate this machine are as well informed and careful in its use as you are.

See a Ryan dealer for any service or parts needed. Ryan service ensures that you continue to receive the best results possible from Ryan's products. You can trust Ryan replacement parts because they are manufactured with the same high precision and quality as the original parts.

Ryan designs and builds its equipment to serve many years in a safe and productive manner. For longest life, use this machine only as directed in the manual, keep it in good repair and follow safety warnings and instructions. You'll always be glad you did.

Jacobsen, a Textron Company
One Bob Cat Lane
Johnson Creek, WI 53038-0469

TABLE OF CONTENTS	FIGURES	PAGE
SAFETY		2
SETUP		3-6
LOADING		7-11
TRANSPORTING		12
UNLOADING		13, 14
PARTS SECTION		15
FENDER AND LIGHT KIT ASSEMBLY	FIGURE 1	16, 17
TRAILER FRAME	FIGURE 2	18, 19
ACCESSORIES	FIGURE 3	20, 21

NOTICE !!!

Unauthorized modifications may present **extreme** safety hazards to operators and bystanders and could also result in product damage.

Jacobsen, a Textron Company strongly warns against, rejects and disclaims any modifications, add-on accessories or product alterations that are not designed, developed, tested and approved by Jacobsen Engineering Department. Any Jacobsen product that is altered, modified or changed in any manner not specifically authorized after original manufacture—including the addition of “after-market” accessories or component parts not specifically approved by Jacobsen—will result in the Jacobsen Warranty being voided.

Any and all liability for personal injury and/or property damage caused by any unauthorized modifications, add-on accessories or products not approved by Jacobsen will be considered the responsibility of the individual(s) or company designing and/or making such changes. Jacobsen will vigorously pursue full indemnification and costs from any party responsible for such unauthorized post-manufacture modifications and/or accessories should personal injury and/or property damage result.



This symbol means:
ATTENTION!
BECOME ALERT!

Your safety and the safety of others is involved.

Signal word definitions:

The signal words below are used to identify levels of hazard seriousness. These words appear in this manual and on the safety labels attached to Jacobsen machines. For your safety and the safety of others, read and follow the information given with these signal words and/or the symbol shown above.

DANGER

DANGER indicates an imminently hazardous situation which, if not avoided, **WILL** result in death or serious injury.

WARNING

WARNING indicates a potentially hazardous situation which, if not avoided, **COULD** result in death or serious injury.

CAUTION

CAUTION indicates a potentially hazardous situation which, if not avoided, **MAY** result in minor or moderate injury. It may also be used to alert against unsafe practices or property damage.

CAUTION

CAUTION used without the safety alert symbol indicates a potentially hazardous situation which, if not avoided, **MAY** result in property damage.

GENERAL NOTE: USE THE OPERATORS/OR DRIVERS SIDE POSITION WHEN DETERMINING THE REFERRAL TO THE LEFT AND/OR RIGHT SIDES OF ANY EQUIPMENT REFERRED TO IN THIS MANUAL.

⚠ WARNING

To prevent malfunction and/or injury to the operator and/or bystanders, use only genuine RYAN parts or parts with equivalent characteristics, including type, strength, and materials, when replacement parts are needed.

Any warning decal that becomes illegible should be replaced immediately.

MOUNTING WHEELS AND FENDERS

Before mounting the wheels to the frame, pack the wheel bearings with a lithium based lubricant.

Clean off any residue which may be accumulated on the axle shafts.

1. Install the wheels to the axles with the seal side of wheel going on first and the valve stem facing outward.
2. Install and tighten the nut, turning the wheel frequently until the wheel starts to drag. Back off the nut approximately 1/16" (2 mm) of a turn, or just enough to allow the cotter pin to fit through the end of the shaft.
3. Check the wheel for free rotation. Wheel should spin freely without any noticeable drag.
4. Install end cap on the hub.
5. Attach the fenders to their respective sides keeping the brackets tight against the frame while tightening the 5/16-18 x 3" and the 5/16-18 x 2" screws.
6. In the hole provided on top of the fender mounting brackets **A**, center punch, then drill a 7/32" (6 mm) hole through the top of the frame **B** only. Install a shakeproof lockwasher and a 1/4-20 x 1/2" (6.35 mm) self tapping screw **C** to help secure fender brackets.

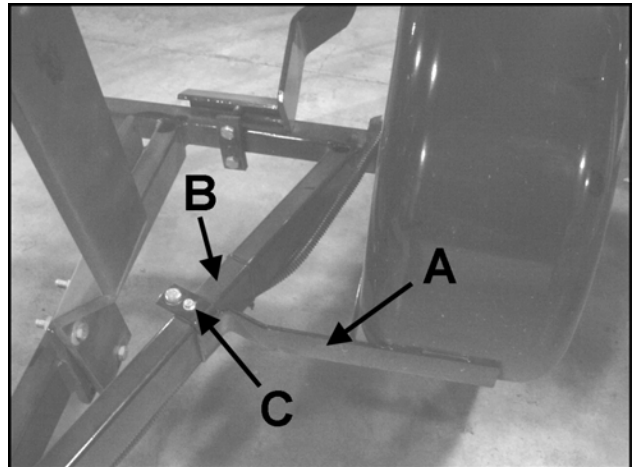

ELECTRICAL

1. Replace the lockwashers provided with the light kit with the shakeproof lockwashers provided with the hardware bag.
2. Attach the taillight with the clear lens and the license plate bracket to the left fender. Make sure the clear lens is pointing down to light the license plate. Attach the other taillight to the right fender. Be sure to use the shakeproof lockwashers when mounting the taillights.
3. Take the longest piece of the three-strand electrical wire, provided with the light kit, solder the electrical terminal from the hardware bag, onto the end of the white wire.
4. Locate and drill one 7/32" (6 mm) hole on the top of the left frame member approximately 3" (76 mm) from the back of the trailer hitch. Scrape the paint off the frame around the hole to ensure a good ground. Attach terminal **E** (on white wire) to frame using a 1/4 -20 x 1/2" (6.35 mm) self tapping screw **F**. Secure the wires with a wire tie just in front of the terminal.
5. Run the length of the three-strand wire towards the rear, staying on the inside of the left frame member and going under any cross-members. Pass the wire behind the bolt of the fender bracket.
6. Beginning behind the electrical terminal and decal, on the front of frame, wrap another wire tie and continue towards the rear using three more wire ties. Hold the wire near the axle and run it along the fender bracket and fender making sure there is enough wire to attach to the wires leading from the taillight. Cut off the excess wire. Wrap a wire tie around the wire and frame close to the axle.
7. Push the brown and green (or black and green) two-strand electrical wire through the black tubing (from the hardware bag) leaving an equal amount of wire exposed at each end of the black tubing.

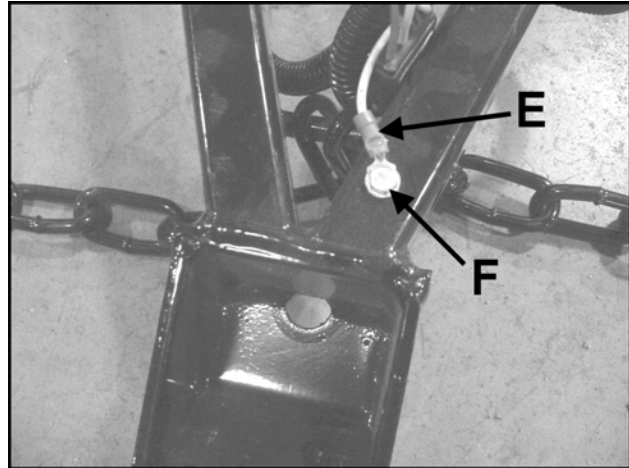

8. Referring to the wiring diagram attach the two-strand wire to the right taillight using connectors provided. Run the wire and tubing down the fender bracket **G** and over the front side of the axle. Place a wire clip **H** onto the taillight bracket **J** and two onto the fender bracket **G**. Slip the wire into these clips keeping the wire taut to avoid any unnecessary slack. Keep the wire connectors **K** within the taillight bracket **J**.

NOTE: Make sure the black tubing covering the electrical wire is against any edge which may cause the wiring to be cut or damaged.

9. Place the wire and tubing along the bottom side of the axle and secure with wire ties. Place one wire tie near the frame member closest to the wheel, one in the center and one near the frame member on the left side.

Place the remaining wire ties so they do not interfere with the adjustment of the wheel stops.

10. Wire the left taillight according to the wiring diagram. Place wire clips and connectors in similar locations to the right taillight.
11. Referring to the wiring diagram attach the trailer's wire leads to the vehicle. Turn on the headlights and check the trailer lights, only the taillights should be lighted. Depress the brake pedal to see if the brake lights are working properly. Turn on each turn signal and check to see if they are working properly. If the turn signals and/or the taillights do not work, check all the grounds for proper contact and review the wiring diagram to be sure all wires are correctly connected.

NOTE: The taillights in the kit are provided with 12-volt bulbs. If the towing vehicle is equipped with a 6-volt battery replace each stop and tail bulb with a number 1154 bulb. These bulbs are available at most garages and service stations.

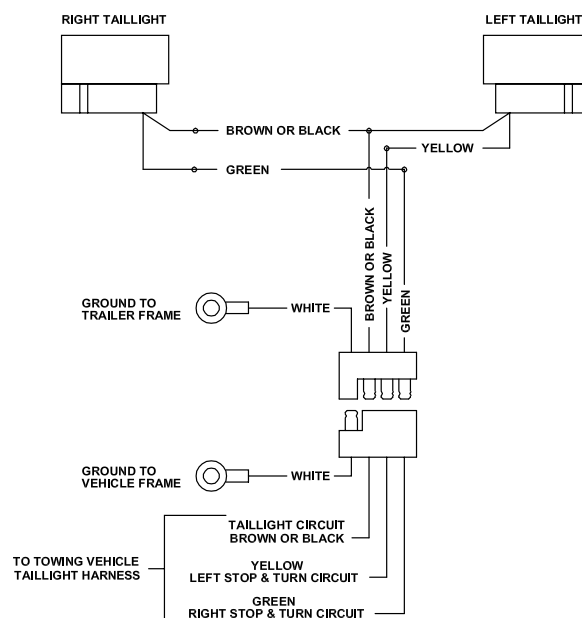

WIRING DIAGRAM

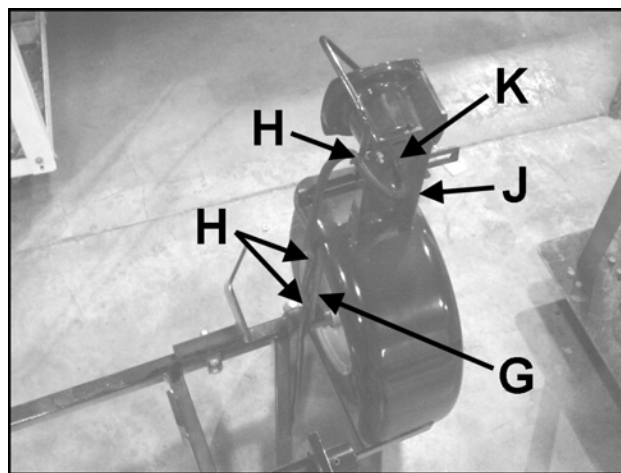

HITCH ASSEMBLY

1. Slide the bolt **A** through the ball clamp **B** so that the head of the bolt is positioned in between the slots on the bottom side of the clamp (this is to prevent the bolt from turning while tightening the hitch into position on the transporting vehicle).
2. Place the spring **C** over the bolt **A** and onto the top of the ball clamp **B**. From underneath the hitch end, push the locking lever handle **D** through the square hole leaving the eyelet inside the hitch. Push the bolt assembly, from below, through the eyelet of the locking lever and on through the hitch end. Install the handle **E** to complete the assembly.

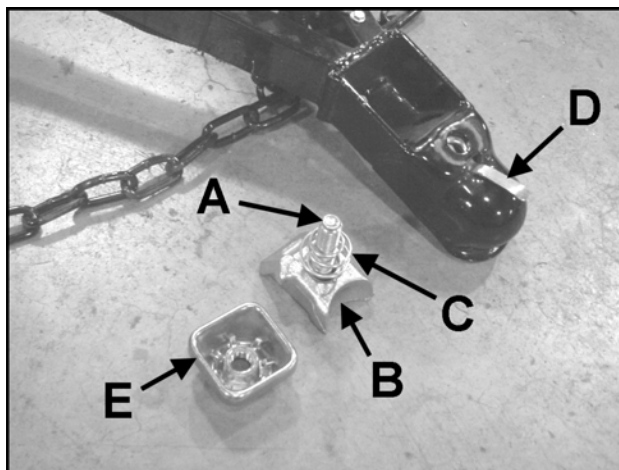

⚠ WARNING

Do not attempt to load the unit on the trailer until you have read and understand the Operation and Transportation section.

To prevent possible injury, load and unload the trailer on a level surface.

To prevent possible injury from the trailer tongue raising suddenly and striking the operator, maintain a firm grip on the trailer tongue while removing the locking shaft while loading or unloading equipment.

To keep the trailer from rolling and causing serious injury, place blocks in front and back of both tires before loading and unloading any unit from the trailer.

LOADING THE LAWNNAIRE IV

NOTE: When tipping the trailer to load and unload, use care to avoid taillight damage.

1. Attach the mounting masts **E** to the forward mounting tabs **F** on the trailer frame using the 5/16-18 x 1 1/4" screws and locknuts. Secure the center hole on the bottom of mounting mast to the bottom forward hole on the mounting tab. Lean mast rearward and secure upper holes in mast to upper holes in forward mounting tab. The slotted holes on the masts go toward the rear and the three tabs on the left mounting mast face outward. Only three bolts for each mast will be used with this application.

NOTE: IF YOUR TOTE TRAILER MODEL IS 1992 OR NEWER, THE LOCKING LEVER WILL HAVE TWO HOLES DRILLED IN IT. THE LOWER HOLE **G** IS FOR USE WITH THE LAWNNAIRE V ONLY.

2. Mount the wheel stops onto the frame using the 3/8-16 x 2 1/4" screws and nuts. Do not tighten. The bottom screw will pass between the frame and the electrical wiring. The left wheel stop **H** will be located on the inside of the frame member, the right wheel stop **J** (with locking lever in the up position) will be located on the outside of the frame member. The Lawnnaire IV (when mounted) will be slightly off center but will still transport without any problems. If the Lawnnaire IV is equipped with narrow tires, the stop brackets will both be located on the inside of the frame members.

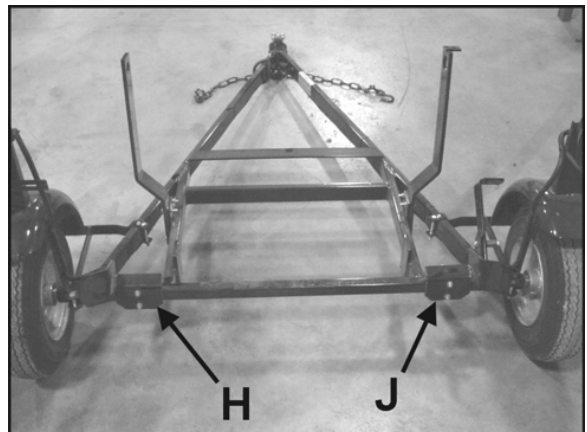
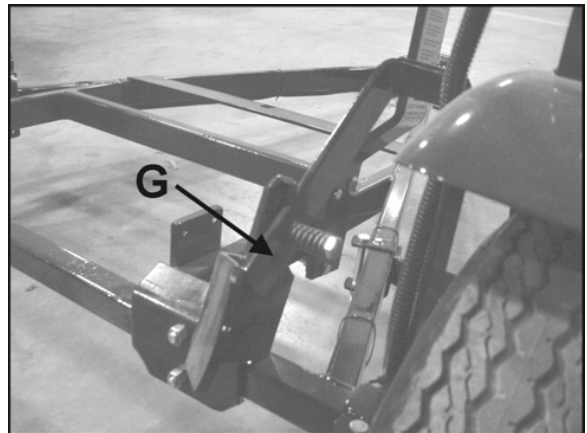
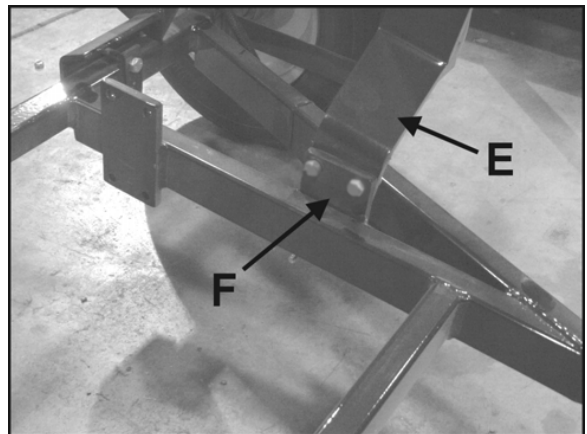

3. Remove the plug from Lawnaire IV's water drum and drain. While the water is draining, remove the weight bar from the center of the Lawnaire IV and remove the locking shaft from the mounting masts on the trailer. After the drum has drained, tip the Lawnaire IV back until the handlebars support the aerator on the ground.
4. Holding the hitch end of the tote trailer push trailer to the aerator and tipping the trailer back, center the Lawnaire IV between the mounting masts. Align the **CENTER** holes on the mounting masts with the hole in the **CENTER** of the Lawnaire IV frame (where weight bar was located). Once holes are aligned, slide the locking shaft **K** through from the right side and secure the locking pins **L**.
5. Pull down on the hitch of the trailer and lower the hitch to the ground. Position the Lawnaire IV so that it aligns with the stop assemblies. Adjust the stop assemblies to leave approximately a 1/4" (6 mm) space between the stop assembly and the wheel. Tighten stops securely. Place the wheel locking lever **M** over the right wheel and prepare tote trailer for towing. Refer to the instructions and precautions for transporting the tote trailer.

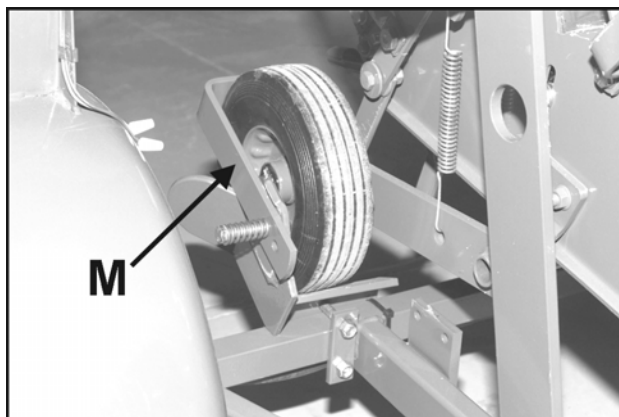
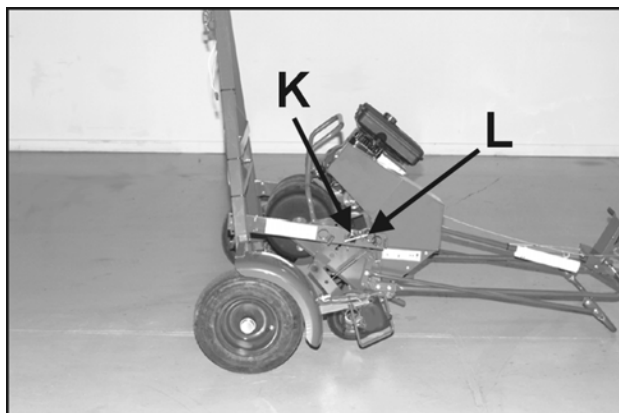

LOADING THE JR. SODCUTTER

NOTE: When tipping the trailer to load and unload, use care to avoid taillight damage.

1. Using four 5/16-18 x 1 1/4" screws and locknuts, attach the mounting masts **A** to the rear mounting tabs **B** on the trailer frame. The tabs on the left mounting mast face outward. The slotted bolt holes on the masts will be toward the rear. Secure masts to the mounting tabs.

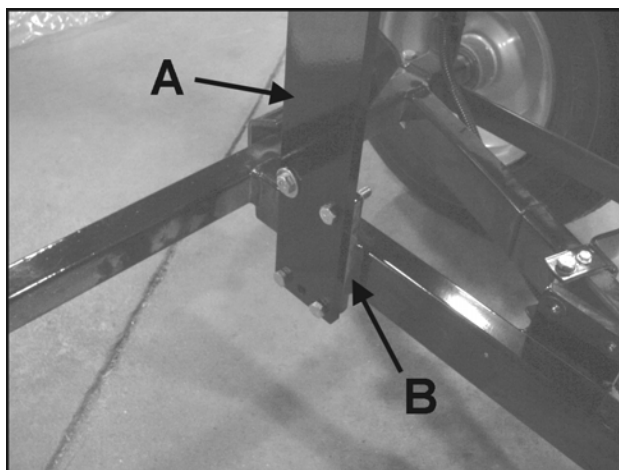

NOTE: IF YOUR TOTE TRAILER MODEL IS 1992 OR NEWER, THE LOCKING LEVER WILL HAVE TWO HOLES DRILLED IN IT. THE UPPER HOLE **C** IS FOR USE WITH THE JR. SODCUTTER.

2. Using the 3/8-16 x 2 1/4" screws and locknuts mount the wheel stops **D** to the rear axle frame. Do not tighten. Position the wheel stops on the inside of the frame members the approximate width of the tires on the sodcutter.
3. With the locking shaft removed from the mounting masts on the trailer, grasp the hitch of the trailer and push it towards the sodcutter. Tip trailer so the sodcutter is centered between the mounting masts.
4. Tip the trailer until the top mounting holes on the mounting masts are aligned with the mounting holes in the sodcutter's A-frame. Slide the locking shaft **E**, from the right side, into place and secure with the locking pins **F**.

⚠ WARNING

After the trailer is positioned and the locking shaft is in place (prior to lifting the sodcutter off the ground) place blocks in front and back of both tires, to prevent the trailer from rolling while lifting sodcutter off the ground. Before unloading the sodcutter, block the tires to prevent possible injury.

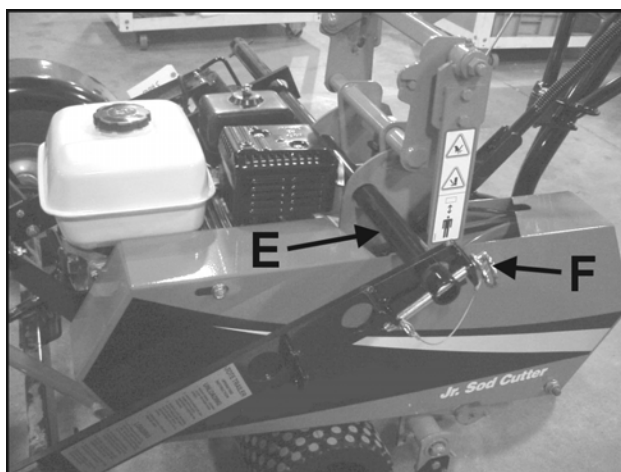
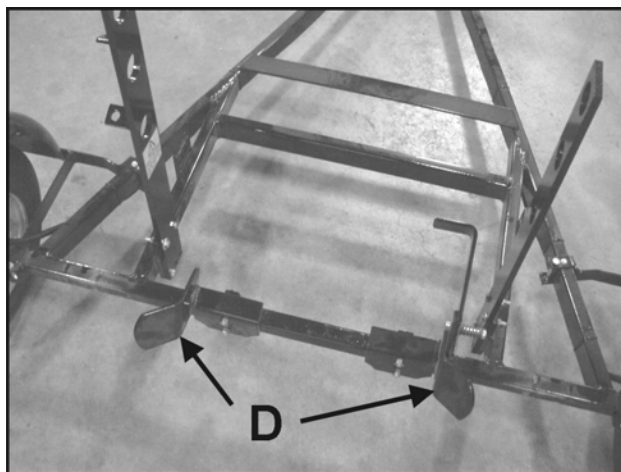
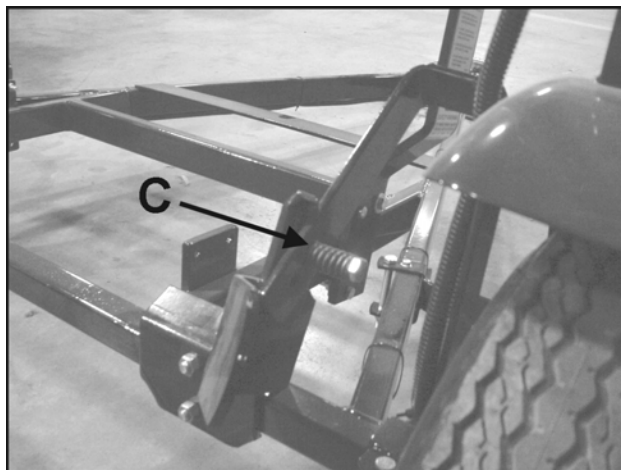

5. Pull down on the trailer lifting the sodcutter off the ground and lower the trailer hitch to the ground.
6. Center the sodcutter on the trailer then adjust the wheel stops so there is approximately a 1/4" (6 mm) space between the stop and the wheels. Tighten the wheel stops and lock the wheel locking lever **G** into position.

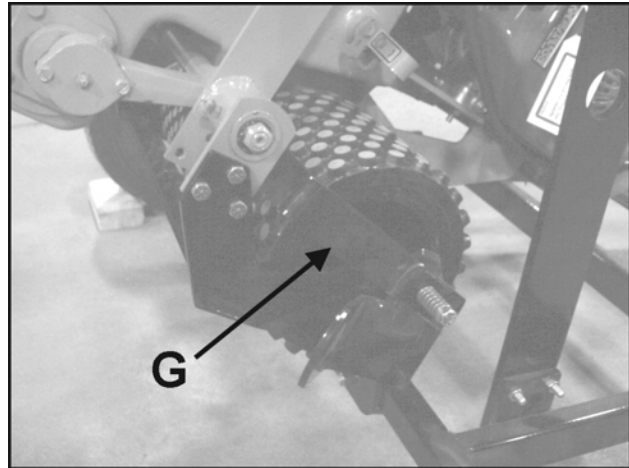

LOADING THE LAWNHAIRE V

NOTE: When tipping the trailer to load and unload, use care to avoid taillight damage.

1. Attach the mounting masts **E** to the forward mounting tabs **F** on the trailer frame using three 5/16-18 x 1-1/4" screws and nuts. Use the center bolt hole on the bottom of the masts for the bottom forward hole position. Lean the masts toward the rear. The slotted holes on the masts go toward the rear and the tab on the left mounting mast faces outward.

NOTE: IF YOUR TOTE TRAILER MODEL IS 1991 OR PRIOR, PROCEED WITH ASSEMBLY STEPS 2 THRU 5. IF YOUR TOTE TRAILER MODEL IS 1992 OR NEWER, CHECK THE HOLE POSITION OF THE LOCKING LEVER ON THE WHEEL STOP. IF IT IS NOT CORRECT FOR YOUR APPLICATION REFER TO THE FOLLOWING INSTRUCTIONS FOR REMOVAL AND INSTALLATION.

2. Remove the locking lever from the wheel stop provided with the tote trailer. Remove the 3/8-16 x 2-1/4" screw, locknut and spring securing the locking lever to the wheel stop.
3. Using the locking lever provided with the Lawnaire V Accessory Kit, attach the locking lever onto the wheel stop using the BOTTOM hole **G** of the locking lever. Reverse the procedure in Step 2 for installation.

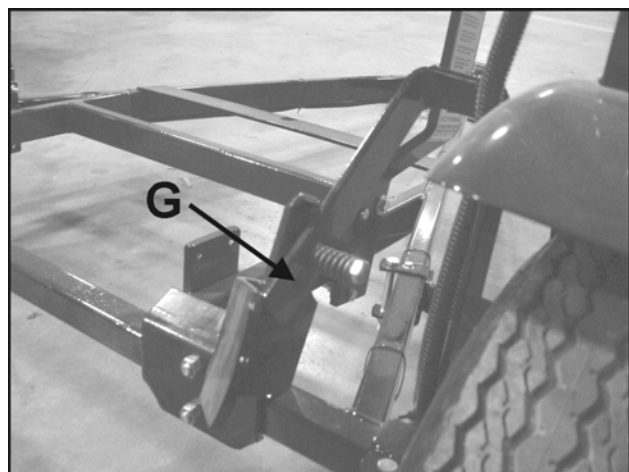
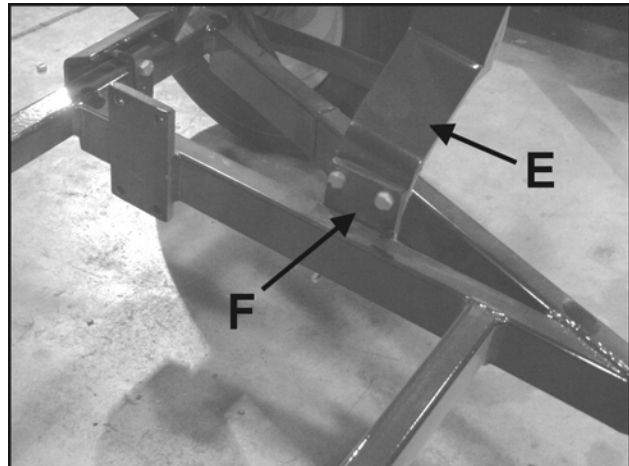

4. Mount the left wheel stop **H** and the right wheel stop (with the locking lever) **J** onto the frame positioned at their farthest allowable width. Do not tighten.
5. Remove the plug from Lawnaire V's water drum and drain all the water. While the water is draining, remove the weight bar from the center of the Lawnaire V and remove the locking shaft from the mounting masts on the trailer. When the drum is drained, tip the Lawnaire V back until the handlebars support the aerator on the ground.
6. Holding the hitch end of the tote trailer push it to the aerator. Tip the trailer back and center the Lawnaire V between the mounting masts. Align the holes on the mounting masts with the hole in the center of the Lawnaire V frame (where weight bar was located). Once holes are aligned, slide the locking shaft **N** through from the right side. Secure shaft with the locking pins **O**.
7. Pull down on the hitch of the trailer and lower the hitch to the ground. Position the Lawnaire V so that it aligns with the stop assemblies. Adjust the stop assemblies to leave approximately a 1/4" (6 mm) space between the stop assembly and the wheel. Tighten stops securely. Place the wheel locking lever **M** over the right wheel and prepare tote trailer for towing. Refer to the instructions and precautions for transporting the tote trailer.

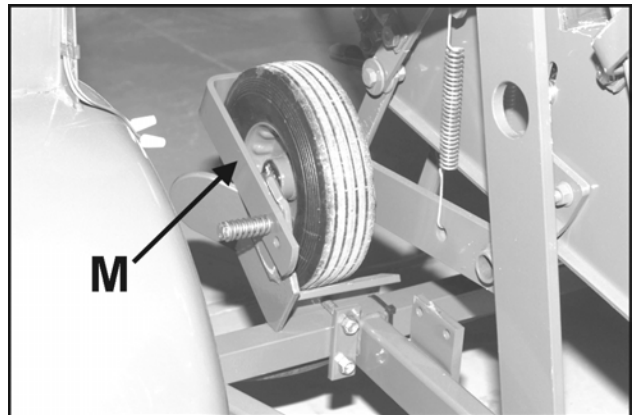
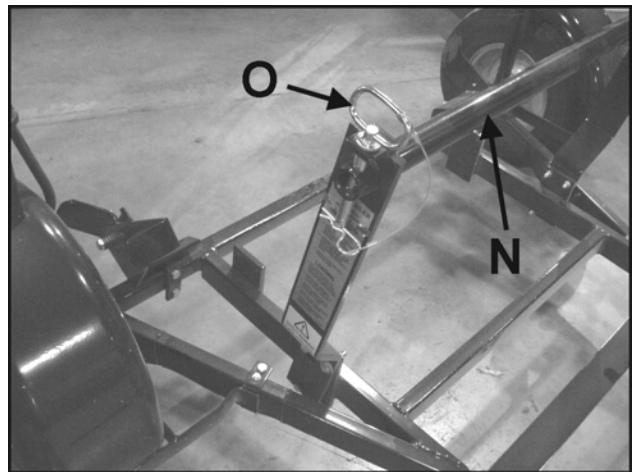
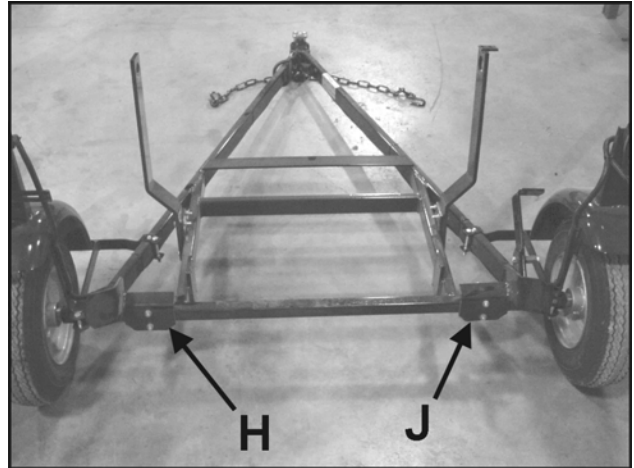

TRANSPORTING

WARNING

To prevent injury or property damage, make sure the safety chains are securely attached to the towing vehicle.

1. Attach the tote trailer to the towing vehicle for transporting to the job site. After the ball-hitch is properly secured, connect the electrical plugs and secure the chains to the towing vehicle with sufficient slack to allow trailer to turn.
2. Maximum towing speed is 35 mph (56 km/h).

WARNING

Use caution when inflating a tire, or bringing a low tire up to recommended pressure. Use a pressure gauge to check the pressure in a partially inflated tire before connecting an air hose. Due to the low air volume requirements of small tires, over-inflation may be reached in a matter of two or three seconds, which may cause the tire to explode.

3. Proper tire inflation is 20 psi (138kPa). Improper inflation will shorten the life of the tire and could cause the tote trailer to pull erratically.

UNLOADING THE LAWNAIRE IV

1. With tote trailer on a level surface, unhook the trailer from the towing vehicle and move the trailer so there is enough room to tip the trailer up without injuring the operator or damaging any property.
2. Make sure the wheel stops are not against the wheels to prevent the Lawnaire IV from swinging freely. Block the tires as instructed in the safety warning.
3. Grasping the hitch of the trailer slowly tip the trailer up until the unit is resting on the ground. Remove the locking pins from the locking shaft and tip the trailer so there is no pressure on the locking shaft. Slide the locking shaft out of the aerator and pull the trailer away from the unit.
4. Install the weight bar on the Lawnaire IV. Fill the water drum and check engine and reduction case oil levels before beginning to aerate. Visually inspect aerator for loose or broken parts and tighten or replace if necessary.
5. After completion of job, clean and service aerator according to instructions in the Lawnaire IV Operator's / Parts Manual.

WARNING

After the trailer is positioned and the locking shaft is in place (prior to lifting the aerator off the ground) place blocks in front and back of both tires, to prevent the trailer from rolling while lifting aerator off the ground. Before unloading the aerator block the tires to prevent possible injury.

UNLOADING THE JR. SODCUTTER

1. With tote trailer on a level surface, unhook the trailer from the towing vehicle and move the trailer so there is enough room to tip the trailer up without injuring the operator or damaging property.
2. Make sure the wheel stops are not against the wheels to prevent the sodcutter from swinging freely.
3. Grasping the hitch of the trailer slowly tip the trailer up until the unit is resting on the ground. Remove the locking pins from the locking shaft and tip the trailer so there is no pressure on the locking shaft. Slide the shaft out of the sodcutter and pull the trailer away from the unit.
4. Check engine and gear case oil levels before beginning operation of sodcutter. Visually inspect sodcutter for loose or broken parts and tighten or replace if necessary.
5. After completion of job, clean and service the sod cutter according to instructions in the Sodcutter Operator's / Parts Manual.

WARNING

To keep the trailer from rolling and causing serious injury, place blocks in front and back of both tires before loading and unloading any unit from the trailer.

UNLOADING THE LAWNAIRE V

1. With tote trailer on a level surface, unhook the trailer from the towing vehicle and move the trailer so there is enough room to tip the trailer up without injuring the operator or damaging any property.
2. Make sure the wheel stops are not against the wheels to prevent the Lawnaire V from swinging freely. Block the tires as instructed in the safety warning.
3. Grasping the hitch of the trailer slowly tip the trailer up until the unit is resting on the ground. Remove the locking pins from the locking shaft and tip the trailer so there is no pressure on the locking shaft. Slide the locking shaft out of the aerator and pull the trailer away from the unit.
4. Install the weight bar on the Lawnaire V. Fill the water drum and check engine and reduction case oil levels before beginning to aerate. Visually inspect aerator for loose or broken parts and tighten or replace if necessary.
5. After completion of job, clean and service aerator according to instructions in the Lawnaire V Operator's / Parts Manual.

WARNING

After the trailer is positioned and the locking shaft is in place (prior to lifting the aerator off the ground) place blocks in front and back of both tires, to prevent the trailer from rolling while lifting aerator off the ground. Before unloading the aerator block the tires to prevent possible injury.

PARTS SECTION

FENDER AND LIGHT KIT ASSEMBLY

TOTE TRAILER

FIGURE 1

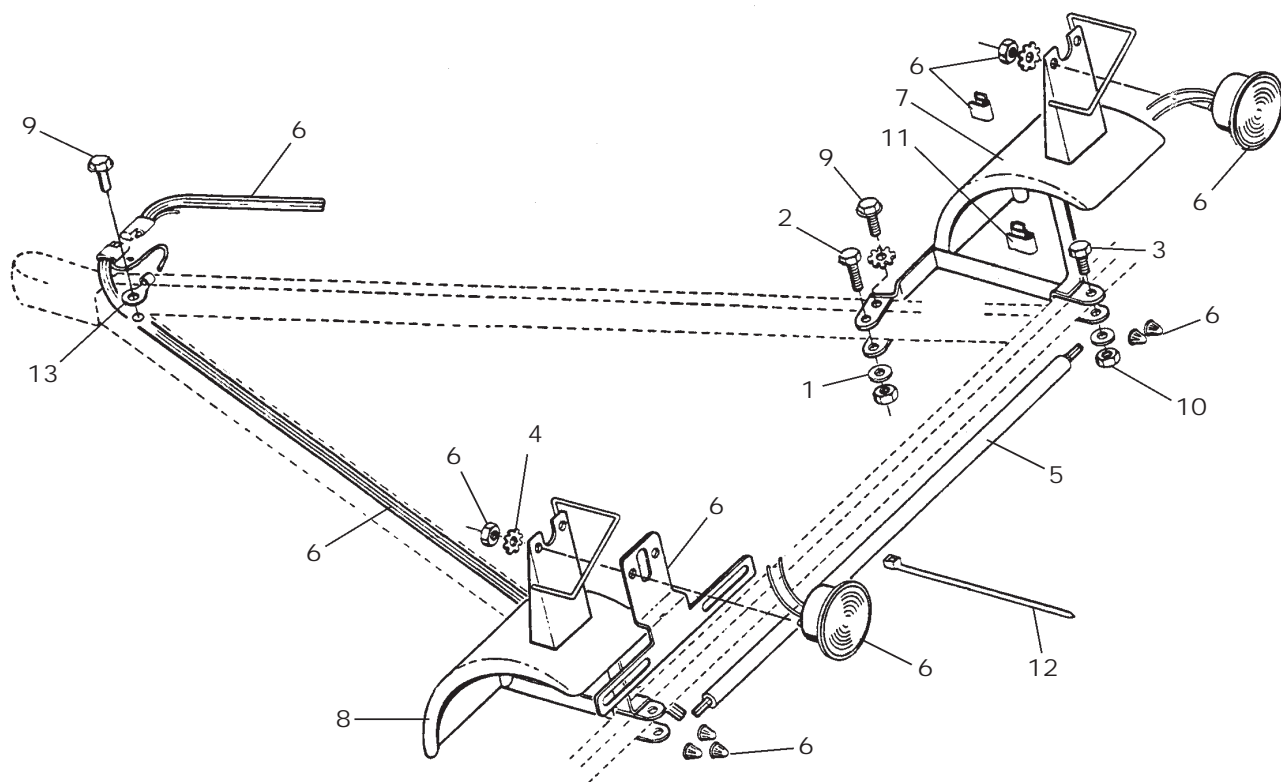

TOTE TRAILER

FENDER AND LIGHT KIT ASSEMBLY

FIGURE 1

ITEM	PART NO.	DESCRIPTION	QTY	ITEM	PART NO.	DESCRIPTION	QTY
1-1	103867	WASHER, 5/16"	4				
1-2	2702102	SCREW. 5/6-18x3"	2				
1-3	306424	SCREW. 5/6-18x2"	2				
1-4	306488	LOCKWASHER, 1/4" SHPRF	6				
1-5	521418	TUBING	1				
1-6	2702090	LIGHT KIT	1				
1-7	547059	FENDER, RIGHT	1				
1-8	547069	FENDER, LEFT	1				
1-9	548013	SCREW, 1/4-20x1/2" SLFTP	3				
1-10	548048	LOCKNUT, 5/16-18	4				
1-11	813840	WIRE CLIP	2				
1-12	823549	WIRE TIE, 14" (356mm)	12				
1-13	828343	TERMINAL. 1/4" EYELET	1				

TRAILER FRAME

FIGURE 2

TOTE TRAILER

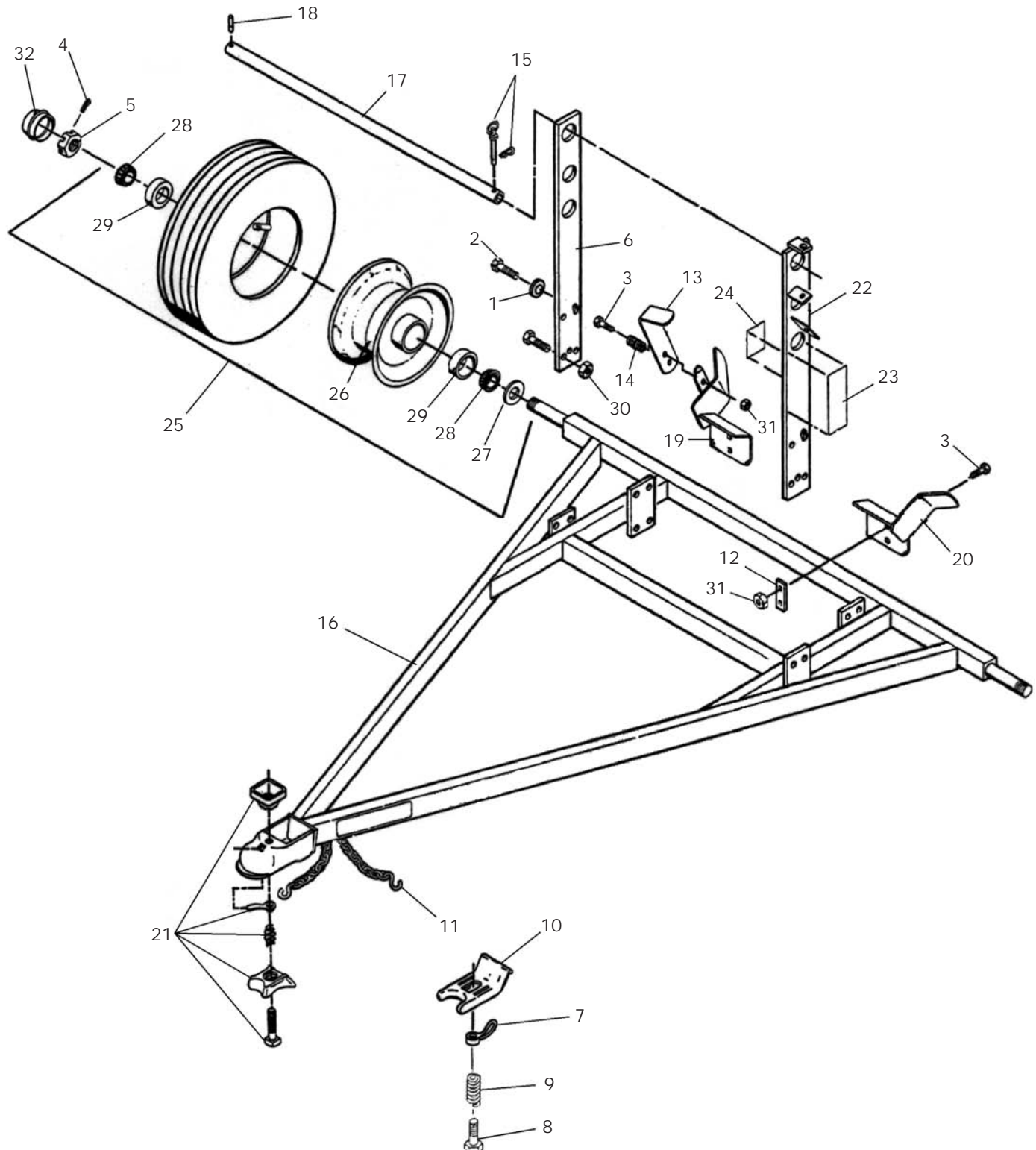

TOTE TRAILER

TRAILER FRAME

FIGURE 2

ITEM	PART NO.	DESCRIPTION	QTY	ITEM	PART NO.	DESCRIPTION	QTY
2-1	103867	WASHER, 5/16"	2				
2-2	306435	SCREW, 5/16-18x1-1/4"	8				
2-3	306836	SCREW, 3/8-16x2-1/4"	5				
2-4	325109	PIN, COTTER 5/32x1-3/4"	2				
2-5	515013	NUT, CASTLE 1"-14	2				
2-6	519300	MAST, MOUNTING	1				
2-7	520213	NUT, LOOP HANDLE 5/8-11	1				
2-8	520214	BOLT, HITCH 5/8-11x4"	1				
2-9	520215	SPRING, HITCH	1				
2-10	520216	LIP, BALL HITCH	1				
		(ITEMS 7-10 USED ON MODELS 7710 & PRIOR ONLY)					
2-11	547107	HOOK, CHAIN	2				
2-12	521628	PLATE, CLAMPING	2				
2-13	524121	LEVER, LOCKING	1				
2-14	521659	SPRING	1				
2-15	882770	PIN, HITCH	1				
2-16	2702084.7	FRAME	1				
2-17	2702147.7	SHAFT, LOCKING	1				
2-18	548192	PIN, ROLL 1/4"x2-1/4"	1				
2-19	545490	STOP, RIGHT	1				
2-20	545491	STOP, LEFT	1				
2-21	545502	KIT, COUPLER REPAIR	1				
		(ITEM 21 USED ON MODELS 7810 & LATER ONLY)					
2-22	2702302	MAST, MOUNTING	1				
		(INCLUDES ITEMS 23 & 24)					
2-23	521658	DECAL, OPERATING	1				
2-24	521660	DECAL, SAFETY	1				
2-25	547057	WHEEL ASSEMBLY, COMP	2				
		(INCLUDES ITEMS 26-29)					
2-26	547058	RIM, WHEEL	2				
2-27	700290	SEAL, OIL	2				
2-28	814473	CONE, BEARING	2				
2-29	814474	CUP, BEARING	2				
2-30	548048	NUT, 5/16"-18	8				
2-31	548052	NUT, 3/8"-16	5				
2-32	824569	CAP, END	2				

FIGURE 3

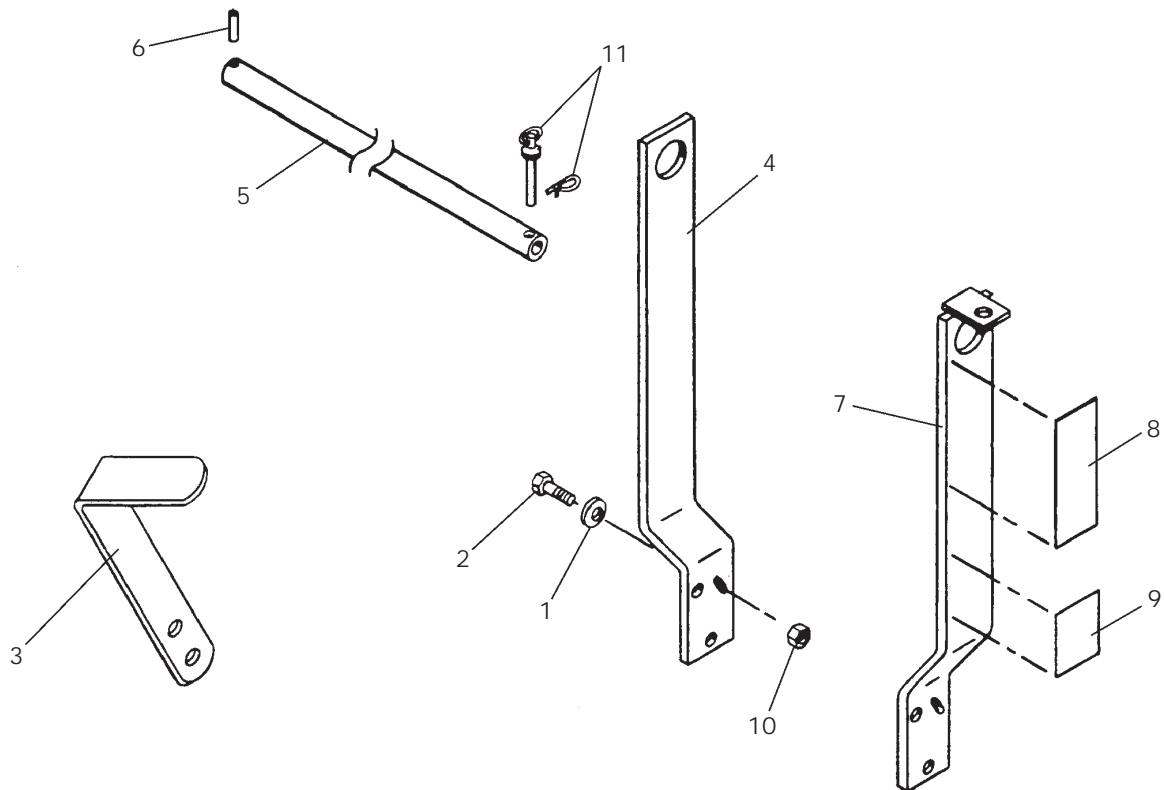

TOTE TRAILER

ACCESSORIES

FIGURE 3

ITEM	PART NO.	DESCRIPTION	QTY	ITEM	PART NO.	DESCRIPTION	QTY
3-1	103867	WASHER, 5/6"	2				
3-2	306435	SCREW, 5/16-18x1-1/4"	6				
3-3	524121	LOCKING LEVER	1				
(ITEM 3 REPLACES THE EXISTING LOCKING LEVER ON MODELS 1991 AND PRIOR)							
3-4	539001	MAST, MOUNTING, RH	1				
3-5	2702147.7	SHAFT, LOCKING (INCLUDES ITEM 6)	1				
3-6	548192	PIN, ROLL 1/4"x2-1/4"	1				
3-7	2702148	MAST, MOUNTING, LH (INCLUDES ITEMS 8 & 9)	1				
3-8	521658	DECAL, OPERATING	1				
3-9	521660	DECAL, SAFETY	1				
3-10	548048	NUT 5/16" LOCKING	6				
3-11	882770	PIN, HITCH	1				
3-12*	549316	LAWNIRE V MOUNT KIT (INCLUDES ITEMS 1-11)	1				

World Class Quality, Performance And Support



Equipment from Jacobsen, a Textron company, is built to exacting standards ensured by ISO 9001 and ISO 14001 registration at all our manufacturing locations.

A worldwide dealer network and factory-trained technicians backed by Textron Parts Xpress provide reliable, high-quality product support.



BOB-CAT BROUWER BUNTON CUSHMAN RYAN STEINER