



OPERATOR / PARTS MANUAL

DELUXE 2-CYCLE TILLER

7234

DELUXE 4-CYCLE TILLER

7264

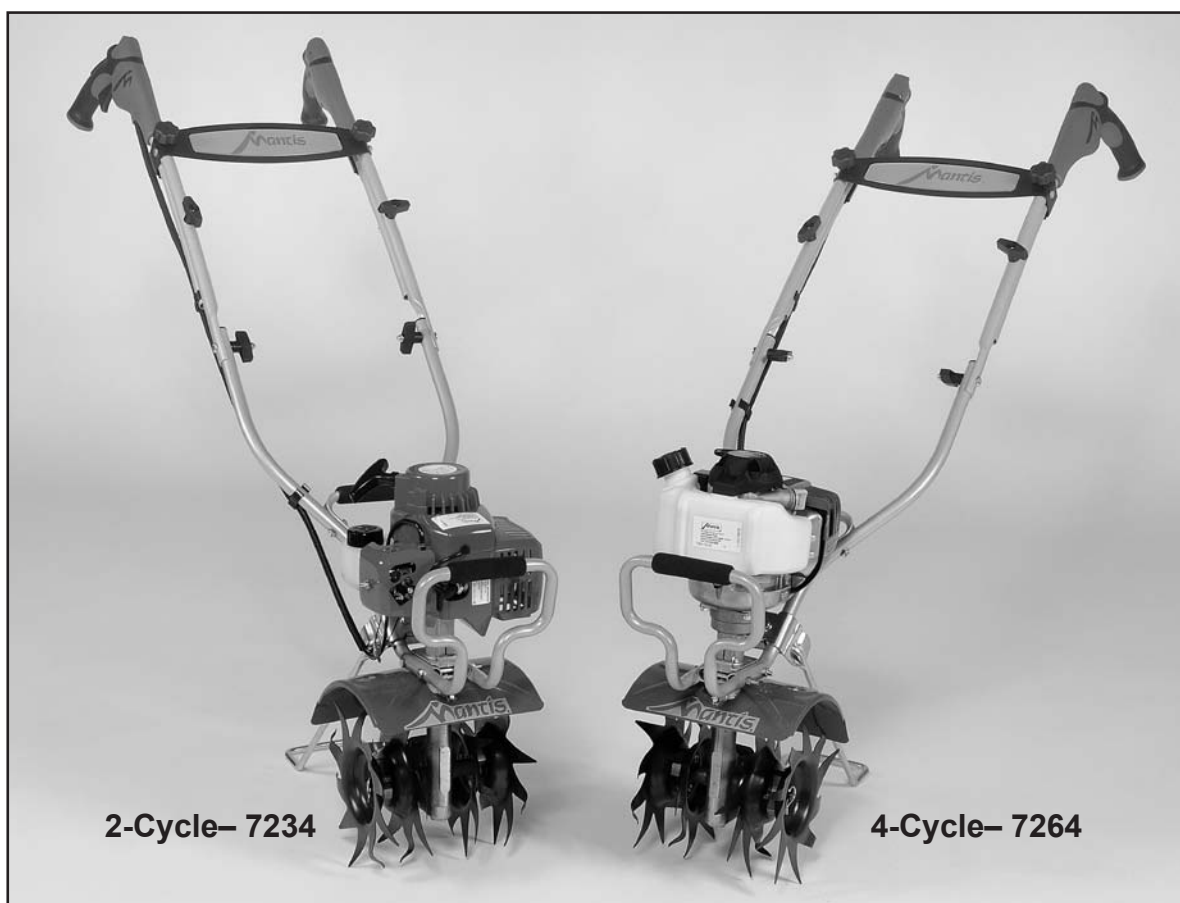

IMPORTANT!

Assembly Instructions Start on Page 7!

**Please review the Warning & Safety Information on Pages 4-6
and the Assembly Instructions before unpacking the box.**



Welcome to the World of Mantis Gardening

Here's your new MANTIS Tiller . . . the lightweight wonder that's Changing the Way Americans Garden.®

Unlike big tillers, your MANTIS Tiller weighs only 26 pounds. So it lifts easily, handles smoothly, tills and weeds precisely. And, unlike other small tillers, it features serpentine tines that churn soil to ten inches deep. It creates a soft, smooth seed bed, even in problem soil.

Once you know how to use your tiller correctly, we guarantee you'll love it. So first, please read this manual. It shows, step by step, how to use your tiller safely.

ATTENTION MANTIS PRODUCT OWNERS!

Get maintenance tips for your Mantis product on our web site at www.mantis.com



2-Cycle— 7234



4-Cycle— 7264



IMPORTANT MESSAGE

Thank you for purchasing this Schiller Grounds Care, Inc. product. You have purchased a world class product, one of the best designed and built anywhere.

This machine comes with Operation and Safety instructions, Parts and Service instructions and Engine instructions. The useful life and good service you receive from this machine depends to a large extent on how well you read and understand these manuals. Treat your machine properly, lubricate and adjust it as instructed, and it will give you many years of reliable service.

Your safe use of this Schiller Grounds Care, Inc. product is one of our prime design objectives. Many safety features are built in, but we also rely on your good sense and care to achieve accident-free operation. For best protection, study the manuals thoroughly. Learn the proper operation of all controls. Observe all safety precautions. Follow all instructions and warnings completely. Do not remove or defeat any safety features. Make sure those who operate this machine are as well informed and careful in its use as you are.

See a Schiller Grounds Care, Inc. dealer for any service or parts needed. Schiller Grounds Care, Inc. service ensures that you continue to receive the best results possible from Schiller Grounds Care, Inc. products. You can trust Schiller Grounds Care, Inc. replacement parts because they are manufactured with the same high precision and quality as the original parts.

Schiller Grounds Care, Inc. designs and builds its equipment to serve many years in a safe and productive manner. For longest life, use this machine only as directed in the manuals, keep it in good repair and follow safety warnings and instructions. You'll always be glad you did.

Schiller Grounds Care, Inc.
1028 Street Road
Southampton, PA 18966-4217
PHONE (800) 366-6268 • FAX (215) 956-3855

TABLE OF CONTENTS

PAGE	
SAFETY RULES & WARNINGS	OPERATION..... 15-16
Special Safety Information..... 4	TRANSPORT 17
Safety & Warnings..... 4	STORAGE 17
Safety Decal Information 4-5	MAINTENANCE
Warning Do's 5	2-Cycle 18
Warning Don'ts 6	4-Cycle 18
Engine/Fuel Warning Do's 6	2-Cycle & 4-Cycle Basic Maintenance 19
Engine/Fuel Warning Don'ts 6	MANTIS TILLER ASSEMBLIES
ASSEMBLY 7	2-Cycle Tiller Assembly 20
Lower Handle 8-9	4-Cycle Tiller Assembly 21
Kickstand 9	TROUBLESHOOTING 22
Tines 10	CONTROL 23
Upper Handle Assembly 10-12	EPA..... 24
Upper Handle Positioning 12	LIMITED WARRANTY INFORMATION ... BACK PAGE
FUELING & STARTING	
2-Cycle Fueling & Starting..... 13	
4-Cycle Fueling/Oil & Starting 14	
4-Cycle Corrective Action 14	



This Operator / Parts Manual is part of the machine. Suppliers of both new and second-hand machines must make sure that this manual is provided with the machine.

Contact us at www.mantis.com



Safety Rules & Warnings

You will notice throughout this Owners Manual Safety Rules and Important Notes. Make sure you understand and obey these warnings for your own protection.

I. SPECIAL SAFETY INFORMATION

WARNING

Attention: This symbol points out our important safety instructions.
When you see this symbol,  heed it's warning!! Stay alert!!

WARNING

To reduce the potential for accidents, comply with the safety instructions in this manual.
Failure to comply may result in serious personal injury, and/or equipment and property damage.

II. SAFETY & WARNINGS

WARNING

Improper use or care of this tiller or failure to wear proper protection can result in serious injury.
Read and understand the rules for safe operation and all instructions in this manual.
Wear hearing and eye protection.

WARNING

The engine exhaust from this product contains chemicals known to the State of California to cause cancer, birth defects or other reproductive harm.

III. SAFETY DECAL INFORMATION

An important part of the safety system incorporated in this tiller are the warning and information decals found on various parts of the tiller. These decals must be replaced in time due to abrasion, etc. It is your responsibility to replace these decals when they become hard to read.

2-Cycle



P/N 430057



Cutting hazard;
keep feet and
hands away from
rotating tines.



Do not carry
the tiller in this
position.



Read owner's manual before
using tiller, or performing any
repair or maintenance. Keep
owners manual in a safe place.



Don't fuel, refuel, or
check fuel while smoking,
or near an open flame or
other ignition source.



P/N 400630



Caution: when assembling
the handles, make sure fuel
tank faces operator. This
is the rear of the tiller, refer
to assembly instruction on
page 8-9.



Incorrect assembly.



Wear ear and
eye Protection.



Don't operate
indoors



Safety Rules & Warnings

V. WARNINGS - DONT'S

Don't use tiller with one hand. Keep both hands on handles with fingers and thumbs encircling the handles, while tines are moving, and engine is running.

Don't run with the machine, walk.

Don't work on excessively steep slopes.

Don't attempt to clear tines while they

are moving. Never try to remove jammed material before switching the engine off and making sure the tines have stopped completely.

Don't allow children or people unfamiliar with these instructions to use the machine. Local regulations can restrict the age of operator.

Don't operate while under the influence of alcohol or drugs.

Don't attempt to repair this tiller. Have repairs made by a qualified dealer or repairman. See that only original Mantis parts are used.

WARNING

Handle fuel with care, it is highly flammable. Fueling a hot engine or near an ignition source can cause a fire and result in serious personal injury and/or property damage.

VI. ENGINE/FUEL WARNINGS - DO'S

2-Cycle Always use fresh gasoline in the fuel mixture. Stale gasoline can cause damage.

4-Cycle Always use fresh gasoline.

Always store fuel in containers specifically designed for this purpose.

Always add fuel before starting the engine.

Always replace all fuel tank and container caps securely.

Always pull starter cord slowly until resistance is felt to avoid kickback and prevent arm or hand injury.

Always operate engine with spark arrestor installed and operating properly.

Stop the engine whenever you leave the machine and before refueling. Allow the engine to cool before storing in any enclosure. Replace worn or damaged parts for safety.

If the fuel tank needs to be drained, this should be done outdoors.

VII. ENGINE/FUEL WARNINGS - DON'TS

Never pick up or carry a machine while the engine is running.

Don't fuel, refuel or check fuel while smoking, or near an open flame or other ignition source. Stop engine and be sure it is cool before refueling.

Don't leave the engine running while the tiller is unattended. Stop the engine when carrying out maintenance and cleaning operations, when changing tools and when being transported by means other than under its own power.

Never remove the cap of the fuel tank or add petrol while the engine is running or when the engine is hot.

Don't refuel, start or run this tiller indoors or in an improperly ventilated area.

Don't run engine when electrical system

causes spark outside the cylinder. During periodical checks of the spark plug, keep plug a safe distance from cylinder to avoid burning of evaporated fuel from cylinder.

Don't check for spark with spark plug or plug wire removed. Use an approved tester.

Don't crank engine with spark plug removed unless spark plug wire is disconnected. Sparks can ignite fumes.

Don't run engine when the odor of gasoline is present or other explosive conditions exist.

Do not attempt to start the engine if petrol is spilled, but move the machine away from the area of spillage and avoid creating any source of ignition until petrol vapors have dissipated.

Don't operate your tiller if there is an accumulation of debris around the muffler, and cooling fins. To reduce the fire hazard, keep the engine and petrol storage area free of vegetative material and excessive grease.

Don't touch hot mufflers, cylinders or cooling fins as contact may cause serious burns.

Don't change the engine governor setting or over speed the engine.

Don't attempt to remove spark plug while engine is hot. Removing a spark plug from a hot engine can cause irreparable damage to the engine and will void your warranty.

Don't use starter fluids as they will cause permanent engine damage.

Assembly

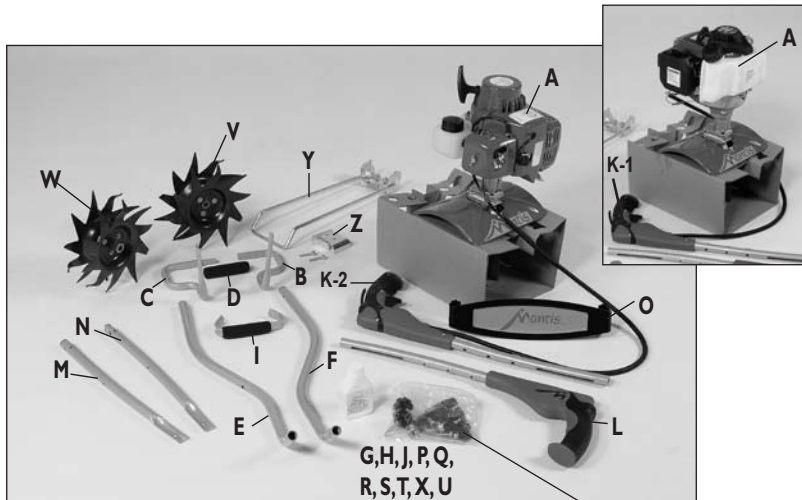

⚠ WARNING

Improper assembly of this tiller can result in serious injury. Make sure to follow all instructions carefully. If you have any questions, contact our factory at 1-800-366-6268 or an authorized Mantis dealer.

Bag Contents

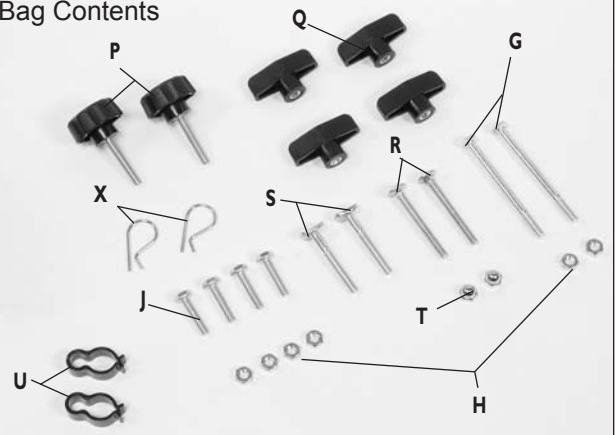

WHAT COMES IN THE BOX

Key	Qty.	Part No.	Description
A	1	N/A	Transmission And Engine Assembly
B	1	430023	Loop Handle Right Half
C	1	430022	Loop Handle Left Half
D	1	430025	Foam Grip
E	1	430051	Lower Handle W/Plug, Right
F	1	430050	Lower Handle W/Plug, Left
G	2	4049	Bolt 1/4-20 X 3.25"
H	6	972	1/4-20 Two-Way Lock Nut
I	1	430049	Carry Handle With Grip
J	4	144-2	1/4-20 X 1.125" Hex Head Cap Screws
K-2	1	430003	Trigger Handle Assembly, 2-Cycle Engine, Right
K-1	1	430004	Trigger Handle Assembly, 4-Cycle Engine, Right
L	1	430006	Handle Assembly, Left
M	1	430053	Middle Handle W/Plug, Right
N	1	430052	Middle Handle W/Plug, Left
O	1	430021	Handle Brace
P	2	430038	Knob, 1/4-20 X 1.5 Male
Q	4	400523	Knob, Two Prongs, Female
R	2	430039	Carriage Bolt 1/4-20 X 2.25"
S	2	430048	Curved Head Bolt, 1/4-20 X 2"
T	2	395	Acorn Nut
U	2	478	Throttle Clip
V	1	438RA	Tine Assembly, Right
W	1	438LA	Tine Assembly, Left
X	2	418-1	Tine Retaining Pins
Y	1	410158	Kickstand, Stand Assembly
Z	1	430037	Kickstand, Bracket and Hardware

Congratulations! You have just purchased a super high-quality product, the Mantis Deluxe Tiller/Cultivator.

Whether you have purchased the 2-Stroke or 4-Stroke model, this manual will show you how to Assemble, Start, Operate, Transport, Store and Maintain your Tiller. The Mantis Deluxe Tiller/Cultivator is designed to bring you years of solid, reliable performance.



2-Cycle Tiller



4-Cycle Tiller

WHAT YOU WILL NEED TO ASSEMBLE THE TILLER

Prior to removing the contents and assembling, it is important to:

- Have a clean work area.
- Make sure all necessary tools are handy.
- You will need a 7/16" crescent wrench
- A ratchet with an extension
- A 7/16" socket
- A 3/8" socket or crescent wrench.



Assembly

LET'S BEGIN

The following instructions are for the 2-Stroke and 4-Stroke Tiller.

- With the box upright, open the box and remove the tine box and the loose parts that are at the top of the tiller box. Do not remove any other parts in the box.
- Lay the box on one side and open the bottom flaps.
- Return the box to an upright position (as shown) and pull the box straight up.
- The right handle, additional parts and tiller engine will be in the box cradle. Leave the engine and throttle in the cradle to assist in the assembly.
- Lay everything out so you can easily identify the parts (see parts image and list on page 7).



NOTE: Some of the photos in this manual do not represent your 4-Stroke tiller engine. They are for assembly purposes only.

LOWER HANDLE ASSEMBLY



- For ease of assembly and stability it is important that you keep the engine assembly in its cardboard cradle.



- Slide the foam grip onto the right loop handle.



- Line up the holes of the Right Loop Handle with the holes of the Lower Right Handle.
- Slide the two 3.25" bolts through the hole



- Position this assembly onto the recessed channels below the engine.



- Slide the lower left handle onto the bolts

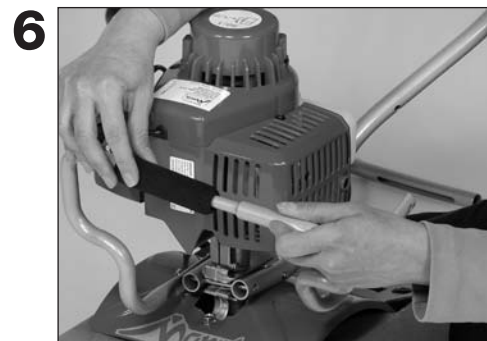

- Slide the left loop handle into the foam grip and right loop handle

Assembly

LOWER HANDLE ASSEMBLY (CONTINUED)



- Slide loop handle through bolts and over top lower left handle, then take two lock nuts and fasten them finger tight



- Place the Carry Handle between the lower handles and line up the holes
- Place two of the 1.125" bolts through holes with hex head on inside of carry handle and with two lock nuts fasten them tight with wrench and socket.

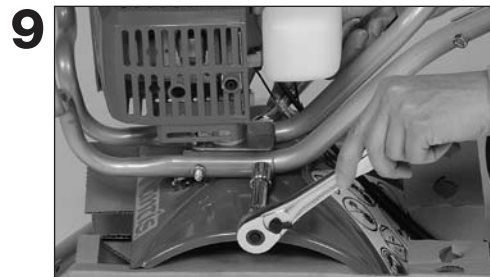

- Use the 7 /16" wrenches and socket to tighten the rest of the handle bolts.

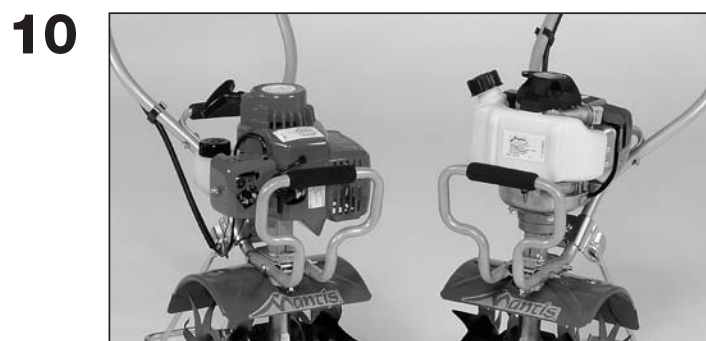

2-Cycle Tiller

4-Cycle Tiller

- At this point, your Mantis tiller should look like this when lower handle assembly is complete.

KICKSTAND ASSEMBLY

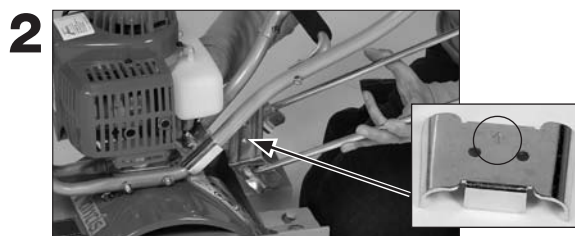

- Position the kickstand brace just above the bend of the lower handles. The stamped arrow should be pointing up
- Position the kickstand under the lower handles, line up the holes and thread the kickstand brace bolts into the kickstand
- Tighten with the 3/8" wrench

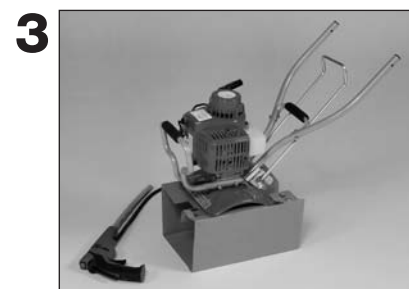

- Your Mantis tiller will look like this when lower handle assembly and kickstand is complete.

Assembly

TINE ASSEMBLY

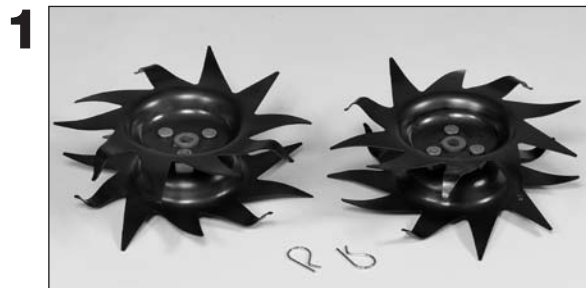

- You'll need the 2 Tines and the 2 Retaining pins



- Remove the unit from the cardboard cradle and turn the unit slightly on its side



- You will notice that one side of the Tine has a circular hole while the other has a "D" shaped hole.



- Attach the Tine so that the circular hole slides onto the axle first.



- When the axle protrudes from the other side it will line up perfectly with the "D" shaped hole.



- Slide a Retaining Pin through the hole in the axle to secure the Tine.
- Repeat steps for the other side.

***NOTE:** The Tiller is laying down for assembly purposes only.
See page 14 for important information.

UPPER HANDLE ASSEMBLY



- To assemble the Upper Handles, first put the Kickstand down

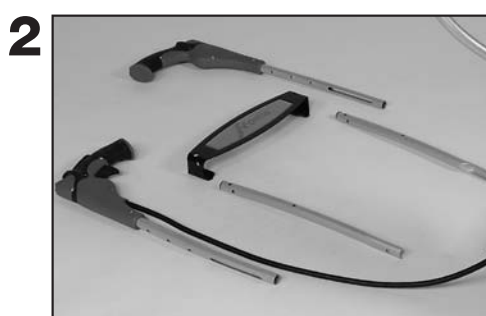

- Layout the Middle and Upper Handles and the Handle Brace as shown above



- Take the Right Middle Handle and attach the brace using a hex head cap screw and a 2-way lock nut. Finger tighten.
- Repeat for left side.

Assembly

UPPER HANDLE ASSEMBLY (CONTINUED)

4

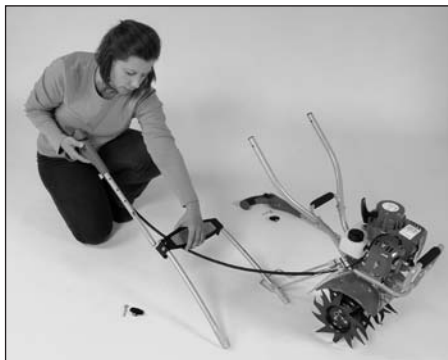

- Take the Right Upper Handle, the one with the throttle, and slide it between the Middle Handle and the lower flange of the Brace.

5



- Insert a curved head bolt into the slot at the bottom of the Upper Handle so that it comes out the top of the Middle Handle.

6



- Thread a 2-pronged knob onto the bolt two full turns while leaving it loose.
- Repeat for left side.

7



- Line up the top holes of the Upper Handles with the holes on the top of the Brace so the handles are in the lowest position.

8



- Insert the round knob into the Brace and tighten.

9



- Now fully tighten the lower 2-prong knobs

10



- With a 7/16 in. wrench and socket, tighten the nuts and bolts that hold the Brace onto the handles

11



- Insert the carriage bolts into the bottom holes of the Upper Handles then through the top holes of the Lower Handles.

12



- Loosely thread the other 2-pronged knobs onto the carriage bolts



Assembly

UPPER HANDLE ASSEMBLY (CONTINUED)



13

- Lift the Upper Handles until they line up with the Lower Handles and fully tighten the knobs at the pivot point.



14

- Cap the exposed bolts with the acorn nuts and tighten with your 7/16" wrench until snug. Do not over tighten.



15

- Attach the throttle cable clips to the Upper and Lower Handles. Make sure the cable is not wrapped or twisted and you have the proper throttle movement.

* See important notes listed below.

UPPER HANDLE POSITIONING



1



2



- Adjust your handle height by loosening the upper 2-prong knobs and removing the round knobs then sliding the Upper Handles to the desired position.

- Then re-insert the round knobs and re-tighten the 2-prong knobs



2-Cycle Tiller



4-Cycle Tiller

IMPORTANT NOTE:

Make sure you have installed the handles properly. When you stand behind your tiller, holding the handles, the fender warning label should face you.

IMPORTANT NOTE:

Before you use your MANTIS Tiller, read the Safety Rules & Warnings on pages 4-6

IMPORTANT NOTE:

Be sure you have proper throttle movements and that the throttle cable is not wrapped or twisted around the handle bar. Hold down the lockout lever, fully squeeze the throttle trigger and let go. The throttle triangle must click in both directions. If there is any doubt, remove air filter and visually check that the throttle triangle hits both the idle screw and the full open stop. **THIS MUST BE DONE BEFORE STARTING THE ENGINE.**

WARNING

Improper Throttle installation can cause tines to rotate unexpectedly.

2-CYCLE TILLER FUELING ONLY

Before you start your Mantis Deluxe 2-Cycle Tiller/Cultivator for the first time you will need to mix the fuel and oil.

Pour the pre-measured bottle of Mantis approved, 2-Cycle oil into one gallon of 89 octane gasoline and mix well.

Put the kickstand down to position the tiller upright.

Remove the fuel cell cap.

Carefully add the fuel mixture to the tank until it is about 4/5 full. And remember, always drain the gas when transporting the unit from one location to another.

Replace the cap.

2-CYCLE TILLER STARTING ONLY

The FastStart feature works by winding up the starter coil to store energy in the starting mechanism. The following process will allow you to easily start your Mantis tiller.

Cold Starting

- First make sure the stop/start switch located on the throttle handle, is in the start position, which is indicated by the "I" symbol.
- Close the choke by pulling the choke button out.
- Press the primer bulb approximately 6 times until the bulb is filled with gas. Once it is filled, press it two more times.
- **Pull the starter cord out a few clicks (8 to 12 inches) to store energy in the starting mechanism. Return the starter cord to the original position. Briskly pull the starter cord. The stored energy is released and the engine will start.**

IMPORTANT NOTE:

If the engine does not start on the first attempt, repeat the above starting process a maximum of 5 times. If you are still experiencing difficulties, push the choke button in and repeat the above starting process again.

WARNING

If engine does not stop when switch is put in the stop position, release the throttle, allow engine to idle, put the tiller down and pull the choke button out to shut engine down. Have product serviced before using.

WARNING

Do not operate the engine in a confined space where dangerous carbon monoxide fumes can collect.

2-Cycle Tiller Fueling & Starting



Switch



Choke

- Once it is running, open the choke by pushing the button back in, if you have not already done so.
- To stop the engine, simply push the start / stop switch to the stop position "O".
- Before using the tiller, let the engine idle for one minute to warm up. Before shutting it down, let the engine idle for two to three minutes to cool down.

Warm Starting

- To start a warm engine, follow the same procedure. The only exception is that you can leave the choke button in and you don't have to pump the primer bulb.
- Before using the tiller, let the engine idle for a minute to warm up. Before shutting it down, let the engine idle for two to three minutes to cool down.

WARNING

Fuel is extremely flammable. Handle it with care. Keep away from ignition sources. Do not smoke while fueling your equipment

WARNING

Avoid accidental blade engagement. Do not squeeze the throttle trigger when starting. Maintain proper idle speed adjustment (2500-3100 rpm)



4-Cycle Tiller Fueling & Starting

4-CYCLE TILLER FUELING AND OIL ONLY

IMPORTANT!

It is normal for your 4 stroke engine to smoke for the first minute or two of operation, however it is not necessary for this to occur every time. This is a result of the oil being pulled through the engine for lubrication.

- Rock the tiller forward so that it rests on its front loop handle.
- It is important to position the Mantis Deluxe 4-Cycle Tiller as shown in **Figure 1** so the oil will properly fill the crankcase. Failure to do so will cause engine damage.
- Remove the oil plug.
- Pour in the bottle of pre-measured, Mantis approved, 4-cycle engine oil.
- Always check the oil level before each use. The oil level should reach the inner first thread of the reservoir. Do not overfill.
- Replace the oil plug.
- Then return the unit to the upright position and put the kickstand down.

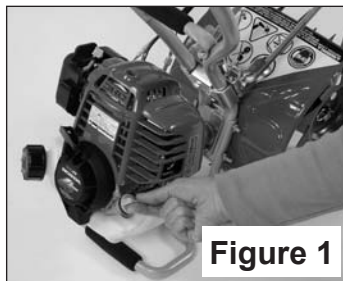

Figure 1

Fueling your Mantis 4 Cycle Deluxe Tiller/Cultivator is easy. Unscrew the gas cap and fill the tank about four-fifths of the way up with 89 octane unleaded gasoline. And remember, always drain the gas when transporting the unit from one location to another.

4-CYCLE CORRECTIVE ACTION

If you suspect the engine is overfilled the following procedure should remove the excess oil from the crankcase and valve cover.

If the engine is overfilled, oil will enter the crankcase and it does not simply pour out of the oil fill opening. The excessive oil has to be pumped out as the engine runs. Checking the oil level and draining any excess between multiple 30 second running intervals will bring the oil back to the proper level.

1. Place the engine on a level surface resting flat on the front

loop handle and remove the oil fill cap/dipstick. Use a catch basin for any oil that overflows from the oil fill opening.

2. Replace the oil fill cap/dipstick and run the engine for approximately 30 seconds then repeat step one. Continue steps 1 & 2 until oil no longer overflows when the oil fill cap/dipstick is removed.
3. Once the oil level is corrected the engine may continue to smoke while running for several minutes while the residual oil burns off.

4-CYCLE TILLER STARTING ONLY

Starting the engine for the first time, or “cold starting”, is easy.

- First, make sure the start/stop switch, located on the throttle handle, is in the start position, which is indicated by the “I” symbol.
- Close the choke by moving the choke lever to the up position.
- Press the primer bulb approximately 6 times until the bulb is filled with gas. Once it is filled, press it two more times.
- Pull the starter cord lightly until you feel resistance and then give it a short, brisk pull. Your tiller should start immediately. Do not pull the cord all the way out and do not let it snap back into the starter housing.
- Once it is running, open the choke. Ensure the lever is fully down.
- To stop the engine, simply push the start/stop switch to the stop position “O.”
- To start a warm engine, follow the same procedure. Except now you can leave the choke lever in the down position and there is no need to pump the primer bulb.
- Before using the tiller, let the engine run for a minute to warm up. And before shutting it down, let the engine run briefly to cool down.



Switch on

IMPORTANT NOTE:

Check the oil level in the engine before each use. If oil is low see your 4 Stroke Tiller Engine Manual and information above for details.

Never use starting fluids as they will cause permanent engine damage. Using them will void the warranty. Before you use the tiller, read the Safety & Warning rules on pages 4-6.

4-CYCLE PROPER OIL FILL/ LEVEL CHECK POSITION



This position does not allow for a proper oil level reading and may cause overfilling.

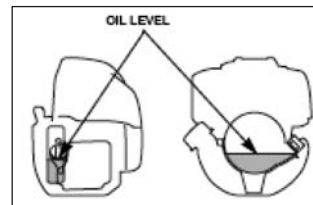

Engine must be resting on a flat surface on the fuel tank

2-Cycle & 4-Cycle Tiller Operation

WARNING

If engine does not stop when switch is put in the stop position, release the throttle, allow engine to idle. Put the tiller down, and slide the choke lever to the cold start (closed) position. Have product serviced.

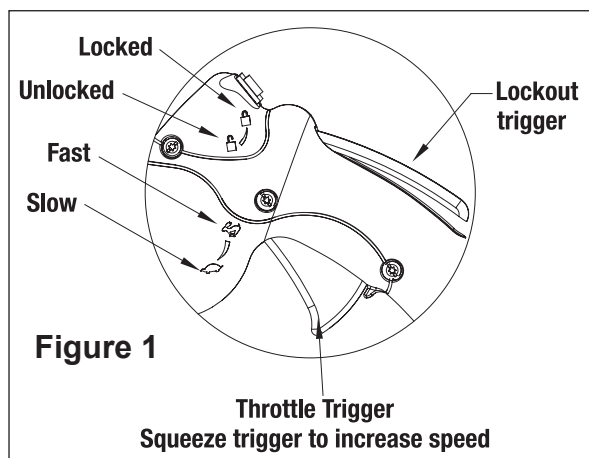

A SPECIAL FEATURE

(With the idle set properly and the engine running)

Even when the engine is running, the tines won't turn unless you squeeze the throttle trigger on the handlebars. And, when you release the throttle trigger, the tines will stop.

A TIP FOR EXTENDING YOUR ENGINE'S LIFE

After you start the engine, let your tiller warm up for two to three

minutes before you use it. Then, before you put your tiller away, let it idle for a minute to give the engine a chance to cool down.

OPERATION

With engine running, and both hands on the handles, hold down the throttle lock out lever (**Figure 1**), then squeeze the throttle trigger gradually to increase the engine speed and engage the tines.

NOTE: This step must be repeated each time your tiller trigger is released.

WARNING

Read the instructions carefully. Be familiar with the controls and the proper use of the equipment.

NOW YOU'RE READY TO USE YOUR MANTIS TILLER.

If you've seen other tillers, your MANTIS Tiller may surprise you. It tills best when you pull it backward! You see, when you pull your MANTIS Tiller backward, you give extra resistance to the tines, so they dig deeper. (**Figure 2**)

In addition, when you go backward, you erase your footprints. So your soil stays light and fluffy. With other tillers, by contrast, you walk right over the soil you've just tilled, packing it down, so it's less plantable.

RUN YOUR MANTIS TILLER LIKE A VACUUM CLEANER

Place your Tiller at the head of the row or area you want to till. Start it up. Then use an easy rocking motion. First, pull your Tiller backward. Then use an easy

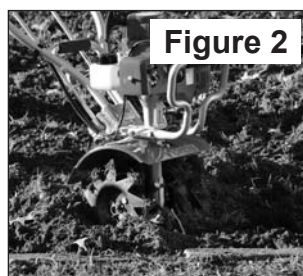

rocking motion. Again, pull your Tiller backward. Then, let it move forward just a little bit. Then pull it backward again. This will help you till deeper.

Keep repeating these steps until you've tilled an entire row. Start again on the next row. It's much like running a vacuum cleaner! (**Figure 3**)

You Can Even Control Depth.

For Deeper Tilling:

Move your Tiller slowly back and forth, as you would a vacuum cleaner. Work the same area over and over until you've dug to your desired depth. (**Figure 4**)

For Shallow Tilling:

Switch the tines to the cultivating position. (See page 16 to learn how.)



Figure 3

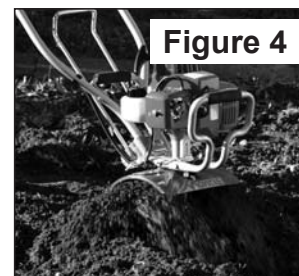

Figure 4

Then move your Tiller quickly over your soil surface.

For Big Weeds or Tough Roots:

Let your Tiller rock back and forth over the tough spot, until the tines slice through the weed or root.

Your MANTIS Tiller Handles Special Tilling Projects:

Want to turn part of your lawn into a colorful flower border? Your MANTIS Tiller makes it easy! Just run your Tiller back and forth until the sod begins to break up. Then continue tilling. Your Tiller will chop the clumps of sod until they're fine. Then, it will work them into the soil. Pretty soon, you'll have a soft, fresh planting bed.



2-Cycle & 4-Cycle Tiller Operation

WARNING

If your tines get jammed or entangled, shut off the engine at once. Remove the obstruction while the engine is off. Never try to remove an obstruction while the engine is running. Serious injury can result.

WARNING

The operator of this tiller is responsible for accidents or hazards occurring to himself, other people or their property.

Figure 1

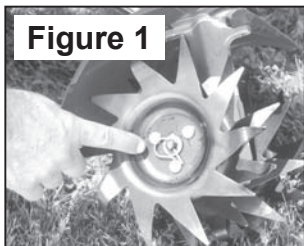

YOUR MANTIS TILLER MAKES WEEDING A PLEASURE!

As a tiller, your MANTIS Tiller works the soil down to 10" (25.4 cm) deep. But, as a cultivator, it gently cultivates the surface, only 2" to 3" (5.09 cm to 7.62 cm) deep.

First, you must switch the tines to the weeding, cultivating position. This takes less than a minute.

Then, your MANTIS Tiller's sharp "tine teeth" will slice up those pesky weeds, burying them as you go along. And, since the tines in this position won't dig too deep, they won't hurt your plants' precious root systems.

The result? Your Tiller will cut your weeding time in half, and turn a tiresome chore into a pleasure.

HOW TO SWITCH FROM TILLING TO CULTIVATING POSITION

1. Make sure your Tiller is off.
2. Remove the retaining pins from the tines. **(Figure 1)**
3. Remove the tines from the axle.
4. Place the right-side tine onto the left-side axle. Place the left side tine onto the right-side axle. The "D" hole should be to the outside.
5. Reinsert the pins.

IMPORTANT:

To change the tines on your Mantis Tiller, push the tiller forward and allow it to rest on the loop handle.

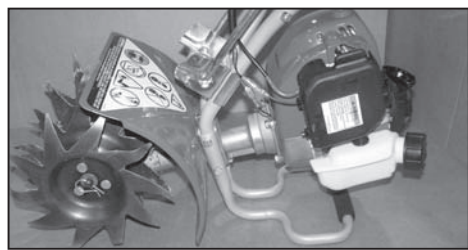

Tilling

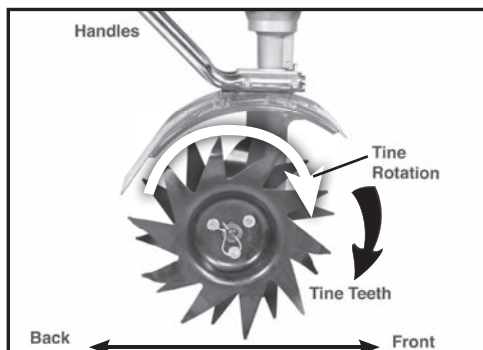

To set them for tilling, attach the tines so the points of the blades face forward - away from the operator. The tines' points will contact the ground first.

Cultivating

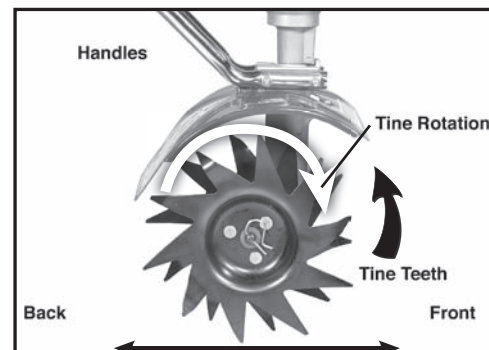

For cultivating, reverse the tines so that the points of the tines face backward - toward the operator. Now the long flat part of the tine's blade will contact the ground first.

2-Cycle & 4-Cycle Tiller Transportation & Storage



Figure 1



Figure 2

2-CYCLE & 4-CYCLE TILLER TRANSPORTATION

Transporting your Tiller is easy. It's light enough and easy to carry using the carrying handle as seen in **Figure 1**.

Or, with it running, you can walk it by gently squeezing the throttle until it moves at a comfortable pace seen in **Figure 2**.

Your tiller is easily transported in the back of a car or truck. Be sure to empty the fuel tank (This is crucial)! Then stow your tiller in the trunk of your car or truck.

WARNING

Never store the equipment with Fuel in the tank or inside a building where fumes can accumulate and breach an open flame or spark

2-CYCLE & 4-CYCLE TILLER STORAGE

WARNING

Do not store in an area where fuel fumes may accumulate and reach a flame or spark.

Each fall, or before you store your Mantis Tiller for any long period, be sure to take these measures:

1. Do not store your Tiller with fuel still in it. Even under ideal conditions, stored fuel containing ethanol or MTBE can start to go stale in 30 days. And, since stale fuel has a high gum content, it can clog the carburetor, this, in turn, will restrict fuel flow. Therefore, when you're ready to store your Tiller, or will not be using it for more than 2 weeks, drain the fuel tank completely.
2. Next, restart the engine to make sure no fuel is left in the carburetor. Then, run the engine until it stops. This will prevent gum deposits, forming inside of the carburetor and possible engine damage.
3. Disconnect spark plug wire and remove the spark plug. Slowly pull the starter cord once.
4. Inspect the spark plug, and if necessary, clean it. If you need to replace it, buy a NGK-CMR5H.

5. Install the spark plug, but leave the spark plug wire disconnected.
6. Wipe the tines with oil or spray them with WD-40, to prevent rusting.
7. Oil the throttle cable and all visible moving parts. (Do not remove the engine cover.)
8. Store your Tiller in an upright position in a clean, dry place. You can store with the handles in an extended position or folded down.

To fold the handles down, simply loosen the lower 2-pronged knobs until you can pivot the upper handles down. **(Figure 3)**

Or it can be hung using the handle brace. **(Figure 4)**

9. To fold the handles, follow these easy steps: Loosen the handle knobs (#40) then fold the handles forward. Tighten knob securely. Your handles are now folded and ready to store in a smaller area.
10. Do you have fuel left over from last season? Dispose of it properly. Buy fresh oil and gasoline next season.
11. Remove Tilling Tines or attachments and lightly oil tine shaft at least once a year.

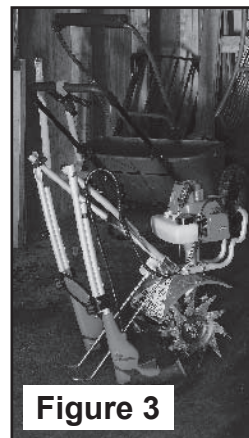

Figure 3



Figure 4

IMPORTANT:

It is important to store your Mantis Tiller in an upright position. Laying the Tiller on its side will cause the oil to leak out of the engine through the air cleaner case.

IMPORTANT:

Avoid any orientation that places the top cover (engine head) down -this may allow oil from the crankcase to enter the combustion chamber and cause hard starting or a locked piston.



2-Cycle Tiller Maintenance

2-CYCLE TILLER BASIC MAINTENANCE ONLY

Your Deluxe 2 Cycle Tiller will require some basic maintenance to keep it performing year after year.

Of course, your Mantis is designed to be used in the soil, but dirt is the enemy of any engine. You should check the air filter regularly

To replace the filter, remove the filter cover by first unscrewing the wing nut. Carefully remove the filter cover, then simply pull out the filter and replace it with a clean filter.

If a new filter is not immediately available, you can clean the old filter with a brush to remove debris.

If you are storing your tiller for the season or longer than 30 days it is very important to empty the fuel tank to prevent engine damage from foul fuel.

The fuel filter should be replaced every year. Open the fuel cap and using the cap retainer you can remove the fuel intake line. The filter is at the end.



Hold the fuel line and work the filter out. Then just push the new one back into the tube making sure the clamping wire is up high enough to engage with the stem of the filter.

4-Cycle Tiller Maintenance

4-CYCLE TILLER BASIC MAINTENANCE ONLY

Your Deluxe 4 Cycle Tiller will require some basic maintenance to keep it performing year after year.

If you are storing your tiller for the season or longer than 30 days it is very important to empty the fuel tank to prevent engine damage.

Undoubtedly, you will be putting your tiller through rigorous use.

Check engine oil level, air filter and fuel filter.

Refer to your Honda® engine manual for more details.

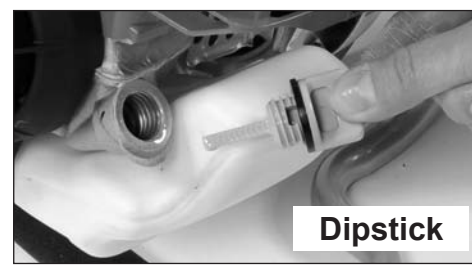

2-Cycle & 4-Cycle Tiller Basic Maintenance

HOW TO RESEAT THE FLANGE

At some point, you may find that the tines won't turn when you press the throttle. This may mean the engine isn't sitting all the way down on the worm gear housing.

Perhaps you've been using your Tiller for several years. Or perhaps you've removed the engine for use with our hedge trimmer attachment, then replaced it. In either case, the flange bolt may have come loose and lifted the engine up.

If this happened you'll notice a gap between the bottom of the engine clutch case and the top of the worm gear housing. **(Figure 1)**

To fix this, loosen the flange bolt. Take the engine off the worm gear housing. Notice the hex head on top of the drive shaft. Inside the clutch case, you'll find the clutch drum. Make sure the hex head lines up with the clutch drum inside the clutch case.

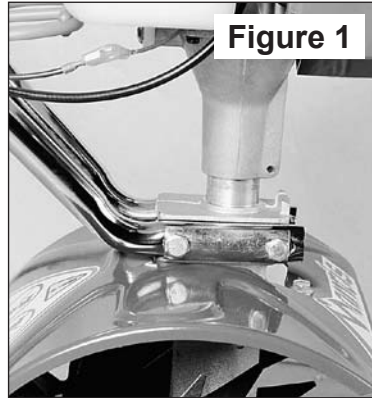

Note how the engine doesn't sit all the way down on the transmission.

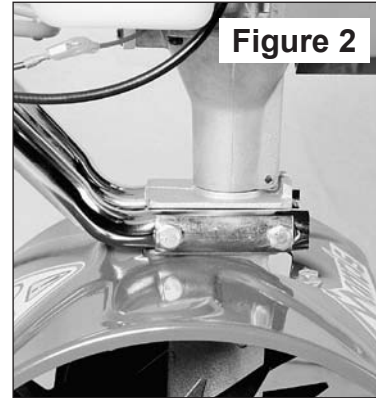

Note how the engine sits all the way down on the transmission.

Then put the engine back on the worm gear housing. Make sure the plastic carrying handle is not under the fuel tank.

If you've followed these steps properly, there will be no gap between the clutch

case and the worm gear housing. **(Figure 2)** Make sure you tighten the flange bolt!

All other engine maintenance issues can be found in the Honda® Engine Manual included in your tiller package.

TRANSMISSION CARE

Check the transmission grease level after the first 10 hours of use, then check yearly.

With the tines off, remove the transmission plate **(Figure 3)** and gasket to see if the grease level is up to the plate flange **(Figure 4)**. If it is not, you will need to add lithium zero grease.

Wipe off any excess grease, replace the transmission gasket and plate.



Figure 3

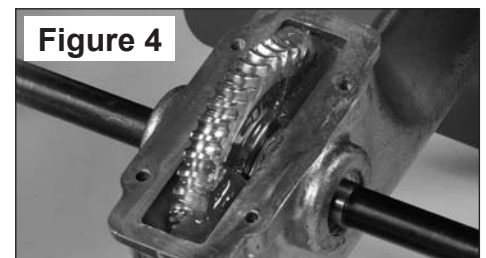
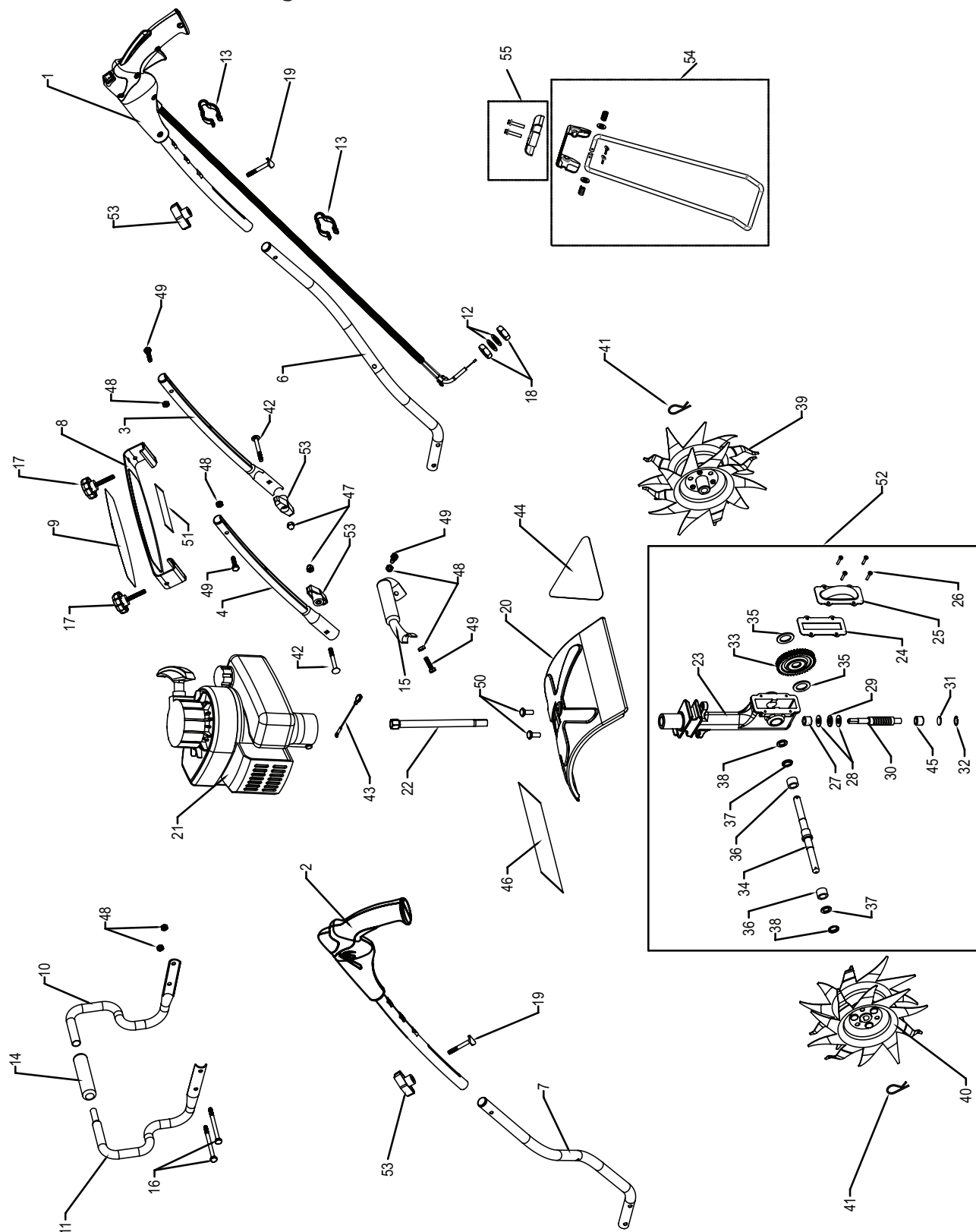

Figure 4

2-Cycle Tiller Assembly



Key	Qty.	Part No.	Description
29	1	424	Worm Thrust Bearing
30	1	422	Worm Shaft
31	1	426	Worm Disk
32	1	428	Retaining Ring
33	1	429	Worm Gear
34	1	431	Tine Shaft
35	2	430	Worm Gear Thrust Washer
36	2	432	Worm Gear Bearing
37	2	434	Bearing Seal
38	2	435	Bearing Seal Retainer
39	1	438RA	Tine Assembly, Right
40	1	438LA	Tine Assembly, Left
41	2	418-1	Tine Retaining Pin
42	2	430039	Carriage Bolt 1/4-20 X 2.25"
43	1	430042	Ground Wire Jumper, 2 Cycle Engine
44	1	400630	Triangle Warning Label (2 Cycle Engine)
45	1	458	Roller Bearing (closed end)
46	1	430058	Mantis Logo Label
47	2	395	Acorn Nut
48	6	972	1/4-20 Two-way Lock Nut
49	4	144-2	1/4-20 X 1.125 Hex Head Cap Screw
50	2	140	Bolt 1/4-20x3/8" Long
51	1	430057	Warning Label
52	1	400010	Transmission Assembly*
53	4	400523	Knob, Two Prongs, Female
54	1	410158	Kickstand, Stand Assembly
55	1	430037	Kickstand, Bracket And Hardware

Key	Qty.	Part No.	Description
1	1	430003	Trigger Handle Assembly, 2 Cycle Engine, Right
2	1	430006	Handle Assembly, Left
3	1	430053	Middle Handle W/plug, Right
4	1	430052	Middle Handle W/plug, Left
6	1	430051	Lower Handle W/plug, Right
7	1	430050	Lower Handle W/plug, Left
8	1	430021	Handle Brace
9	1	430056	Label, Handle Brace
	1	430020	Brace with Labels, Includes Key #'s 8,9,51
10	1	430023	Loop Handle Right Half
11	1	430022	Loop Handle Left Half
12	2	4079	M6 Internal Lock Washer
13	2	478	Throttle Clip
14	1	430025	Foam Grip
15	1	430049	Carry Handle With Grip
16	2	4049	Bolt 1/4-20 X 3.25"
17	2	430038	Knob, 1/4-20 X 1.5 Male
18	2	4078	M6 Jam Nut
19	2	430048	Curved Head Bolt, 1/4-20 X2"
20	1	465	Fender Guard
21	1	400904	Engine Assembly Sv-5ci/2
22	1	468	Drive Shaft
23	1	466	Worm Gear Housing
24	1	436	Gasket
25	1	437A	Gear Housing Cover
26	4	651	#8 Self Tapping Screw
27	1	423	Roller Bearing
28	2	425	Worm Bearing Race

* Includes Key #22

4-Cycle Tiller Assembly

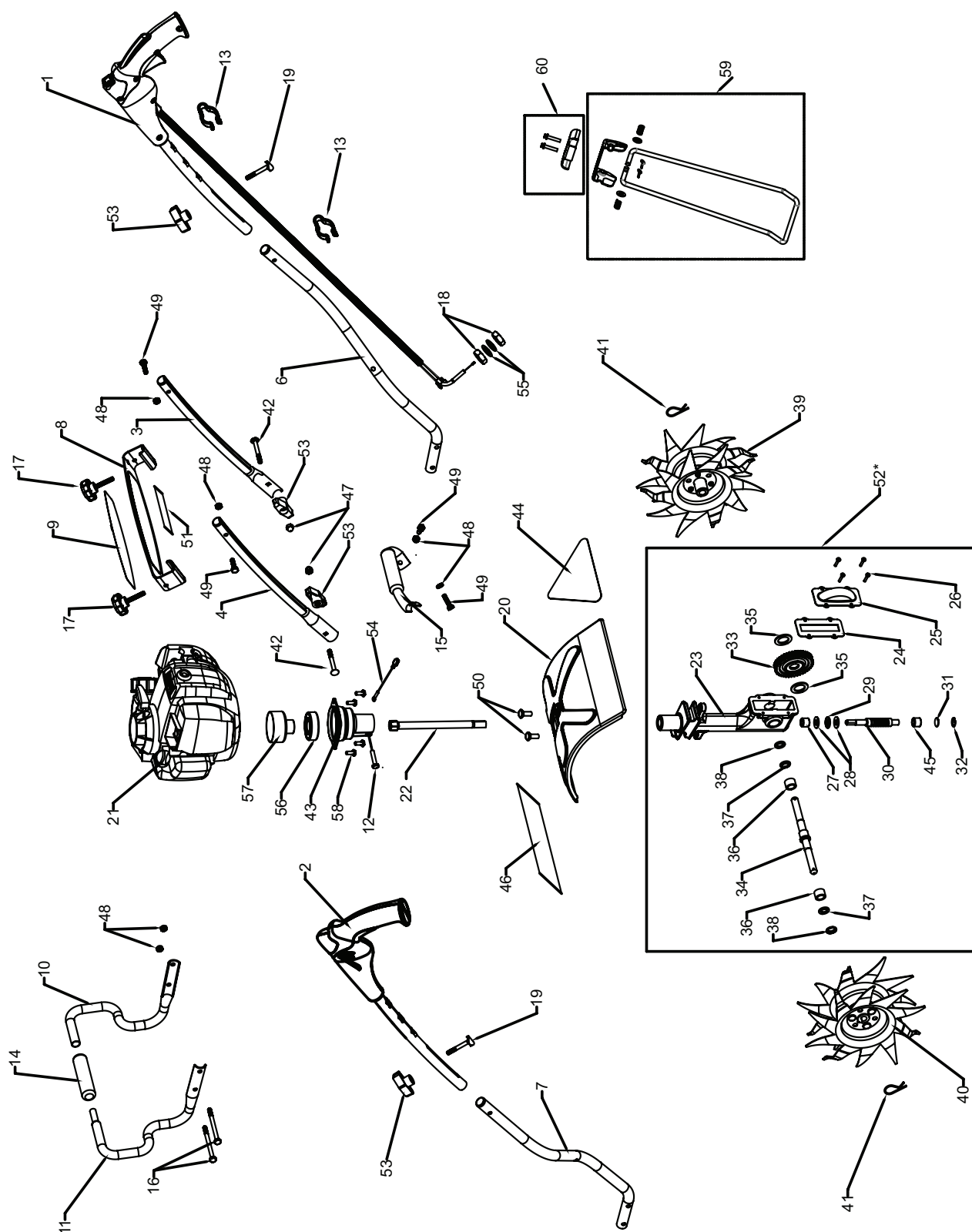

Key	Qty.	Part No.	Description
31	1	426	Worm Disk
32	1	428	Retaining Ring
33	1	429	Worm Gear
34	1	431	Tine Shaft
35	2	430	Worm Gear Thrust Washer
36	2	432	Worm Gear Bearing
37	2	434	Bearing
38	2	435	Bearing Seal Retainer
39	1	438RA	Tine Assembly, Right
40	1	438LA	Tine Assembly, Left
41	2	418-1	Tine Retaining Pin
42	2	430039	Carriage Bolt 1/4-20 X 2.25"
43	1	400130	Engine Flange
44	1	400631	Triangle Warning Label (4 Cycle Engine)
45	1	458	Roller Bearing
46	1	430058	Mantis Logo Label
47	2	395	Acorn Nut
48	6	972	1/4-20 Two-Way Lock Nut
49	4	144-2	1/4-20 X 1.125 Hex Head Cap Screw
50	2	140	Bolt 1/4-20x3/8" Long
51	1	430057	Warning Label
52	1	400010	Transmission Assembly*
53	4	400523	Knob, Two Prongs, Female
54	1	430043	Ground Wire Jumper, 4 Cycle Engine
55	2	4079	M6 Internal Lock Washer
56	1	400132	Bearing
57	1	400131	Clutch Drum
58	4	400511	M6x12 Flange Bolt
59	1	410158	Kickstand, Stand Assembly
60	1	430037	Kickstand, Bracket And Hardware

Key	Qty.	Part No.	Description
1	1	430004	Trigger Handle Assembly, 4 Cycle Engine, Right
2	1	430006	Handle Assembly, Left
3	3	430053	Middle Handle W/Plug, Right
4	1	430052	Middle Handle W/Plug, Left
6	1	430051	Lower Handle W/Plug, Right
7	1	430050	Lower Handle W/Plug, Left
8	1	430021	Handle Brace
9	1	430056	Label, Handle Brace
	1	430020	Brace with Labels, Includes Key #'s 8,9,51
10	1	430023	Loop Handle Right Half
11	1	430022	Loop Handle Left Half
12	1	910502	10-32 X 3/4" Flange Bolt
13	2	478	Throttle Clip
14	1	430025	Foam Grip
15	1	430049	Carry Handle W/Grip
16	2	4049	Bolt 1/4-20 X 3.25"
17	2	430038	Knob, 1/4-20 X 1.5 Male
18	2	4078	M6 Jam Nut
19	2	430048	Curved Head Bolt, 1/4-20 X 2"
20	1	465	Fender Guard
21	1	400911	Engine Assembly-25cc Honda
22	1	468	Drive Shaft
23	1	466	Worm Gear Housing
24	1	436	Gasket
25	1	437A	Gear Housing Cover
26	4	651	#8 Self Tapping Screw
27	1	423	Roller Bearing
28	2	425	Worm Bearing Race
29	1	424	Worm Thrust Bearing
30	1	422	Worm Shaft

* Includes Key #22



Troubleshooting

Problem	Cause	Remedy
1. Tines don't turn when throttle is depressed.	<ul style="list-style-type: none"> Engine is not seated properly on the gear housing. 	<ul style="list-style-type: none"> Re-install engine following the instructions on page 18 (How to reseat the flange).
2. Engine fails to start.	<ul style="list-style-type: none"> O/I switch is in "O" position. No fuel in tank. Fuel strainer clogged. Fuel line clogged. Spark plug shorted or fouled. Spark plug is broken (cracked porcelain or electrodes broken). Ignition lead wire shorted, broken or disconnected from spark plug. Ignition inoperative. 	<ul style="list-style-type: none"> Move switch to "I." Fill Tank. Replace Strainer. Clean fuel line. Install new spark plug. Replace spark plug. Replace lead wire or attach to spark plug. Contact your local authorized dealer.
3. Engine hard to start.	<ul style="list-style-type: none"> Water in gasoline or stale fuel mixture. Too Much oil in fuel mixture. (2-Cycle only) Engine under or over choked. Carburetor out of adjustment. (2-Cycle only) Gasket leaks (carburetor or cylinder base gasket). Weak spark at spark plug. 	<ul style="list-style-type: none"> Drain entire system and refill with fresh fuel. Drain and refill with correct mixture. If flooded by over choking, proceed according to instructions in operation section. If under choked, move choke lever to closed position and crank two or three times. Replace gaskets. Contact your local authorized dealer.
4. Engine continuously floods.	<ul style="list-style-type: none"> Fuel tank vent line is not in an upright position. (2-Cycle only) 	<ul style="list-style-type: none"> Return the fuel tank vent line to the upright position and place it under the cylinder cover in the small "pocket" in the cylinder cover.
5. There is black smoke coming from exhaust.	<ul style="list-style-type: none"> The muffler screen may be clogged. The exhaust port may be restricted. 	<ul style="list-style-type: none"> Clean carbon from muffler screen. Clean exhaust port.
6. Engine misses.	<ul style="list-style-type: none"> Dirt in fuel line or carburetor. Carburetor improperly adjusted. Spark plug fouled, broken or incorrect gap setting. Weak or intermittent spark at spark plug. 	<ul style="list-style-type: none"> Remove and clean. Clean or replace spark plug - set gap to .024-.028 in. (0.6-0.7 mm). Contact your local authorized dealer.
7. Engine lacks power.	<ul style="list-style-type: none"> Air filter clogged. Carburetor out of adjustment. Muffler clogged. Clogged exhaust ports. Spark Arrestor Clogged. Poor compression. 	<ul style="list-style-type: none"> Clean or replace air filter. Clean carbon from muffler. Clean Spark Arrestor. Contact your local authorized dealer.
8. Engine overheats.	<ul style="list-style-type: none"> Insufficient oil in fuel mixture. (2-Cycle only) Air flow obstructed. 	<ul style="list-style-type: none"> Mix fuel as described in starting instructions. (2-Cycle only) Clean flywheel cylinder fins and screen.
9. Engine noisy or knocking.	<ul style="list-style-type: none"> Spark plug in incorrect heat range. Bearings, piston ring or cylinder walls are worn. 	<ul style="list-style-type: none"> Replace with plugs specified for engine. Contact your local authorized dealer.
10. Engine stalls under load.	<ul style="list-style-type: none"> Engine overheats. Carburetor adjustment too "lean." 	<ul style="list-style-type: none"> Remove dust and dirt from between fins. Contact your local authorized dealer.

ECHO INCORPORATED EMISSION CONTROL WARRANTY STATEMENT

FOR ECHO AND SHINDAIWA BRANDS

The Environmental Protection Agency (EPA) and the California Air Resources Board (C.A.R.B.) and ECHO Incorporated (ECHO Inc.) are pleased to explain the emission control system warranty on your 2010 and later equipment/small off-road engine (SORE). New equipment/SORE must be designed, built and equipped to meet stringent EPA and C.A.R.B. anti-smog standards. ECHO Inc. must warrant the emission control system on your equipment/SORE for the periods of time listed below, provided there has been no abuse, neglect or improper maintenance of your equipment/SORE. Your emission control system may include parts such as: carburetor, fuel-injection system, ignition system, catalytic converter/muffler, fuel tank, fuel feed lines, fuel cap assembly, spark plug, air filters, and other associated components. Where a warrantable condition exists, ECHO Inc. will repair your equipment/SORE at no cost to you including diagnosis, parts and labor. The Emission Control System warranty is extended to the original owner including all subsequent owners.

MANUFACTURER'S WARRANTY COVERAGE:

The emission control system is warranted for 2 years or the length of the ECHO Inc. warranty, whichever is longer. If any emission-related part on your equipment is defective, the part will be repaired or replaced by ECHO Inc. or its Authorized Service Representative.

OWNER'S WARRANTY RESPONSIBILITIES:

As the equipment/SORE owner, you are responsible for the performance of the required maintenance listed in your Operator's Manual. ECHO Inc. recommends that you retain all receipts covering maintenance on your equipment/SORE however, ECHO Inc. cannot deny warranty solely for the lack of receipts or for your failure to ensure the performance of all scheduled maintenance. As the equipment/SORE owner, you should be aware that ECHO Inc. may deny you warranty coverage if your equipment/SORE or a part has failed due to abuse, neglect, improper maintenance or unapproved modifications.

You are responsible for presenting your equipment/SORE to an ECHO Inc. authorized service representative as soon as a problem exists. The warranty repairs should be completed in a reasonable amount of time, not to exceed 30 days. If a warrantable condition exists and there is no Authorized Dealer within 100 miles, ECHO Inc. will pay to ship the unit to the nearest authorized dealer. If you have questions regarding your warranty coverage, you should contact ECHO Inc. at 1-800-673-1558, web site WWW.ECHO-USA.COM or contact Shindaiwa at 1-877-986-7783, web site WWW.SHINDAIWA.COM.

WHAT DOES THIS WARRANTY COVER?

ECHO Inc. warrants that your equipment/SORE was designed, built and equipped to conform with applicable EPA and C.A.R.B. emissions standards and that your equipment/SORE is free from defects in material and workmanship that would cause it to fail to conform with applicable requirements for 2 years or the length of the ECHO Inc. warranty, whichever is longer. The warranty period begins on the date the product is purchased by an end user.

HOW WILL A COVERED PART BE CORRECTED?

If there is a defect in a part covered by this warranty, any ECHO Inc. Authorized Service Dealer will correct the defect. You will not have to pay anything to have the part adjusted, repaired or replaced. This includes any labor and diagnosis for warranted repairs performed by the dealer. In addition, engine parts not expressly covered under this warranty but whose failure is a result of a failure of a covered part will be warranted.

WHAT PARTS ARE COVERED?

- Any applicable emission related part not scheduled for "required maintenance" will be repaired or replaced within the warranty period. The repaired or replaced part will be warranted for the remaining ECHO Inc. warranty period.
- Any warranted part that is scheduled only for regular inspection in the written instructions supplied is warranted for the warranty period stated above. Any such part repaired or replaced under warranty will be warranted for the remaining ECHO Inc. warranty period.
- Any emission related part scheduled for replacement during "required maintenance" is warranted for the period of time prior to the first scheduled replacement point for that part. Any such part repaired or replaced under warranty shall be warranted for the remainder of the period prior to the first scheduled replacement point for that part.
- Any manufacturer-approved replacement part may be used in the performance of any warranty maintenance or repairs on emission related parts, and must be provided without charge if the part is still under warranty.
- Any replacement part that is equivalent in performance and durability may be used in non-warranty maintenance or repairs, and shall not reduce the warranty obligations of the manufacturer.
- Throughout the equipment/SORE warranty period, ECHO Inc. will maintain a supply of warranted parts sufficient to meet the expected demand for such parts.

SPECIFIC EMISSION RELATED WARRANTED PARTS:

- | | |
|--|---|
| • Electronic Ignition System | • Spark Plug |
| • Catalytic Converter / Muffler Assembly | • Carburetor (complete assembly or replaceable components) |
| • Choke | • Fuel-Injection Assembly (or replaceable components) |
| • Fuel Tank | • Fuel Cap Assembly |
| • Air Filter | • Fuel Feed Line (and associated clamps/connectors as applicable) |

WHAT IS NOT COVERED?

Any failure caused by abuse, neglect, improper maintenance, unapproved modifications, use of unapproved add-on parts/modified parts or unapproved accessories.

EPA PHASE 2 / CALIFORNIA TIER III EMISSION CONTROL WARRANTY STATEMENT YOUR RIGHTS AND OBLIGATIONS

The Environmental Protection Agency (EPA) and the California Air Resources Board (C.A.R.B.) and The Equipment Manufacturer are pleased to explain the emission control system warranty on your EPA Phase 2 / C.A.R.B. Tier III model year 2005 and later small off road engine (SOREs). New small off road engines must be designed, built and equipped to meet stringent EPA and C.A.R.B. anti-smog standards. Echo, Incorporated must warrant the emission control system on your small off road engine for the periods of time listed below provided there has been no abuse, neglect or improper maintenance of your small off road engine.

Your emission control system may include parts such as the carburetor or fuel injected system, and the ignition system and catalytic converter. Also included may be hoses, belts, connectors and other emission-related assemblies.

Where a warrantable condition exists, the Manufacturer will repair your small off road engine at no cost to you including diagnosis, parts and labor.

MANUFACTURER'S WARRANTY COVERAGE:

The 1995 and later small off road engines are warranted for two years. If any emission-related part on your engine is defective, the part will be repaired or replaced by the Manufacturer.

OWNER'S WARRANTY RESPONSIBILITIES:

- As the small off road engine owner, you are responsible for the performance of the required maintenance listed in your *Operator's Manual*. The Manufacturer recommends that you retain all receipts covering maintenance on your small off road engine, but the Manufacturer cannot deny warranty solely for the lack of receipts or for your failure to ensure the performance of all scheduled maintenance.
- As the small off road engine owner, you should however be aware that the Manufacturer may deny you warranty coverage if your small off road engine or a part has failed due to abuse, neglect, improper maintenance or unapproved modifications.

You are responsible for presenting your small off road engine to the Manufacturer's authorized service center as soon as a problem exists. The warranty repairs should be completed in a reasonable amount of time, not to exceed 30 days.

If you have any questions regarding your warranty rights and responsibilities, you should contact your Product Manufacturer.

EPA PHASE 2 / CALIFORNIA TIER III EMISSIONS DEFECT WARRANTY EXPLANATION

This is additional detailed information about the EPA PHASE 2/ CALIFORNIA TIER III EMISSIONS DEFECT WARRANTY for your small off road engine.

WHAT DOES THIS WARRANTY COVER?

The Manufacturer warrants that your unit was designed, built and equipped to conform with applicable California emissions standards and that your unit is free from defects in material and workmanship that would cause it to fail to conform with applicable requirements within five (5) years. *The warranty period begins on the date the product is delivered to a retail purchaser.* This is your emission control system, DEFECTS WARRANTY.

HOW WILL A COVERED PART BE CORRECTED?

If there is a defect in a part covered by this warranty, a Manufacturer's Authorized Service Dealer will correct the defect.

You will not have to pay anything to have the part adjusted, repaired or replaced. This includes any labor and diagnosis for warranted repairs performed by the dealer. *In addition, engine parts not expressly covered under this warranty but whose failure is a result of a failure of a covered part will be warranted.*

Emissions System repairs covered under this warranty should be completed in a reasonable time, not to exceed 30 days.

IMPORTANT

If the diagnosis reveals no defect, the emission defect warranty does not apply.

WHAT PARTS ARE COVERED BY THE EPA PHASE 2/ CALIFORNIA TIER III 2005 & LATER SMALL OFF ROAD ENGINE EMISSIONS DEFECT WARRANTY?

- Any emission related part not scheduled for, "required maintenance" (See Engine Operators Manual, "SERVICE MAINTENANCE SCHEDULE") will be repaired or replaced within the warranty period. The repaired or replaced part will be warranted for the remaining Emissions Defect warranty period.
- Any emission related part scheduled for replacement during "required maintenance" (See Engine Operators Manual, "SERVICE MAINTENANCE SCHEDULE") is warranted for the period of time prior to the first scheduled replacement point for that part. Any such part repaired or replaced under warranty shall be warranted for the remainder of the period prior to the first scheduled replacement point for that part.
- Any manufacturer-approved replacement part may be used in the performance of any warranty maintenance or repairs on emission-related parts, and must be provided without charge if the part is still under warranty.
- Any replacement part that is equivalent in performance and durability may be used in non-warranty maintenance or repairs, and shall not reduce the warranty obligations of the manufacturer.
- *The owner is responsible for the performance of the required maintenance described in the operators manual.*

SPECIFIC EMISSION RELATED WARRANTED PARTS:

- | | | |
|--------------|--|---|
| - Choke | - Carburetor (complete assembly or replaceable components) | - Fuel Injection Assembly or replaceable components |
| - Air Filter | - Electronic Ignition System | - Spark Plug |
| | | - Catalytic Converter / Muffler Assembly |

WHAT IS NOT COVERED BY THE EPA PHASE 2/CALIFORNIA TIER III 2005 & LATER SMALL OFF ROAD ENGINE EMISSIONS DEFECT WARRANTY?

- *Any failure caused by abuse, neglect, improper maintenance.*
- *Any failure caused by unapproved modifications, use of unapproved add-on parts/modified parts or unapproved accessories.*



LIMITED WARRANTY

MANTIS extends this limited warranty against defects in material and workmanship for a period of five (5) years under normal usage for residential purposes and two (2) years under normal usage for commercial purposes, from the date of purchase by the original purchaser.

MANTIS will repair or replace, at its option, any part or parts of the product found to be defective in material or workmanship during the warranty period. Warranty repairs and replacements will be made without charge for parts or labor. All parts replaced under warranty will be considered as part of the original product, and any warranty on the replaced parts will expire coincident with the original product warranty. If you think your MANTIS TILLER is defective in material or workmanship, you must send it, along with your proof of purchase (sales receipt) to:

Mantis
1028 Street Road
Southampton, PA 18966

You are responsible for pickup and delivery charges; the product must be returned to us postage paid.

MANTIS assumes no responsibility in the event that the product was not assembled or used in compliance with any assembly, care, safety, or operating instructions contained in the Owner's Manual or accompanying the product. This limited warranty does not cover damages or defects due to normal wear and tear, lack of reasonable and proper maintenance, failure to follow operating instructions or owner's manual, misuse, lack of proper storage or accidents [or routine maintenance parts and service]. This limited warranty shall not be effective if your Mantis tiller has been subjected to negligence or has been repaired or altered by anyone other than an authorized dealer or authorized service center.

You must maintain your MANTIS TILLER by following the maintenance procedures described in the owner's manual. Such routine maintenance, whether performed by you or a dealer, is at your expense.

MANTIS MAKES NO EXPRESS OR IMPLIED WARRANTIES, REPRESENTATIONS OR PROMISES EXCEPT THOSE CONTAINED HEREIN. THERE ARE NO OTHER WARRANTIES, INCLUDING WARRANTIES OF MERCHANTABILITY AND FITNESS FOR A PARTICULAR PURPOSE. ALL WARRANTIES OTHER THAN THE EXPRESS WARRANTY SET FORTH ABOVE ARE SPECIFICALLY DISCLAIMED. THE DURATION OF ANY IMPLIED WARRANTY, INCLUDING MERCHANTABILITY AND FITNESS FOR A PARTICULAR PURPOSE, IS LIMITED TO THE DURATION OF THIS WRITTEN LIMITED WARRANTY. MANTIS DISCLAIMS ALL LIABILITY FOR INDIRECT, INCIDENTAL AND/OR CONSEQUENTIAL DAMAGES IN CONNECTION WITH THE USE OF THE MANTIS PRODUCTS COVERED BY THIS WARRANTY. SOME STATES DO NOT ALLOW LIMITATIONS ON HOW LONG AN IMPLIED WARRANTY LASTS AND/OR DO NOT ALLOW THE EXCLUSION OR LIMITATION OF INCIDENTAL OR CONSEQUENTIAL DAMAGES, SO THAT ABOVE LIMITATIONS AND EXCLUSIONS MAY NOT APPLY TO YOU. THIS WARRANTY GIVES YOU SPECIFIC LEGAL RIGHTS, AND YOU MAY ALSO HAVE OTHER RIGHTS WHICH VARY FROM STATES TO STATE.

MANTIS
1028 Street Road
Southampton, PA 18966
(215) 355-9700

Specifications, descriptions, and illustrative material in this literature are as accurate as known at the time of publication, but are subject to change without notice.