

INFORMATION BULLETIN

Date: 3-27-2008

Product Type: **PARTS BULLETIN**

Bulletin No: JC-007-08

430 Steering Valve (23-054) Change

ISSUE: The Parker Steering valve has changed the steering Shaft from $\frac{3}{4}$ " to $\frac{7}{8}$ " which means the original dust seal listed in the parts list (21-402405) will NOT fit the newer steering valves.

CORRECTION: We will update the part breakdown in the near future but in the meantime you will need to make note of the $\frac{7}{8}$ " seal. **The new $\frac{7}{8}$ " seal is part number 21-402407.**

ACTION REQUIRED: Do **NOT** supersede part 21-402405 to 21-402407. They are both good numbers and have separate applications.

PARTS INVOLVED:

OLD STYLE $\frac{3}{4}$ " Seal = 21-402405

NEW STYLE $\frac{7}{8}$ " Seal = 21-402407

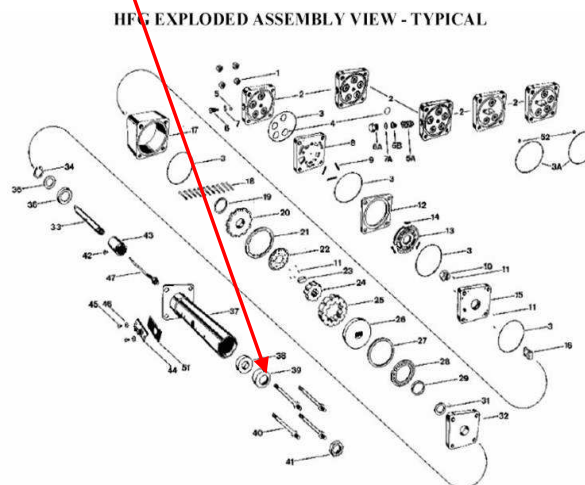

If you have any questions please contact Commercial Grounds Care, Inc.

Customer Service Department @ 920-699-2000

This bulletin is relevant to the departments shown below. Please circulate as appropriate.

SERVICE



WARRANTY



SALES



PARTS

