

INSTALLATION INSTRUCTIONS

1. Raise tractor with jack.
2. Install the dual wheel base on top of the existing nuts with 7/16 NF nuts and tighten to 85 ft. lbs. (Rotate the dual wheel base for best valve stem clearance prior to bolting down.)
3. Bolt the guide plate to inside of extension square.
4. Install extension square to outer wheel with 7/16 NF nuts and tighten to 85 ft. lbs.
5. Fit lockwasher onto the draw rod and install and center roll pin to keep the lockwasher from falling off. Lubricate threads of the draw rod with anti-sieze.
6. **Adjust tire pressure to 5 to 8 lbs. in original tires, and 3 to 4 lbs. in dual tires.**
7. Fit dual wheel into place and insert the draw rod through the assembly into the threaded bushing of the dual wheel base. Tighten draw rod securely to 80 ft.lbs.
8. Repeat steps 1-7 for remaining wheels.

IMPORTANT! Tighten again after one hour of running time!

9. To remove the duals simply loosen the draw nut and remove the draw bolt. The driver adapter may remain on the tractor.

SPECIAL INSTRUCTIONS AND OPERATING PRECAUTIONS

- Tire pressure is important. Excessive tire pressure in outside dual tires may cause premature axle failure. ***Outside duals should have no more than 50% of the inner tire pressure!***
- Operation on or along curbs requires careful operation. Uneven terrain, ditches or curbs that cause the weight of the unit to be carried with the outside tires should be avoided. If mounting a curb becomes necessary, proceed very slowly.
- Avoid high speeds.
- Watch for tire clearance around gates, buildings, posts and trees due to the increased width with the dual wheels.

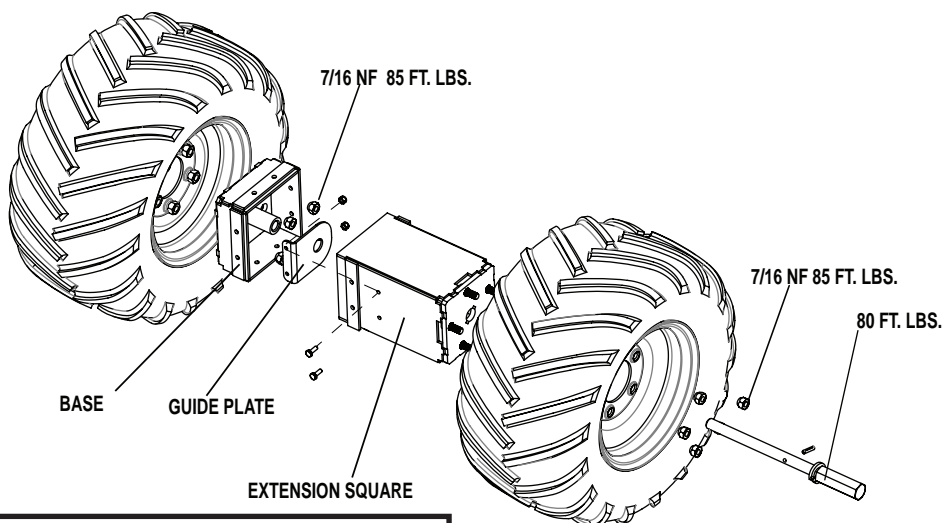

WARNING
EXCESSIVE TIRE PRESSURE IN
OUTSIDE DUAL TIRES MAY CAUSE
PREMATURE AXLE FAILURE.

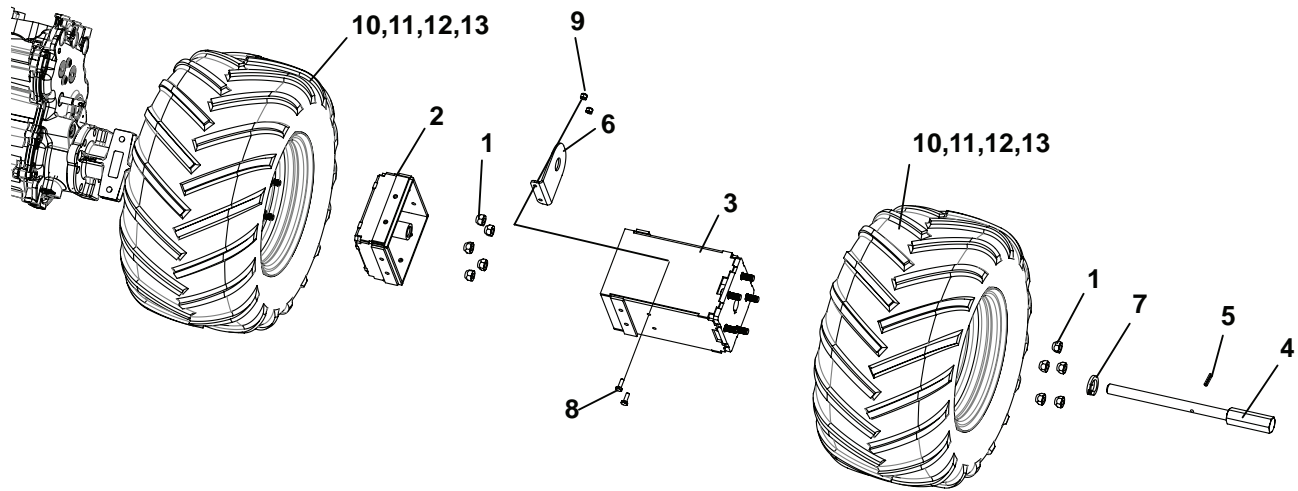

ITEM	PART NO.	DESCRIPTION	QTY
------	----------	-------------	-----

75-71200 DW200-DUAL WHEELS, 440 FLD TRX
(INCLUDES ITEM 1-9 , & 12)

75-71201 DW201-DUAL WHEELS, 440 BAR TRD
(INCLUDES ITEM 1-9 , 10 & 11)

75-71202 DW202-DUAL WHEELS, 440 TURF
(INCLUDES ITEM 1-9 , & 13)

1	64187-02	S-NUT-WHEEL 7/16-20	40
2	4166975.7	WLDMT-BASE, DUAL WHEEL	4
3	4166956.7	WLDMT-EXTNSN, DUAL WHEEL	4
4	4167376	ROD-DRAW, DUAL WHEEL	4
5	64061-39	ROLLPIN-1/4 X 1-1/8	4
6	4167375.7	PLT-GUIDE, DUAL WHEEL	4
7	64006-20	LOCKWASHER-HELICAL, 7/8 I.D.	4
8	64123-89	BLT-HEX 1/4-20X3/4	8
9	64229-01	NUT-NYLON LOCK 1/4-20	8
10	4167166	WHEEL ASSY-CHEV 21X11.0-10 LH	2
11	4167167	WHEEL ASSY-CHEV 21X11.0-10 RH	2
12	4167168	WHEEL ASSY-FIELD TRX22X12.0-10	4
13	4167391	ASSY-WHEEL TURF 22 X 11.0-10	4
14*	00-056	DECAL-WARNING DUAL WHEEL	4

*NOT ILLUSTRATED