

INTRODUCTION: This instruction sheet covers the installation of the Front Fender Kit (75-71208) for the Steiner 440 tractor. **This kit is not compatible with other Steiner tractor models.**

NOTE: -This kit will not work in conjunction with the 440 Cab Accessory and possible other future accessories. **DO NOT** discard the original front lift cylinder shaft. It will be needed for use with these accessories.

ASSEMBLY INSTRUCTIONS:

1. Remove the existing bolt **A** and washer **B** from each side of the Front Cylinder Shaft. Retain hardware to use later in these instructions. Remove the cylinder shaft and keep for use of machine without the front fenders. Retain the washers and the wave spring for assembly in Step 2. **(Figure 1 & 2)**
2. Insert the longer cylinder shaft **1** through the PTO Lever **F**. Install the 1.015 X 1.5 x 14GA washer **C**, the wave spring **D**, and the 1-1/32 x 1-3/4 x 1/4 washer **E** removed in Step 1 between the PTO lever and the front frame. . Slide cylinder shaft through the front frame. **(Figure 3)**

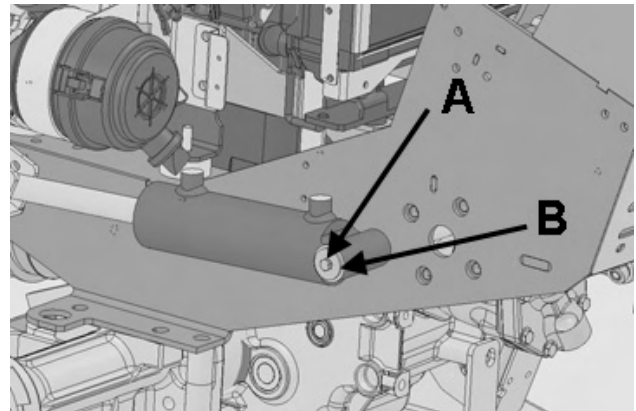

Figure 1

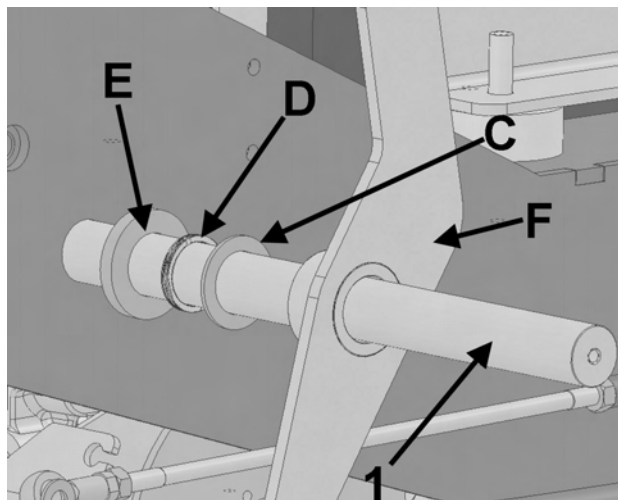

Figure 3

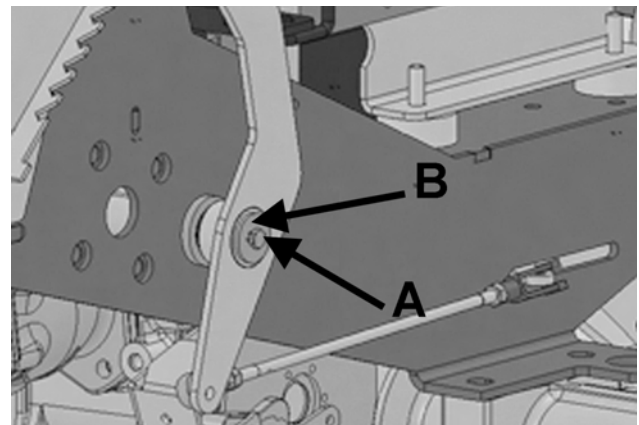

Figure 2

ASSEMBLY INSTRUCTIONS (continued):

3. Replace cylinder onto shaft then slide short spacer tube **2** onto cylinder shaft outside of the lift cylinder. Slide long spacer tube **3** onto cylinder shaft outside of PTO lever. **(Figure 4)**
4. Position the Right Fender Weldment **4** onto the cylinder shaft and push in until it contacts the spacer tube. **(Figure 4)** Fasten into place using hardware **A & B** removed from Step 1. Repeat on the left side with the Left Fender Weldment **5**. **(Figure 4)**
5. Using two bolts **6** and two nuts **7** fasten the Right Stabilizing Bracket **8** to the right fender weldment. Repeat with the Left Stabilizing Bracket **9** on the left side. **(Figure 4)** Tighten hardware.

NOTE: Some older units do not have the mounting holes on the Lower Axle Supports. Follow Step 6 to drill holes.

6. Square up the Stabilizing Brackets to the Lower Axle Supports and center punch each hole. Rotate the fenders with brackets out of the way and drill Ø.281 hole on each punch. (2 per side)
7. Attach Stabilizing Brackets to lower axle supports using two bolts **6** and two nuts **7**.

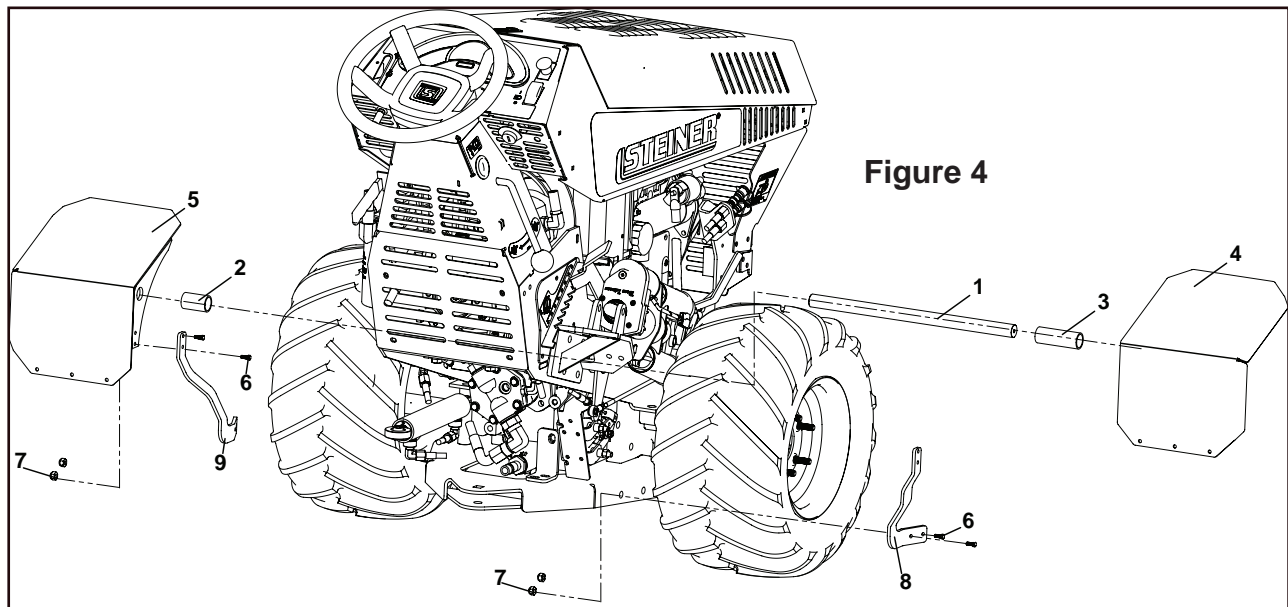
**Figure 4**

KIT PARTS LIST			
ITEM	PART NO.	DESCRIPTION	QTY
1	4167845	SHAFT-CYLINDER MTG, FENDERS	1
2	4167849.7	TUBE-1.03 X 1.25 X 2.02	1
3	4167850.7	TUBE-1.03 X 1.25 X 3.536	1
4	4167847.17	WLDMT-FENDER, FRONT RIGHT	1
5	4167846.17	WLDMT-FENDER, FRONT LEFT	1
6	64123-114	BLT-HEX 1/4-20 X 1	8
7	64229-01	NUT-NYLON LOCK 1/4-20	8
8	4167817.7	BRKT-FRNT FENDER MNT, RT BTM	1
9	4167816.7	BRKT-FRNT FENDER MNT, LFT BRM	1