



One BOB-CAT Lane, P.O. Box 469
Johnson Creek, WI 53038 U.S.A.
(920) 699 2000
Fax: (920) 699 6836

Service Bulletin

Date: March 10, 2014

Bulletin No: JC-14-04

Product Type: STEINER 440

Customer Issue: Loss of Forward or Reverse neutralization. The cable and pedal stay connected to pump shaft but the neutralizer rod becomes disconnected from the pump shaft.

Cause: Schiller recently released Service Bulletin JC-13-23 Rev 2 recommending a specific torque for the pump lever and clamp. We have since developed a new bracket which mounts differently but serves the same function as the original bracket. Specific instructions are attached.

Action required: We are recommending converting over to this new pump lever and clamp, depending on the situation:

- A. If you have **970485** F/R Cable Kits in your inventory and they have not been installed on a tractor yet, we would recommend that you order the new pump lever bracket **970508** through regular parts ordering procedure. This new bracket will replace the original bracket in the 970485 kit.
- B. We have created a revised F/R Cable Update Kit, **970485A**, which has the new bracket as a part of this kit. If you need any additional kits, please order this kit number. This supersedes the original update kit **970485**.
- C. If you have installed the **970485** F/R Cable Kit per the Service Bulletin JC-12-23 Rev 2, no action is required at this time. If the pump lever bracket fails, order and install **970508** Pump Lever Replacement Kit.

Products Involved: The serial numbers listed below are the first units built off the assembly line with the factory installed 970485A kit components. Any prior serial numbers would follow the "Action required - C" from above.

- 75-72010 serial number 75720100445
- 75-72011 serial number 75720110204
- 75-72012 serial number 75720120195
- 75-72013 serial number 75720130188

Warranty:

- A. This is a **fix as fail**. If kit 970485 is installed on a tractor and the pump bracket lever fails, you may claim 1 hour labor to install the kit **970508**.
- B. Please follow regular warranty procedure selecting Service Bulletin Number JC-14-04 from the drop-down labor code in Warranty Smart. One unit per claim.

If you have any questions, please contact our Customer Service Department at 920-699-2000.

This bulletin is relevant to the departments checked below. Please circulate as appropriate.

SERVICE

☒

WARRANTY

☒

SALES

☒

PARTS

☒

MOW IT ► BLOW IT ► TRENCH IT ► HAUL IT ► DRILL IT ► TILL IT ► **DO IT.**



4169996 REV A

INTRODUCTION: This instructions covers the pump lever replacement parts for the service replacement of 4169564.7 and 4169565.7 on the Steiner 440 units.

1. On the front of the unit, move the PTO tension handle out of the way and remove the belt tension cover plate located on the driver's right hand side and the pump panel cover located under the dash. Set aside & retain hardware for reattachment. **Figure 1**

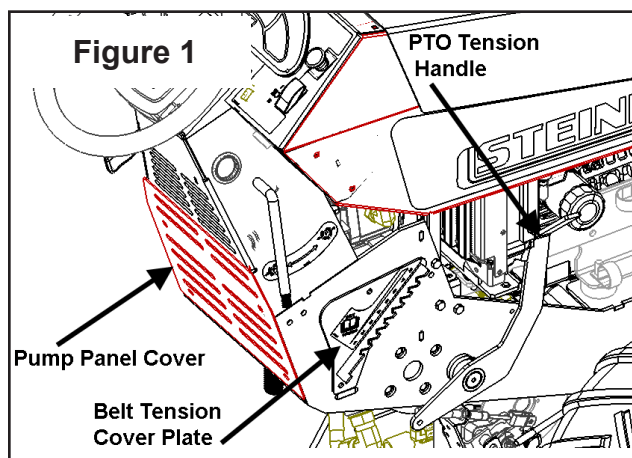

2. Remove the neutral centering ball joint. Unbolt forward/reverse bell crank rod from bell crank end. Save hardware for reinstallation. Remove the hydro pump lever bracket and pump lever clamping bracket and discard. **Figure 2**

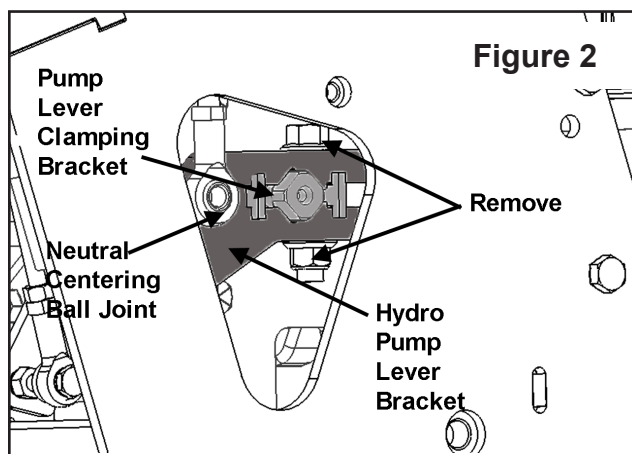

3. Using three new bolts (7), replace mounting bracket hardware one at a time. Discard removed bolts and washers. Leave bolts loose enough so the pump lever plate spacer (3) will fit between the pump plate and the pump. Approximately 1/8" gap. **Figure 3**

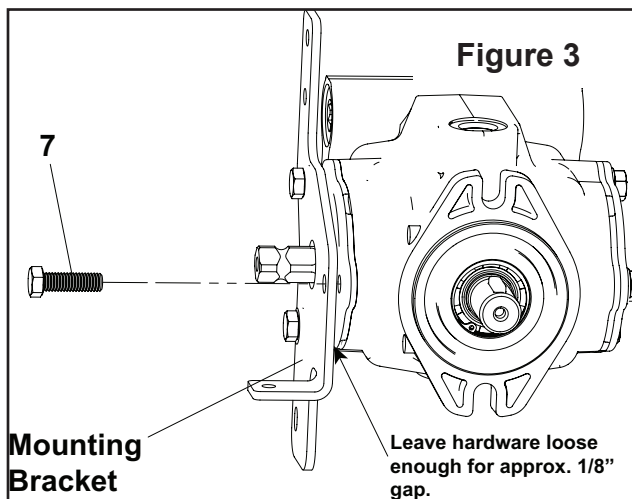

4. Slide the pump lever plate spacer (3) upward between the pump plate and the pump so the bottom left bolt engages on the indicated slot. Turn the spacer counter clockwise until all 3 bolts engage in spacer slots. The spacer handle will be in the vertical position. Tighten hardware. **Figure 4**
5. Assemble pump lever assembly (Items 1, 2, 4-6). Install the forward/reverse cable bellcrank rod (previously removed) onto the pump lever assembly with the rod facing upward. **Figure 5**
6. Assemble pump lever assembly onto pump shaft. **Figure 5**
7. Install two flange bolts (8) and two flange nylon lock nuts (9) into the pump lever clamps. NOTE: The bolts fit into the groove on the pump shaft. Tighten hardware and torque to 35 ft. lbs. **Figure 6**
8. Tighten the bolts (6) of the pump lever assembly. **Figure 6**
9. Reattach Neutral center ball joint and forward/reverse bell crank rod.
10. Adjust as needed. **See Adjustments Page 3.**
11. Reinstall the pump panel cover and belt tension cover plate removed in step 1.

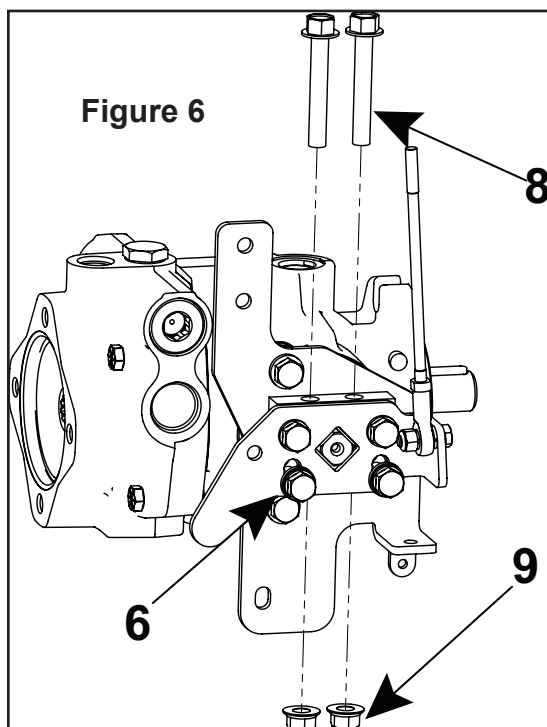
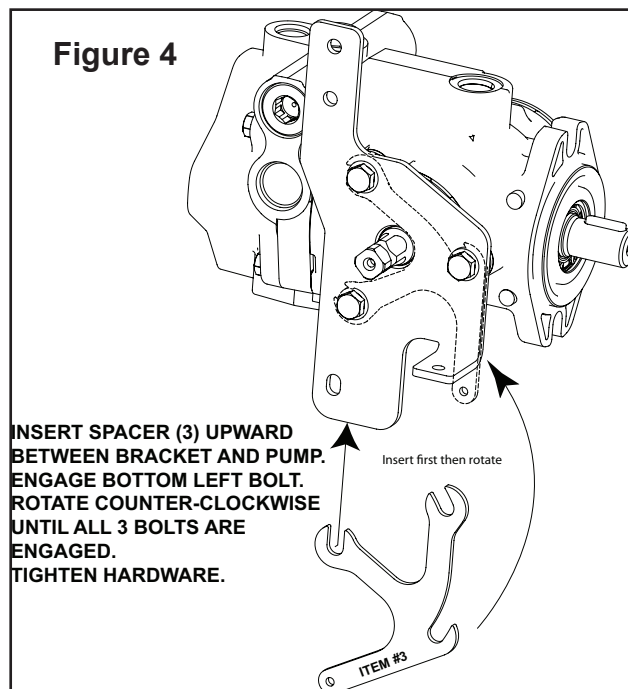
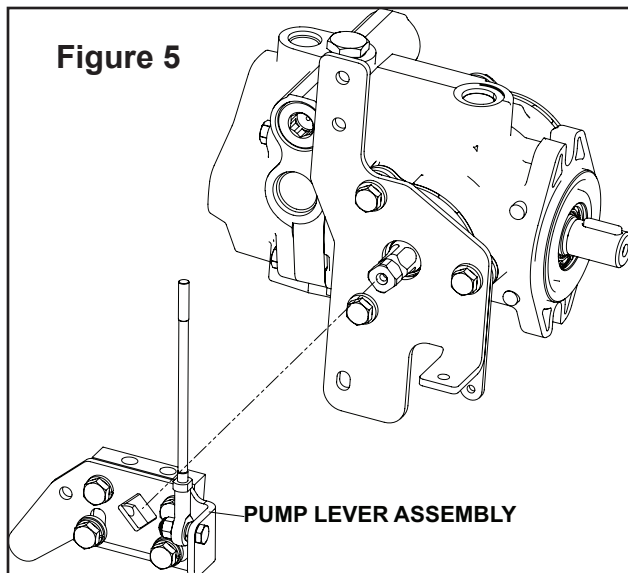
Figure 4

Figure 5



4169996 REV A

ADJUSTMENTS:

NEUTRAL LINKAGE ADJUSTMENT

1. Remove the top bolt on the PTO Adjustment Bracket **A** located on the right side of unit. Loosen the bottom bolt and swing the bracket out of the way.
2. Loosen the jam nut **B**.
3. Turn the adjustment bolt **C** until the desired setting is reached.
Lengthen bolt if unit creeps forward.
Shorten bolt if unit creeps backward.
4. Tighten the jam nut **B** when neutral setting is correct.
5. See Neutral Lock Adjustment.

NEUTRAL LOCK ADJUSTMENT

1. Place the unit into neutral and release the parking brake.
2. Remove the pump cover **E**, located under the steering wheel.
3. Remove the top bolt on the PTO Adjustment Bracket **A** located on the right side of unit. Loosen the bottom bolt and swing the bracket out of the way.
4. Loosen bolt **F** and nut **G**. NOTE: If bolt **F** and nut **G** are installed opposite of what is shown, remove and reassemble with the bolt **F** on the left side and nut **G** on the right.
5. Push the lock plate **H** to center it as shown and retighten nut **G** and bolt **F**.
6. Start the tractor and push on the forward/reverse pedal to see if the neutral lock holds the pump in neutral. If not, re-adjust.
7. Replace PTO adjustment bracket **A** and hardware. Verify all hardware is tight.

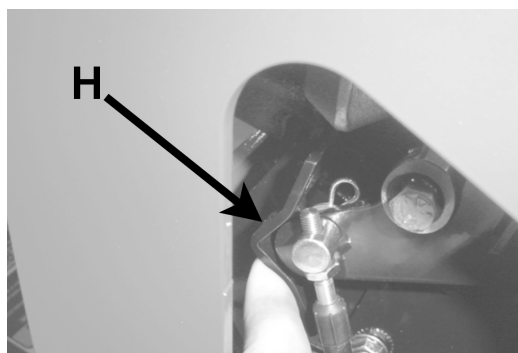
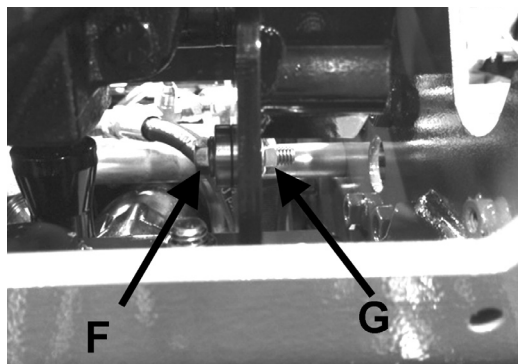
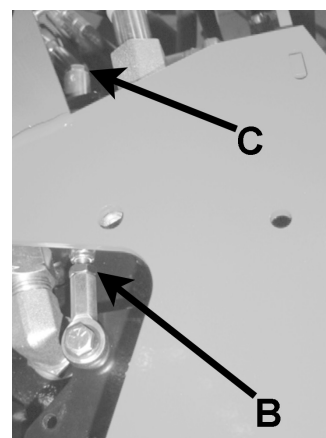
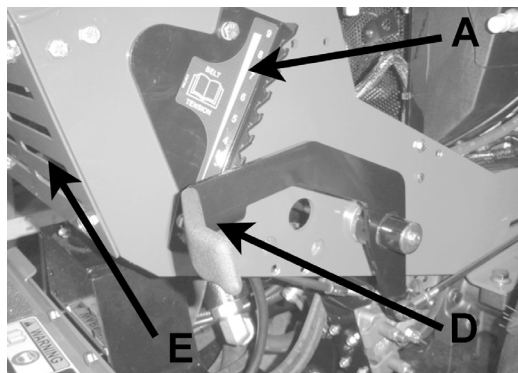

4169996 REV A

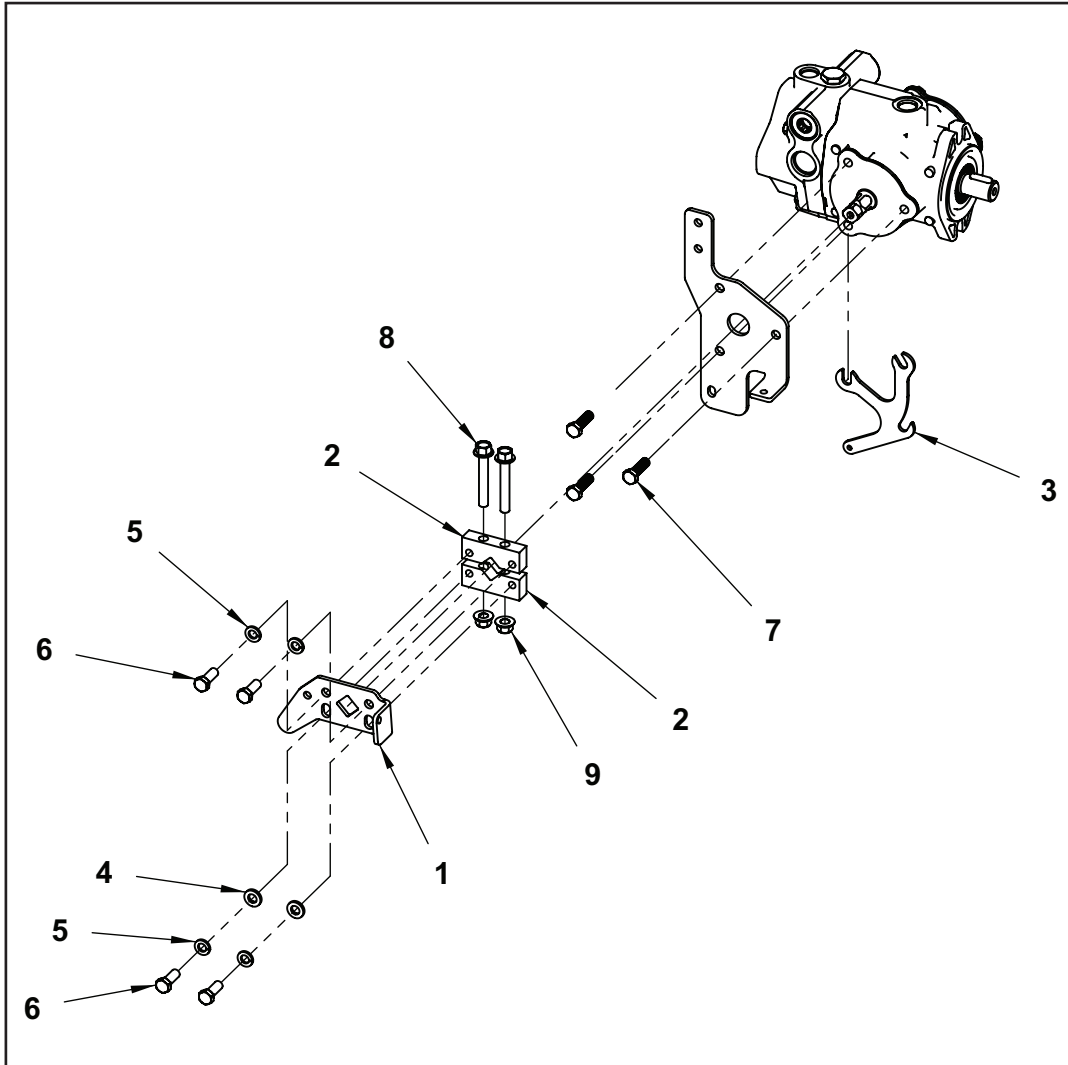

ITEM	PART NO	DESCRIPTION	QTY.
1	4169965.7	BRKT-PUMP LEVER CLAMP	1
2	4169966	CLAMP-PUMP LEVER	2
3	4169967.7	SPACER-PUMP LEVER PLATE	1
4	64163-105	WASHER-.406ID X .75 OD X .134	2
5	64006-03	LOCKWSHR-3/8 HELICAL	4
6	64123-50	BLT-HEX 3/8-16X1	4
7	64123-16	BLT-HEX 3/8-16X1-1/4	3
8	64262-025	BLT-FLG HD 3/8-16 X 2-1/2 LG	2
9	64268-03	NUT-FL NYLON LOCK 3/8-16	2