



INTRODUCTION: This instruction sheet covers the installation of the Rear Weight Bar Kit (75-60500) on the 410 power units.

Weights are added by using a weight bar attachment to counter balance front mounted equipment.

Suggested minimum weights for attachments:

Units	No. of Weights
60" Mower	4
48" Mower	2
Aerator (all types)	4
Blade (power angle and V-blade)	4
Chipper Shredder	4
Snowblower	4
Stump Cutter	2
44" Hydraulic Slip Scoop	4
Terra Rake	4
Trencher	4
Tiller	4

- Align holes on weight bar **1** to holes in tractor hitch frame as shown in illustration on Page 2 and bolt weight bar to tractor, using (1) 5/8-11 X 1-3/4" bolt **2**, (2) 5/8 washers **6**, (1) 5/8 lockwasher **7**, (1) 5/8-11 nut **8**, (4) 3/8-16 X 1 bolts **4** and (4) 3/8-16 nuts **3**. Tighten all fasteners at this time.

NOTE: To install this weight bar on Serial No. 1001 - 1634 you need to purchase Part Number 62-879 Drawbar, not included with kit, which has the correct mounting holes.

- Place the weights **5** on the weight bar **1** and secure with the security bars **10** and presto pins **9**.

NOTE: Rear weights must be used with front mounted attachments over 120 pounds for stability. Weights must be removed when front mounted attachments are removed, or when using attachments less than 120 pounds to reduce the danger of unit tipping over backward while climbing steep slopes or ramps. Always use security rods to hold weights in position.

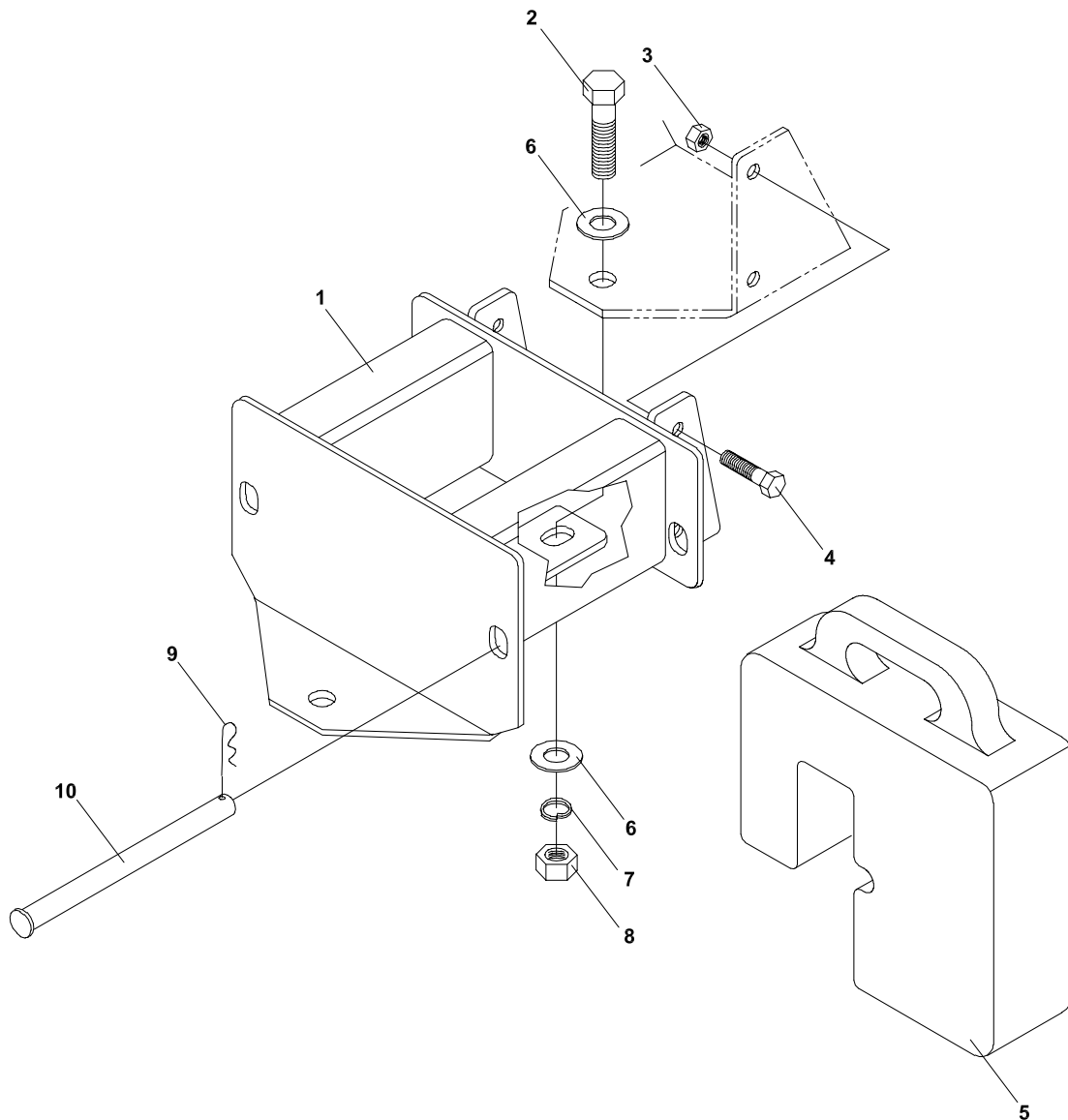

KIT PARTS LIST

ITEM	PART NO.	DESCRIPTION	QTY
1	62-880.7	FRAME, 410 WEIGHTBAR	1
2	90-1014	BOLT-5/8-11 X 1-3/4	1
3	64141-4	NUT-WLF 3/8-16	4
4	64139-24	BLT-WLF 3/8-16 X 1	4
5	62-540.7	WEIGHT	4
6	94-10	FLAT WASHER-5/8	2
7	64006-04	LOCKWSHR-5/8	1
8	64025-21	NUT-HEX 5/8-11	1
9	64168-1	PRESTO PIN	2
10	03-1060	CLEVIS PIN	2