

INTRODUCTION: This instruction sheet covers the installation of the LA V Tote Trailer Mount Kit.

NOTE: Parts indicated with a letter are existing, parts supplied with kit are represented with the number corresponding to the parts list.

1. Attach the mounting masts **1** and **2** to the forward mounting tabs **A** and **B** on the trailer frame **C** using (6) 5/16-18X1-1/4" screws **D**, (2) washers **E** (used on the slotted holes) and (6) 5/16-18 locknuts **3**. Use the center bolt hole on the bottom of the masts for the bottom forward hole position. Lean the masts toward the rear. The slotted holes on the masts go toward the rear and the tab on the left mounting mast **2** faces outward.

NOTE: If your Tote Trailer model is 1992 or newer, and the locking lever **4** supplied with this kit is the same as the existing locking lever and it is mounted using the hole closest to the end of the locking lever, proceed to step 4. If the locking lever **4** is different or not mounted using the hole closest to the end of the locking lever, proceed to step 2.

2. Remove the locking lever from the wheel stop **J** provided with the tote trailer. Remove the 3/8-16X2-1/4" screw **G**, locknut **L** and spring **M** securing the locking lever to the wheel stop.
3. Attach the locking lever **4** onto the wheel stop **J** using the hole closest to the end of the locking lever. Reverse the procedure in Step 2 for installation.
4. Position the left wheel stop **H** and the right wheel stop (with the locking lever) **J** on the frame at their farthest allowable width. Do not tighten at this time.
5. Position the Lawnaire V so that it aligns with the stop assemblies. Adjust the wheels stop assemblies to leave approximately a 1/4" (6 mm) space between the wheel stop assembly and the wheel. Tighten wheel stops securely. Place the wheel locking lever **4** over the right wheel and prepare tote trailer for towing. Refer to the Tote Trailer manual Part Number 521663 for instructions and precautions for loading and transporting the tote trailer.

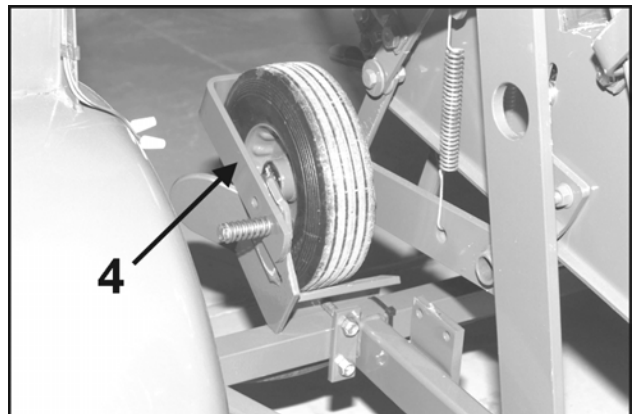
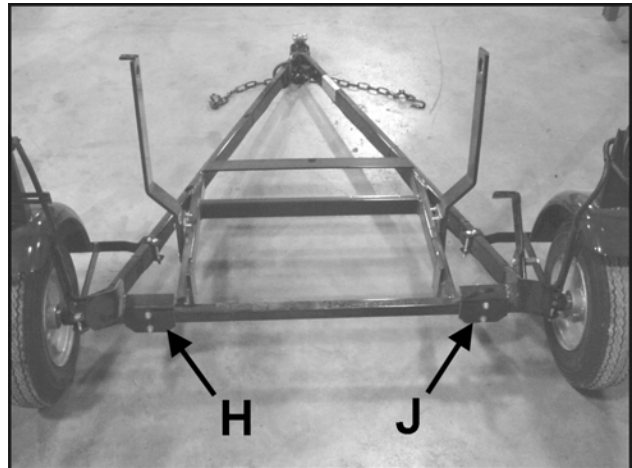

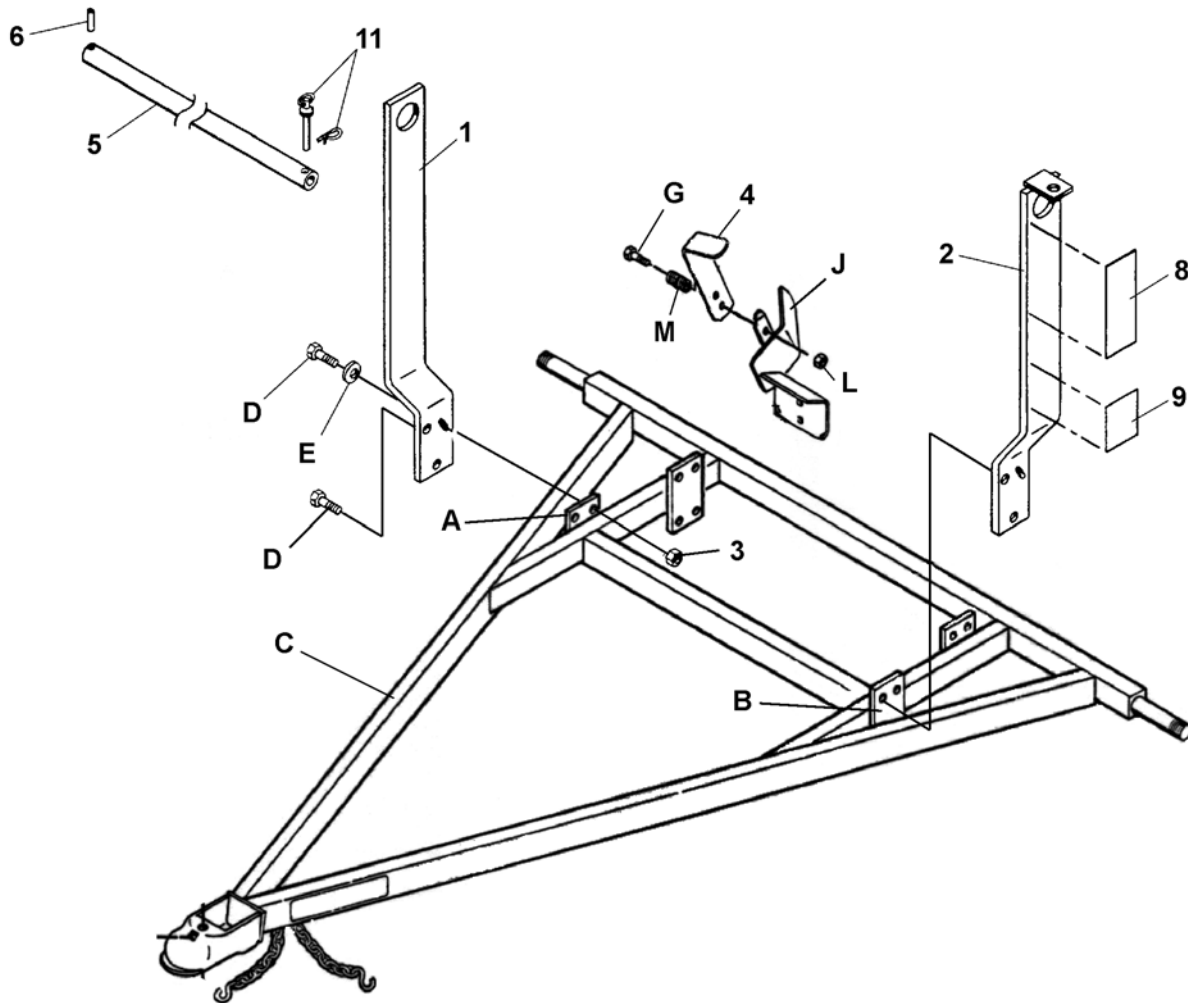

KIT PARTS LIST

| ITEM | PART NO. | DESCRIPTION | QTY |
|------|-----------|---|-----|
| 1 | 539001.7 | MAST, MOUNTING, RH | 1 |
| 2 | 2702148 | MAST, MOUNTING, LH (INCLUDES ITEMS 8 & 9) | 1 |
| 3 | 64229-02 | NUT 5/16" LOCKING | 6 |
| 4 | 524121.7 | LOCKING LEVER (ITEM 4 REPLACES THE EXISTING LOCKING LEVER ON MODELS 1991 AND PRIOR) | 1 |
| 5 | 2702147.7 | SHAFT, LOCKING (INCLUDES ITEM 6) | 1 |
| 6 | 548192 | PIN, ROLL 1/4"x2-1/4" | 1 |
| 7 | * 4128519 | I.S. LA V TOTE TLR MNT | 1 |
| 8 | 521658 | DECAL, OPERATING | 1 |
| 9 | 521660 | DECAL, SAFETY | 1 |
| 10 | 882770 | PIN, HITCH | 1 |

* NOT ILLUSTRATED