

1982 Tractor

**STEINER**



**OWNERS MANUAL**

Front End Loader  
Cylinder  
for farmers

# CONTENTS

Barnes Pump

To the Owner .....	1
Description .....	2
Pre-Start Instructions .....	3
Controls .....	4
Operating Instructions .....	5
Driving the Steiner Tractor .....	6
Service Schedule .....	7
Service Chart .....	8
Trouble Shooting .....	9
Blade .....	10
Mower Operation .....	11
Mower Maintenance .....	12

## PARTS

Electrical .....	13
Engine .....	14
Hydraulic System .....	15, 16
Axles & Wheels .....	17
Rear Parts .....	18
Front Parts .....	19, 20
3-Point Hitch .....	21
Blade .....	22
Mower .....	23-26
Guarantee .....	27

Date of Purchase: \_\_\_\_\_ Month \_\_\_\_\_ Day \_\_\_\_\_ Year \_\_\_\_\_

Dealer Name \_\_\_\_\_ Phone Number \_\_\_\_\_

Serial Number \_\_\_\_\_

Engine Number \_\_\_\_\_ Make \_\_\_\_\_



12657 Church Road  
Orrville, Ohio 44667  
Phone: 683-0055

### **TO THE OWNER**

The purpose of this manual is to assist you in realizing all the benefits anticipated when you purchased your new Steiner Tractor.

The way you operate this product, and the care you give it, will have much to do with its successful performance.

This manual has been prepared and illustrated to give you as much information as possible.

It is important that you read the entire manual carefully before operating your new tractor, and keep it handy for future reference. Your Steiner dealer will be happy to answer any further questions, or refer them to us at Steiner Corporation: 12657 Church Road, Orrville, Ohio 44667.

## ***Description***

The HYDROSTATIC, 4-wheel drive, Steiner tractor is designed with the user in mind. All components are those that have been tested and used in other equipment, and parts are readily available.

The tractor is powered by a Briggs and Stratton, twin cylinder engine, driving an industrial hydraulic pump. This pump supplies the power to the two identical transaxles, providing the four-wheel drive.

Center pivot power steering enables it to operate in close quarters and further enhances the 4-wheel drive ability. Its low center of gravity and large, low pressure, high flotation tires enables it to operate on side hills far steeper than anything in its category.

The ruggedly built, front-mounted mower enables you to mow under bushes and shrubs or out over water or ditch banks. It, along with the snowblower, is designed to be removed in seconds by removing one drive belt, pulling a release latch, and backing away. To hook up, just reverse the procedure.

The blade just snaps on and off the front hydraulic lift. Category "O" 3-point-hitch for the rear is optional and enables the tractor to use most of the equipment available, such as plows, scrapers, and cultivators.

All the bearings on the mower and snowblower are standard industrial grease-type roller bearings that can be purchased 'off the shelf' locally. All belts and pulleys likewise are standard industrial items that can also be locally purchased. No more going to a specific dealer for a one-of-a-kind item!

The Steiner tractor also has as standard equipment, adjustable seat, 12-volt automotive type battery, electric start, lights, front hydraulic lift, and power steering.

The tractor has been bought and used with great success in many places — schools, city and county parks, campgrounds, golf courses, orchards, vineyards, industrial parks, chicken farms, and by many, many homeowners.

It's more than a mower, more than a tractor — it's even a "fun to run" machine!

- 1. Always check engine oil.**
- 2. Make sure you have plenty of fuel.**
- 3. Visually check tires.**
- 4. Adjust seat.**
- 5. READ SAFETY DECALS.**
- 6. Get emotionally ready for a good experience.**

# PRE-START INSTRUCTIONS

## FILL CRANKCASE WITH OIL

Place engine level. Clean area around oil fill before removing dipstick.

**EXTENDED OIL FILL.** Remove cap and dipstick. **FILL TO FULL MARK** on dipstick, **POUR SLOWLY**. Capacity 3 pints (1.42 liters). When checking oil level, push dipstick assembly firmly but slowly until cap bottom on tube. **DO NOT OVERFILL.** Dipstick assembly must be securely assembled into tube at all times when engine is operating.

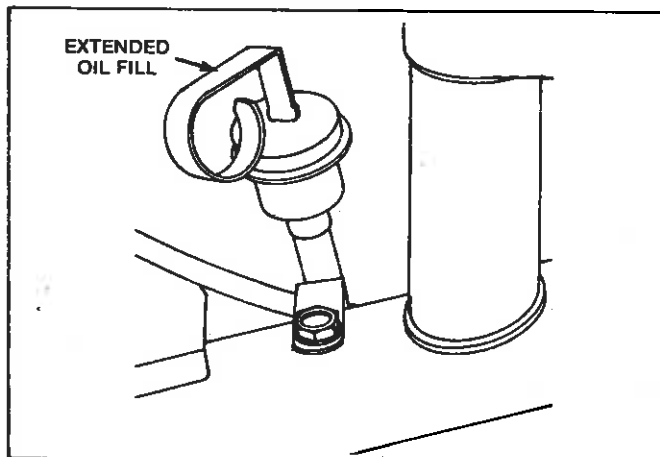

## RECOMMENDED SAE VISCOSITY GRADES

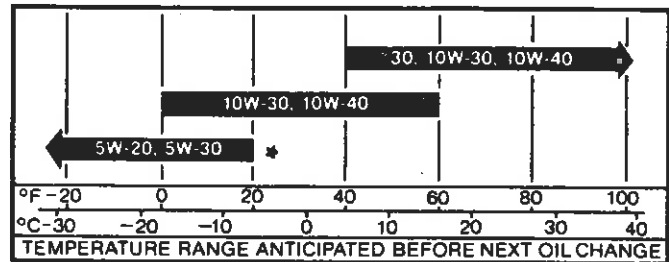

\*If not available, a synthetic oil may be used having 5W-20, 5W-30 or 5W-40 viscosity.

## FILL FUEL TANK

Use clean, fresh, "regular grade leaded or low-lead" gasoline. **DO NOT MIX OIL WITH GASOLINE.**

**NOTE:** The use of "lead-free" gasoline produces fewer combustion deposits, but may shorten valve life if carburetor adjustment is too lean.

# Controls

Figure 2

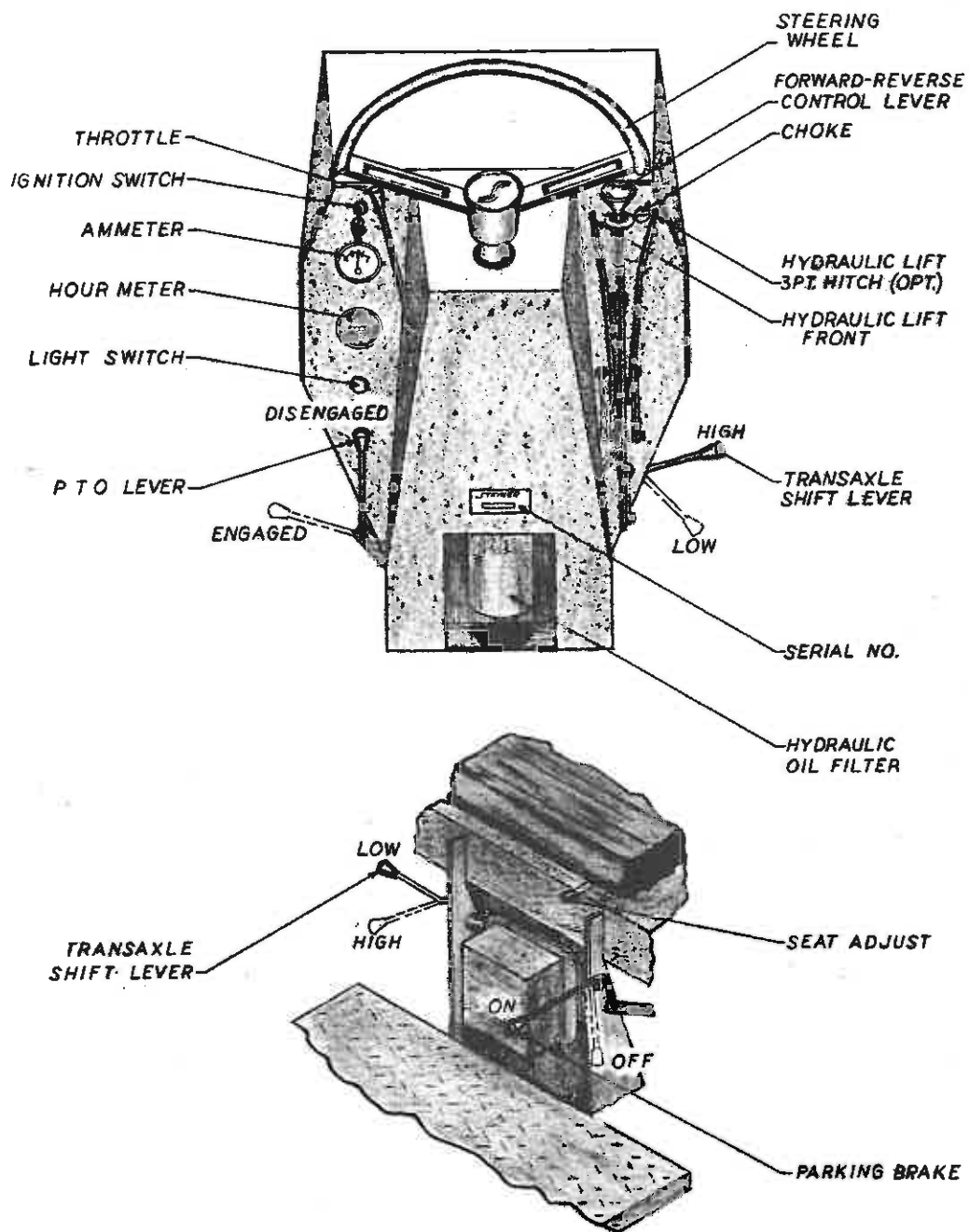

# Operating Instructions

## IMPORTANT!

CHECK ALL BOLTS FOR SIGNS OF  
LOOSENING AFTER ONE HOUR OF  
OPERATION AND DAILY THEREAFTER

MOWER AND OTHER ATTACHMENTS:  
CHECK ALL BOLTS AND SET SCREWS  
ON PULLEYS AND SHAFTS FOR SIGNS  
OF LOOSENING  
TIGHTEN AS NEEDED!

## STARTING

1. Put forward-reverse control in Neutral.
  2. Make sure P.T.O. is in the "Out" position.
  3. Pull throttle back approximately one inch.
  4. Pull choke all the way out.
  5. Turn key to right. Tractor should start.
  6. Push choke most of the way in until engine warms up.
  7. In cold weather, let hydraulic oil warm up a few minutes before using tractor.
  8. Make sure both transaxles are in the SAME GEAR.
  9. The farther you push (or pull) the forward-reverse lever, the FASTER you go.
- NOTE: Move control gradually.
10. To STOP, pull the control to NEUTRAL.

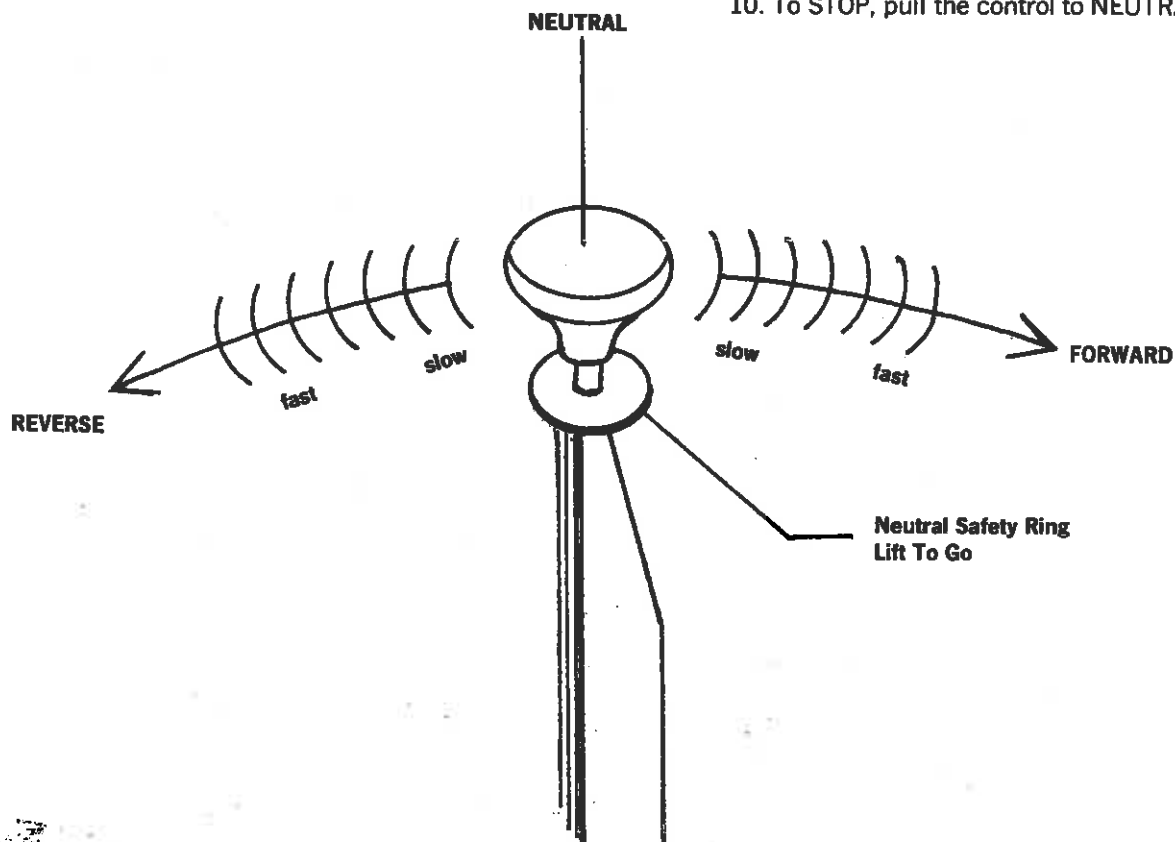

**NOTE: LEVER MUST BE IN NEUTRAL AND P.T.O. IN THE "OUT" POSITION  
OR TRACTOR WILL NOT START!**

# *Driving the Steiner Tractor*

Driving the Steiner Tractor with its center pivot steering is usually somewhat of a new experience, but after a few minutes this "different feel" vanishes and is replaced by a feeling of pure pleasure.

With its superb maneuverability and 4-wheel drive, the tractor becomes a "go almost anywhere" machine; therefore, we urge EXTREME CAUTION, lest these features get you into trouble.

We offer these operating tips to ensure your safety and pleasure:

- A.. Take some time and get used to the handling characteristics of your new tractor.
- B. Always look before backing.
- C. Slow down over rough terrain.
- D. Do not make sharp turns at high speeds.
- E. When going down steep grades with mower on, put mower in DOWN position.

**CAUTION: IF MOWER IS NOT ATTACHED,  
BACK DOWN STEEP GRADES.**

- F. When going up steep grades, put transaxles in low gear and open throttle enough to provide adequate power to prevent stalling. Control speed with forward-reverse lever.
- G. When hauling heavy loads or using blade ALWAYS use low gear. Load limit 1000 lbs. Do not exceed weight limit.
- H. Do not expect your tractor to think for you.

**USE COMMON SENSE!!**

## **WARNING**

**ALWAYS DISENGAGE PTO  
SET BRAKE AND SHUT ENGINE OFF  
BEFORE LEAVING TRACTOR SEAT**



## Daily Service Schedule

1. Check fuel level
2. Check engine oil level
3. Visual inspection of:

Use good clean regular or unleaded gasoline

Use HD30 above 32° F.

(a) Bolts & fittings for signs of loosening

(b) Accumulation of dirt or foreign material around engine restricting engine cooling.

(c) A clean tractor is easier to maintain and a pleasure to use

## 25 Hour Service Schedule

1. Change engine oil.
2. Check air cleaner.
3. Check battery water level.
4. Check transaxle oil levels.

Use HD30 Above 32° F

Use HD10W40 below 32° F.

Capacity: 1-1/2 quarts U.S.

Clean as necessary.

Fill as necessary.

1/4 inch over plates.

Refill as needed with 1H Hytran or JD 303 special purpose oils, or see your dealer.

DO NOT USE motor oil or automatic transmission oil.

A. Bolt and fittings for signs of loosening. Tighten as necessary.

B. Accumulation of dirt or foreign material around engine restricting engine cooling.

Grease fitting on center pivot ball.

Adjust to 5 lbs. when using front mounted equipment.

Replace if extremely dirty.

Grease all fittings.

Do not over-grease.

5. Visual inspection of:

6. Lubrication.
7. Check tire pressure.
8. Check fuel filter.
9. Mower.

## Annual Service Schedule

In addition to daily and 25 hour service:

1. Replace hydraulic oil filter
2. When storing tractor

Use Michigan Fluid Power S-29 or equivalent

Refill transaxles as needed

Drain fuel tank

Maintain tire pressures as specified

*Do Not use  
NAPA 1552  
Unit will  
not run  
From  
AC*

# Service Chart

KEEP IT CLEAN!

Figure 3

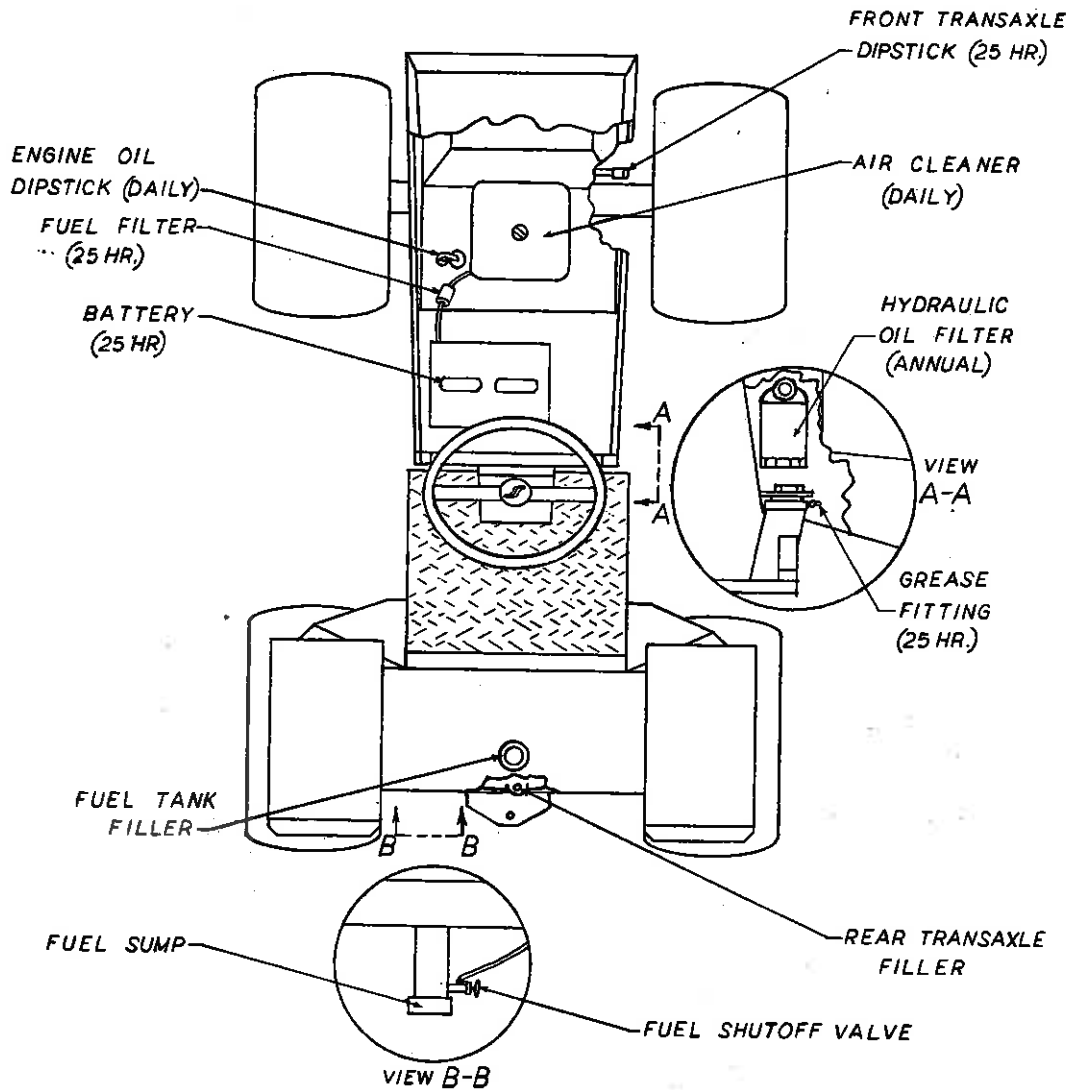

# Trouble Shooting

SYMPTOMS	POSSIBLE CAUSE	REMEDY
Engine fails to start.	<ol style="list-style-type: none"><li>1. Forward-reverse control not in neutral.</li><li>2. P.T.O. lever not in neutral.</li><li>3. Fuse blown.</li><li>4. Discharged battery.</li><li>5. Dirty fuel filter or out of fuel</li></ol>	<ol style="list-style-type: none"><li>1. Position control lever in neutral.</li><li>2. Position P.T.O. lever in neutral.</li><li>3. Replace with 14A fuse.</li><li>4. Charge battery.</li><li>5. Replace fuel filter, and/or fill.</li></ol>
Loss of power.	<ol style="list-style-type: none"><li>1. Dirty air cleaner.</li><li>2. Transaxle shifters not in same range.</li><li>3. Low oil level in transaxles.</li><li>4. Parking brake improperly adjusted.</li><li>5. Dirty fuel filter.</li></ol>	<ol style="list-style-type: none"><li>1. Remove air cleaner; clean or replace.</li><li>2. Shift both shift levers into proper range.</li><li>3. Refill transaxles to proper level.</li><li>4. Adjust parking brake.</li><li>5. Replace fuel filter.</li></ol>
Excessive wheel slippage.	<ol style="list-style-type: none"><li>1. Tire pressure too high.</li><li>2. One transaxle shifter in neutral.</li></ol>	<ol style="list-style-type: none"><li>1. Adjust tire pressure to 5 lbs.</li><li>2. Shift both shift levers into proper range.</li></ol>
Tractor jerks or is not responsive to control lever movement — too large neutral movement.	<ol style="list-style-type: none"><li>1. Loose pump control arm or linkage.</li><li>2. Low oil level in transaxle.</li><li>3. Loose or dirty hydraulic filter.</li><li>4. Transaxles in neutral.</li></ol>	<ol style="list-style-type: none"><li>1. Tighten pump control arm or linkage.</li><li>2. Refill transaxles to proper level.</li><li>3. Tighten or replace hydraulic filter.</li><li>4. Check shifters front and rear.</li></ol>
Noisy operation.	<ol style="list-style-type: none"><li>1. Low oil level in transaxles.</li><li>2. Loose or dirty hydraulic filter.</li><li>3. Low hydraulic pressure.</li><li>4. Restriction or air leak in pump supply lines.</li></ol>	<ol style="list-style-type: none"><li>1. Refill transaxles to proper level.</li><li>2. Tighten or replace hydraulic filter.</li><li>3. See your dealer for pump repairs.</li><li>4. Replace defective hose.</li></ol>
Loss of power steering.	Same as above.	Same as above.
Loss of lift (mower/blade)	Same as above.	Same as above.

# Blade

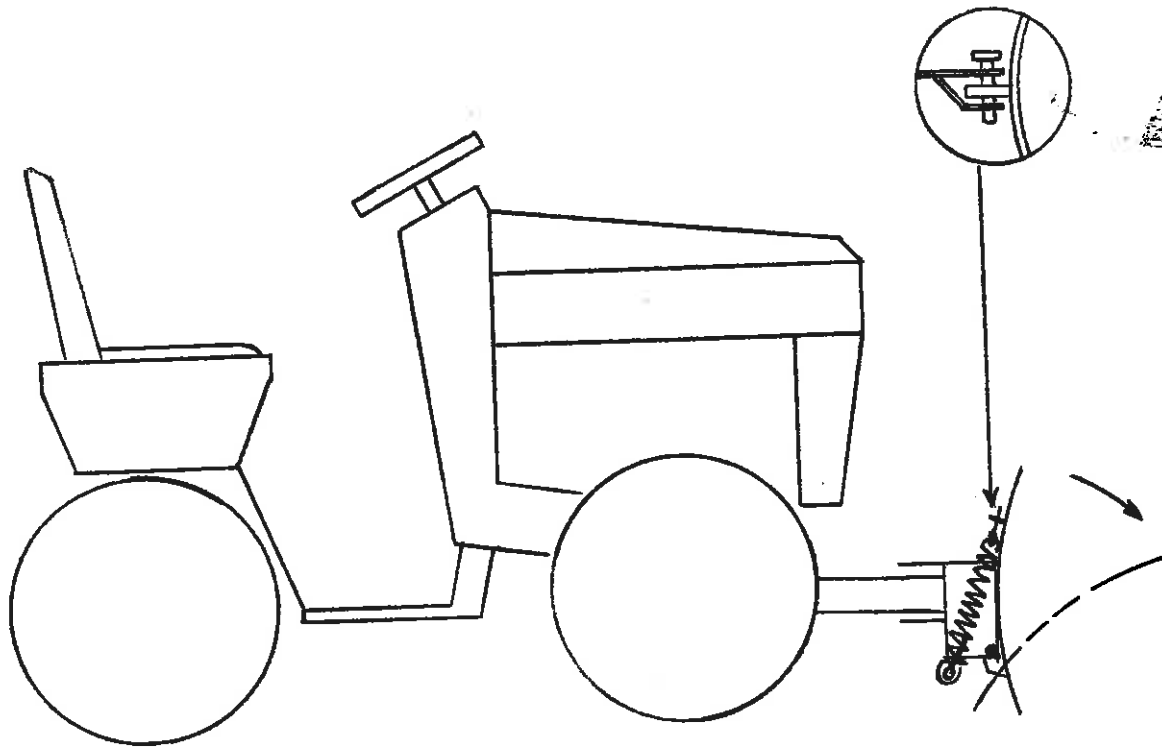

Dozer blade is equipped with spring "trip" to prevent damage to driveway surface.

For heavy work, insert pin to make blade solid.

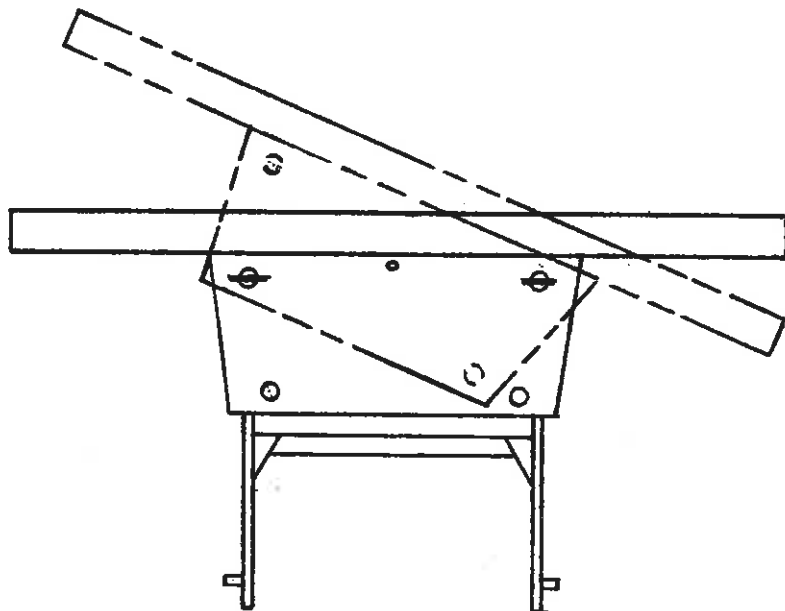

ANGLE BLADE right or left by pulling one pin, move blade in desired direction and replace pin.

# Mower Operation

Be sure to observe all Safety Decals. When attaching the mower, drive tractor into place, engaging the quick attach. Make sure it is latched securely. Shut off tractor. DO NOT attempt to put drive belt on while tractor engine is running. **MAKE SURE P.T.O. lever is in the OUT position.**

- Put on drive belt.  
Adjustment is provided by moving drive idler in slotted hole.
- Make sure all guards are in place.
- Set mower to desired height.
- Start tractor and engage belt slowly.
- Make sure mower is in the FLOAT position.  
(See "LIFT")
- When mowing, pull the throttle most of the way back to ensure proper blade speed.  
Most level mowing can be done in "HIGH" gear with speed controlled by the FORWARD-REVERSE lever.
- When going UP steep grades, put tractor transaxles in "LOW" and keep engine at near full speed to minimize wheel slippage.
- When going DOWN steep inclines or loading on or off truck with mower on, put mower in the "DOWN" position to prevent lifting rear wheels off the ground.

## SAFETY PRECAUTIONS:

- A. Keep all guards in position.
- B. Do not work around mower when it is running.
- C. Watch out for debris in mowing area.
- D. Be extremely careful when mowing steep inclines.

## Hydraulic Lift

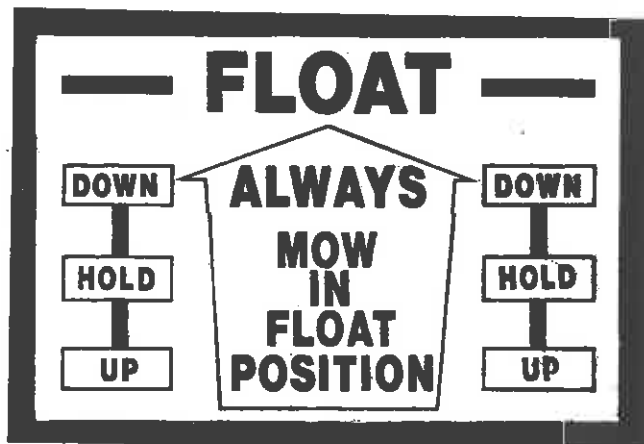

The hydraulic lift is equipped with 2-way controls and cylinders.

Single spool valve is standard equipment.

2 or 3 spool valve is optional.

NOTE: Float position is available on the front lift only.

## WARNING:

**Mower MUST be operated in the FLOAT position to prevent damage.**

# Mower Maintenance

**DAILY:** Visual inspection for loose parts and accumulation of grass and dirt. Keep blades sharp.

**25 HOUR:** In addition to above; grease fittings - DO NOT over grease.

**ANNUAL:** In addition to above; remove and sharpen blades, clean and wash deck prior to storage. The acid in grass causes corrosion to mower parts. Replace belts as needed.

Installing main drive belt:

1. Remove 3 top rear shields and cotter pin between attaching arms. No further disassembly is necessary.
2. Follow illustration below and install belt as shown. (It will be necessary to slide the belt between the top and bottom deck along the front).

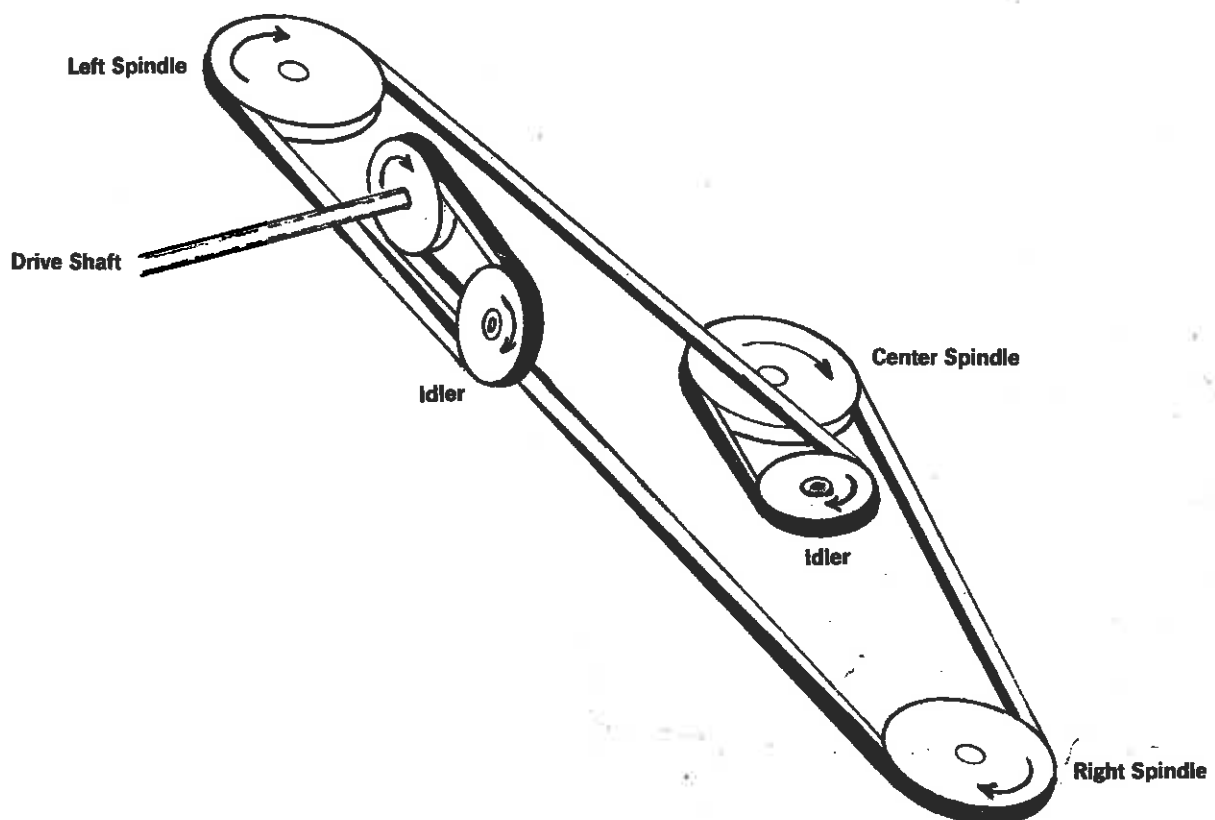

Build #  
gyl 1156 (G2)

# Electrical

Figure 4

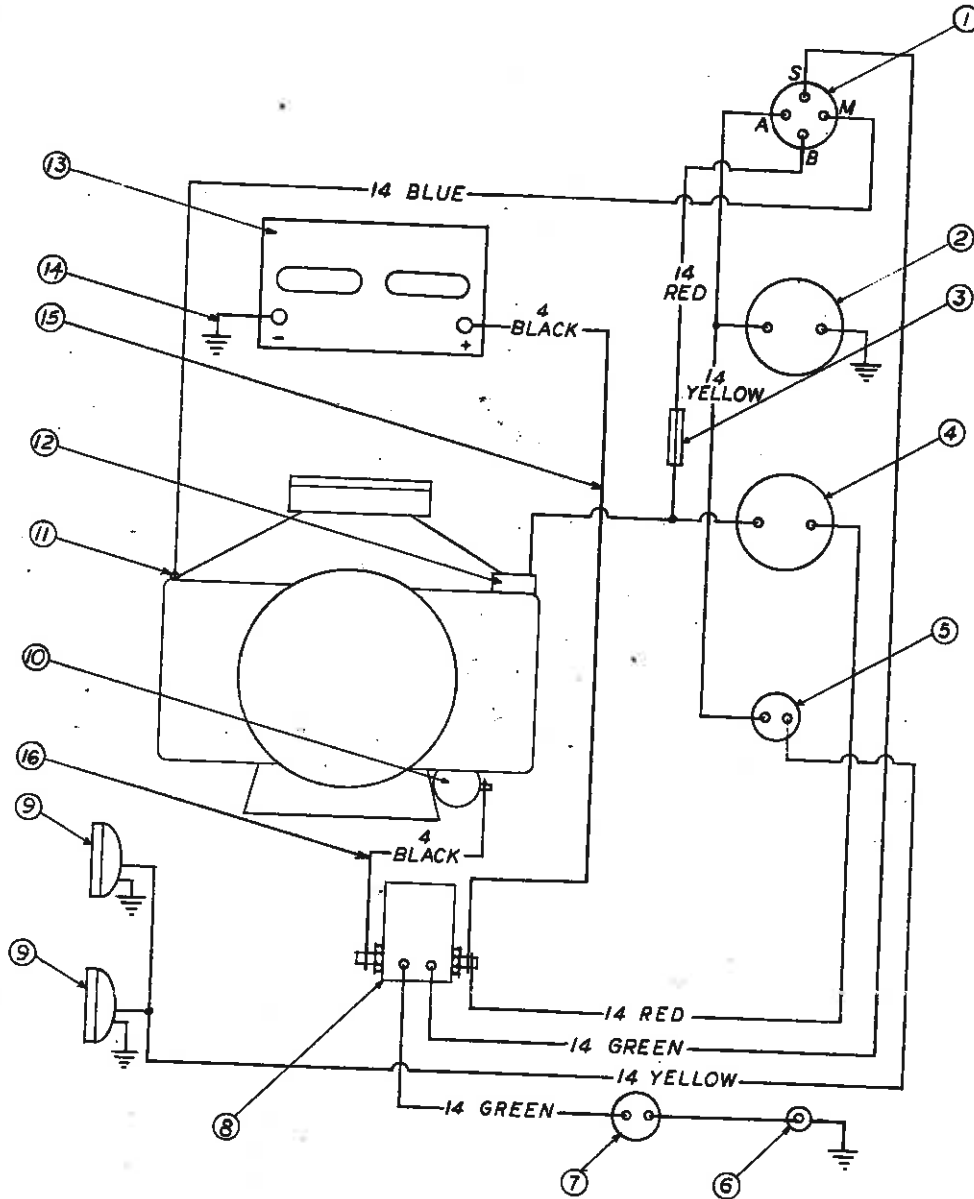

LEGEND  
COLOR - CIRCUIT  
RED - BATTERY  
GREEN - START  
YELLOW - ACC.  
BLUE - IGNITION

REF.	PART NO.	DESCRIPTION
1	31-01	Ignition Switch (B&S)
2	31-02	Ignition Switch (Onan)
3	35-14	Hour Meter
4	35-15	Fuse 14A
5	35-16	Ammeter
6	31-03	Light Switch
	90-0406	Neutral Start Contact
	94-04	Bolt
	99-A04	Washer
	05-05	Locknut
		Grommet

REF.	PART NO.	DESCRIPTION	QUAN.
7	31-04	Switch, PTO Neutral	1
8	31-05	Solenoid	1
9	33-01	Light	2
10	Sup. by B&S	Starter	
11	Sup. by B&S	Magneto points condenser	
12	Sup. by B&S	Voltage Regulator	
13	33-02	Battery, Group 22F	1
14	30-01	Negative Ground Cable	1
15	30-02	Positive Batt. Cable	1
16	30-03	Starter Cable	1
	30-04	Wiring Set, Complete	

1406 Steiner Tractor Muffler  
14-0411 MPV 22

# Engine

## Figure 5

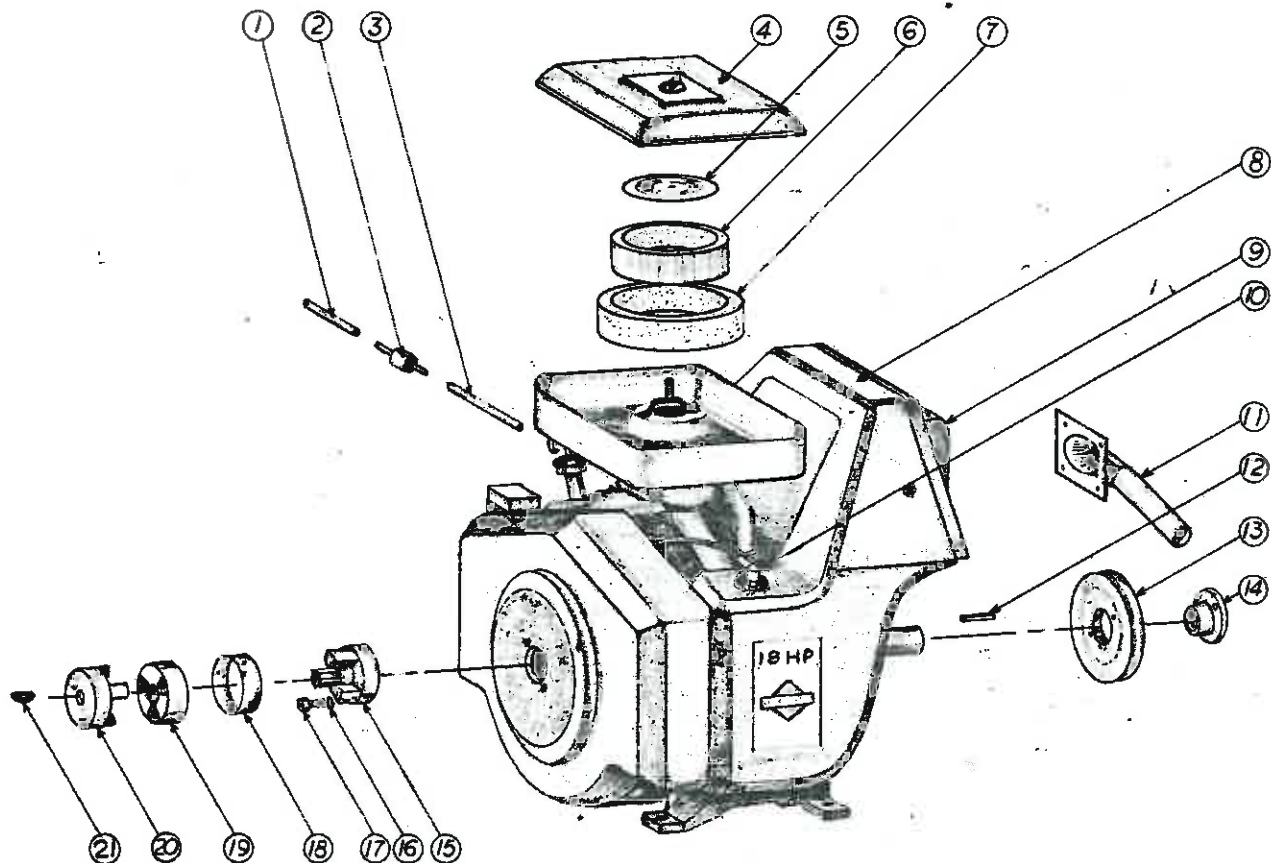

onan

Ref	PART NO.	DESCRIPTION	Quan.
1	11-02	Fuel Line	1
2	11-03	Fuel Filter	1
3	11-04	Fuel Line	1
4	Sup. by B&S	Cover	1
5	Sup. by B&S	Plate	1
6	13-01	Filter, Air (B&S)	1
	13-06	Filter, Air (Onan)	1
7	13-02	Precleaner (B&S)	1
	13-07	Precleaner (Onan)	1
8	13-03	Engine, Complete (B&S)	1
	13-08	Engine, Complete (Onan)	1
9	13-04	Muffler (B&S)	1
	13-09	Muffler (Onan)	1
10	13-05	Spark Plug, Champion	2
		R-J8 (B&S) or RJ-129	
13-10		Spark Plug, Champion	2
		RBN-13Y (Onan)	

Ref	PART NO.	DESCRIPTION	Quan.
11	14-01	Exhaust Extension (B&S)	1
	14-02	Exhaust Manifold (Onan)	1
12	85-K0410	Key	1
13	83-BK60H	Pulley	1
14	83-H16 <sup>on H22</sup>	Bushing	1
15	87-22	Coupler, Engine (B&S)	1
	87-23	Coupler, Engine (Onan)	1
16	99-G01	Lock Washer (B&S)	2
	99-G02	Lock Washer (Onan)	2
17	99-11	Cap Screw (B&S)	2
	99-12	Cap Screw (Onan)	2
18	87-26	Retainer	1
19	87-24	Insert, Coupler	1
20	87-25	Coupler, Pump	1
21	85-W0305	Key, Woodruff	1
91	13-11	Oil Filter (Onan only)	1

23-5-04  
Motor Mount Cushions  
may use RJ-129



# Hydraulic System - Primary Circuit

Figure 6

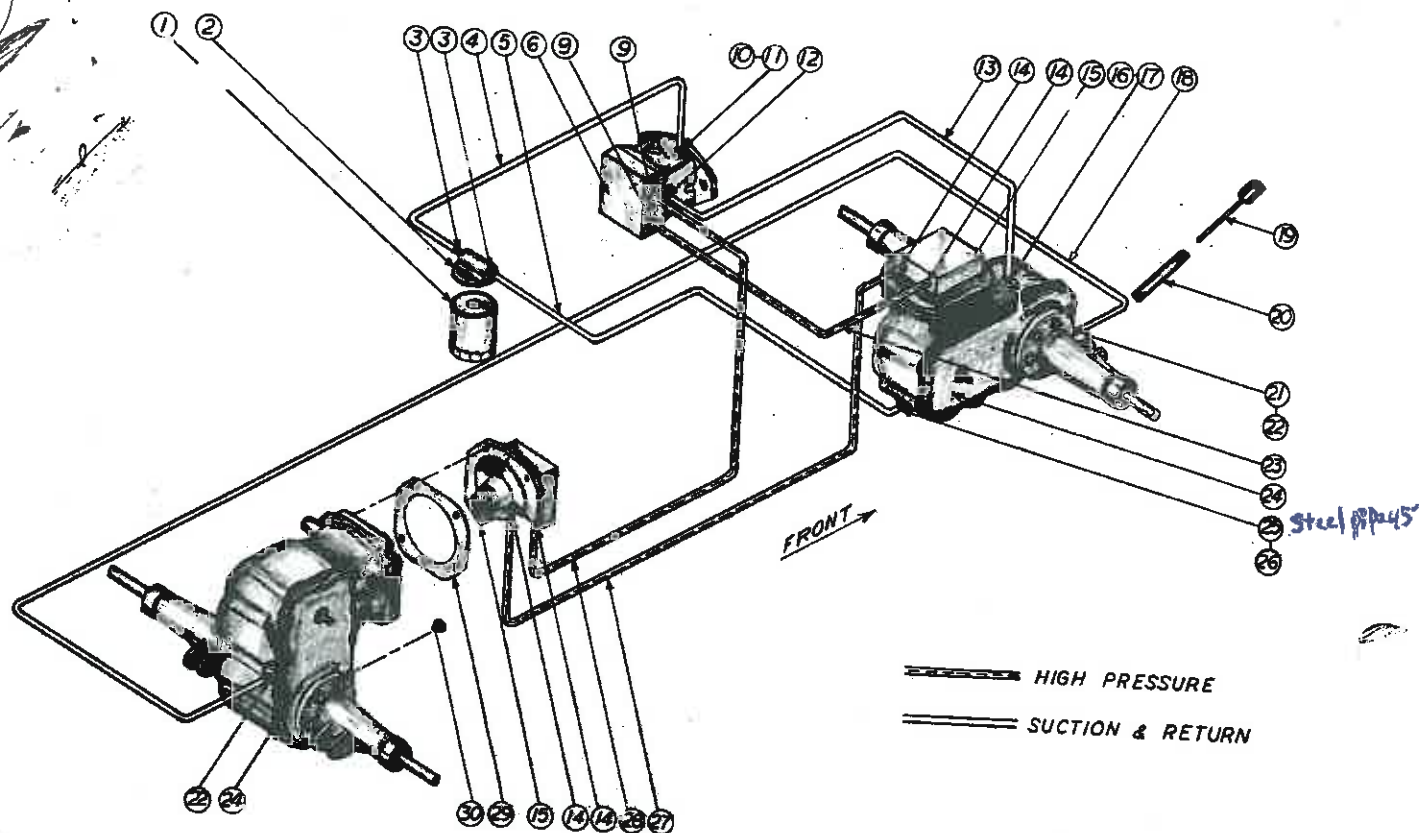

Ref	PART NO.	DESCRIPTION	Quan.
1	21-01 <i>obsolete</i>	Filter, Hydraulic Oil <i>21-093</i>	1
2	21-02	Filter Assembly <i>Base + Filter</i>	1
3	25-2103-12-10	Fitting	2
4	22-01	Hose 5/8 x 8	1
5	22-02	Hose 5/8 x 20	1
6	21-03	Hydraulic Pump	1
7	25-2503-8-8	Fitting 90° O Ring	1
8	25-2507-8-8	Fitting Swivel 90° O Ring	1
9	25-5603-8-10	Fitting 90° Long	1
10	25-2503-8-6	Fitting 90° O Ring	1
11	22-03	Hose 3/8 x 18	1
12	25-3503-8-8	Fitting 45° O Ring	4
13	21-04	Hydraulic Motor	2
14	25-0502-10-4	Adapter, O Ring	1
15	25-5603-4-6	Fitting 90° Long	3

Ref	PART NO.	DESCRIPTION	Quan.
16	22-04	Hose 3/8 x 58	1
17	24-01	Dipstick	1
18	29-11	3/8 x 6 nipple	1
19	25-212T-6-6	Fitting	1
20	25-2103-6-6	Fitting 90°	1
21	20-01	Hose 1/2 x 24	1
22	See Fig. 8	Transaxle	1
23	29-12	3/8 pipe 45° Street Elbow	1
24	25-3103-6-10	Fitting 45°	1
25	20-02	Hose 1/2 x 42	1
26	20-03	Hose 1/2	1
27	21-05	Gasket, Motor	1
28	25-05CP-10	Plug, O Ring	2
29	20-04	Armor Guard - 18" length for 1/2" Hoses	1

*oil*  
*Replace 29-12 by 13/8 close Nipple*

*req'd 3.00/p*

# Hydraulic System - Implement Circuit

Figure 7

23-25 10243 Steering Cylinder Repair Kit  
23-26 10118 Lift

cylinder  
cost 100.00  
Lift

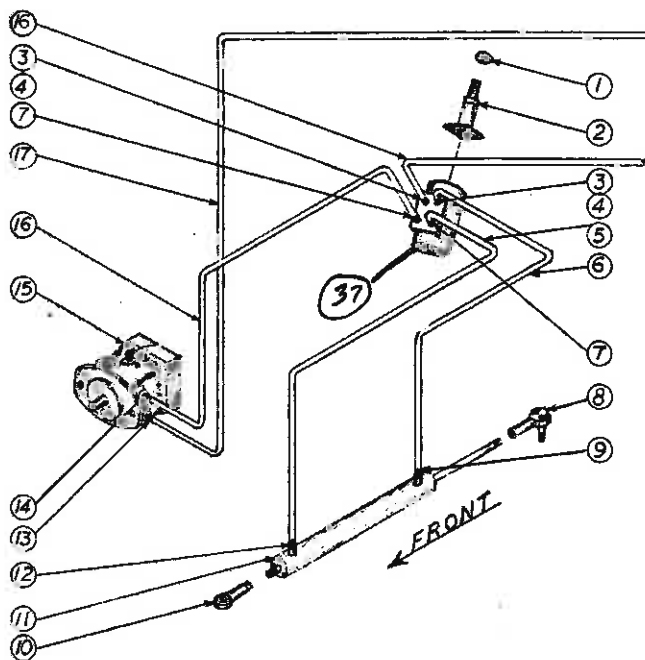

LEFT SIDE VIEW

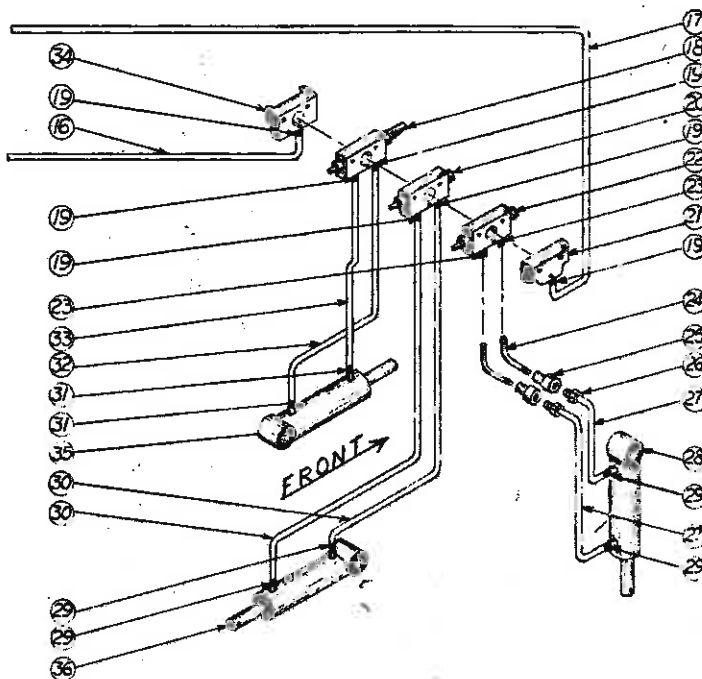

RIGHT SIDE VIEW

single spool - float  
2 spool valve - 1 float  
3 spool valve - 1 float  
Relief add

Ref	PART NO.	DESCRIPTION	Quan.
1	99-E02	Nut	1
2	23-01	Steering Post	1
3	25-0502-8-4	Adapter O Ring	2
4	25-5603-8-6	Fitting 90° Long	2
5	20-05	Hose 1/4 x 30	1
6	20-06	Hose 1/4 x 24	1
7	25-2503-8-6	Fitting 90° O Ring	2
8	43-105	Spherical Rod End	1
9	25-0103-4-6	Fitting	1
10	43-08	Spherical Rod End	1
11	23-02-24-009	Steering Cylinder	1
12	25-2103-4-6	Fitting 90°	1
13	25-2503-6-6	Fitting 90° O Ring	1
14	25-053T-6-6	Tee O Ring	1
15	25-06CP-6	Cap	1
16	21-03	Hydraulic Pump	1
17	20-07	Hose 1/4 x 20	2
18	20-08	Hose 1/4 x 26	1
19	23-06	Valve Body (std.) Single Spool, Float Position	1

Ref	PART NO.	DESCRIPTION	Quan.
19	25-0503-6-6	Fitting, O Ring, (as req'd)	16
20	23-07	Valve Body, (optional)	1
21	23-07	3 Point Hitch	1
22	23-07	Supplied with 23-06 Only	1
23	25-0502-6-4	Valve Body (Optional)	1
24	29-13	Implement Cylinder	2
25	23-03	Adapter, O Ring	2
26	23-04	Coupler, Female (Optional)	2
27	20-09	Implement Cylinder	2
28	23-05	Coupler, Male (Optional)	1
29	25-2103-6-6	Hose 1/4 x 48 (Optional)	4
30	20-10	Implement Cylinder (Optional)	2
31	25-3103-6-6	Fitting 90° (as req'd)	2
32	20-11	Fitting 45°	1
33	20-12	Hose 1/4 x 12-1/2	1
34	23-05	Hose 1/4 x 18	1
35	23-05	Supplied with 23-06 only	1
36	23-05	Cylinder, Front (std.)	1
		Cylinder, 3 pt. Hitch (Optional)	1

Not shown

Dust Caps

# Axles & Wheels

Figure 8

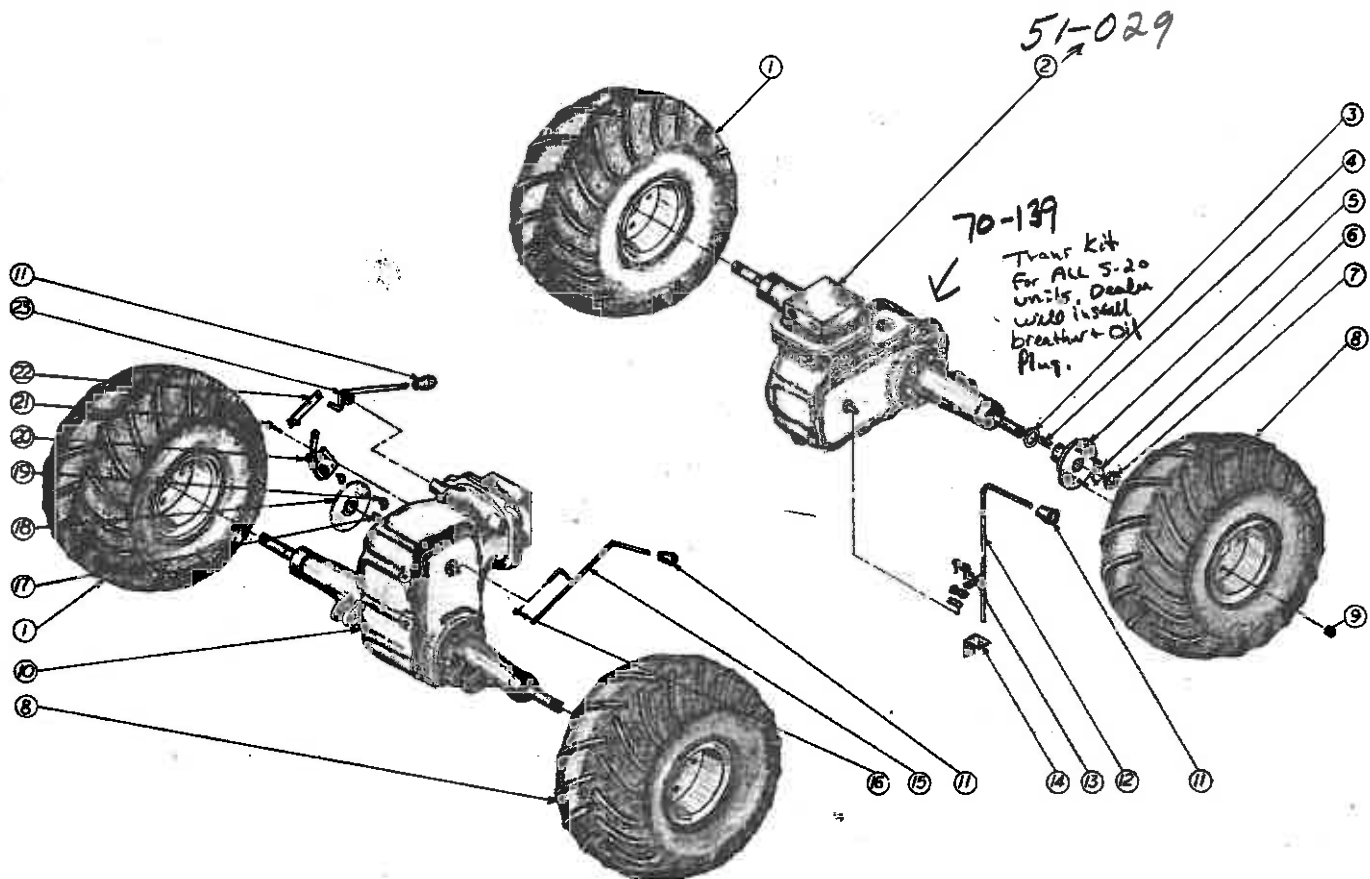

New Hub  
53-35

Ref	PART NO.	DESCRIPTION	Quan.
1	53-15	Wheel & Tire Assembly (left)	2
2	51-01	Transaxle, Front, less Motor	1
3	99-B11	Washer, Special	4
4	85-W0417	Key	4
5	53-17	Hub	4
6	53-18	Lock Tab	4
7	53-19	Nut	4
8	53-16	Wheel & Tire Assembly (right)	2
9	99-E01	Nut, Lug	6
10	51-02	Transaxle, Rear (less Motor)	1
11	47-01	Knob, small	3
12	40-30	Lever, Front Shift	1

Ref	PART NO.	DESCRIPTION	Quan.
13	81-24	Link 1740	1
14	40-31	Clip	1
15	40-32	Lever, Rear Shift	1
16	99-A04	Lock Nut	1
17	85-W0306	Key, Woodruff	1
18	53-20	Disc, Parking Brake	1
19	53-21	Puck Brake — set of	2
20	53-22	Brake Assembly	1
21	90-0612	Bolt	2
22	40-33	Link, Brake	1
23	40-34	Lever, Brake	1

53-44 pet list 45  
Tire only End Rim

53-24 First Brake Pad Large comes side D  
53-25 " " " Small comes side  
Assembled with 1/2" Dia. Pins 9/11/82

# Rear Parts

Figure 9

Seat Slides

Cost

List

Seat Bump

Seat cushions

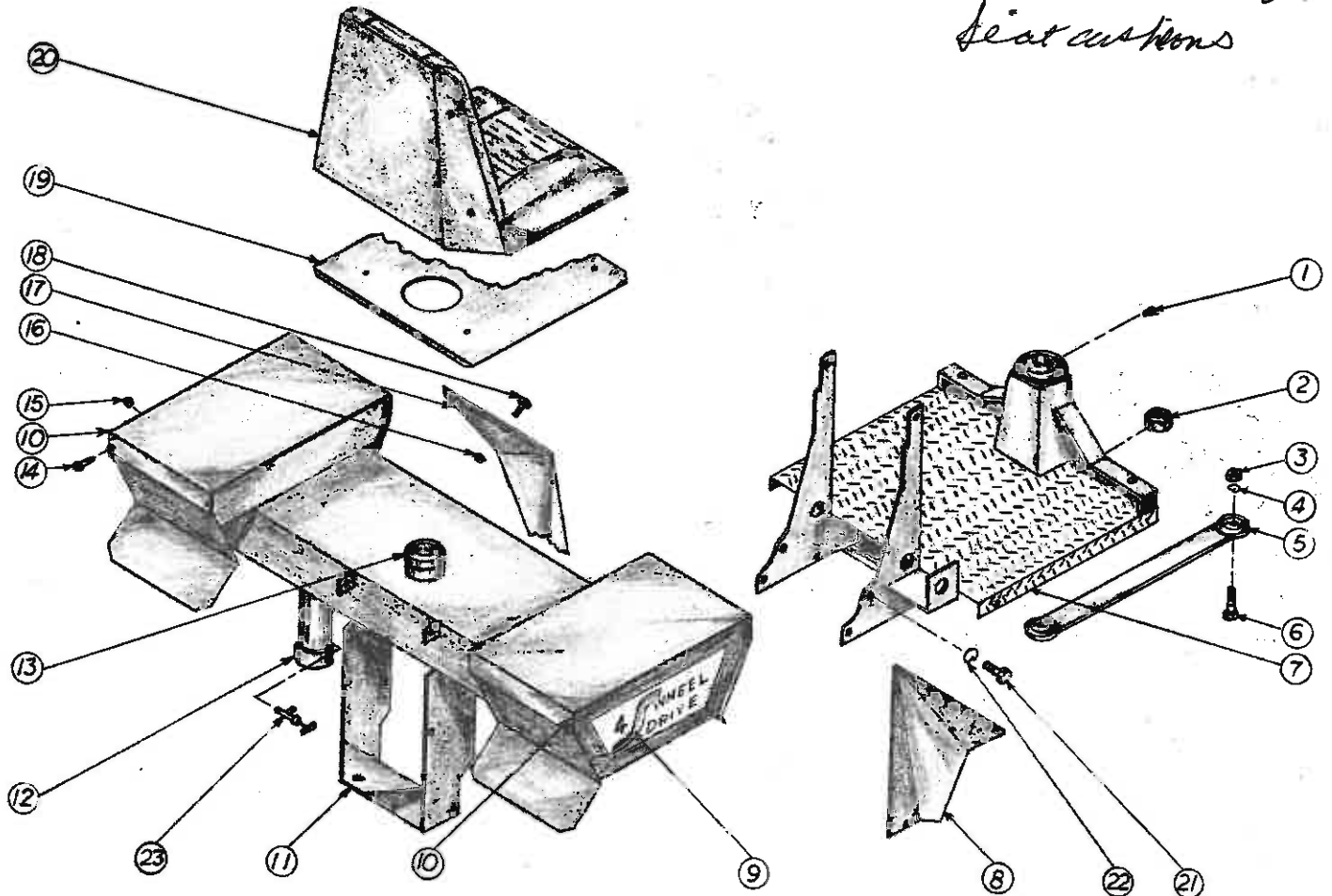

Seat Bumper

05-019

Ref	PART NO.	DESCRIPTION	Quan.
1	29-14	Grease Fitting	1
2	99-A16	Lock, Nut	1
3	93-10	Nut	as reqd
4	96-10	Lock Washer	as reqd
5	62-116	Center Link	1
6	91-1016	Bolt	2
7	62-117	Frame, rear	1
8	60-52	Lower, Fender, Right	1
9	00-05	Decal, 4 Wheel Drive	2
10	60-54	Fender Lid	2
11	62-118	Frame, Tank & Hitch	1
12	29-15	Cap 2" Pipe	1
13	47-07	Cap, Fuel Filler	1

Ref	PART NO.	DESCRIPTION	Quan.
14	90-0406	Bolt	as reqd
15	99-A04	Locknut	as reqd
16	92-04	Nut	as reqd
17	60-53	Lower Fender, Left	1
18	90-0404	Bolt	as reqd
19	62-119	Seat Plate	1
20	47-08	Seat Assembly	1
21	90-0814	Bolt	as reqd
22	96-08	Lockwasher	as reqd
23	29-16	Fuel Valve	1
24	64-07	Pin, Cylinder (optional)	1
25	02-CP0516	Cotter Pin	2

Gas tank Neck

Seat Parts Back & Bottom

# Fro. Parts

Figure 10

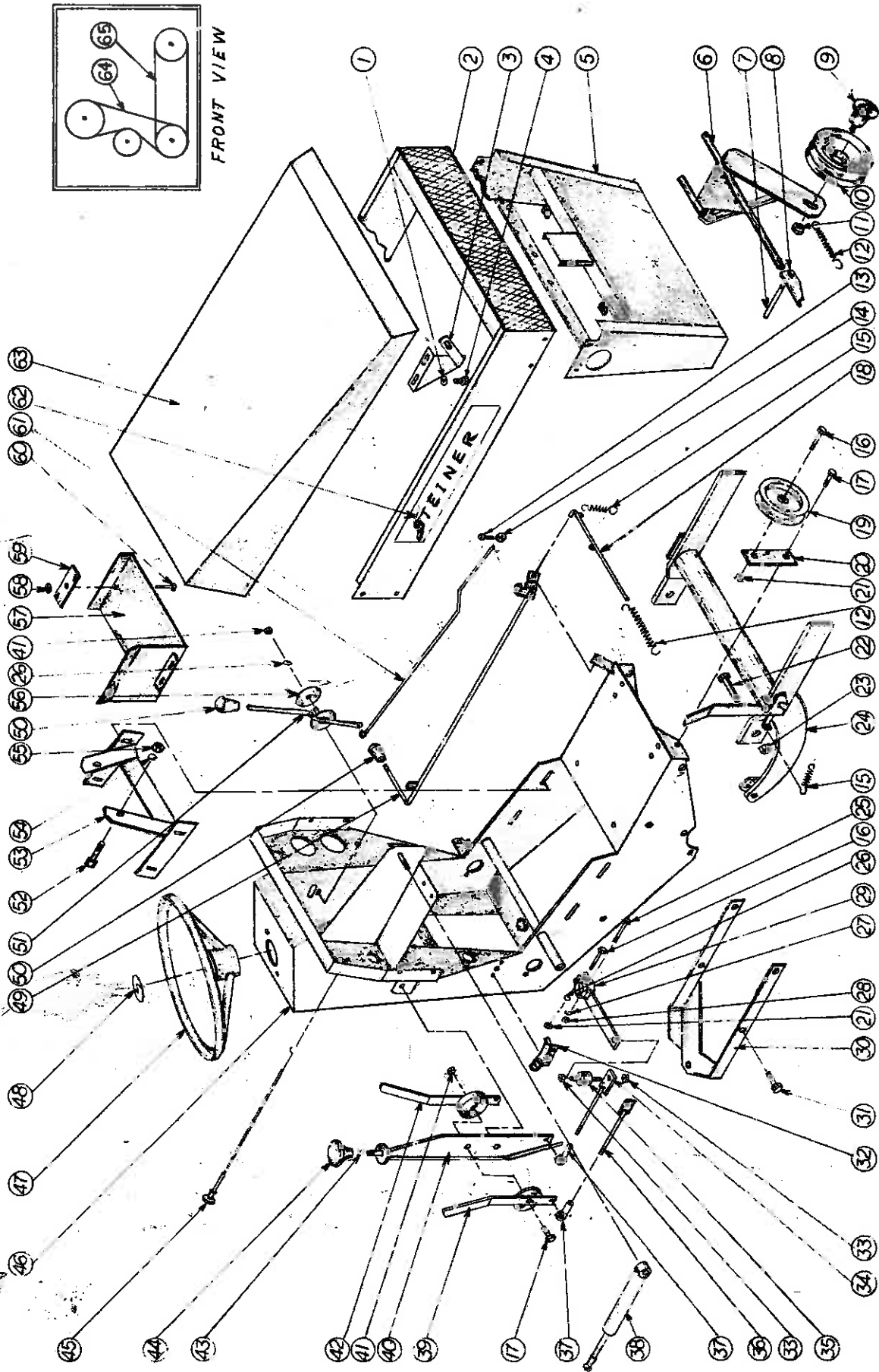



# 3-Point Hitch

Figure 11

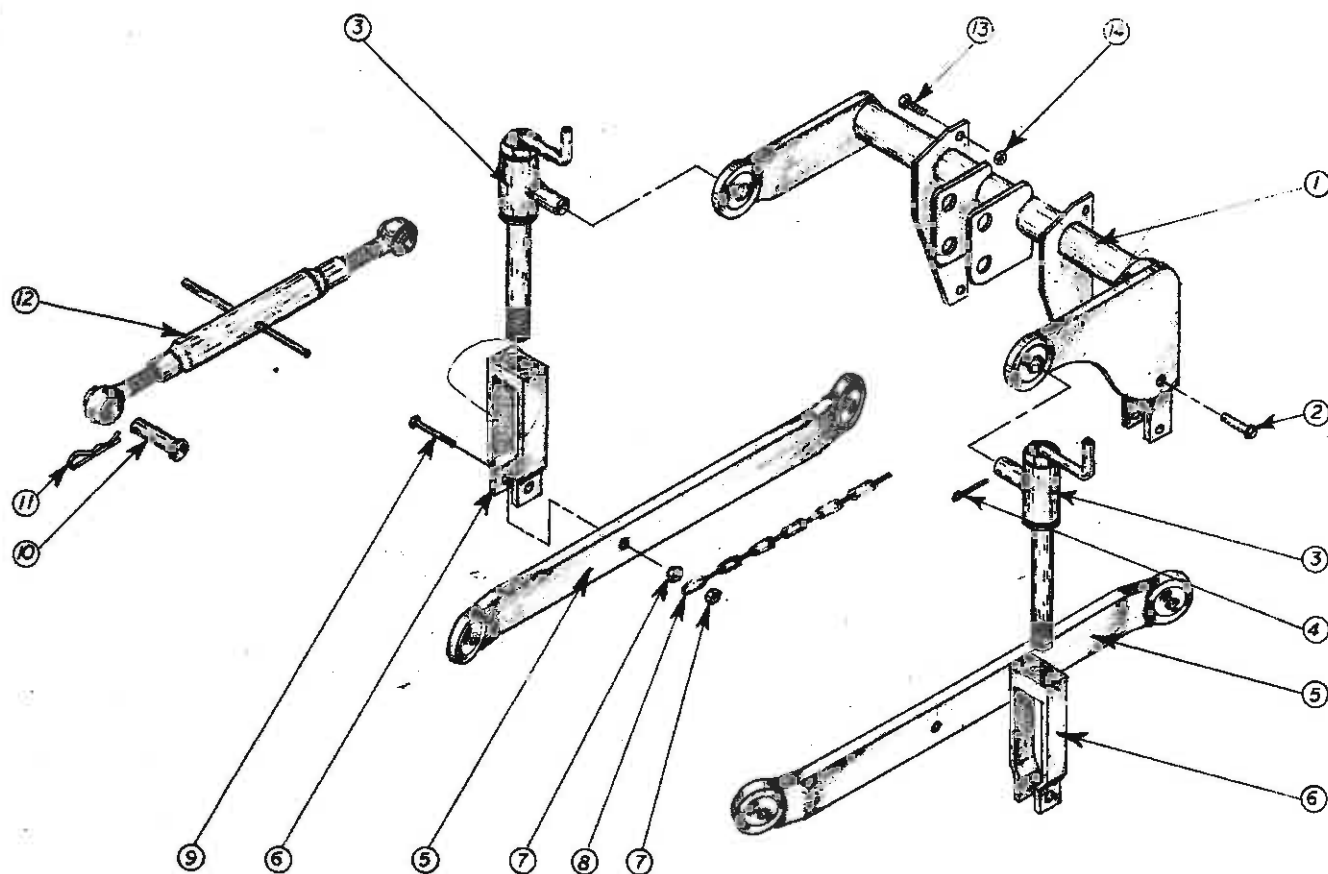

Ref	PART NO.	DESCRIPTION	Quan.
1	62-120	Rockshaft Assembly	1
2	03-0610	Clevis Pin	1
3	42-52	Lift Adjuster	2
4	02-CP0410	Cotter Pin	2
5	62-121	Draft Link	2
6	42-53	Lift Link	2
7	99-A06	Lock Nut	4
8	45-14	Chain, Sway	2

Ref	PART NO.	DESCRIPTION	Quan.
9	90-0618	Bolt	2
10	03-1020	Clevis Pin	2
11	02-PP03	Clip Pin	2
12	47-09	Top Link	1
13	90-0610	Bolt	as reqd.
14	92-06	Nut	as reqd.
15	03-14	Drawbar	

# Blade

## Figure 12

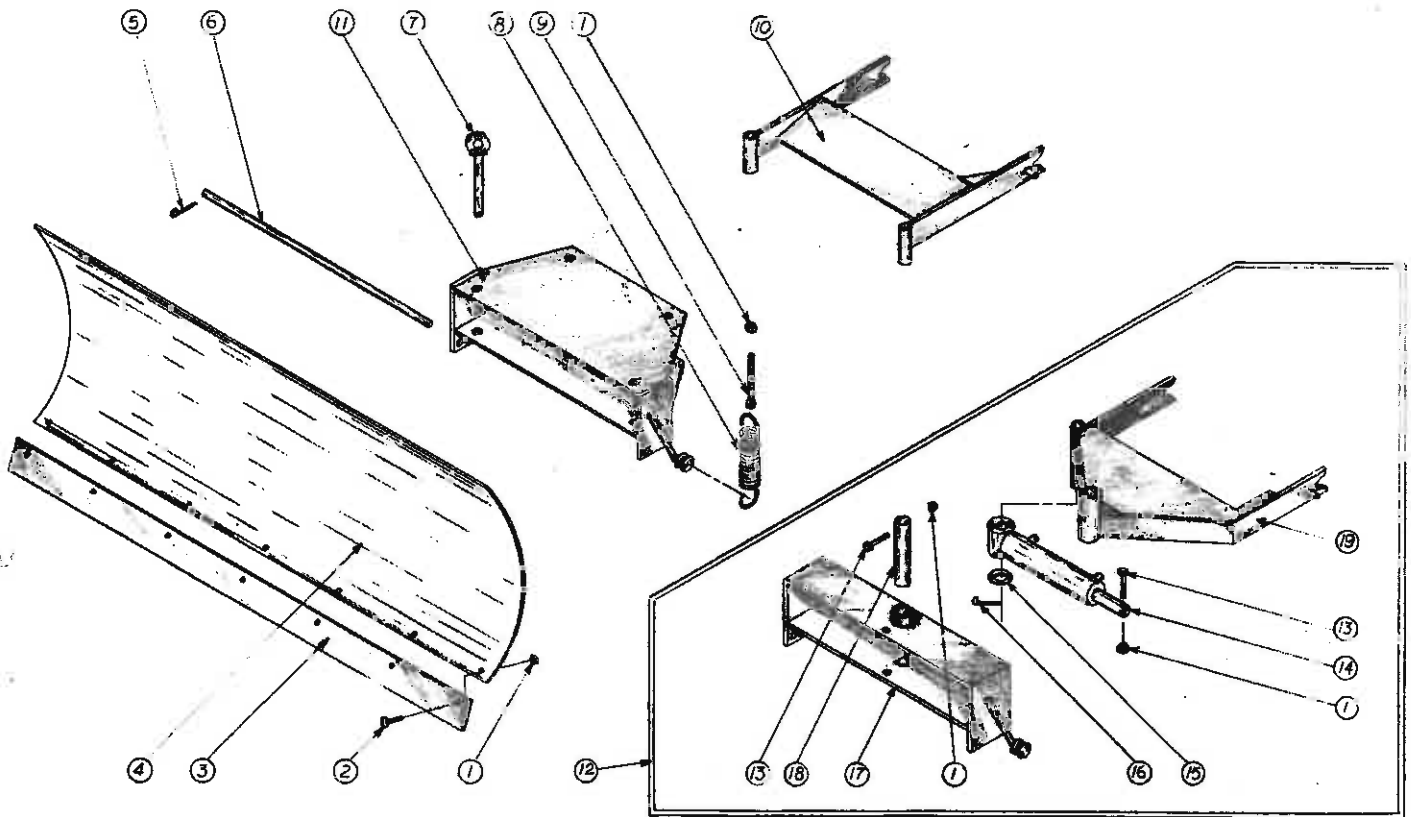

*skid shoes*

Ref	PART NO.	DESCRIPTION	Quan.
1	92-06	Nut	as reqd
2	97-0608	Bolt, Carriage	as reqd
3	78-04	Cutting Edge 48"	1
4	78-05	Cutting Edge 60"	1
5	62-122	Blade 48"	1
6	62-123	Blade 60"	1
7	02-CP0410	Cotter Pin	2
8	64-08	Rod	1
9	64-09	Pin	2
10	41-12	Spring	2
11	42-54	Adjuster, Spring	2
12	62-124	Frame, Attaching	1
13	62-125	Sub Frame	1

Ref	PART NO.	DESCRIPTION	Quan.
14	12	Hydraulic Angle Hitch	Optional
15	90-0620	Bolt	1
16	23-05	Cylinder, Implement	1
17	95-16	Washer, Flat	1
18	02-CP0516	Cotter Pin	1
19	62-126	Sub Frame	1
20	64-10	Pin, Pivot	1
21	62-127	Frame, Attaching (tractor)	1
22	62-128	Frame, Attaching (MPV)	1

See Fig. 7 for Hoses & Fittings

TRACTOR

2-1/2" Hoses

2-1/2" x 6"

22 2-1/2" x 80/125

2-1/2" x 80/125

MPV

2-1/4" x 26"

2-1/4" x 28"

2-1/4" x 80/125

2-1/4" x 80/125



# Mower Deck

Figure 13

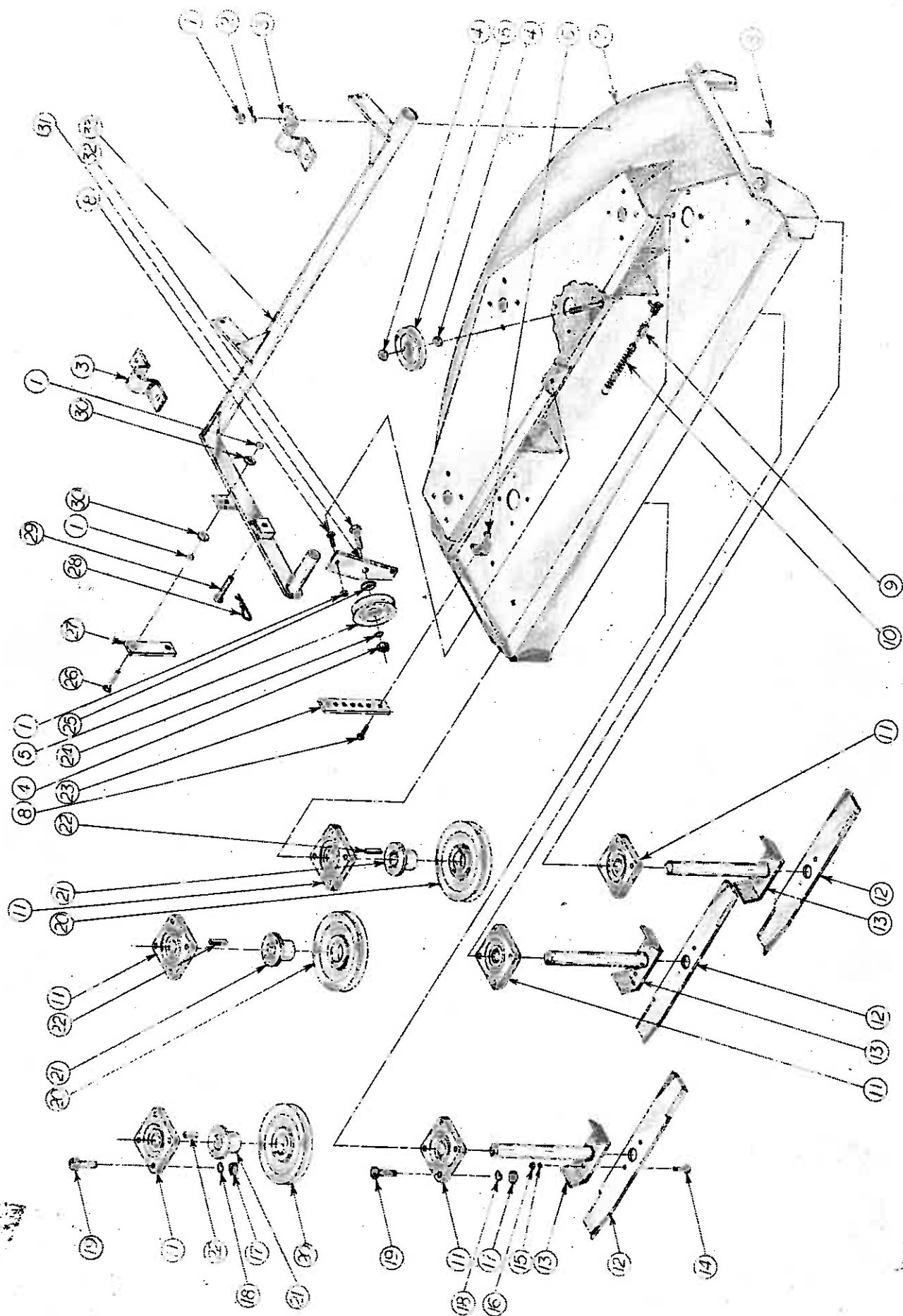

Ref	PART NO.	DESCRIPTION	Quan.
1	92-06	Nut	as reqd
2	96-06	Lockwasher	as reqd
3	64-11	Clamp (48")	2
4	64-13	Clamp (60")	2
5	92-08	Nut	as reqd
6	83-12	Idle Pulley	2
7	99-A06	Locknut	as reqd
8	62-133	Deck (48")	1
9	62-134	Deck (60")	1
10	90-0610	Bolt	as reqd
11	45-10	Chain	1
12	41-10	Spring	1
13	55-FB22016	Bearing	6
14	79-14	Blade (48")	3
15	79-15	Blade (60")	3
16	80-45	Spindle	3
17	99-F05	Bolt, special	6
18	96-05	Nut	6
19	92-05	Lock Washer	6
20	92-07	Nut	24
21	96-07	Lock Washer	24
22	90-0710	Bolt	24
23	83-BK50H	Pulley (48")	3
24	83-BK60H	Pulley (60")	3
25	83-H16	Bushing	3
26	85-K0410	Key	3
27	64-15	Strap, Adjusting	1
28	96-08	Lock Washer	as reqd
29	99-B12	Spacer	1
30	90-0612	Bolt	2
31	42-55	Link, Connecting	1
32	02-PP03	Clip Pin	1
33	02-0610	Clevis Pin	1
34	94-06	Washer, Flat	2
35	40-43	Idle Arm	1
36	90-0816	Bolt	1
37	40-44	Lever, Height Adj. (48")	1
38	40-45	Lever, Height Adj. (60")	1

55-SH20516 Inserts

U-Bolt Mower Blades

*[Signature]*

Pneumatic Tires

alcenter  
sheet 17.32

# Mower Frame

Figure 14

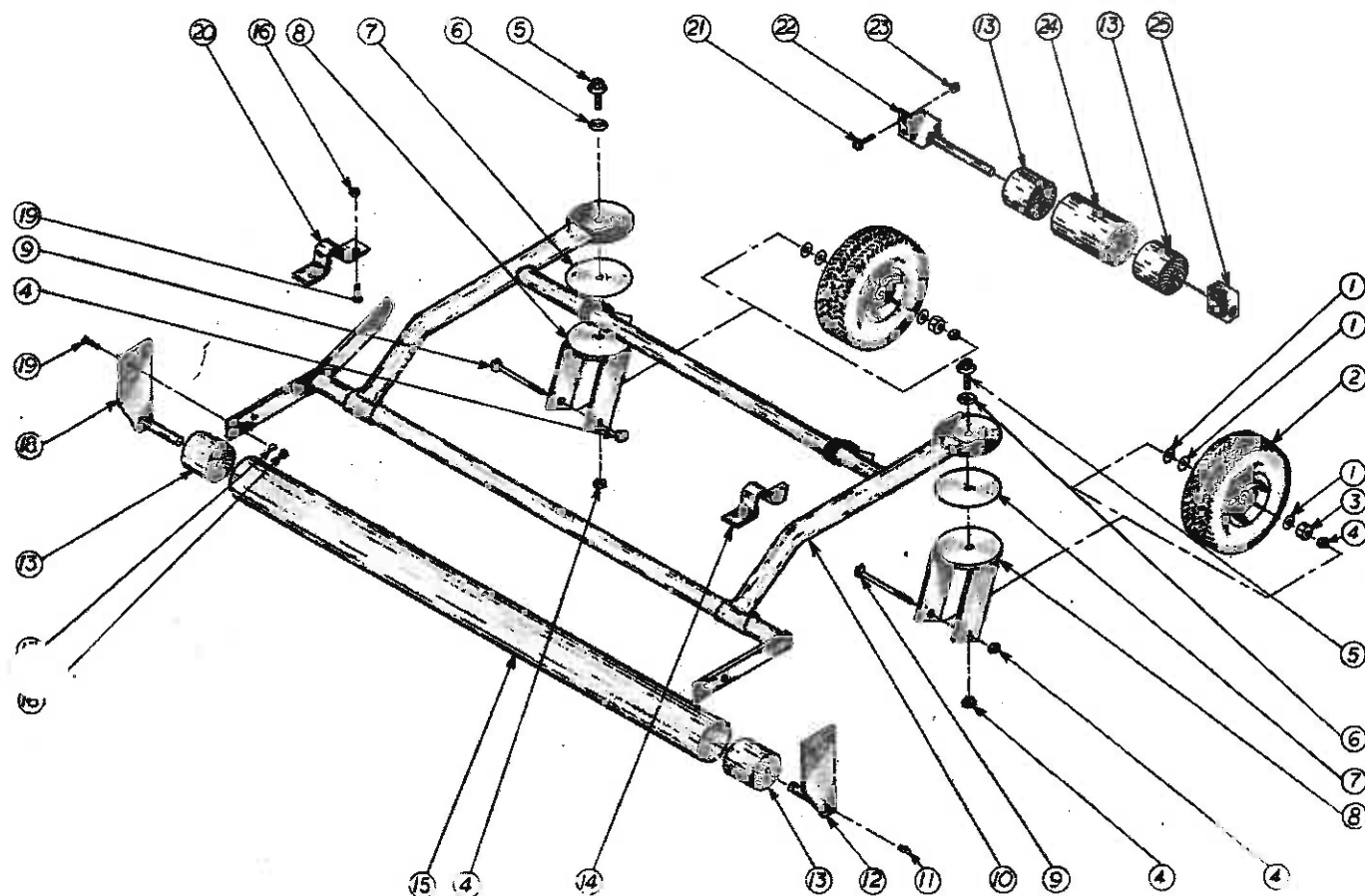

To convert to new style castors  
kit 70-028

Ref	PART NO.	DESCRIPTION	Quan.
1	94-08	Washer, Flat	as reqd
2	53-23	Wheel	2
3	92-10	Spacer	2
4	92-08	Nut	as reqd
5	99-F04	Bolt, Special	2
6	05-03	Washer, Special	2
7	05-04	Washer, Special	2
8	50-01	Caster	2
9	90-0836	Bolt	2
10	62-129	Frame (48")	1
	62-130	Frame (60")	1
11	29-10	Grease Fitting	2
	50-02	Roller Support (right)	1
	85-B11	Bearing, Wood	4
14	64-12	Clamp, right (48")	1
	64-14	Clamp, right (60")	1

Ref	PART NO.	DESCRIPTION	Quan.
15	50-04	Roller (48")	1
	50-05	Roller (60")	1
16	92-06	Nut	as reqd
17	96-06	Lock Washer	as reqd
18	50-03	Roller Support, left	1
19	90-0610	Bolt	as reqd
20	64-11	Clamp, left (48")	1
	64-13	Clamp, left (60")	1
21	90-0506	Bolt	4
22	50-06	Bracket, front roller (optional on 48")	1
23	92-05	Nut	4
24	50-07	Roller (optional on 48")	1
25	50-08	Bracket (optional on 48")	1

25

26  
27

05-07

05-08

Sub 75-04

# Mower Hitch

Figure 15

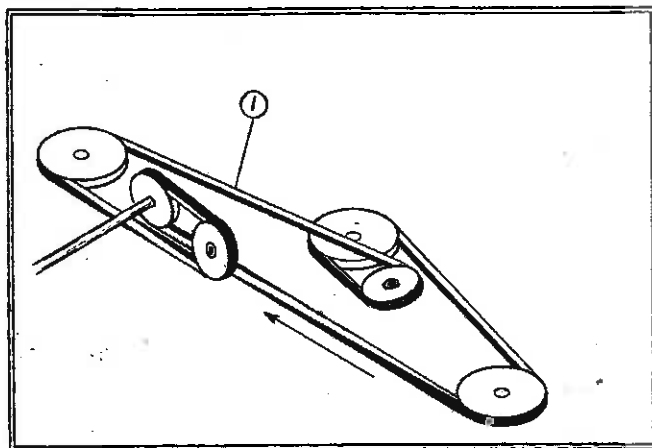
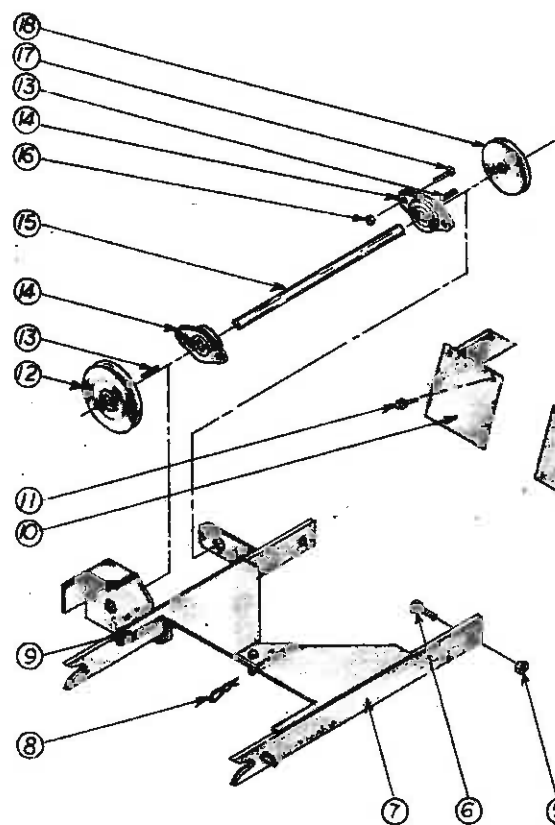

48" Right shield 48" Left shield  
 9" wide 3" wide  
 60" Right shield 60" Left shield  
 15" 5" wide plus

Ref	PART NO.	DESCRIPTION	Quan.
1	81-A128	Belt (48")	1
	81-A144	Belt (60")	1
2	60-55	Discharge Chute (48")	1
	60-56	Discharge Chute (60")	1
3	60-60	Shield, right (48")	1
	60-58	Shield, right (60")	1
4	60-59	Shield, Center	1
5	99-A08	Lock Nut	2
6	90-0812	Bolt	2
7	62-13	Hitch Arm, right	1
8	02-PP03	Clip Pin	1

Ref	PART NO.	DESCRIPTION	Quan.
9	62-13	Hitch Arm, left	1
10	60-61	Shield, left (48")	1
	60-57	Shield, left (60")	1
11	99-C0406	Bolt, Self Tapping	6
12	83-BK5012	Pulley	1
13	85-K0310	Key	2
14	55-FB23012	Bearing	2
15	80-44	Shaft	1
16	92-06	Nut	4
17	90-0610	Bolt	4
18	83-BK4012	Pulley	1