

INTRODUCTION: This instruction sheet covers the installation of the 48" and 52" PTO idler kit (970366) for the 48" and 52" cutterdeck.

TOOLS REQUIRED:

- Drill
- 13/32" Drill Bit
- Center Punch
- Tape Measure or Ruler
- Blocks (for deck support)
- Ratchet w/ extension
- 9/16" Socket
- 9/16" Wrench
- Die Grinder
- Angle Grinder
- Red Loctite

Note: All references to "right" or "left" are with respect to an operator at the controls.

NOTE: Park the machine on a smooth, level surface. Raise the cutterdeck to the transport position and remove the height of cut pin. Lower the cutterdeck onto a set of equal height blocks. Remove cutterdeck from the machine.

ASSEMBLY INSTRUCTIONS:

1. Use the die grinder to remove welded on PTO idler pin and clean up all material down to cutterdeck top.
2. Locate new pin weldment as shown in **Figure 1**, mark and drill three 13/32" holes as indicated.
3. Install new idler pin weldment **(7)** using 3/8-16 nuts **(8)** and bolts **(6)**.
4. Slide inner rings **(5)** onto idler pin **(7)**. Inner rings may be a press fit onto pin
Place a drop of red Loctite in threaded hole in pin **(7)**.
5. Place spacer **(4)** on top of inner rings **(5)**.
6. Install idler arm weldment **(3)** onto pin **(7)**.
7. Place a drop of red loctite onto bolt **(2)** and fasten down idler arm weldment **(3)** to idler pin **(7)**
Torque Bolt **(2)** to 60 ft-lbs.
8. Install cap **(1)** then grease the assembly.
9. Remove pulleys from current idler arm weldment and install them on new idler arm weldment.
10. Reinstall cutterdeck on machine.

FIGURE 1

48" CUTTERDECK

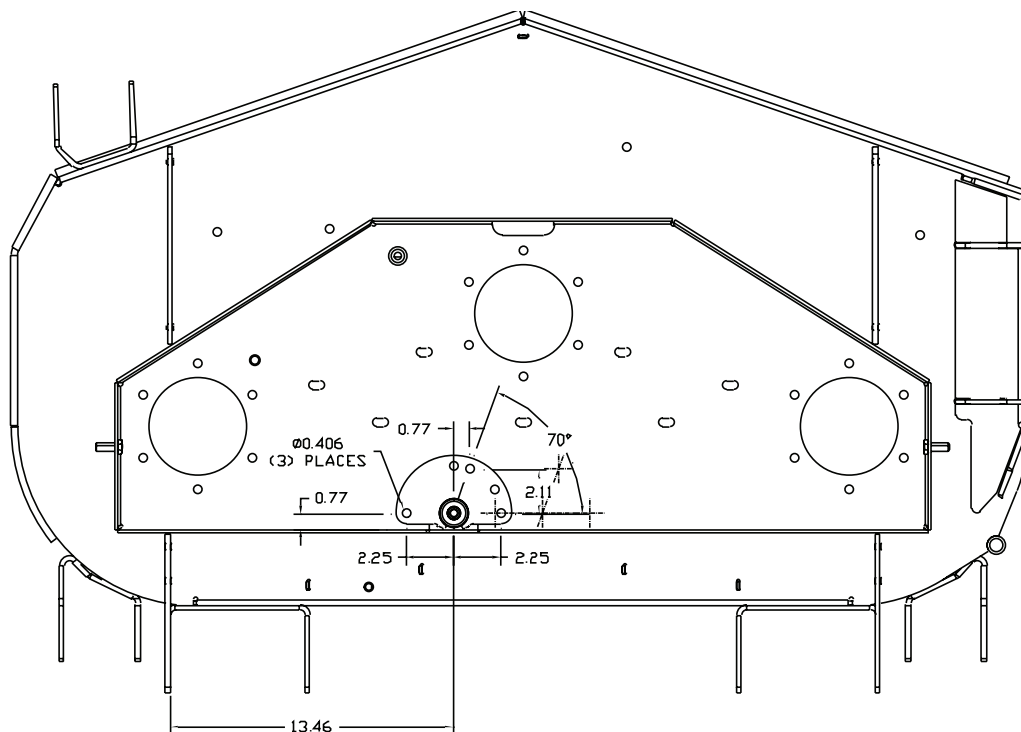

52" CUTTERDECK

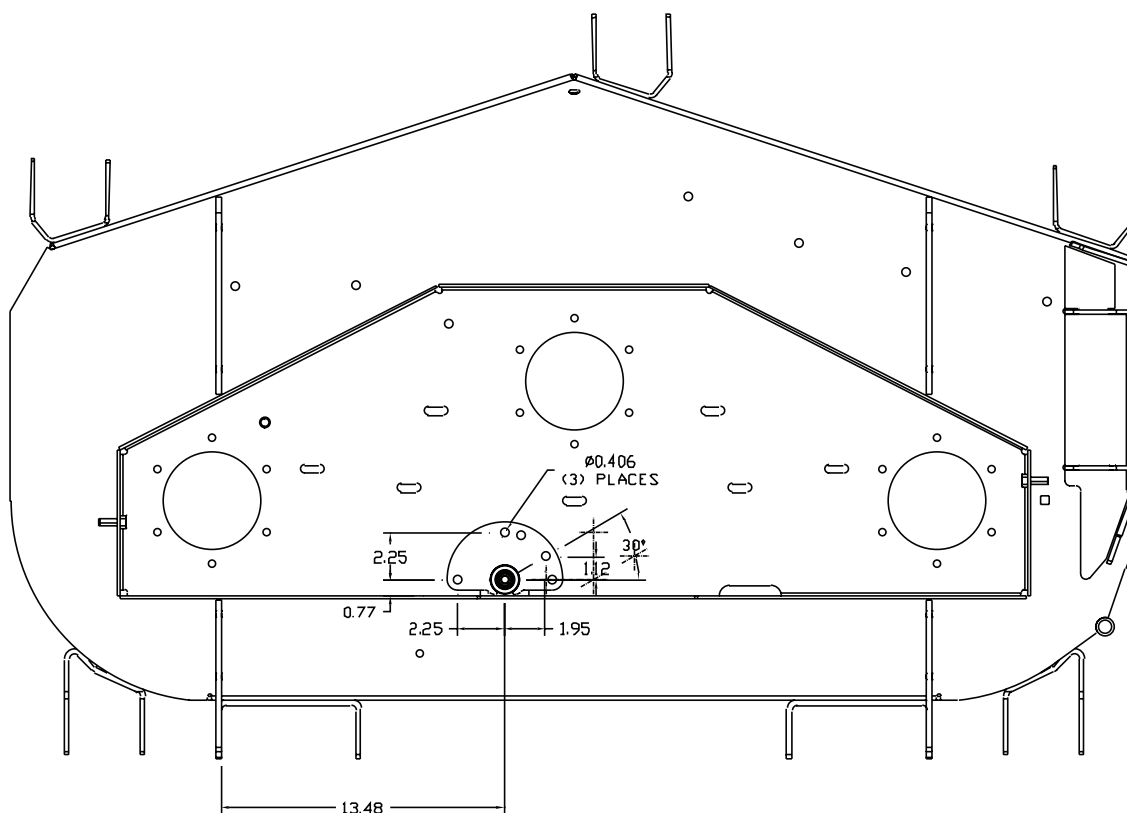

SERVICE PARTS LIST

ITEM	PART NO.	DESCRIPTION	QTY
1	4128002	CAP-END, 26 X 7	1
2	64270-02	BOLT-M10-1.5 X 30 ISO CL 10.9	1
3	4163028	WLDMNT-IDLER ARM	1
4	4163014	SPACER	1
5	4163155	INNER RING	2
6	64123-16	BOLT-3/8-16X1	3
7	4163251.7	WLDMNT-IDLER PIN	1
8	64229-03	NUT-3/8-16 NYLON LOCK	3

