

**INTRODUCTION:** This instruction sheet covers the replacement of a fuel shut off valve for Midsized fuel tanks.

**INSTALLATION INSTRUCTIONS:**

1. Drain fuel from fuel tank and disconnect fuel hose from tank. Retain clamps for later use.
2. Remove tank from frame and remove drain valve (A) and grommet (B). Observe orientation of drain valve in tank (See Figure 1).
3. Install hose (1) onto fitting (2) using one clamp (4). This will aid in guiding the fitting through the hole on the bottom of the tank.
4. Install fitting (2) into tank and orient fitting similar to the drain valve removed in step 2. Torque fitting nut to 8-12 ft/lbs. (See Figure 2)
5. Install in-line fuel valve (3) onto the other end of hose (1) using clamp (4).
6. Remove 8" of the current fuel hose to establish the length of fuel line needed. Install this end onto the other side of the in-line fuel valve (3). Use clamps removed in step 1 to secure.
7. Reinstall tank onto unit.
8. Route fuel lines appropriately so that the hose layout matches that of the original routing of the machine.

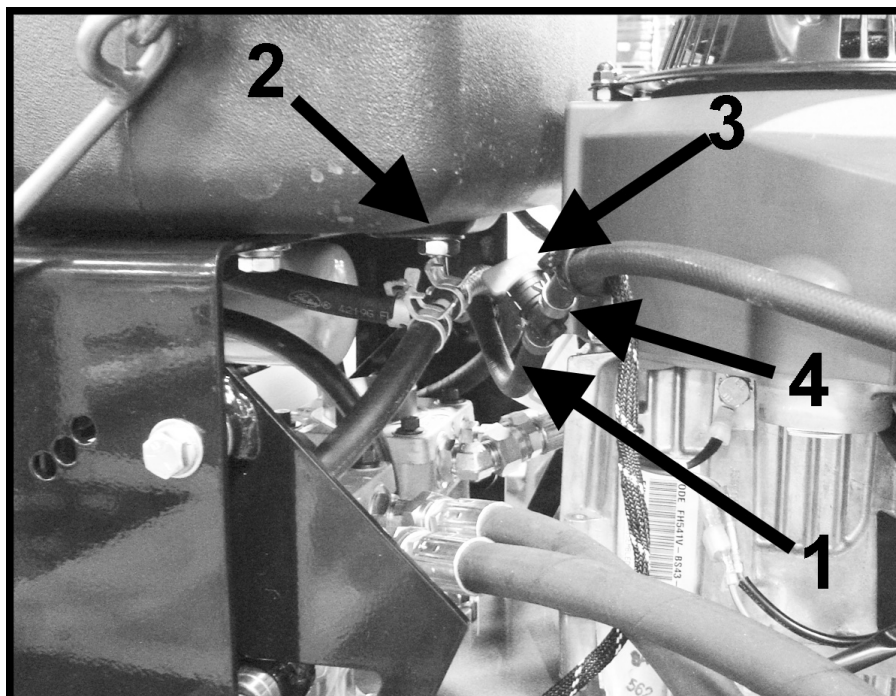

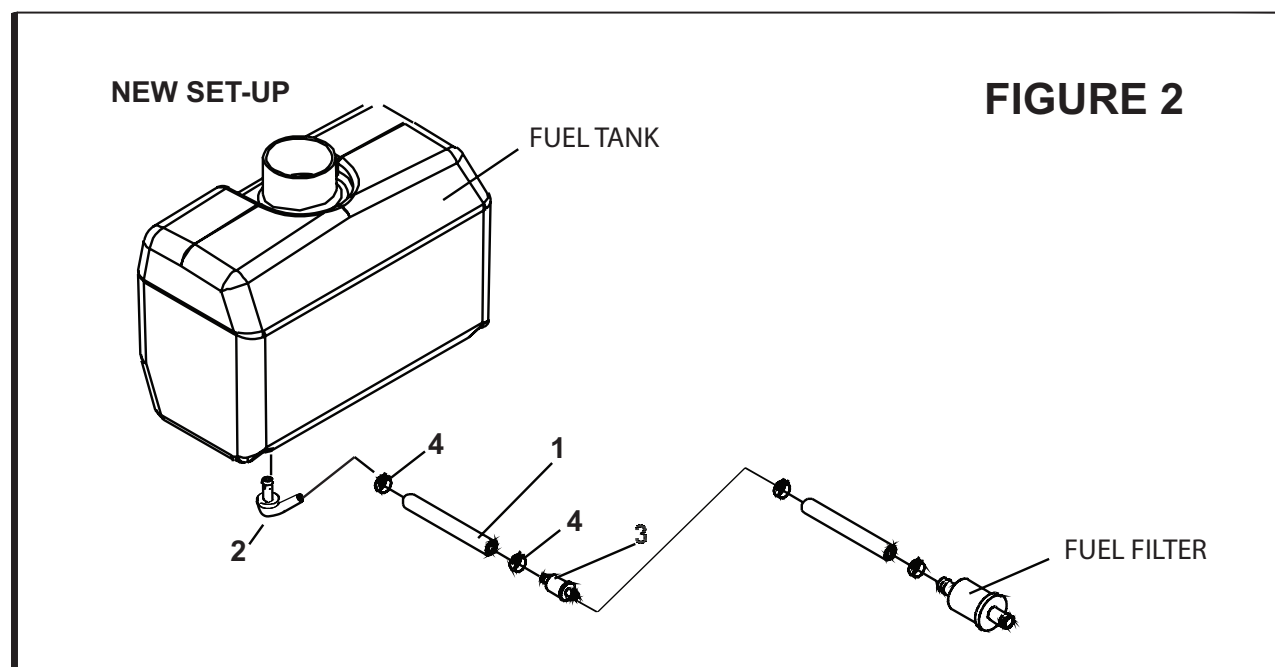
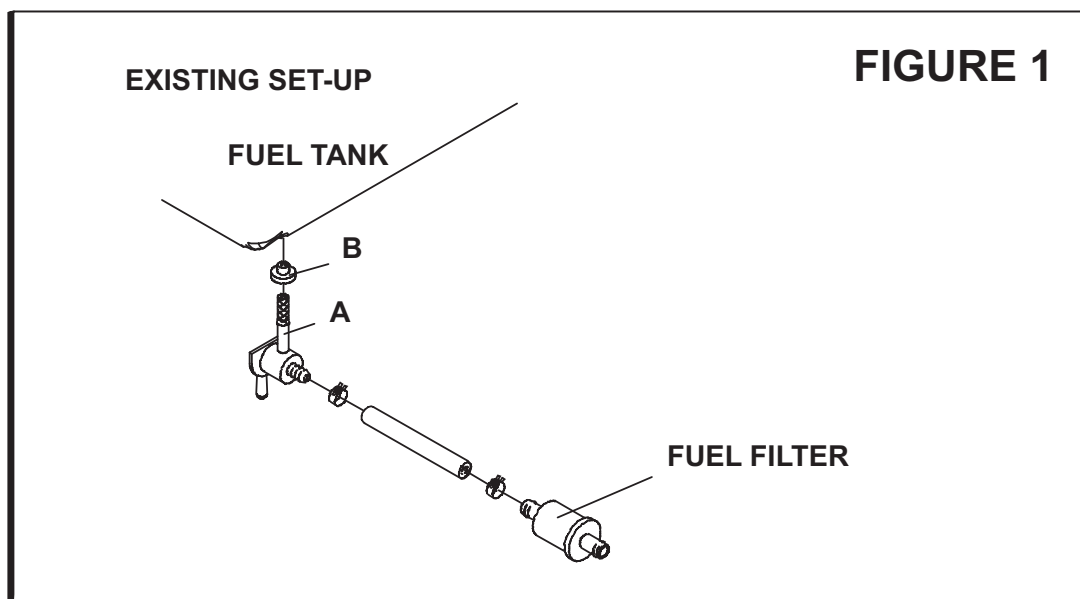

PART NUMBER	DESCRIPTION	QTY
1. 4162977-007	HOSE,25ID X .50ODX 8"	1
2. 4163012	FITTING-90 DEGREE SEAL	1
3. 4163016	FUEL VALVE, IN-LINE	1
4. 88042N	CLAMP, HOSE	2