

INTRODUCTION: This instruction sheet covers the installation of the Guards for EU Jr. Sodcutters Kit.

1. Remove the two lower engine platform support bolts and slide the U-bolt bracket **3** over the engine support platform. Secure with (2) 3/8-16x1 3/4 bolts **7** from the kit and the original lockwashers, washers and nuts. **(Figure 1)**
2. Tip the unit forward to avoid losing oil and remove the two screws in the lower gear case. Install the rear bracket **2** with the screws. Apply gasket compound or pipe thread compound to the threads to prevent oil leakage, **(Figure 2)**

NOTE: It is not recommended that this kit be installed to units without the two screws in the lower gearcase. For units without the two screws in the lower gearcase, holes will need to be drilled and tapped into the gearcase. It will be necessary to clean the resulting metal shavings from the gearcase

3. Lower the rear and place the front guard **4** around the machine. Install loosely to the rear bracket **2** with two 3/8-16x3/4 bolts **11** and two 3/8-16 nuts **6**. Raise the front and attach to the U-bolt bracket **3** with two U-bolts **9** and four 1/4-20 flange nuts **10**. Tighten the fasteners. **(Figure 3)**

- 4.. Complete the installation by attaching the top shield **5** with three 1/4-20x3/8 self tapping screws **8**.

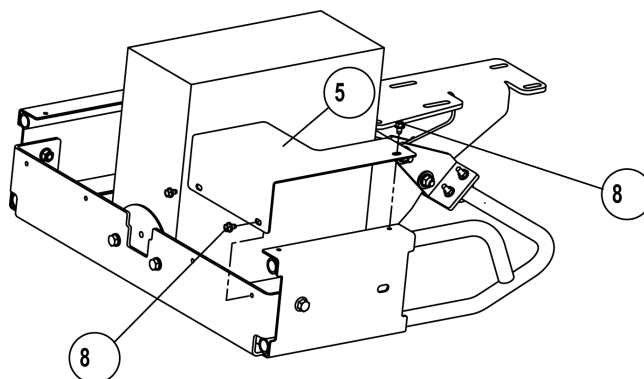
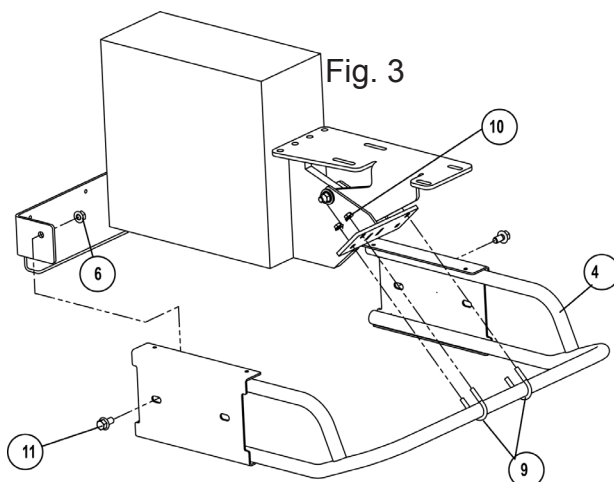
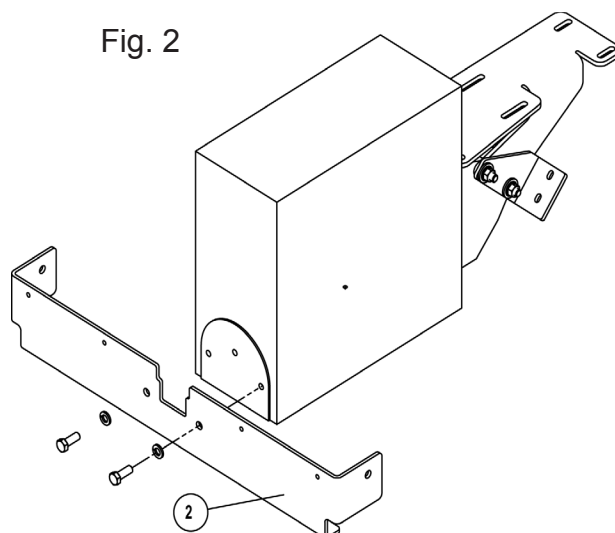
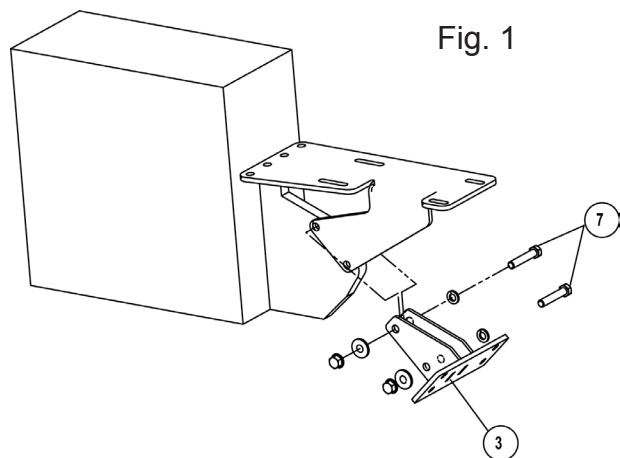

Fig. 4

I.S.-KIT (970385)EU GUARD ASSEMBLY FOR JR SODCUTTER

4163974 REV A

ITEM NO.	PART NUMBER	DESCRIPTION	QTY.
1	4163695	LABEL-CHF HOR EU	1
2	4163849	BRKT-REAR	1
3	4163852	WLDMT-UBOLT BRKT	1
4	4163856	WLDMT-FRONT GUARD	1
5	4163848	SHIELD-TOP	1
6	64268-03	NUT-FL NYLON LOCK 3/8-16	2
7	64123-67	BLT-HEX 3/8-16 X 2	2
8	64152-23	1/4-20X3/8 LG SP SCREW	3
9	64225-03	U-BOLT 1/4-20 X 1 X 2-3/4	2
10	64268-01	NUT-FL NYLON LOCK 1/4-20	4
11	64262-010	BLT-FLG HD 3/8-16 X 3/4	2

