

I.S.-970394 SEAT SUSPENSION KIT

4164680 REV A

**INTRODUCTION:** This instruction sheet covers the installation of the seat suspension.

1. Remove seat assembly from seat plate.
2. Remove the sliders from the bottom of the seat and retain the mounting hardware for later use.
3. Attach the suspension, using appropriate mounting holes, to the seat assembly. Use the hardware retained in step 2. Tighten hardware.
4. Attach the sliders to the seat suspension using spacers 3, bolts 2 and nuts 1 as shown in **Figure 2**.
5. Attach new slider/seat assembly to the seat plate using the studs of the sliders and the nuts 1 as shown in **Figure 2**. Tighten hardware.

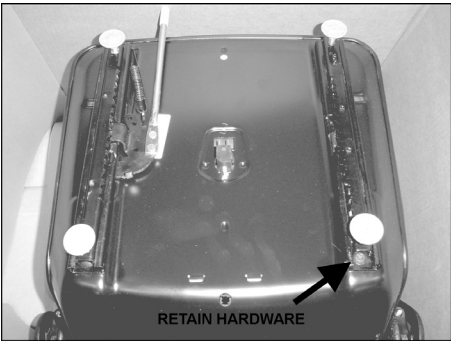
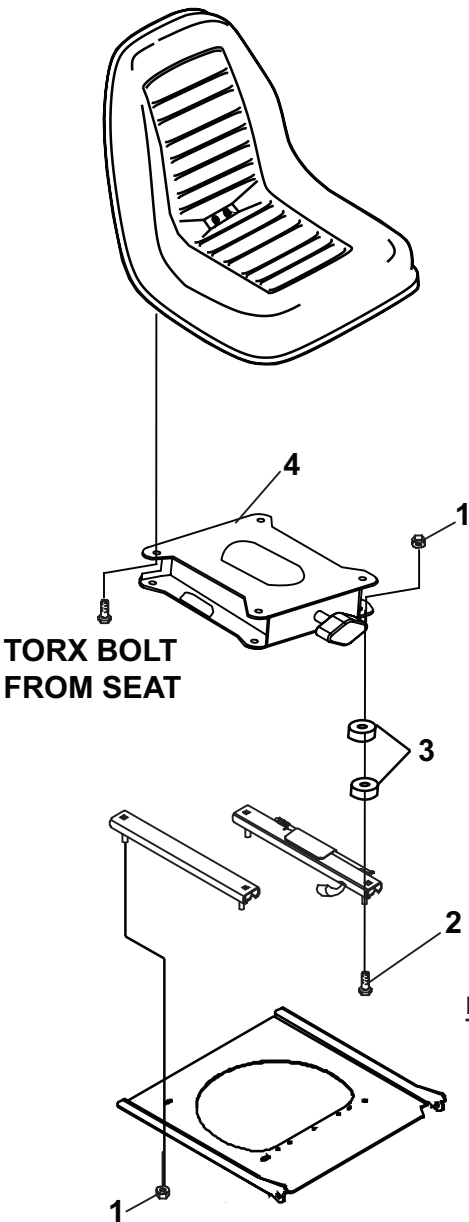

FIGURE 1

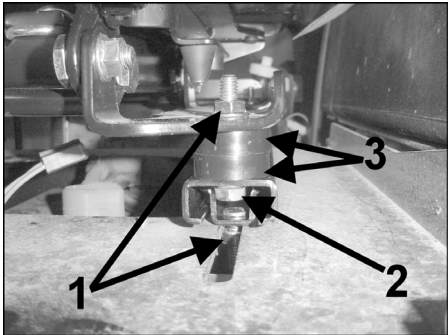
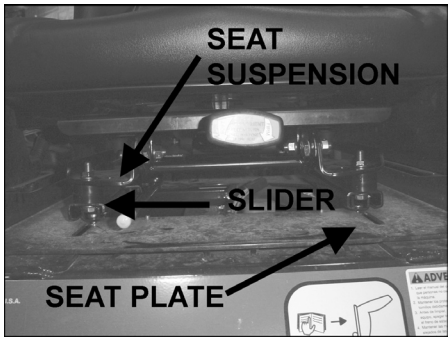

FIGURE 2



SERVICE PARTS LIST

ITEM	PART NO.	DESCRIPTION	QTY
1	64141-6	NUT-WLF 5/16-18	8
2	64262-019	BLT-FLG HD 5/16-18X1-3/4	4
3	2720975-07	SPACER-NYLON 3/8IN	8
4	4164679	SEAT-SUSPENSION	1
5	4164680	I.S. SEAT SUSPENSION KIT	1