

INTRODUCTION: This instruction sheet covers the installation of the Anti-scalp Roller Rear Kit (970397) for the 42" Cutterdeck(s).

TOOLS REQUIRED

- Drill.
- Bit to drill 13/32" hole.
- Center punch.
- Scribe.
- Combination square.
- Tape measure or ruler.
- Blocks (for deck support).
- Ratchet and 9/16" socket or 9/16" wrench.
- 9/16" wrench.

NOTE: All references below to the "right" or "left" are with respect to an operator at the controls.

1) Turn unit off and remove ignition key.

2) Using the deck lift lever, lower the deck onto the blocks to stabilize the deck.

⚠ WARNING

Mower blades may be sharp. Wear gloves when working near blades.

3) For the middle anti-scalp bracket, mark and drill (2) 13/32" diameter holes **A** on the cutterdeck as shown in **Figure 1**.

4) Install the middle roller bracket **4** using bolt **5** and nuts **8**, as shown in **Figure 2**.

5) Install the middle roller **3** using one bolt **6**, one spacer **1**, and one nut **9** as show in **Figure 2** to the desired height.

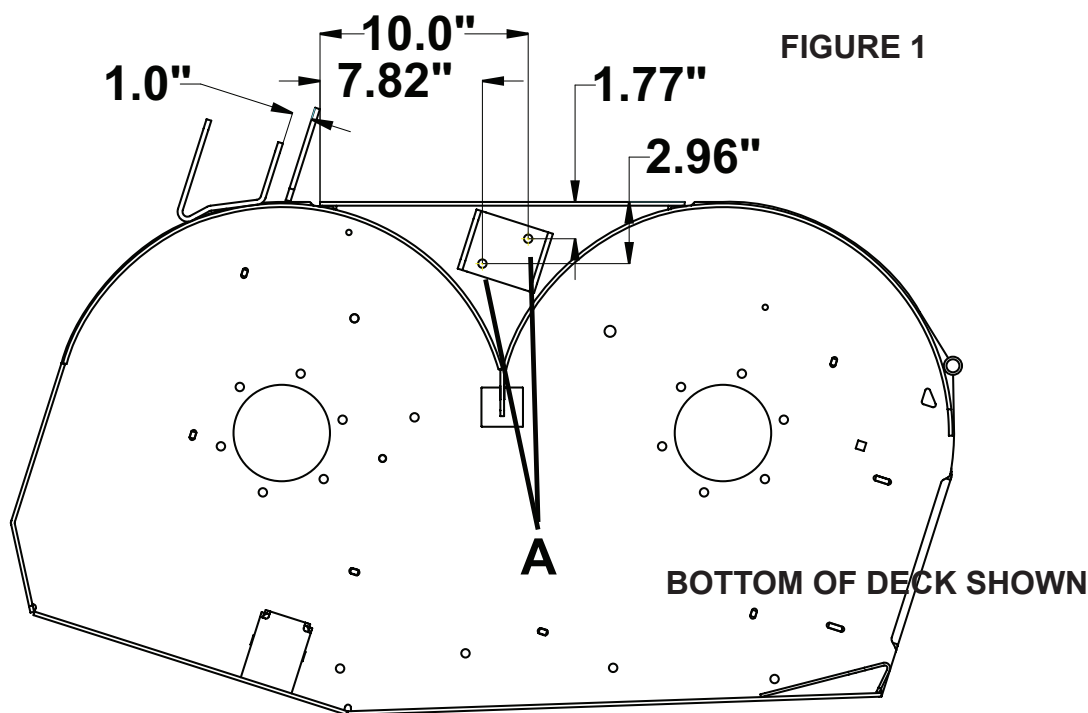

- 8) Place the LH anti-scalp bracket 1.0" away from the deck lift bracket and adjacent to the deck top. Mark and drill (2) 13/32" diameter holes through the outer deck wall as shown in **Figure 3**.
- 9) Mount the LH bracket **2**, using bolts **7** and nuts **9**.
- 10) Install the middle roller using one bolt **6**, one spacer **1**, and one nut **9** as show in **Figure 2** to the desired height.

KIT PARTS LIST

| ITEM | PART NO. | DESCRIPTION | QTY |
|------|-----------|-----------------------|-----|
| 1 | 2720685 | SPACER | 2 |
| 2 | 2721315.7 | BRKT-ROLLER LH | 1 |
| 3 | 2721512 | ROLLER-5X2.75 CNTRD | 2 |
| 4 | 4164360.7 | BRKT-ROLLER MIDDLE | 1 |
| 5 | 64123-15 | BOLT-HEX 3/8-16X3/4 | 2 |
| 6 | 64123-217 | BOLT-HEX 3/8-16X4-1/4 | 2 |
| 7 | 64123-50 | BOLT-HEX 3/8-16X1 | 2 |
| 8 | 64141-4 | NUT-WLF 3/8-16 | 2 |
| 9 | 64229-03 | LOCKNUT-NYLON 3/8-16 | 4 |

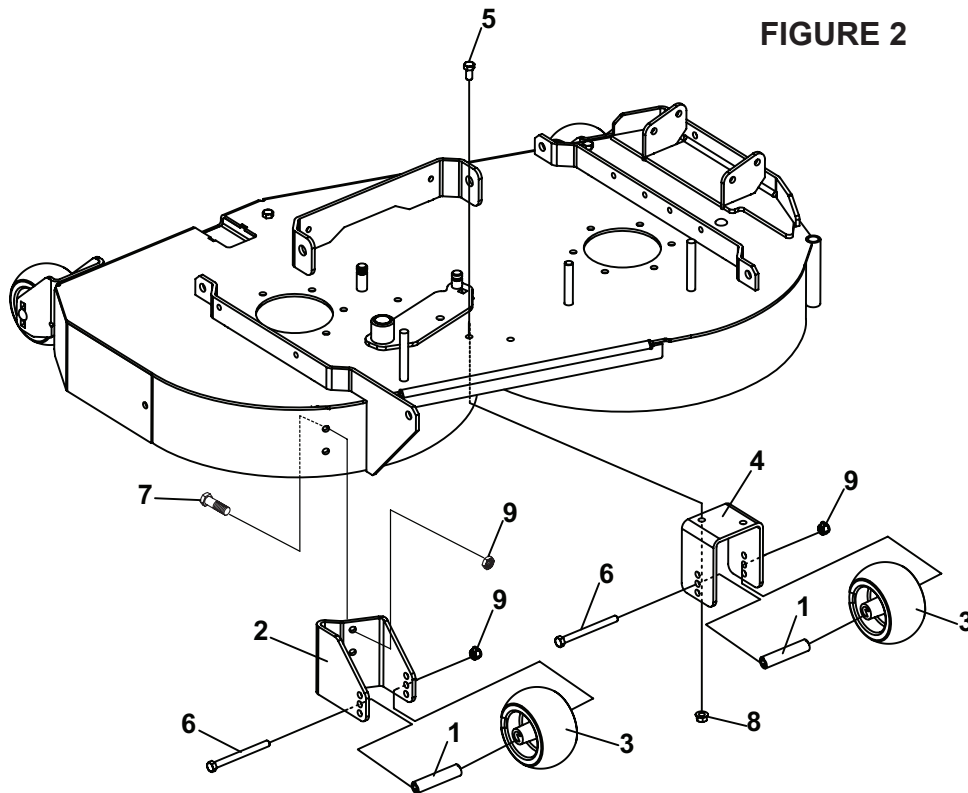

FIGURE 2

