

I.S.-52" & 61" "F-SERIES" COLLECTION SYSTEM CONVERSION KIT TO "G-SERIES" ZT2 (970413)

4166492 REV B

INTRODUCTION: These supplemental instructions explain how to install any one of the 970323, 970324, 970325, and 970326 collection systems to the new G-Series Predator-Pro and Procat ZT's.

INSTRUCTIONS:

1. Referring to **Figure 1**, remove the current discharge baffle A from the deck and retain the hardware.
2. Install the new discharge baffle **Item 1** for 52in. deck or **Item 2** for a 61in. deck. See discharge baffle profile in **Figure 2** to insure which baffle is required. Use the hardware retained in Step 1.
3. Replace the current uprights in the collection system kit with the new uprights **Item 3 & 4**. Install items **5, 6, and 7** as described in **Figure 4**. Install as the collection system instructions dictate. Be sure to locate the engine oil drain hose clip one hole back from its original position when installing uprights.
4. **For 61in. decks only**, modify the blower housing in the collection system kit by removing the plate highlighted in **Figure 3**. Cutting and/or grinding will be required. Touch up with paint as needed.
5. **For 61in. decks only**, Replace the existing counterweight mounting brackets and U-bolts, with the new brackets items **8 & 9** and U-bolts **Item 10** as shown in **Figure 5**.

For 52in. decks only, Replace the existing U-bolts **Item 10**.
6. Material may have to be removed on the belt guard. Use the template 4166791 (52in.) or 4166792 (61in.) included in this kit to remove excess material. Cut the template out, fold where appropriate, and lay on top of the belt guard to see what material needs to be removed. Potential areas to be removed are highlighted on the template. Touch up with paint as needed.
7. **For 61in. decks only**, On the discharge side of the deck, the belt guide bolt needs to be removed and placed in the hole immediately next to it, in the forward most hole. Insure the correct height is maintained.
8. Install the collection system as instructions dictate.
9. When installing the rear heat shield, use the noted mounting holes and current hardware as shown in **Figure 6**. Note that the mounting holes are staggered. If you have an older collection system, it is possible that you would not have a second slot in the bottom of your heat shield. Using the rear bumper as a guide, drill a hole for the bottom mounting. Touch up with paint as needed.

**I.S.-52" & 61" "F-SERIES" COLLECTION SYSTEM CONVERSION KIT
TO "G-SERIES" ZT2 (970413)**

4166492 REV B

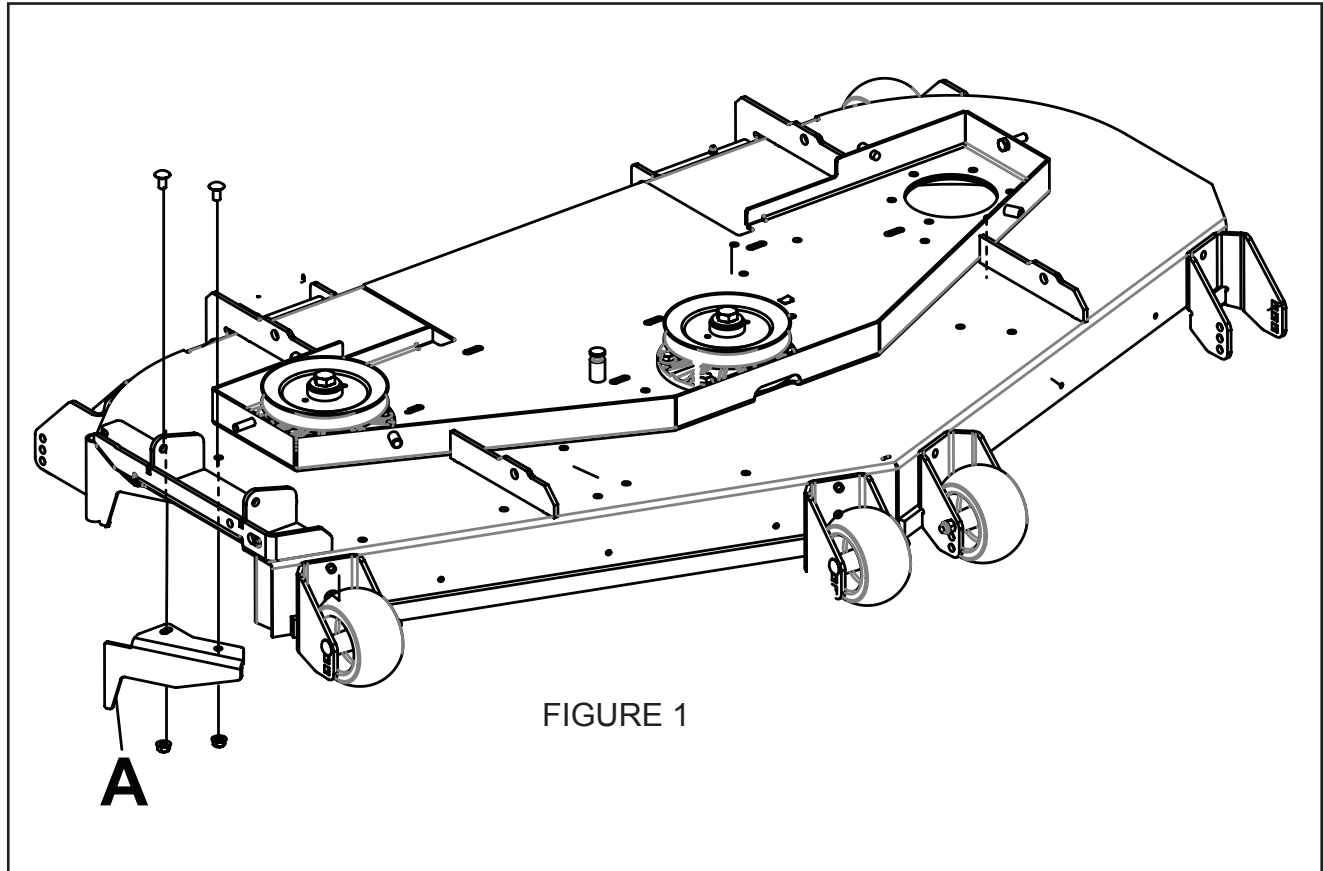

KIT PARTS LIST

ITEM	PART NO.	DESCRIPTION	QTY
1	4166027.7	BAFFLE-DISCHARGE 52"	1
2	4166028.7	BAFFLE-DISCHARGE 61"	1
3	4166471.7	PLATE-SUPPORT, RH SIDE	1
4	4166472.7	PLATE-SUPPORT, LH SIDE	1
5	64163-31	WSHR 25/64X1X12	8
6	64262-012	BLT-FLG HD 3/8-16 X 1-1/4	2
7	64268-03	NUT-FL NYLON LOCK 3/8-16	2
8	4164306	BRKT-COUNTERWEIGHT LH ZT2	1
9	4164305	BRKT-COUNTERWEIGHT RH ZT2	1
10	4166635	U-BOLT	4
11	4166791	TEMPLATE-BELT GAURD 52"	1
12	4166792	TEMPLATE-BELT GUARD 61"	1

I.S.-52" & 61" "F-SERIES" COLLECTION SYSTEM CONVERSION KIT TO "G-SERIES" ZT2 (970413)

4166492 REV B

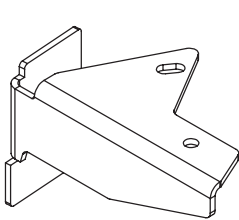

61 INCH BAFFLE
4166028.7
ITEM 2

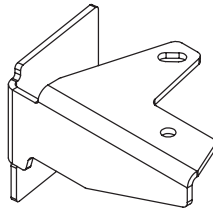

52 INCH BAFFLE
4166027.7
ITEM 1

FIGURE 2

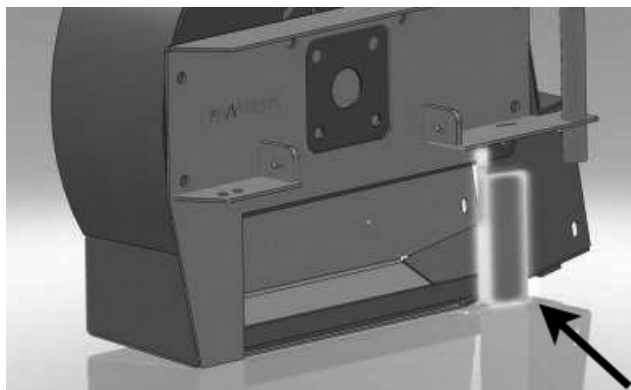

FIGURE 3

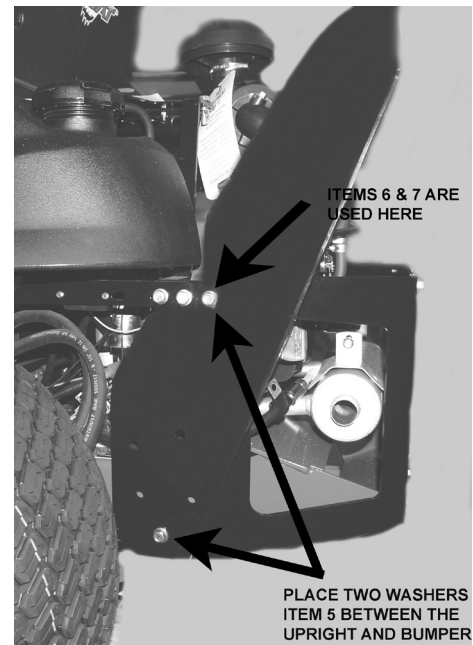

FIGURE 4

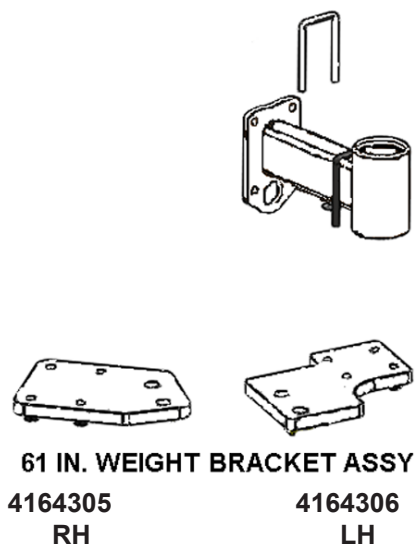

FIGURE 5

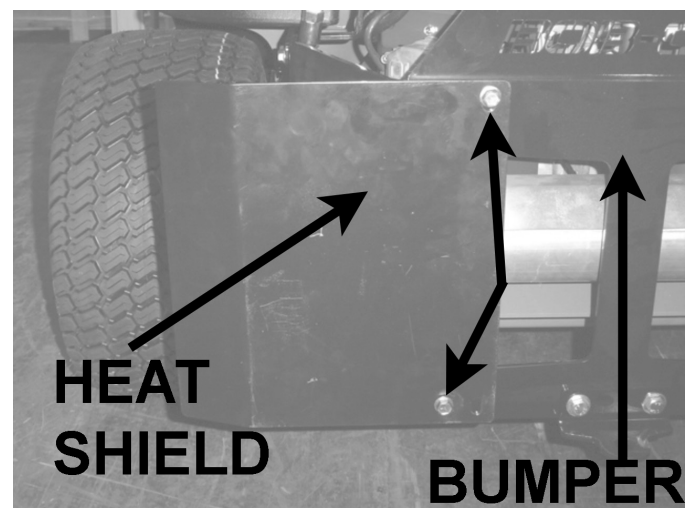

FIGURE 6