

I.S.-48", 52" & 61" BAHIA DECK KITS (970427, 970416 & 970417)

4166511 REV B

INTRODUCTION: This instruction sheet covers the installation of the Bahia deck kit for the 48", 52" and 61" cutterdecks for ZT2 models.

1. Remove and replace the left hand extension 2 and the right hand extension 1 with Bahia grass extensions as shown in **Figure 1**.

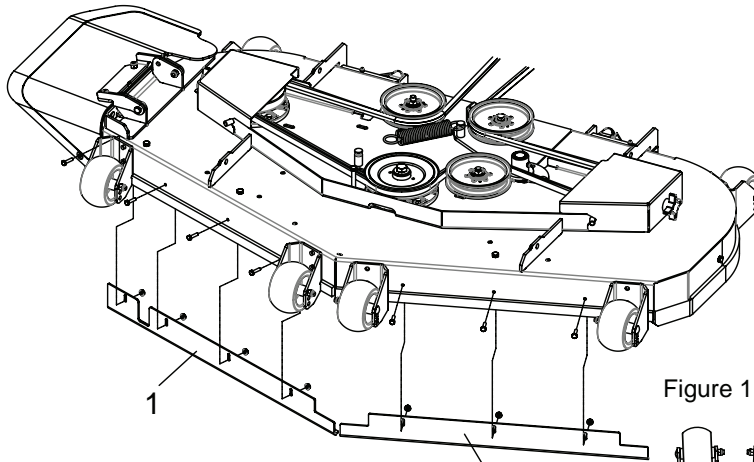

Figure 1

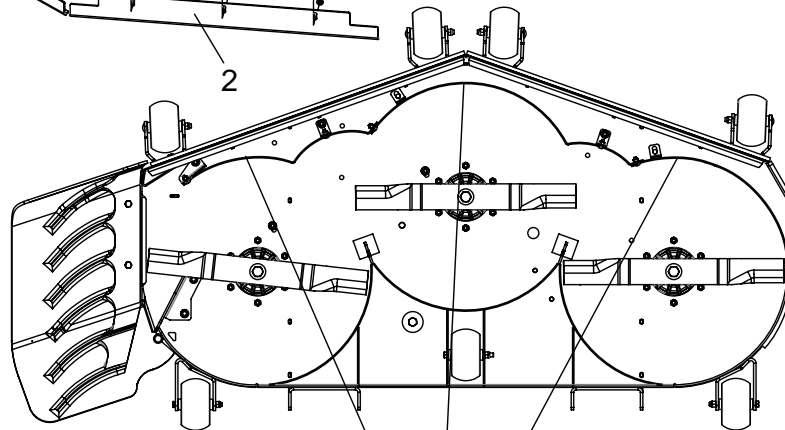

Figure 2

2. Remove the baffles and retain with hardware for later use. **Figure 2**

KIT PARTS LIST

ITEM	PART NO.	DESCRIPTION	QTY
1	4166478.7	EXTENSION, 52" CUTTERDECK RH	1
	4166480.7	EXTENSION, 61" CUTTERDECK RH	
	4166929.7	EXTENSION, 48" CUTTERDECK RH	
2	4166479.7	EXTENSION, 52" CUTTERDECK LH	1
	4166481.7	EXTENSION, 61" CUTTERDECK LH	
	4166930.7	EXTENSION, 48" CUTTERDECK LH	