

## Service Bulletin

Date: 3/26/2008

Product Type: 72" Full size Zero Turn Units

Bulletin No: JC-005-08

### **970368 Heavy Duty PTO Idler Post for 72"**

**ISSUE:** Our rear PTO Idler stud has undergone various changes over the years to keep with the objective of making the machine as maintenance free as possible. Where each previous style had its pro's and con's, this new generation assembly has included all the pro's and eliminated all the cons and goes beyond the expected in strength, durability and serviceability.

**CORRECTION:** Any 72" unit that has a current or future warrantable failure of the idler post and/or idler arm on the rear of the deck will require the kit 970368 to be installed.  
**NOTE:** Production will begin implementing this new generation idler assembly as an in-line production change commencing 12-14-2007.

**ACTION REQUIRED:** This does NOT affect all units and is NOT a recall. If a customer experiences a problem with the current idler **during the warranty period**, then installation of the kit is applicable.

**PARTS INVOLVED:** Kit 970368 – Instructions and component parts list attached.  
Note: One more kit will be released in the future to address the 48"/52" applications.  
**RECAP-** Previously release 61" kit is 970367

**PRODUCTS INVOLVED:** 72" Full Size BOB-CAT & BUNTON Zero Turns.

**WARRANTY:** 2 hours per unit/kit **ONLY on as need basis.**

If you have any questions please contact Commercial Grounds Care, Inc.  
Customer Service Department @ 920-699-2000

This bulletin is relevant to the departments shown below. Please circulate as appropriate.

SERVICE ☒

WARRANTY ☒

SALES ☒

PARTS ☒



**INTRODUCTION:** This instruction sheet covers the installation of the 72" PTO idler kit (970368) for the 72" cutterdeck.

**TOOLS REQUIRED:**

- Drill
- 13/32" Drill Bit
- Center Punch
- Tape Measure or Ruler
- Blocks (for deck support)
- Ratchet w/ extension
- 9/16" Socket
- 9/16" Wrench
- Die Grinder
- Angle Grinder
- Red Loctite

Note: All references to "right" or "left" are with respect to an operator at the controls.

**NOTE:** Park the machine on a smooth, level surface. Raise the cutterdeck to the transport position and remove the height of cut pin. Lower the cutterdeck onto a set of equal height blocks. Remove cutterdeck from the machine.

**ASSEMBLY INSTRUCTIONS:**

1. Use the die grinder to remove welded on PTO idler pin and clean up area with the angle grinder.
2. Locate new pin weldment as shown in **Figure 1**, mark and drill three 13/32" holes.

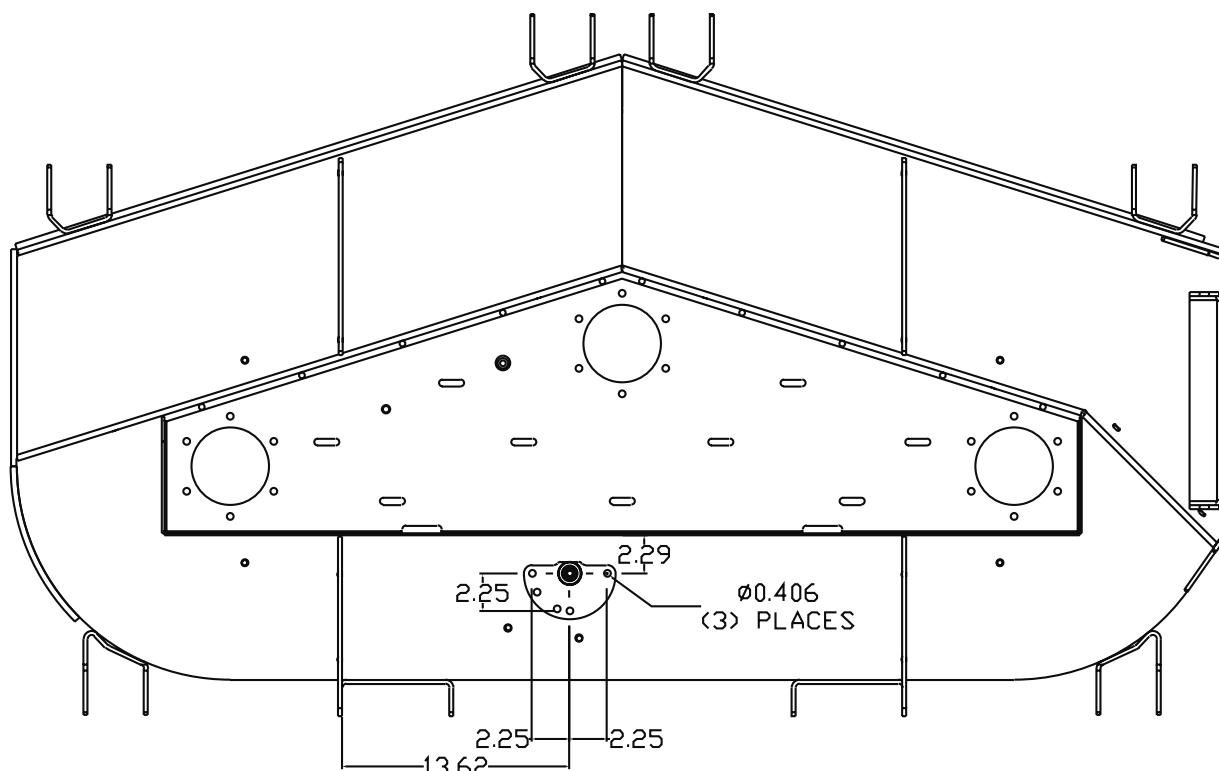

3. Install new idler pin weldment (7) and spacer plate (9) using 3/8-16 nuts (8) and bolts (6).

4. Slide inner rings (5) onto idler pin (7). Inner rings may be a press fit onto pin  
Place adrop of red Loctite in threaded hole in pin (7).
5. Place spacer (4) on top of inner rings (5).
6. Install idler arm weldment (3) onto pin (7).
7. Place a drop of red loctite onto bolt (2) and fasten down idler arm weldment (3) to idler pin (7)  
Torque Bolt (2) to 60 ft-lbs.
8. Install cap (1) then grease the assembly.
9. Remove pulleys from current idler arm weldment and install them on new idler arm weldment.
10. Reinstall cutterdeck on machine.

### SERVICE PARTS LIST

ITEM	PART NO.	DESCRIPTION	QTY
1	4128002	CAP-END, 26 X 7	1
2	64270-02	BOLT-M10-1.5 X 30 ISO CL 10.9	1
3	4163028	WLDMNT-IDLER ARM	1
4	4163014	SPACER	1
5	4163155	INNER RING	2
6	64123-70	BOLT-3/8-16X1	3
7	4163030.7	WLDMNT-IDLER PIN	1
8	64229-03	NUT-3/8-16 NYLON LOCK	3
9	4163189.7	PLATE-SPACER	1

