



SERVICE BULLETIN

October 15, 2009

Bulletin No: JC-019-09

IDLER KIT 970395

Product Type: 26hp Kawasaki Liquid Cooled Full Size ZT

Issue: Sporadic reports of throwing/shredding PTO belt

Details: We issued a previous bulletin, JC-012-09 dated June 19, 2009, in reference to this issue. That bulletin is still valid, and while that bulletin corrected a cast majority of affected units, it did not rectify the situation in all units. The central issue is still harmonic PTO belt slap under heavy load. Typically, the belt rolls over on its back from slapping which results in the shredding of the belt cords which eventually ends with the belt thrown or breaking.

Action Required: If you experience a PTO belt problem with this unit, and after following steps outlines in bulletin JC-012-09 you still have an issue then we advise installing **Idler Kit 970395**. This kit only applies to the 26hp liquid cooled units. See the attached directions for details on what is involved in the kit.

Products Involved: Models 642245D, E or F, and 942245D, E or F

Warranty: We will pay 0.5hr plus the kit for any units requiring this update. In WarrantySmart you will see a labor code in the drop down box for "Service Bulletin JC01909 – Idler Update Kit (under power unit)".

If you have any questions please contact Schiller Grounds Care, Inc. Customer Service Department at 920-699-2000.

This bulletin is relevant to the departments shown below. Please circulate as appropriate.

SERVICE

☒

WARRANTY

☒

SALES

☐

PARTS

☒

*Schiller Grounds Care, Inc.
One BOB-CAT Lane, P.O. Box 469
Johnson Creek, WI 53038*

Phone: 920.699.2000

Fax: 920.699.6836

INTRODUCTION: This instruction sheet covers the installation of the liquid cooled PTO idler kit for ZT200 liquid cooled units.

1. Cut out template 4164771 provided with kit.
2. Position the template inside the frame, aligning along the edges as shown in Figure 1 and Figure 2.
3. With the template in position, locate and center punch the drill location.
4. Remove the template and drill a 13/32" hole at the punch location.
5. Assemble the idler as shown in Figure 3.
6. Once assembled idler should appear as pictured in Figure 4.



FIGURE 1



FIGURE 2

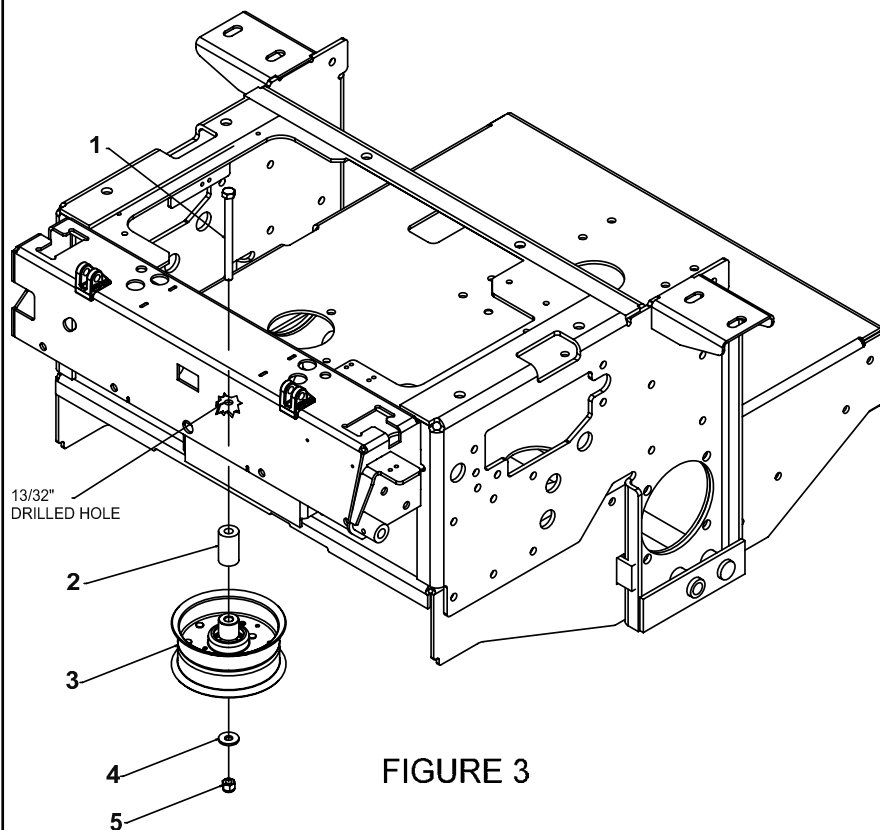

FIGURE 3

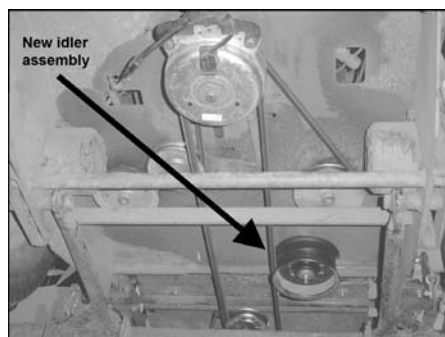

FIGURE 4

SERVICE PARTS LIST

ITEM	PART NO.	DESCRIPTION	QTY
1	64123-93	BLT-HEX 3/8-16 x 5	1
2	2721485-01	SPACER-IDLER	1
3	2721541	PULLEY-IDLER 5 IN.	1
4	64163-31	WASHER-25/64 X1X 12GA.	1
5	64229-03	NUT-NYLON LOCK 3/8-16	1
6	4164771	TEMPLATE-PTO IDLER KIT (NOT SHOWN)	1