



## SERVICE BULLETIN

June 8, 2010

Bulletin No: JC-019-09 REV-1

### REVISED IDLER KIT 970395

Upon the release of kit 970395, we have found that when cutting conditions are at extremes the belt can climb up on top of the new idler. To be proactive, we have started to include a wrap around guide in kit 970395. We recommend having this guide installed for any units in the field with kit 970395 previously installed.

**Product Type:** This only applies to the 26hp Kawasaki Liquid Cooled Full Size ZT units

**Issue:** Sporadic reports of Throwing/Shredding PTO belt.

**Details:** See original bulletin **JC-019-09** for details that still apply.

**Action Required:** If kit 970395 has already been installed, order belt guide **4165330.7** and thick washer **64163-105** and submit warranty. See the attached directions for details on this kit and placement of the guide.

**Products Involved:** MODELS - **642245D**, E & F and **942245D**, E & F, and **942253F**

**Warranty:** We will pay .5hr plus the kit for any unit requiring the update kit (kits being shipped from the factory already have the new guide in them). If you have a kit without the guide simply order the guide and washer and claim it on warranty. If the kit has already been installed we will pay an additional .3hr to put the belt guide on. In Warranty Smart, you will see a labor code in the drop down box for both of these jobs under "Service Bulletin" and the bulletin number.

If you have any questions, please contact the Schiller Grounds Care, Inc. Customer Service Department at 920-699-2000.

This bulletin is relevant to the departments shown below. Please circulate as appropriate.

SERVICE

☒

WARRANTY

☒

SALES

☐

PARTS

☒

## I.S.-970395 LIQUID COOLED PTO IDLER KIT

4164768 REV A

**INTRODUCTION:** This instruction sheet covers the installation of the liquid cooled PTO idler kit for ZT200 liquid cooled units.

1. Cut out template 4164771 provided with kit.
2. Position the template inside the frame, aligning along the edges as shown in Figure 1 and Figure 2.
3. With the template in position, locate and center punch the drill location.
4. Remove the template and drill a 13/32" hole at the punch location.
5. Assemble the idler as shown in Figure 3.



FIGURE 1



FIGURE 2

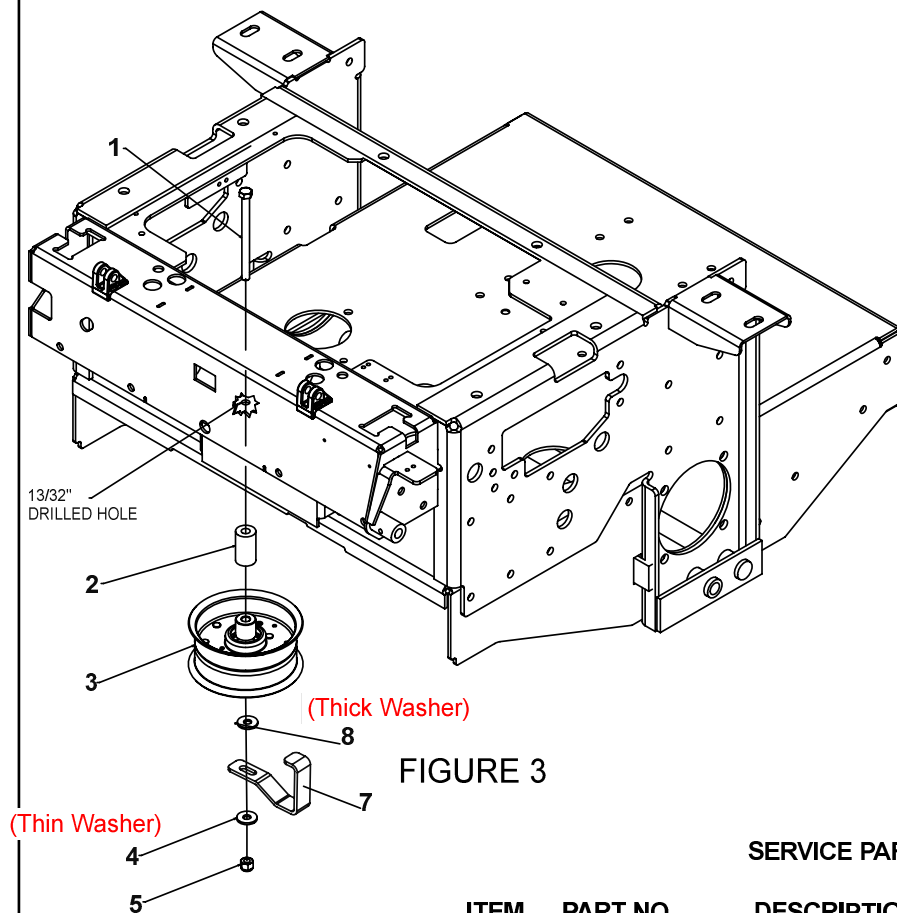

FIGURE 3

### SERVICE PARTS LIST

ITEM	PART NO.	DESCRIPTION	QTY
1	64123-93	BLT-HEX 3/8-16 x 5	1
2	2721485-01	SPACER-IDLER	1
3	2721541	PULLEY-IDLER 5 IN.	1
4	64163-31	WASHER-25/64 X1X 12GA.	1
5	64229-03	NUT-NYLON LOCK 3/8-16	1
6	4164771	TEMPLATE-PTO IDLER KIT (NOT SHOWN)	1
7	4165330.7	GUIDE-BELT, LC	1
8	64163-105	WASHER-.406ID X .75 OD X .134	1