

Product Type: 430 – 33G**Bulletin No: JC-023-07****October 22, 2007**

Service Bulletin

Action Required: Installing new throttle lever**ISSUE:** We are receiving reports that full engine RPM is not being attained when throttle lever is pushed all the way forward.**CORRECTION:** remove the old throttle lever and linkage. Install new throttle lever using a pivot bolt instead of the linkage. Adjust the cable so full engine RPM is 3700 and idle is 1600**PARTS INVOLVED:**

1 – 4162930.7	LEVER, THROTTLE
1 – 4162932	SPACER
1 – 64123-60	BOLT, 1/4X1-3/4
1 – 64141-2	NUT, FLANGE 1/4
1 – 64123-47	BLT-HEX, 5/16-18X1-1/4
1 – 64229-02	LOCKNUT-NYLON 5/16-18
1 – 05-028	WASHER-FRICTION (on pivot bolt)

PRODUCTS INVOLVED: 75-70010A

Serial numbers: 75700100070 - 75700100171

WARRANTY:

You may claim up to .5 hour of labor and parts for units covered under this bulletin. Please file warranty using Service Bulletin Number JC-021-07 with one unit per claim.

All warranty claims regarding this bulletin must be filed before April 22, 2008

If you have any questions please contact Commercial Grounds Care Inc.
Customer Service Department @ 920-699-2000

This bulletin is relevant to the departments shown below. Please circulate as appropriate.

SERVICE	<input checked="" type="checkbox"/>	WARRANTY	<input checked="" type="checkbox"/>	SALES	<input checked="" type="checkbox"/>	PARTS	<input checked="" type="checkbox"/>
---------	-------------------------------------	----------	-------------------------------------	-------	-------------------------------------	-------	-------------------------------------



CGC

Commercial Grounds Care, Inc.

One Bob-Cat Lane
P.O. Box 469
Johnson Creek, WI 53038-0469

Tel: 920-699-2000
Fax: 920-699-3683

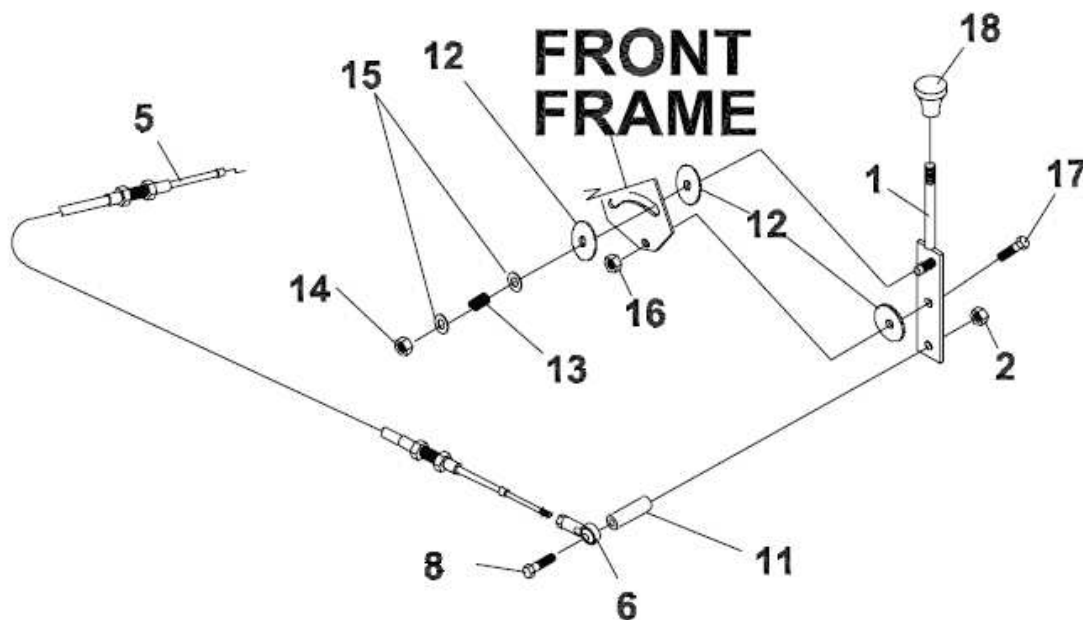

ITEM	PART NO.	DESCRIPTION	QTY
2-1	4162930.7	LEVER-THROTTLE	1
2-2	64141-2	NUT-FLANGE, 1/4	1
2-3	4162977-002	FUEL LINE, 1/4"x12"	1
2-4	38666	FUEL FILTER	1
2-5	4152043	CABLE, 430 THROTTLE	1
2-6	43-004X	ROD END, 1/4x10-32	1
2-7	4162977-001	FUEL LINE, 1/4"x54"	1
2-8	64123-60	BOLT, 1/4x1-3/4	1
2-9	88042N	CLAMP, HOSE	2
2-10	29-127	VALVE-FUEL W/O SCREEN	1
2-11	4162932	SPACER	1
2-12	05-028	WASHER-FRICTION	3
2-13	41-055	SPRING-COMPRESSION	1
2-14	64151-15	NUT-HEX 5/16-18 CTRLK	2
2-15	64163-55	WASHER-25/64X5/8X16GA	1
2-16	64229-02	LOCKNUT-NYLON 5/16-18	1
2-17	64123-47	BLT-HEX 5/16-18X1-1/4	1
2-18	47-114	KNOB-TAPERED 3/8-16	1



RYAN

