



One BOB-CAT Lane, P.O. Box 469
Johnson Creek, WI 53038 U.S.A.
(920) 699 2000
Fax: (920) 699 6836

Information Bulletin

Clarify wiring on Flex Deck

Date: 3/23/2015

Bulletin No: JC-15-06

Product Type: STEINER FLEX DECK

Customer Issue: Potential to wire the "Deck Lift Restrictor Switch" wrong.

Cause: The red color of the ground wire is misleading as most people associate red with positive polarity.

Action required: When assembling, assure the red wire with eyelet is grounded. For your records, the complete information on installing the (Lastec® Built) Steiner Flex Deck is attached.

Products Involved: 75-71305 80" Flex Deck

Warranty: No warranty applies.

If you have any questions, please contact our Customer Service Department at 920-699-2000.

This bulletin is relevant to the departments checked below. Please circulate as appropriate.

SERVICE

☒

WARRANTY

☐

SALES

☒

PARTS

☐

**LASTEC®***a division of Wood-Mizer Products, Inc.*

Instruction Sheet

Date: 1/27/2014
Bulletin #: IS-0379
Subject: 072854, 80EFS Electrical Kit
Purpose: To instruct Lastec personnel
Model Numbers: 80EFS
Serial Numbers: All Numbers
Recipients: All Lastec Dealers

The provided electrical kit (072854) needs to be installed to the tractor equipped with the 80EFS Deck Assembly. When installed, the kit will prevent the PTO from engaging when the decks are not locked into the closed position.

The electrical kit includes the following parts:

Ref	Part #	Description	Qty.
	072854	Electrical Kit, 80EFS	1
1	072852	Mounting Bracket, 80EFS Relay	1
	072853	Harness Assembly, 80EFS Main	1
	072842	Harness Assembly, 80EFS Aux	1
2	050436	Relay, 40A 12VDC Automotive	2
3	F05004-27	Screw, 10-24x1/2 Unsl Ind HH SS Machine	2
4	F05010-160	Nut, 10-24 Hex Nylon Lock	2
	IS-0379	Instruction Sheet, 80EFS Harness Install	1

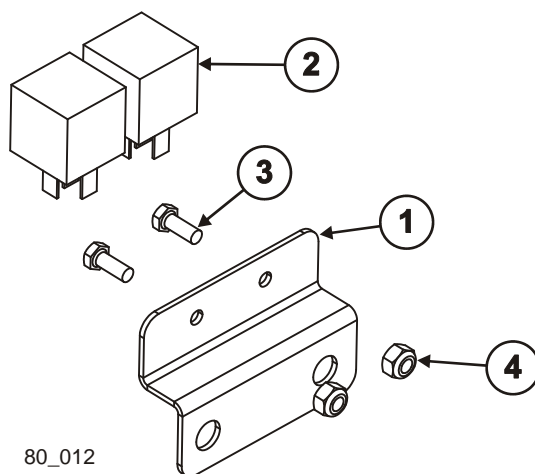

Installation Instructions:

1. Make sure that the mower is parked on level ground.
2. Turn the key in the ignition switch to the OFF position and remove the key.
3. Make sure that the parking brake is engaged.
4. Assemble the harness to the mounting bracket using two screws. Ensure that the relay connector with the black wire is positioned towards the front of the tractor.
5. Insert two relays into the harness connectors.

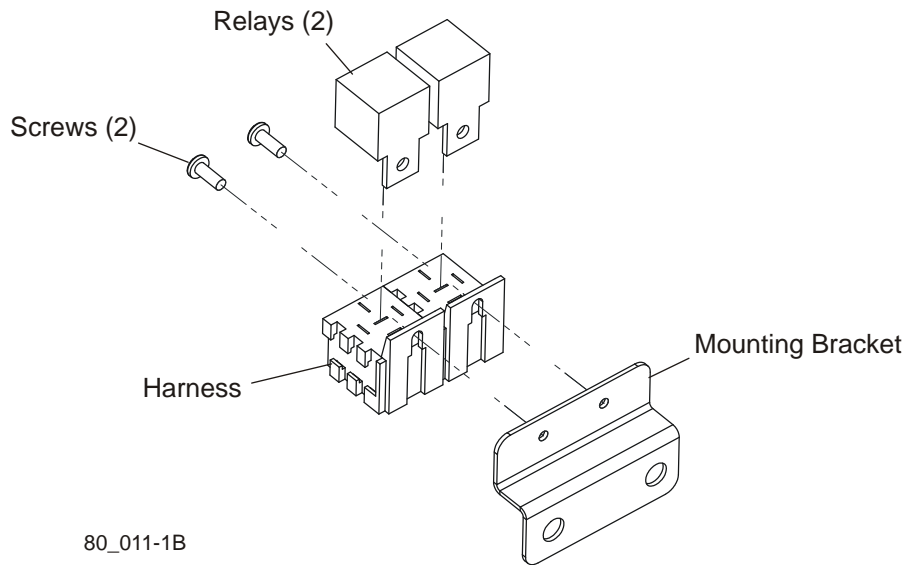

6. Attach the harness on the mounting bracket to the right hand upper grill. **NOTE:** Rotate the headlight harness clip to the rear of the machine.

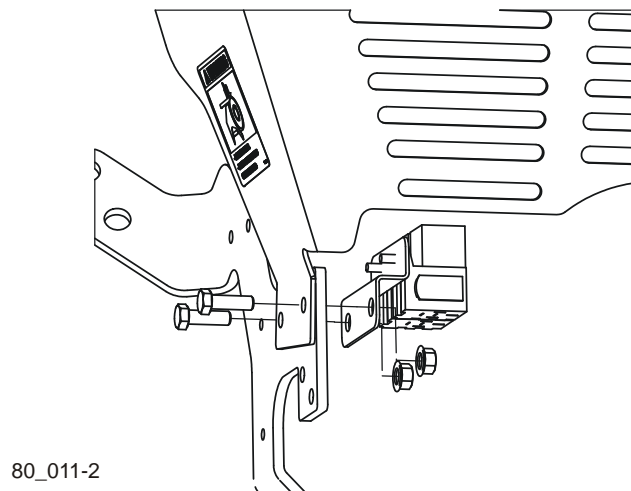

7. Disconnect the five wire connector from the soft start module (shown below). Connect the connector to the provided harness.

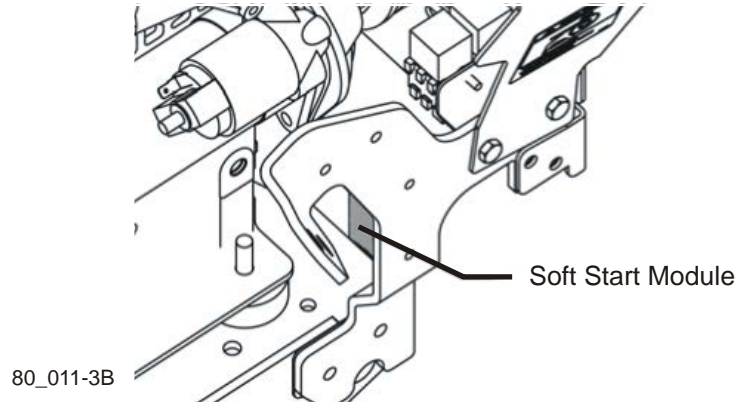

8. Connect the five wire connector on the provided harness to the Soft Start Module.
9. Connect the provided deck cables to the harness as shown below.

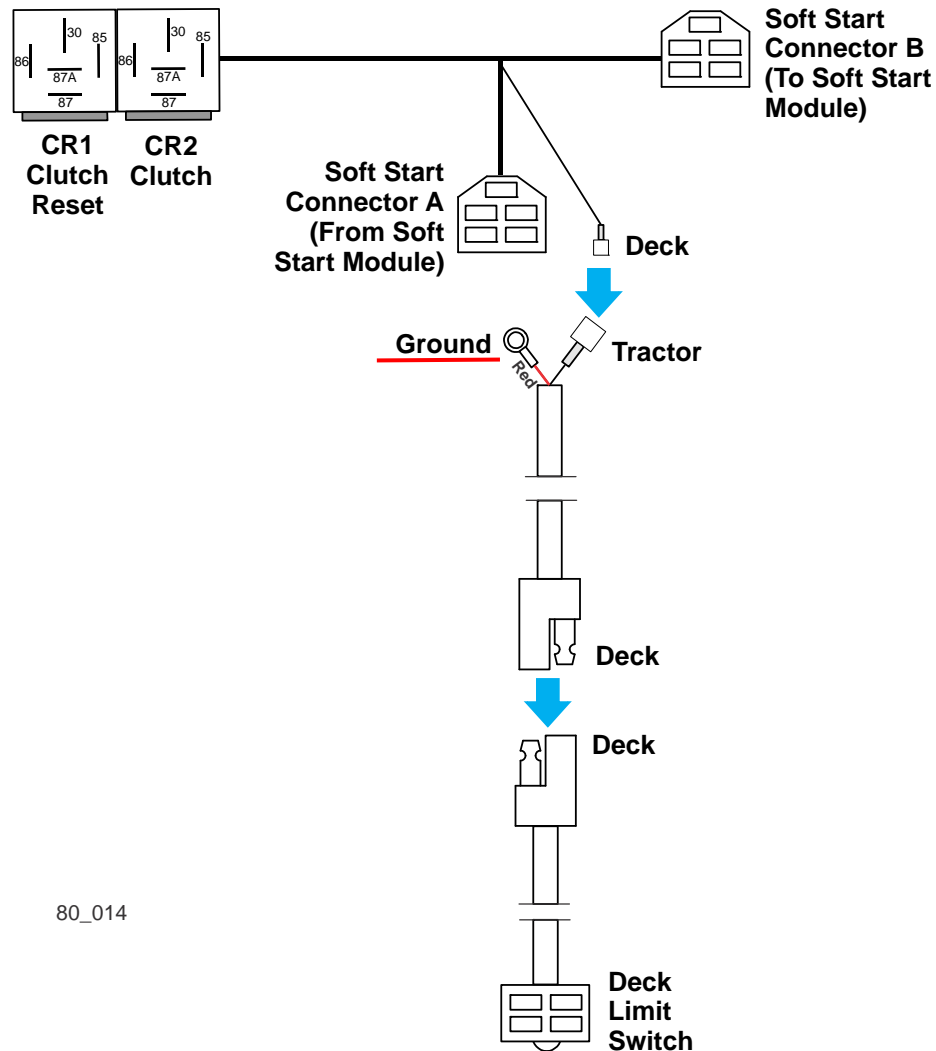

10. Connect the red ground wire on the harness to the frame.

11. Route the harness to the deck and connect it to the deck limit switch on the hydraulic cylinder.

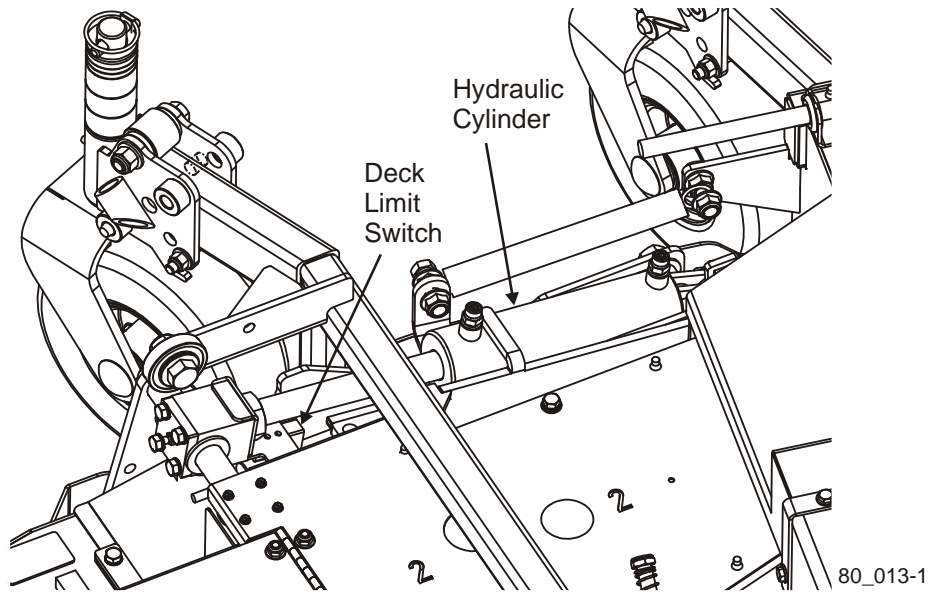

12. Secure the harness so the wires cannot become damaged by moving parts, heat, etc.

13. Test the system. With the operator sitting on the unit and the key in the ON position but the engine OFF, and the parking brake engaged:

- A. Fold the deck.
- B. Pull the PTO switch "ON". The clutch should engage.
- C. Unplug the harness. The clutch should not engage.
- D. Remove the ground. The clutch should stay disengaged.
- E. Reset the system by turning the PTO switch "OFF".